

STEPS

(1) Straight Support Poles

(2) Top MDF Board
Bottom MDF Board

(3) Printed Graphic Fabric Banner

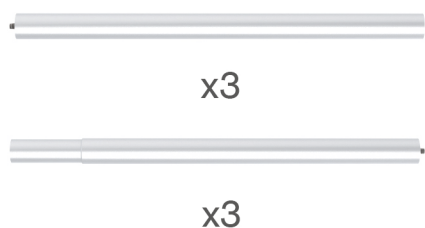
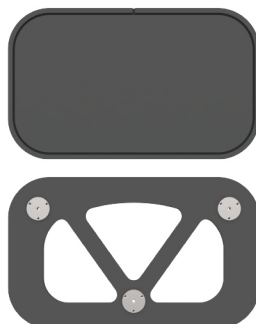

STEP 01

Insert fabric banner into bottom MDF board's slot and turn it over.

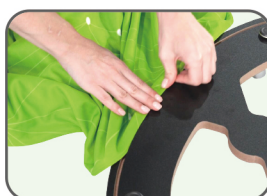
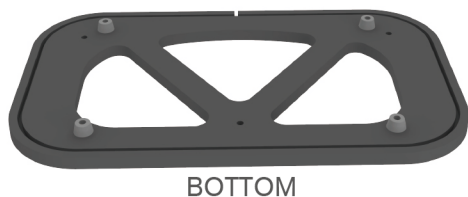

PRESS



STEP 02

Screw straight support poles in top & bottom MDF boards' threaded holes and interconnect them in the middle.

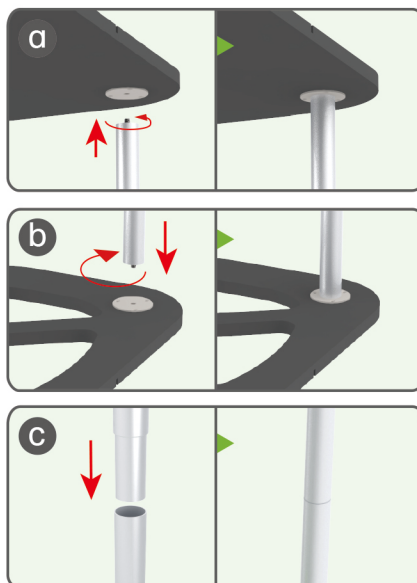
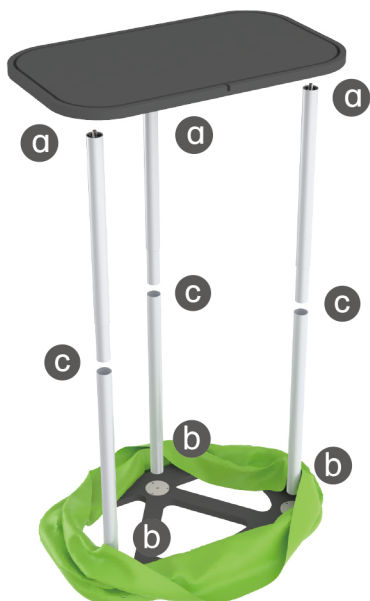

STEP 03

Pull fabric banner from bottom to top and insert into top MDF board's slot.



PRESS



DT-C-03



DT-C-01



DT-C-02