

★ One Tool (Hex Wrench) **STEPS****(1) Hardware****(2) Printed Graphic Fabric Banner****(3) LED Ladder Light & Switching Power Supply****STEP 01**

Connect to make long poles according to labelings.

**STEP 02**

Connect long poles with corner poles according to labelings.

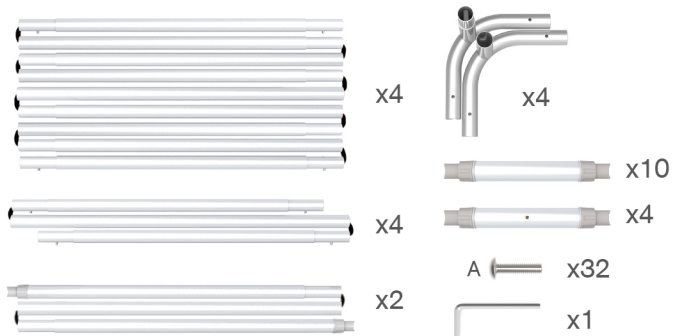
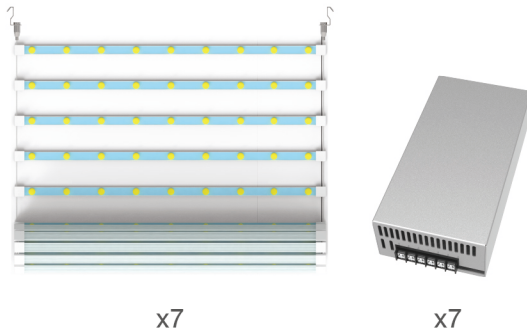
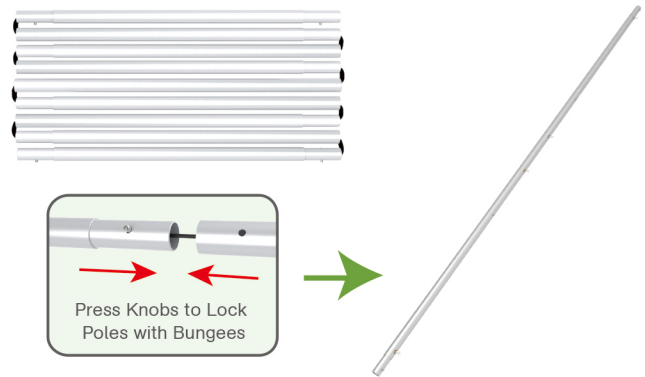
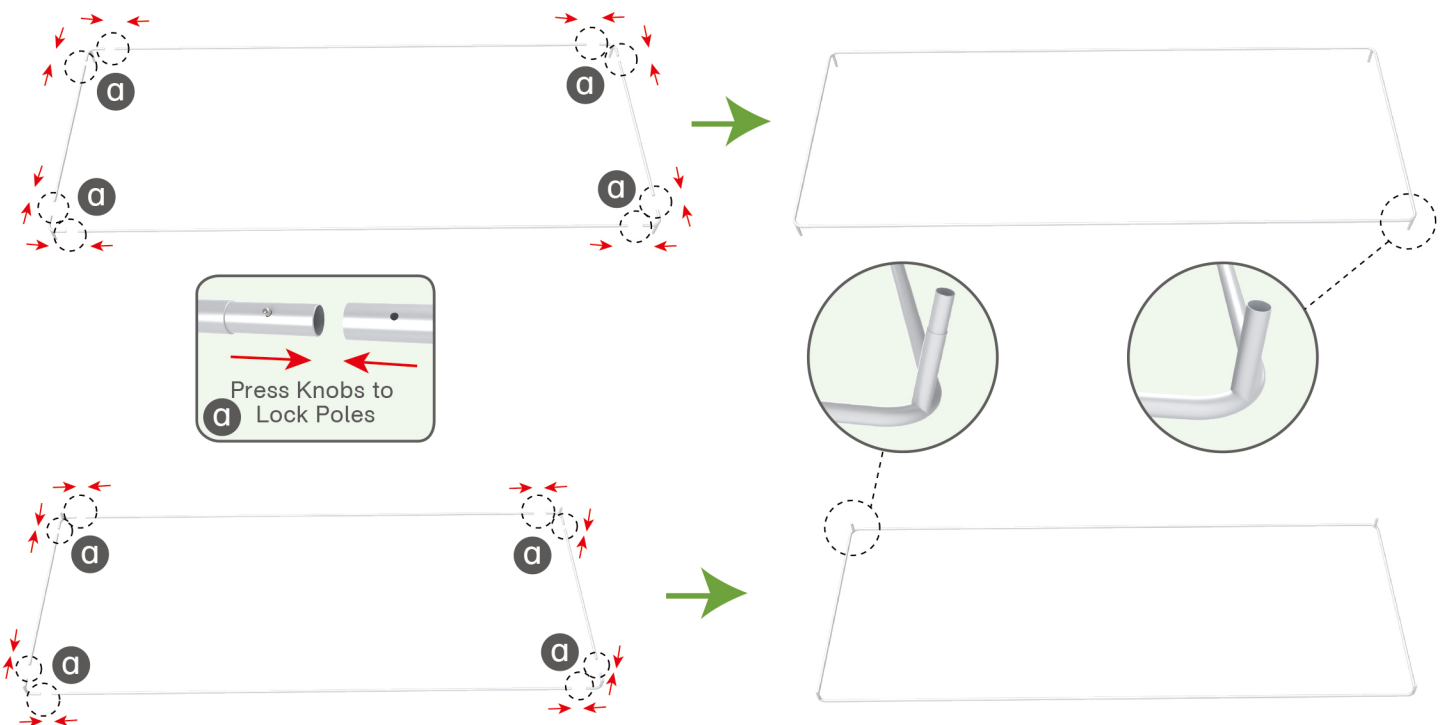

STEPS

STEP 03

Interconnect corner poles to make column frame according to labelings.

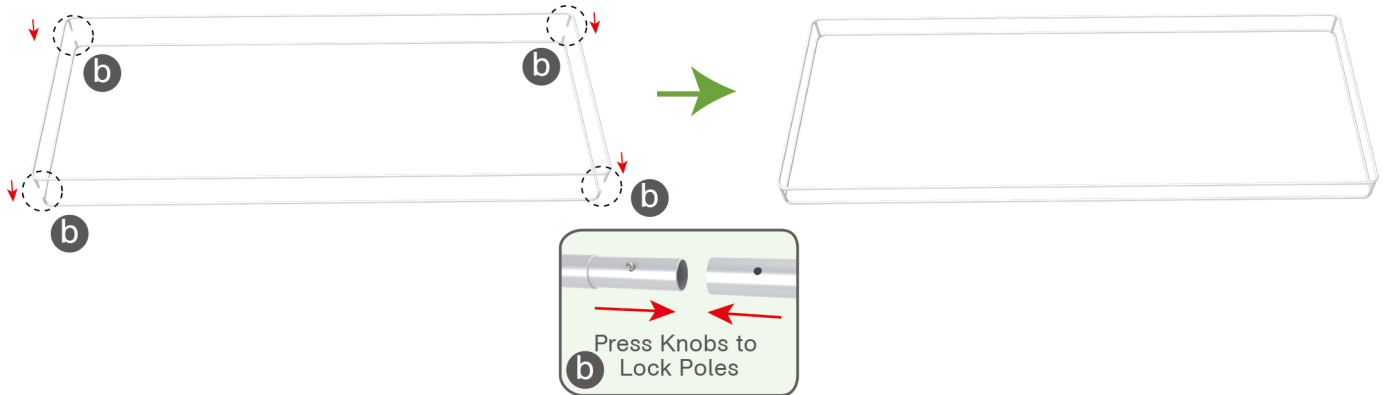

STEP 04

Connect support poles onto column frame.

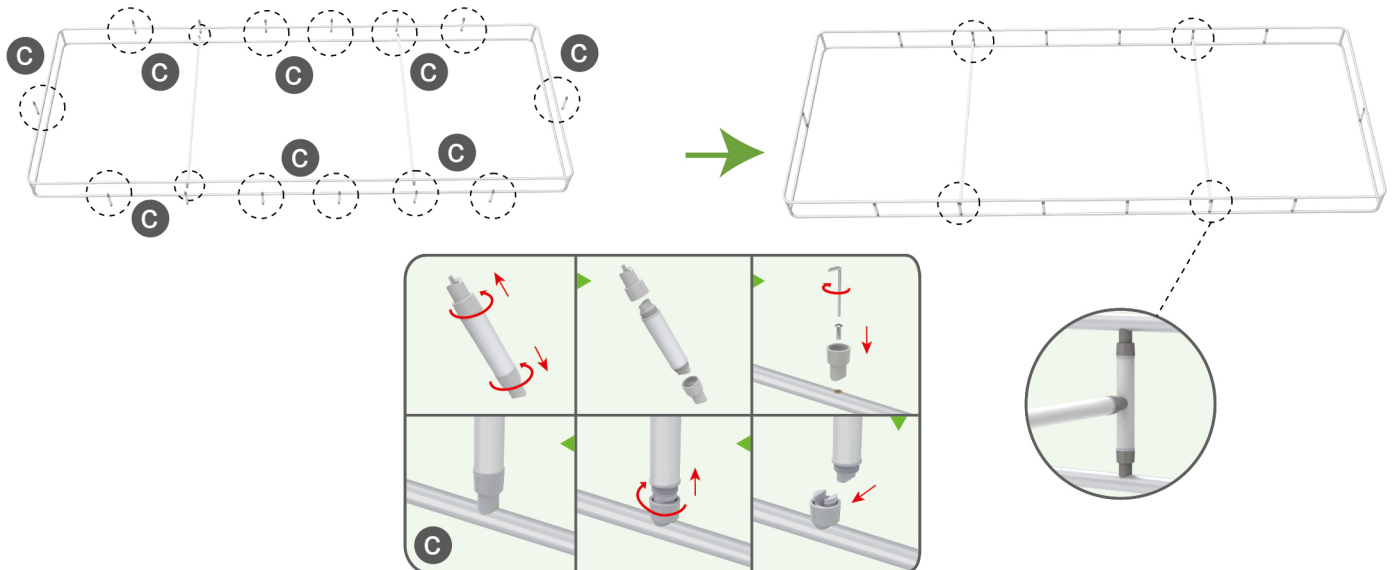

STEP 05

Hang LED ladder light into poles' holes.

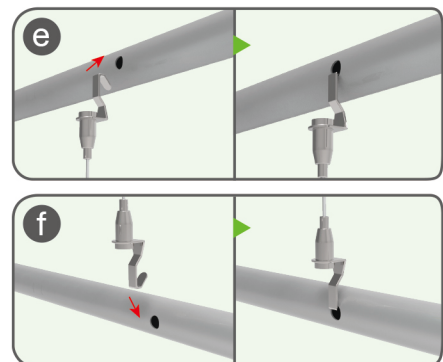
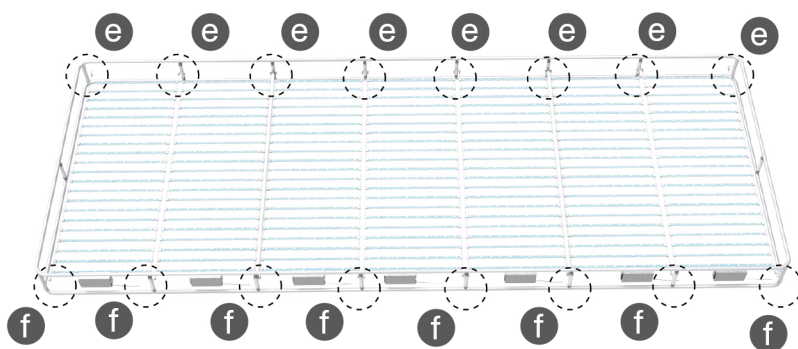

STEPS

STEP 06

Connect switching power supply with wires.

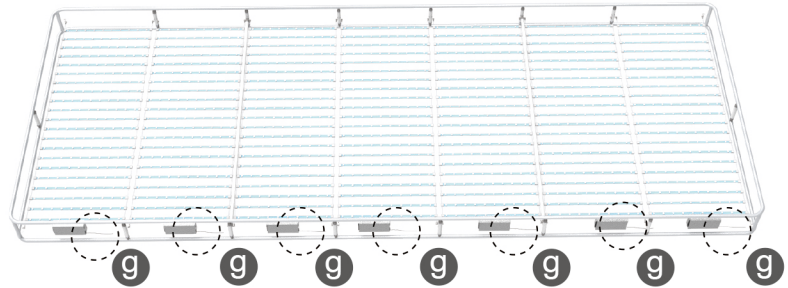
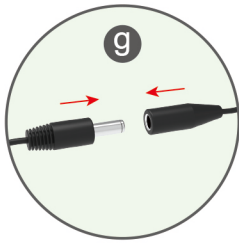

STEP 07

Slide fabric banner on frame from top and zip up at bottom.

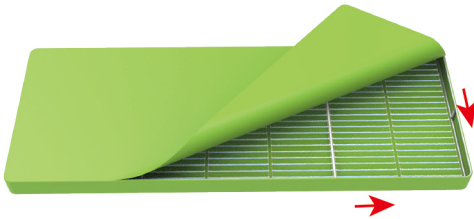

(1) Hardware

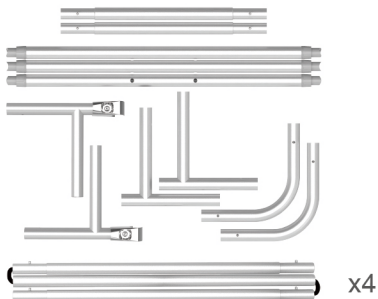

(2) Printed Graphic Fabric Banner



STEP 01

Connect to make long poles according to labelings.

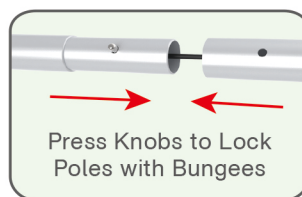

STEPS

STEP 02

Connect long poles with corner poles according to labelings, connect support poles onto frame.

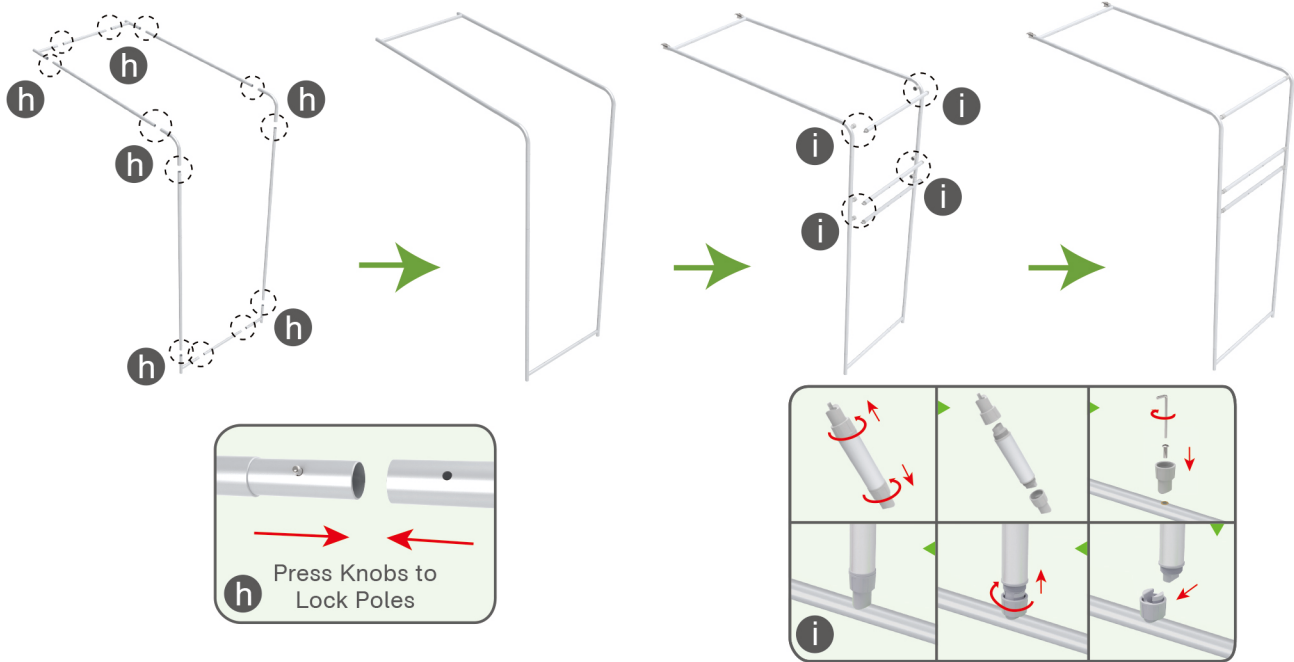

STEP 03

Slide fabric banner on frame from top and zip up at bottom.



Booth Set Assembly

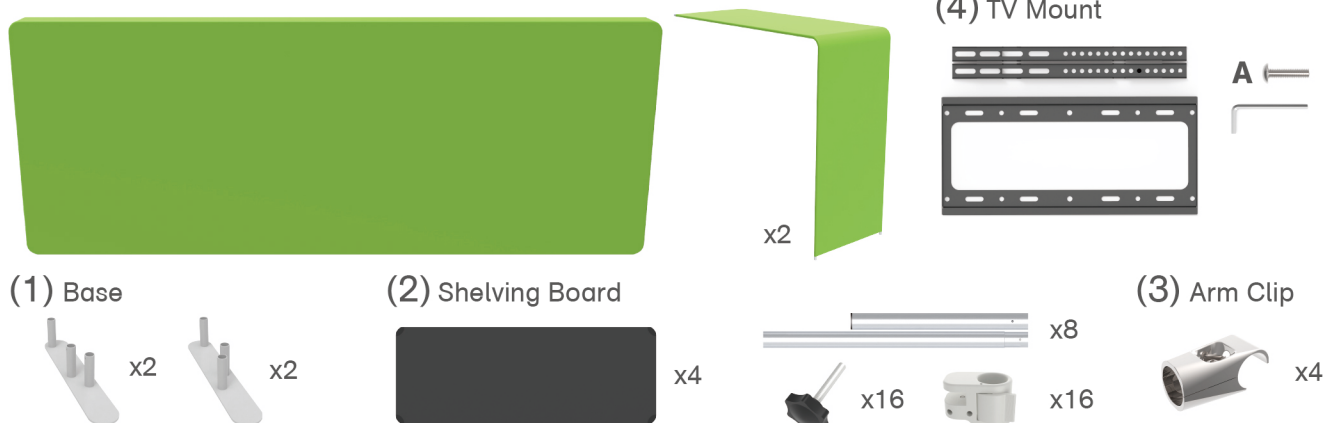

STEPS

STEP 01 Insert display stands onto feet by pressing their knobs.

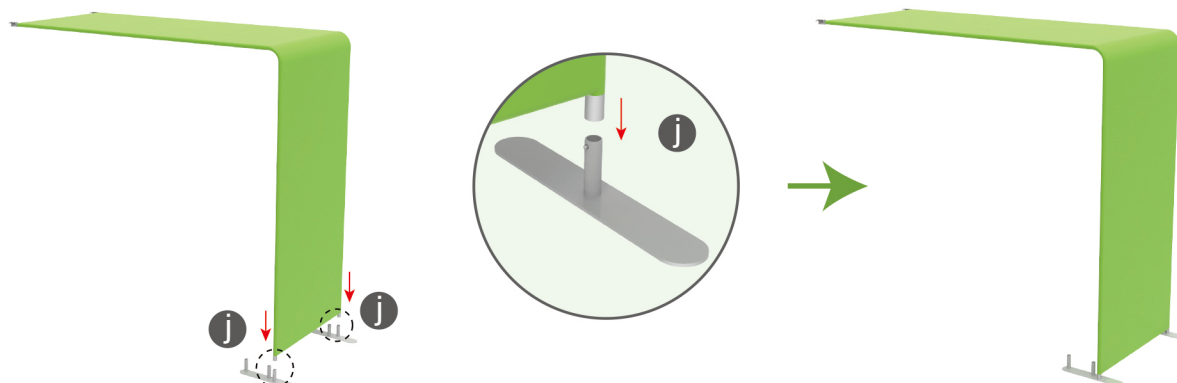

STEP 02 Connect display stands with arm clips.

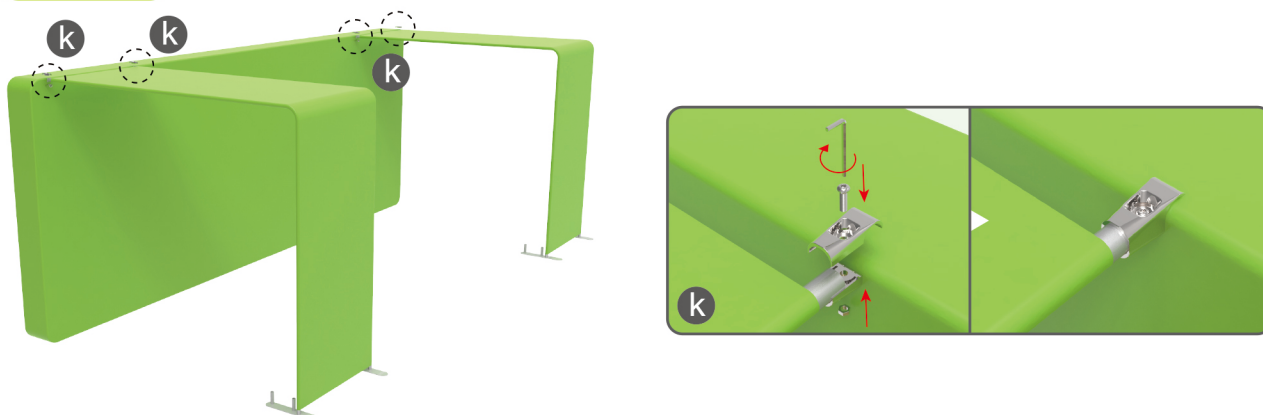

STEP 03 Install shelving boards in position.

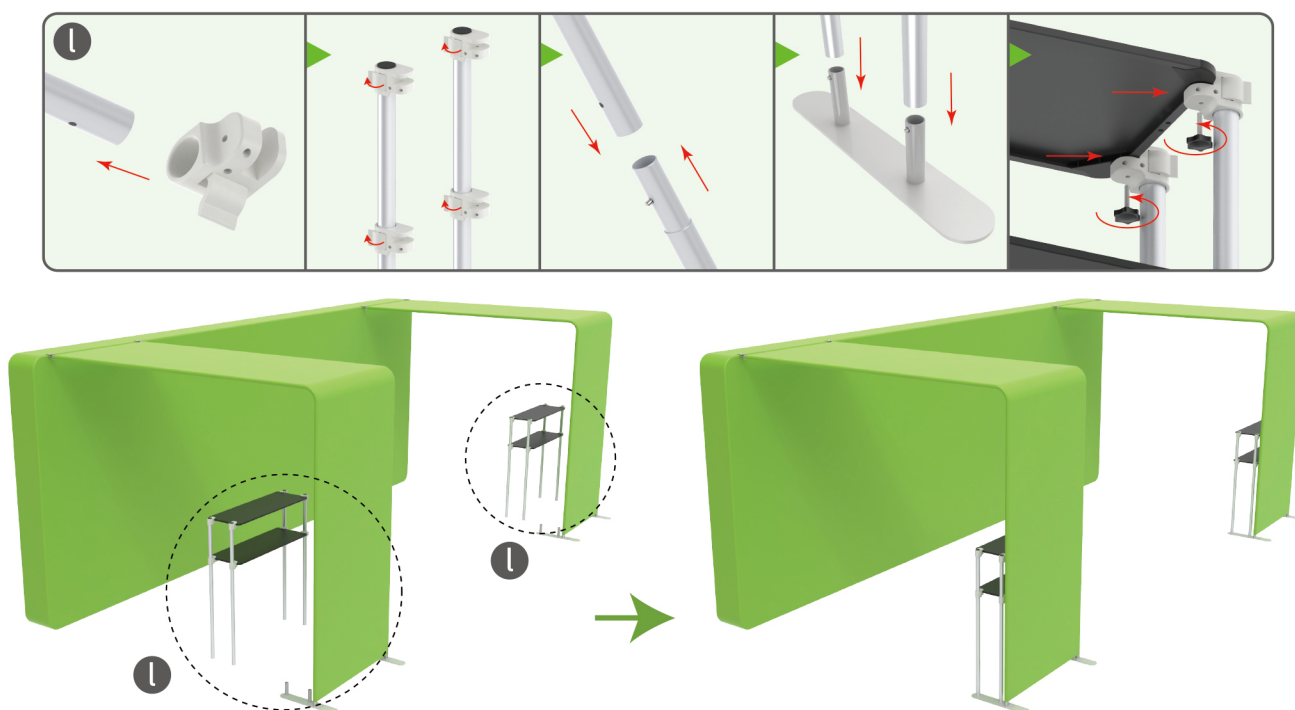

STEPS

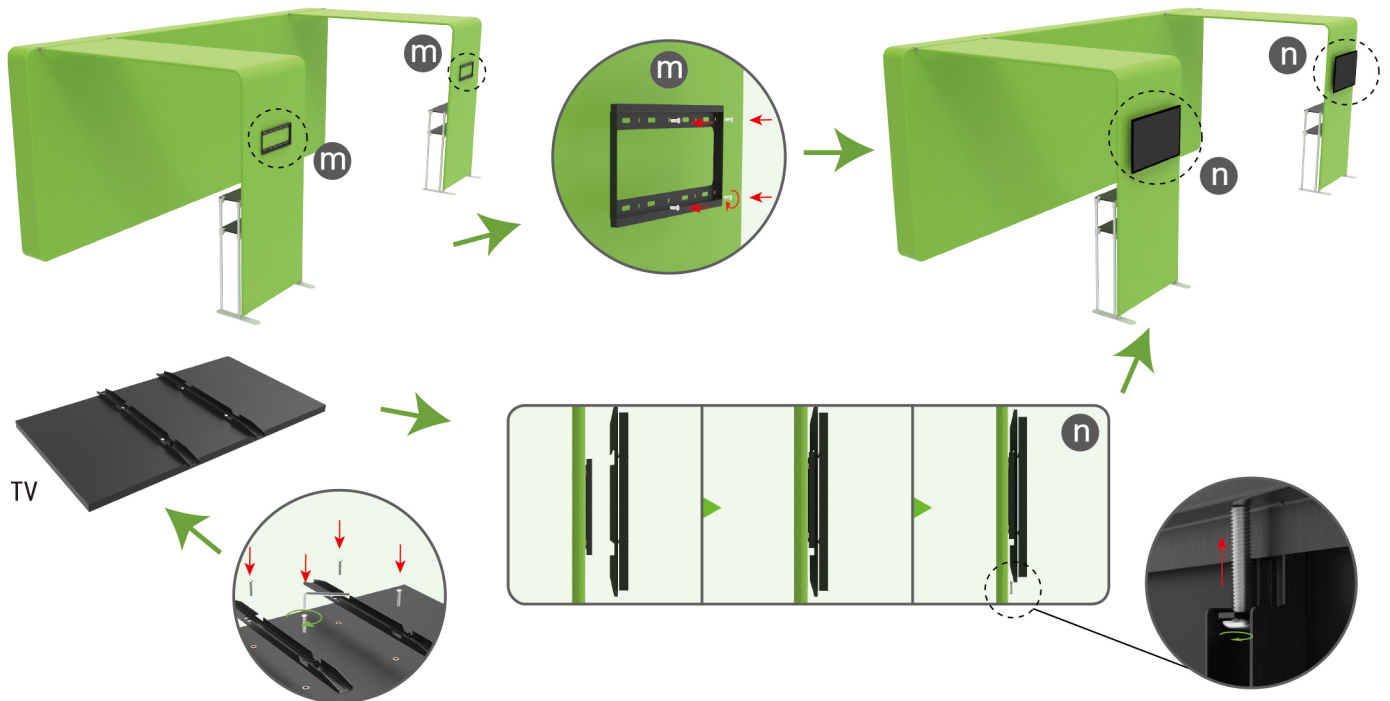
STEP 04 Screw TV mount with hex wrench.

10X20FT-BOOTH-20