

STEPS

(1) Hardware

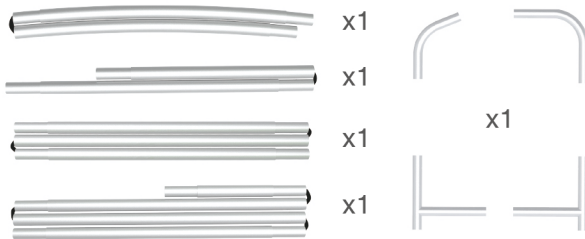

(2) Printed Graphic Fabric Banner



STEP 01

Connect to make long poles according to labelings.

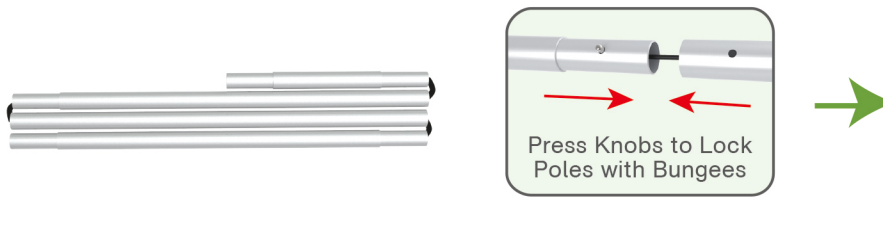

STEP 02

Connect long poles with corner poles according to labelings.

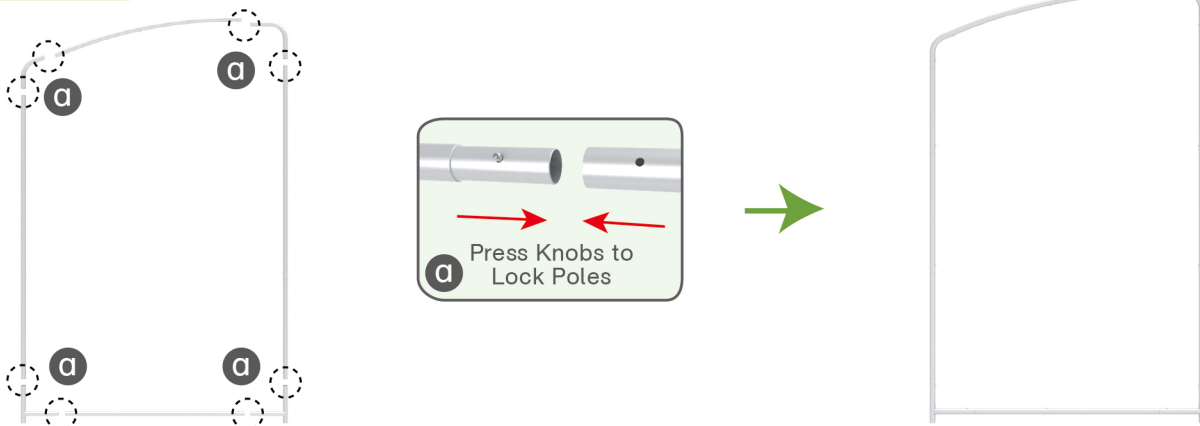

STEP 03

Slide fabric banner on frame from top and zip up at bottom.

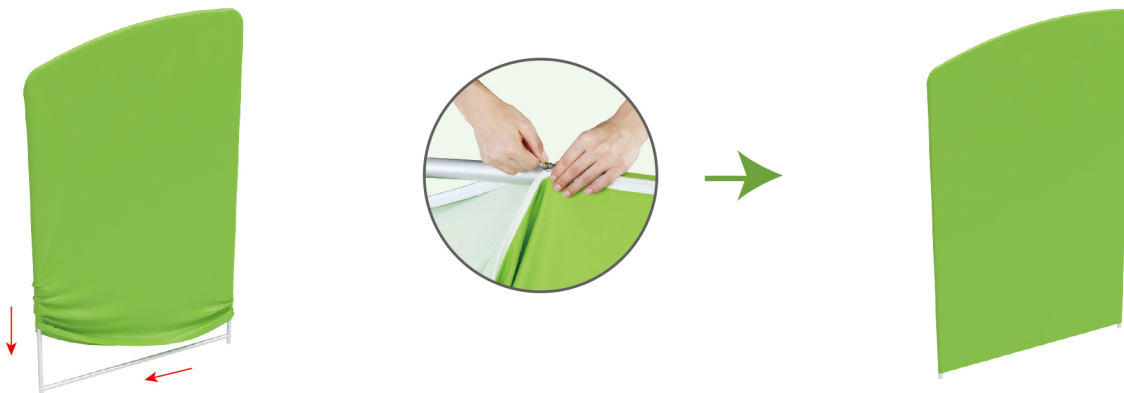

STEPS

(1) Hardware

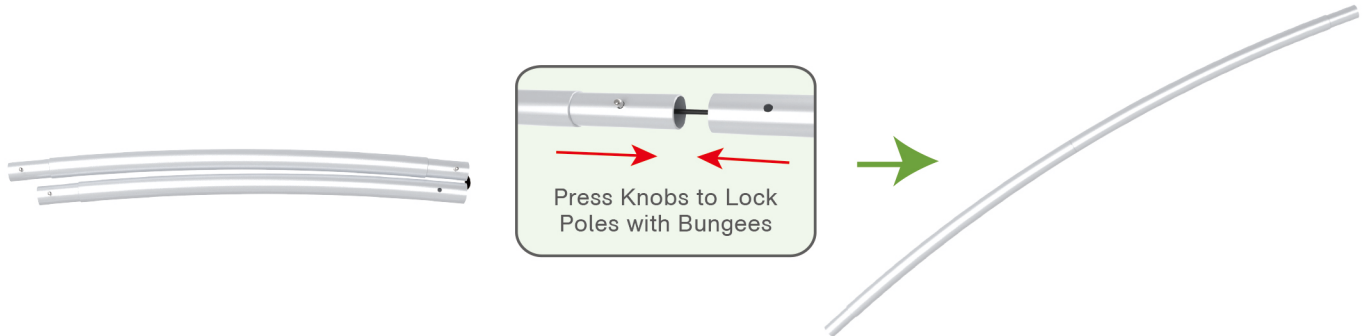
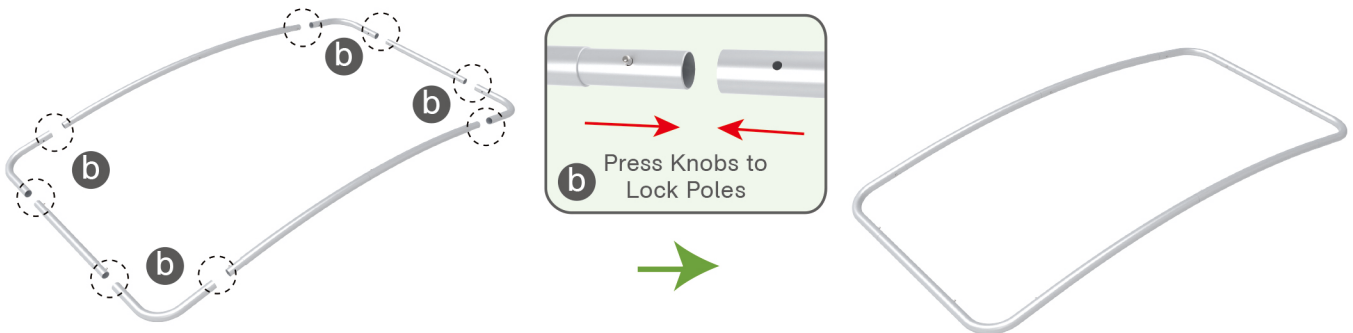
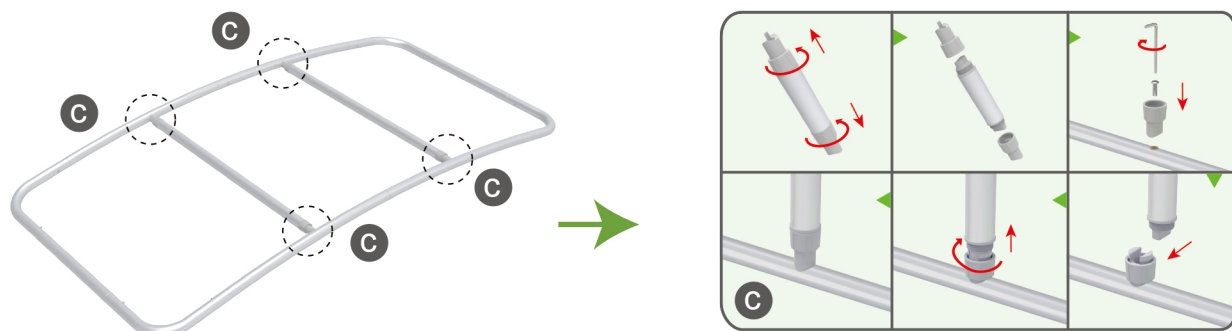

(2) Printed Graphic Fabric Banner

**STEP 01** Connect to make long poles according to labelings.**STEP 02** Connect long poles with corner poles according to labelings.**STEP 03** Connect support poles onto frame.

STEPS

STEP 04

Slide fabric banner on frame from left and zip up at right.

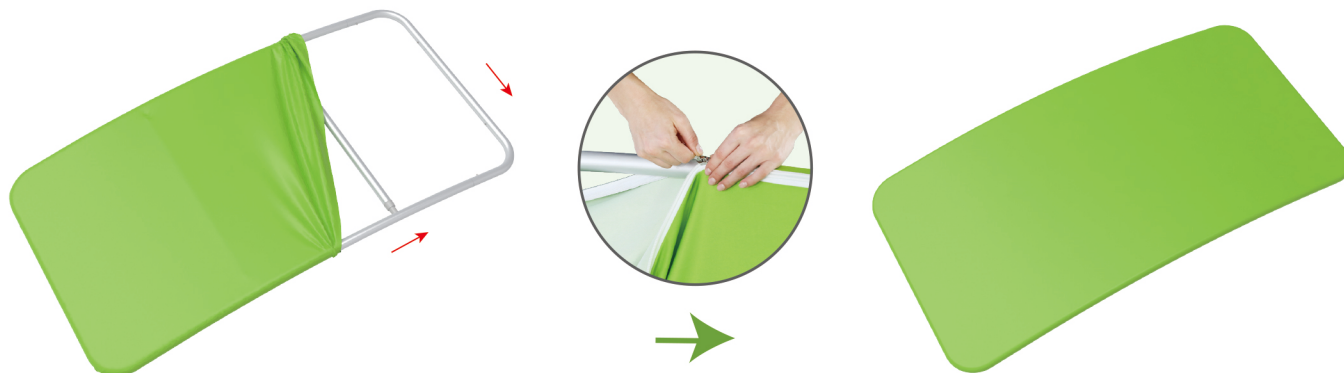

(1) Hardware

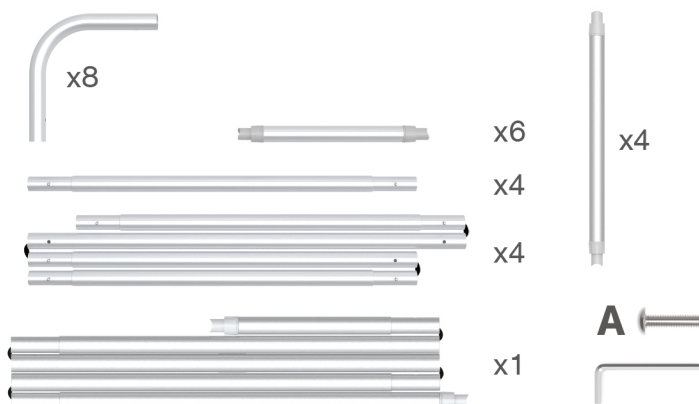

(2) Printed Graphic Fabric Banner



STEP 01

Connect to make long poles according to labelings.

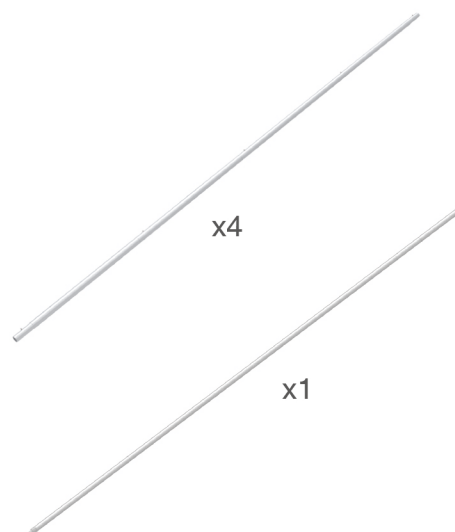
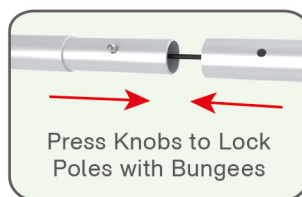

STEPS

STEP 02

Connect long poles with corner poles according to labelings.

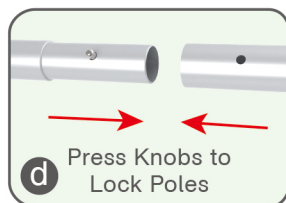
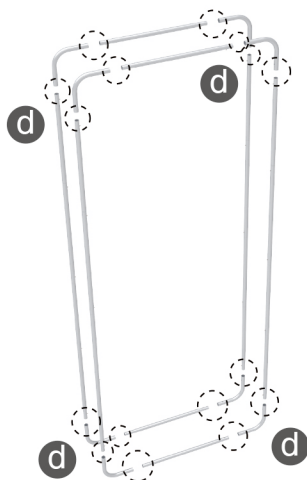

STEP 03

Connect support poles onto column frame.

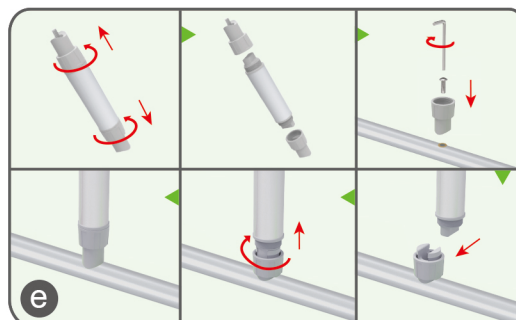
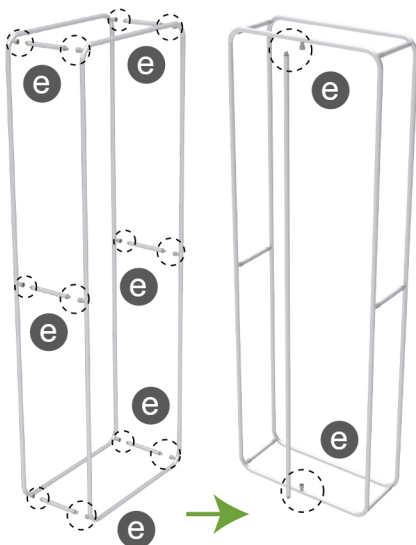

STEP 04

Slide fabric banner on frame from top and zip up at bottom.

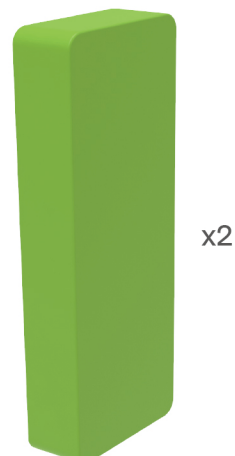
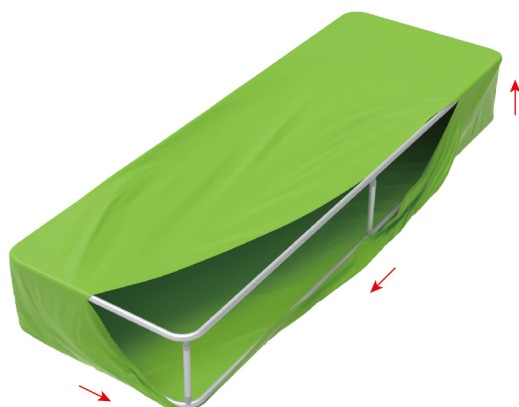

STEPS

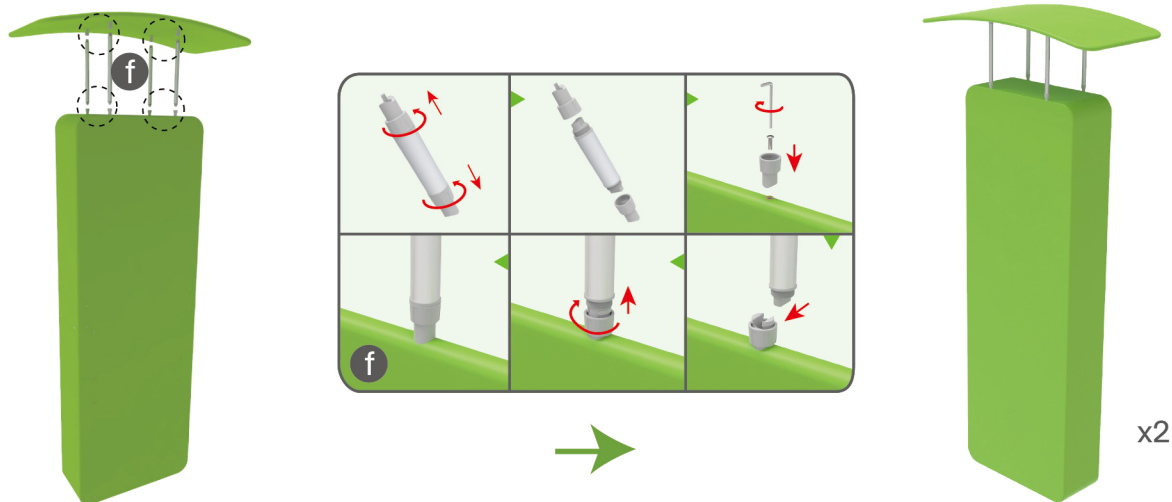
STEP 05 Connect support poles onto column frame and canopy.

(1) Hardware

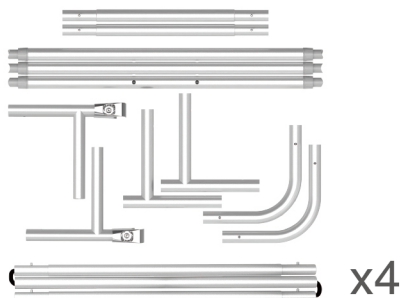

(2) Graphic printing fabric banner

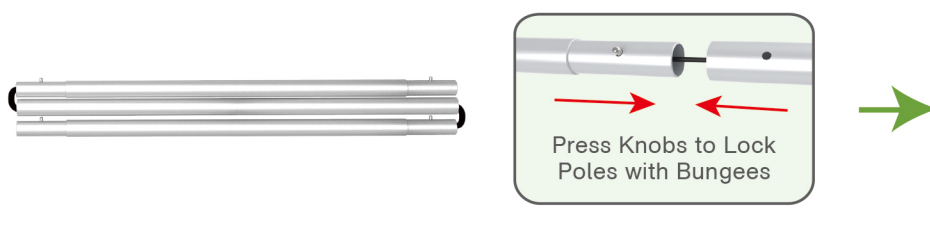
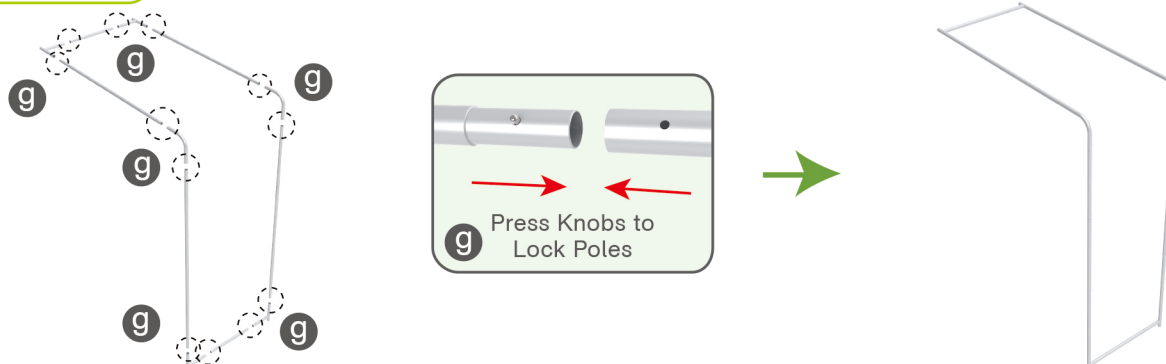
**STEP 01** Connect to make long poles according to labelings.**STEP 02** Connect long poles with corner poles according to labelings.

STEPS

STEP 03

Connect support poles onto frame.

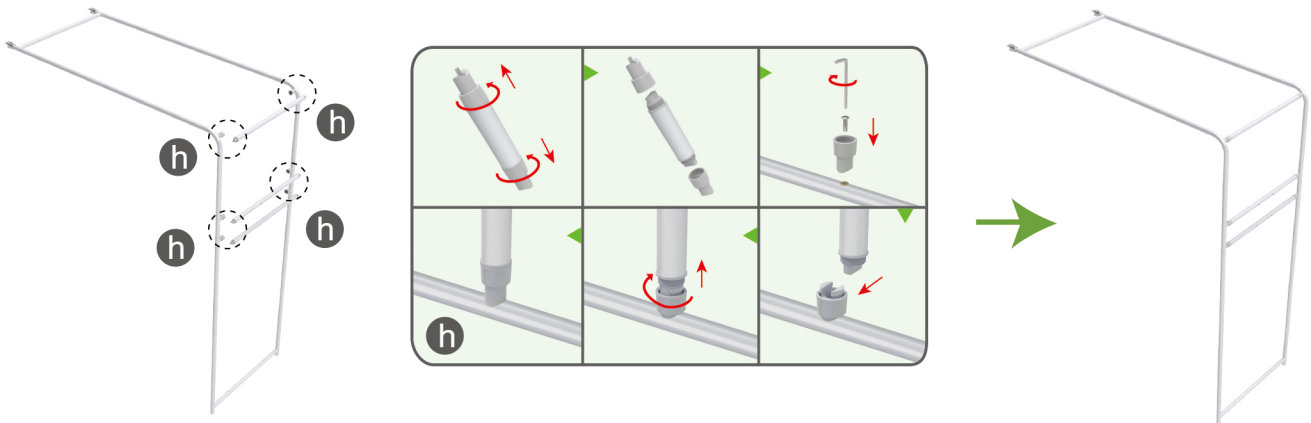

STEP 04

Slide fabric banner on frame from top and zip up at bottom.

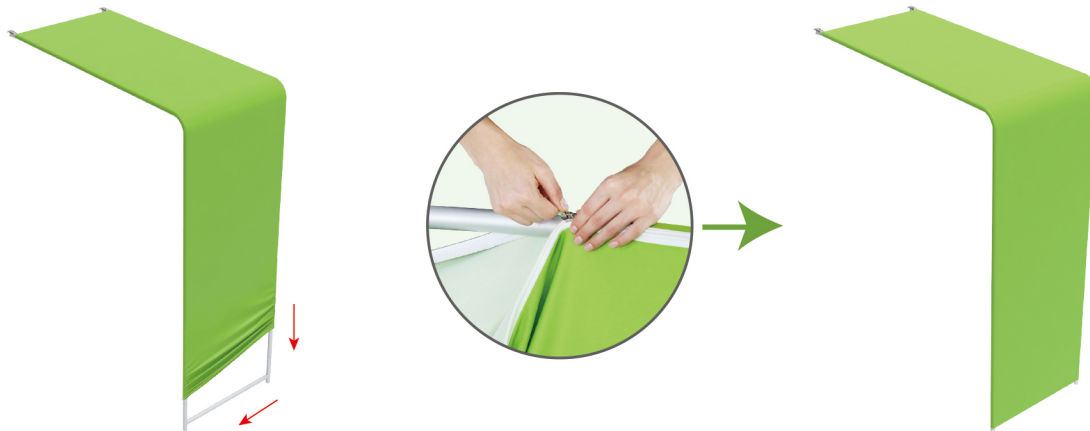

Booth Set Assembly

(1) Base

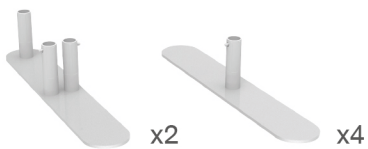

(2) TV Mount & Screw

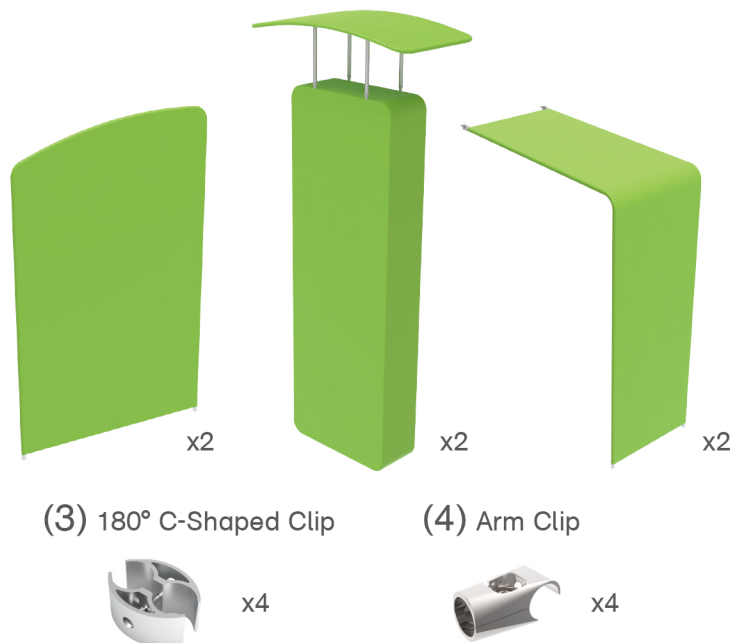
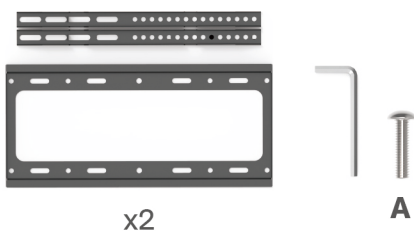

STEPS

STEP 01

Insert display stands onto feet by pressing their knobs.

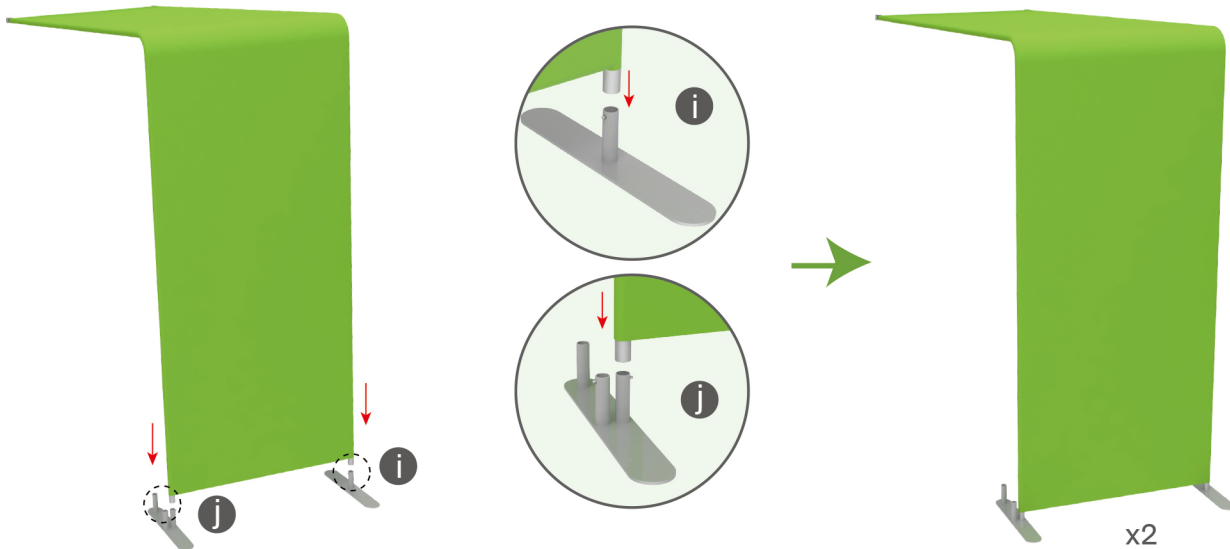

STEP 02

Connect display stands with arm clips.

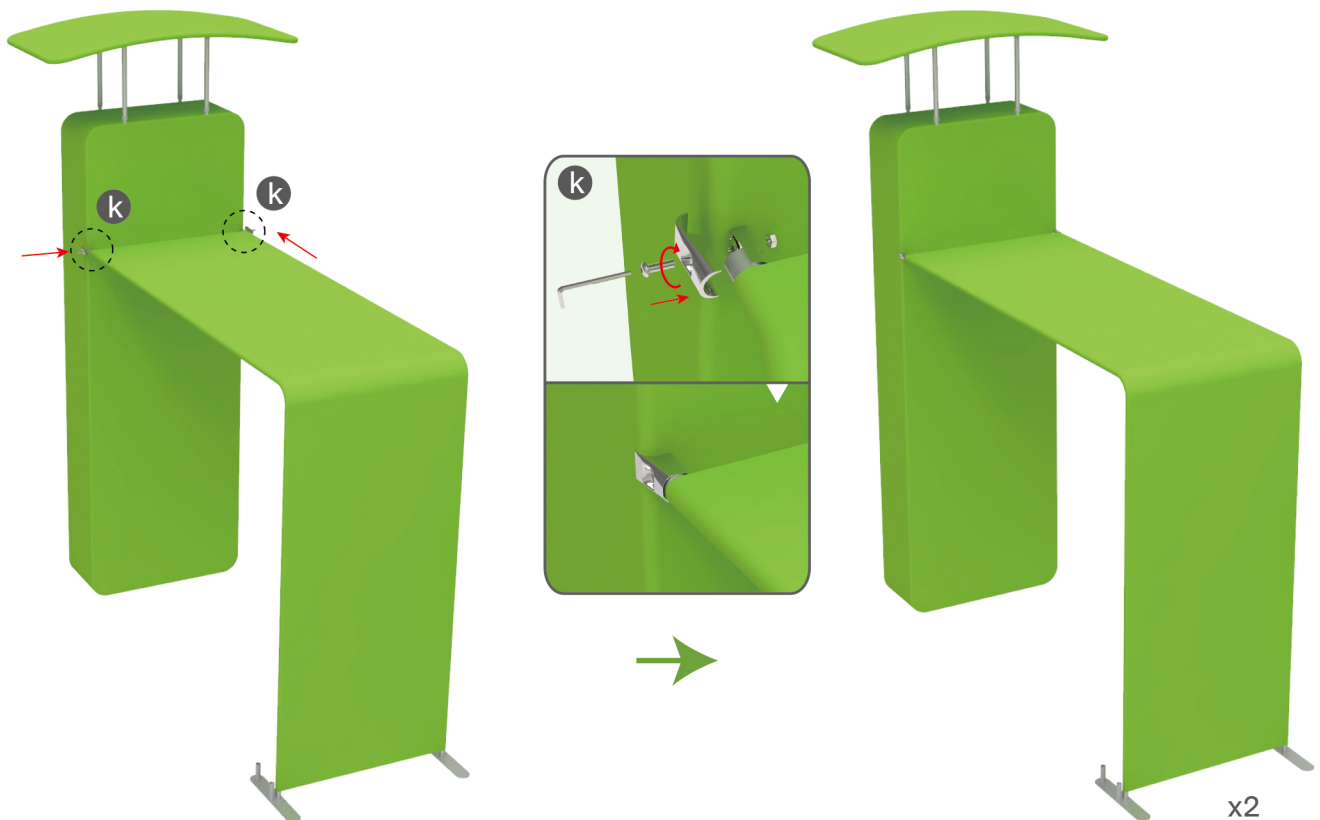

STEPS

STEP 03

Insert display stands onto feet by pressing their knobs.

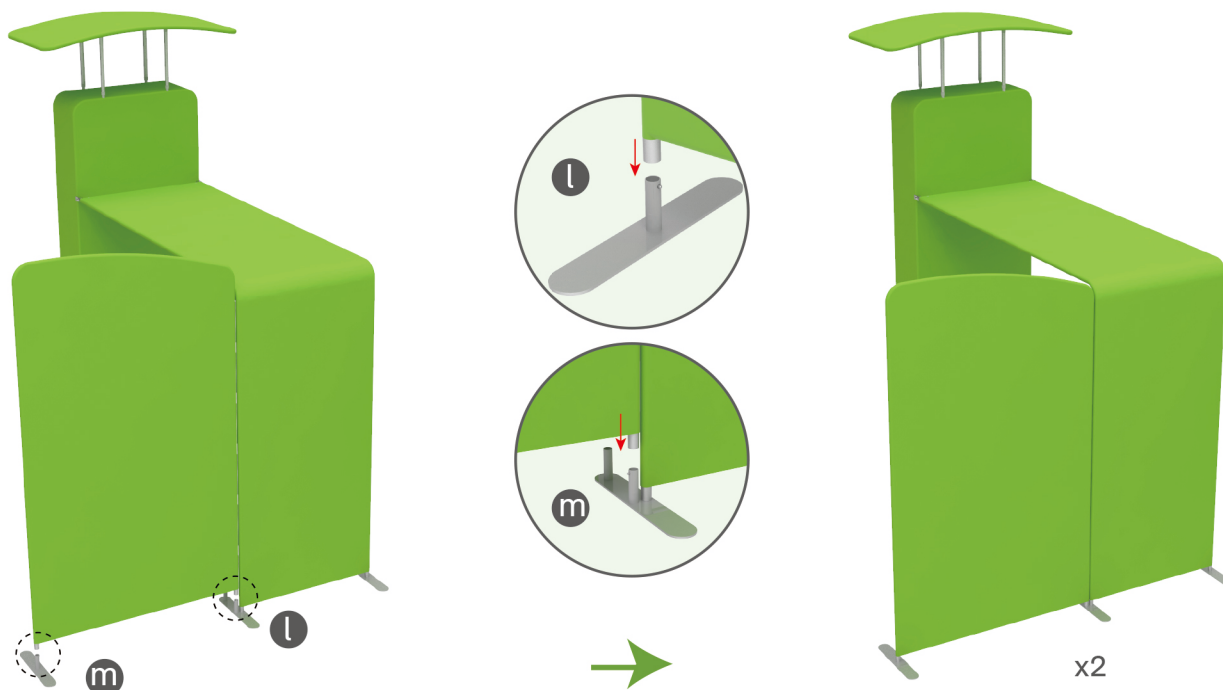

STEP 04

Interconnect display stands with C-shaped clips.

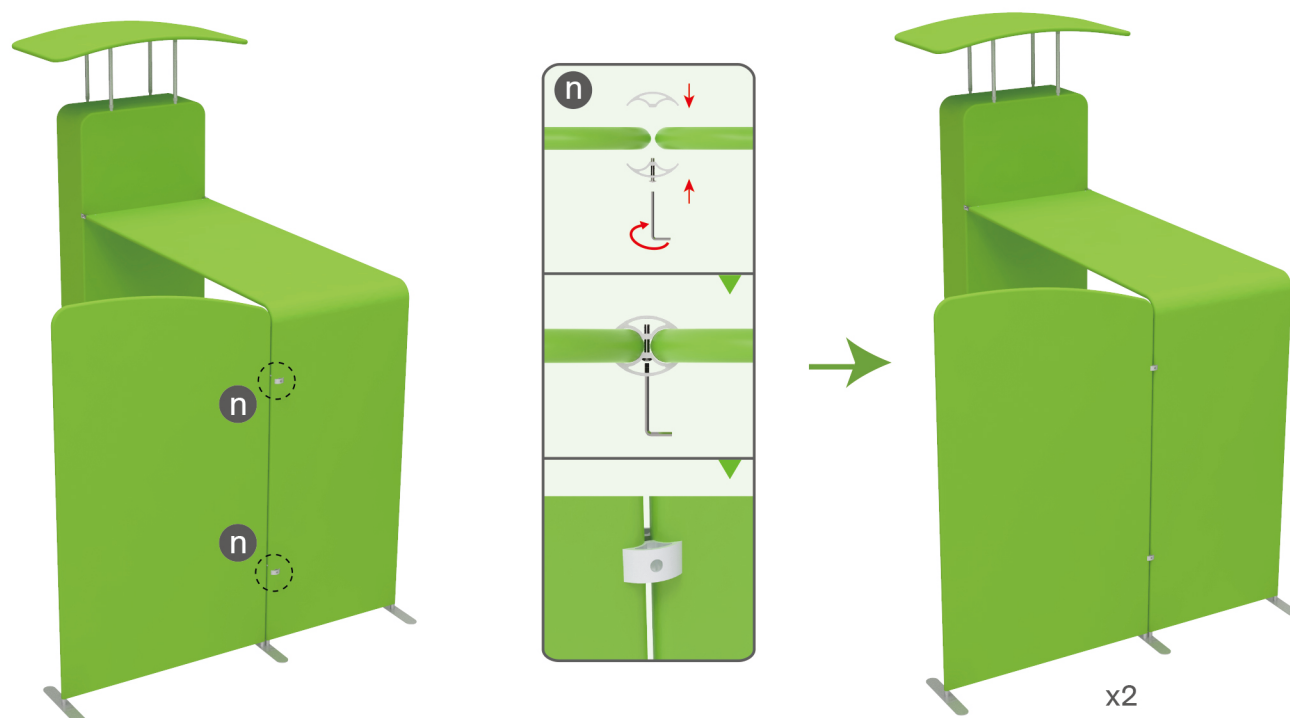

STEPS

STEP 05

Insert pole into base, screw clamp with hex wrench, place MDF board onto pole & insert into clamp with screw.

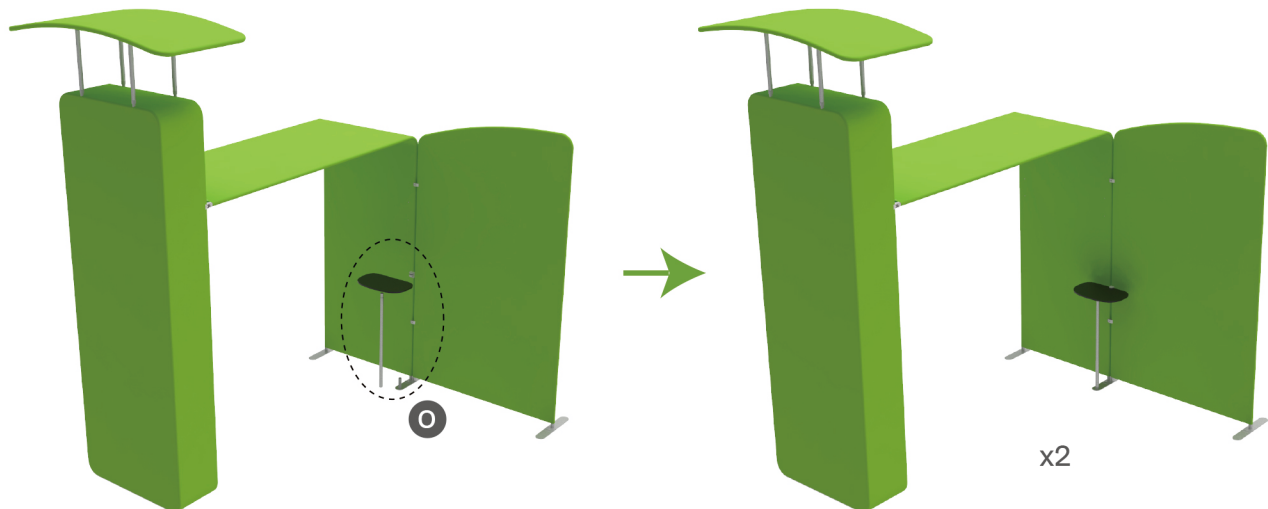
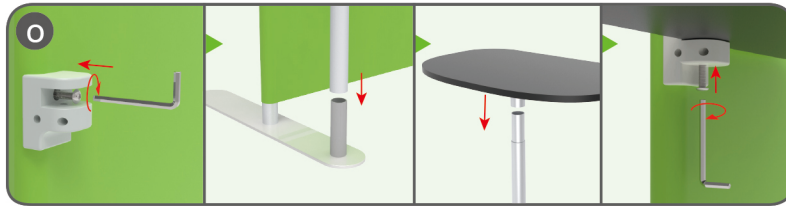

STEP 06

Screw TV mount with hex wrench.

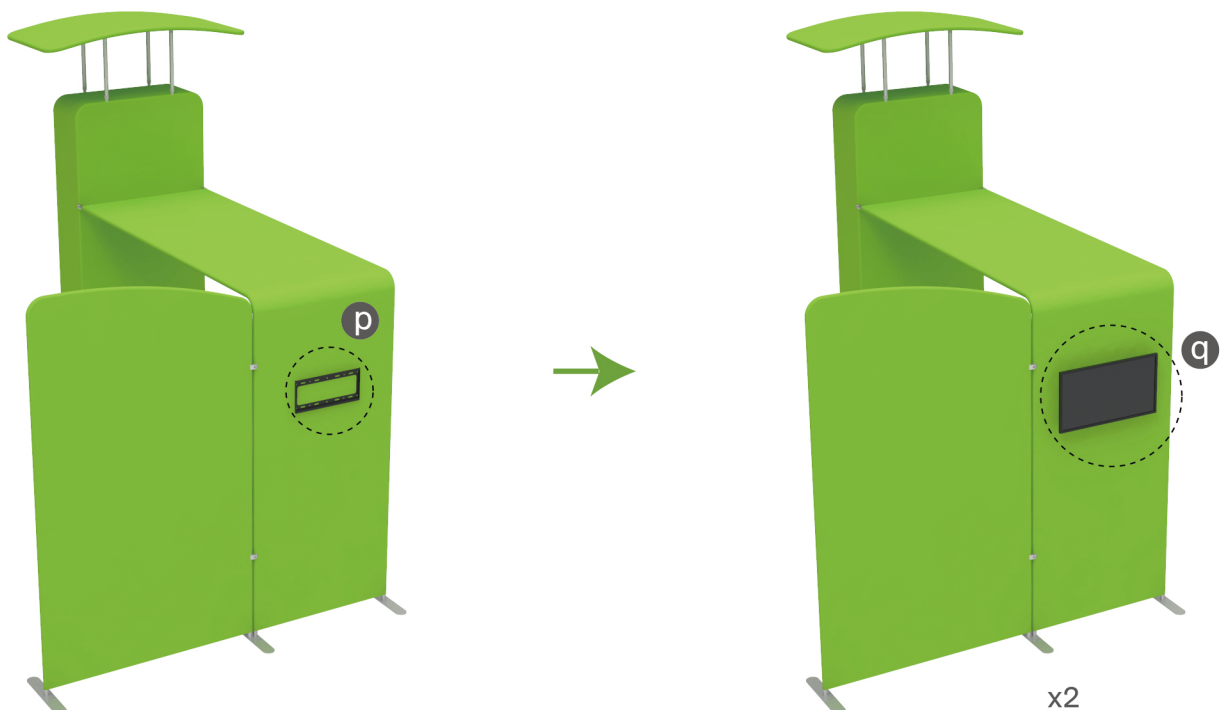

STEPS

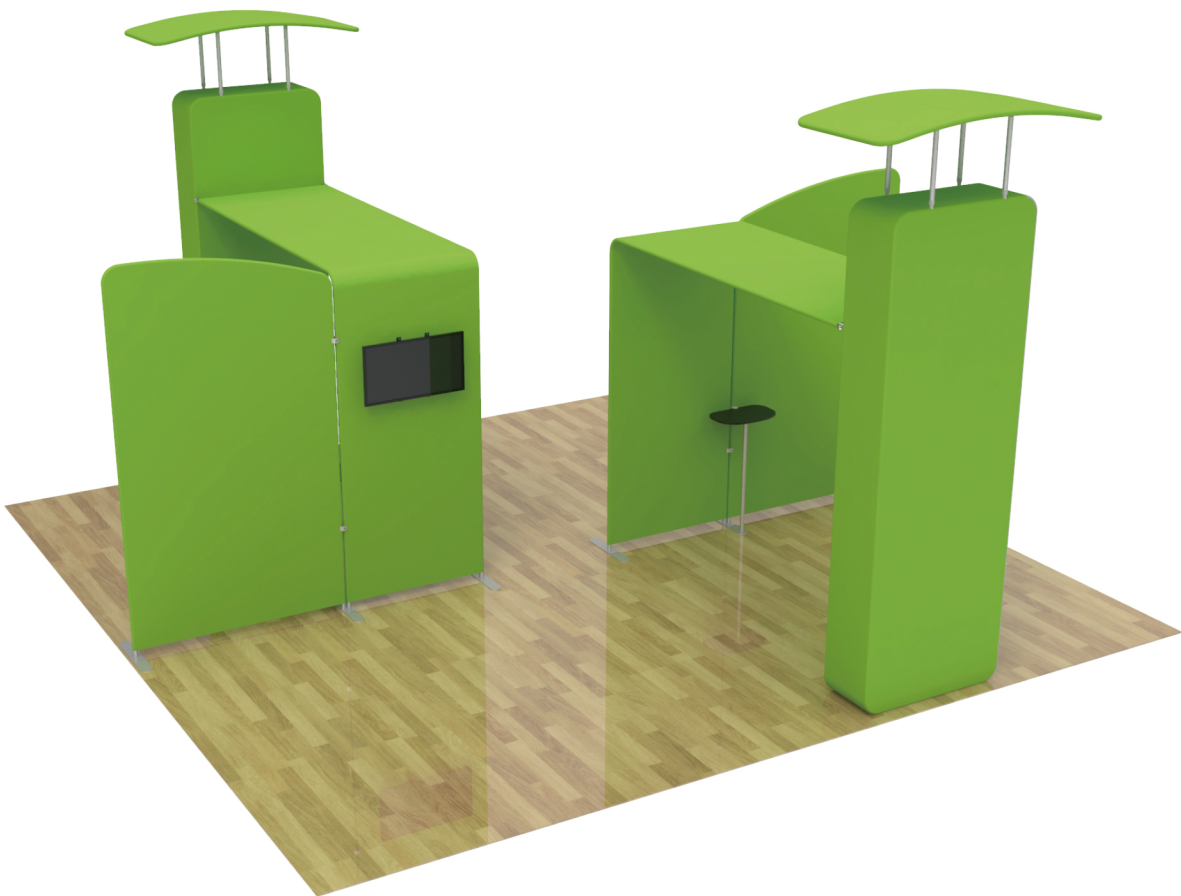
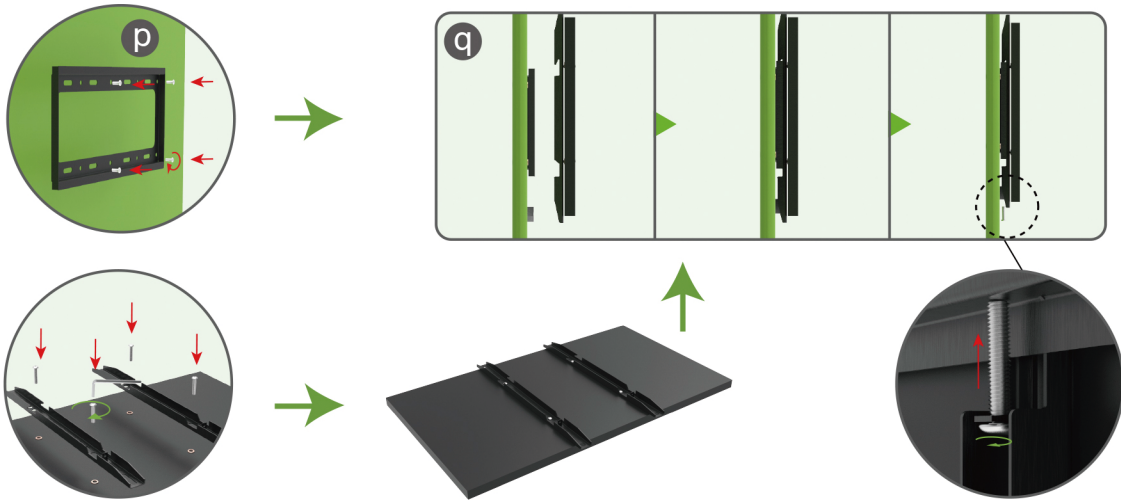

20X20FT-BOOTH-07