

STEPS**(1) Hardware****(2) Printed Graphic Fabric Banner****STEP 01**

Connect to make long poles according to labelings.

**STEP 02**

Connect long poles with corner poles according to labelings.

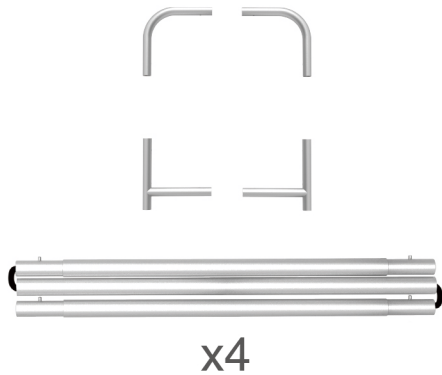
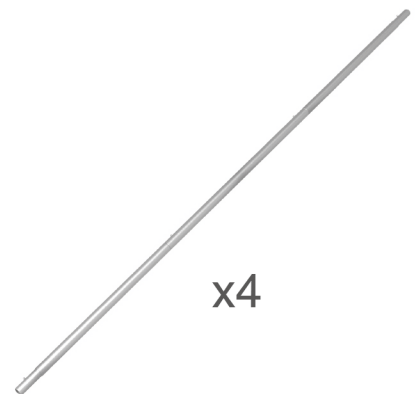
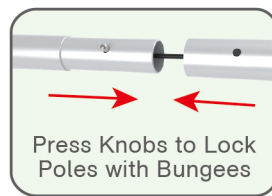
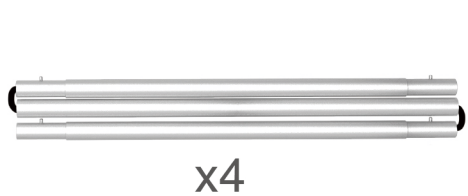
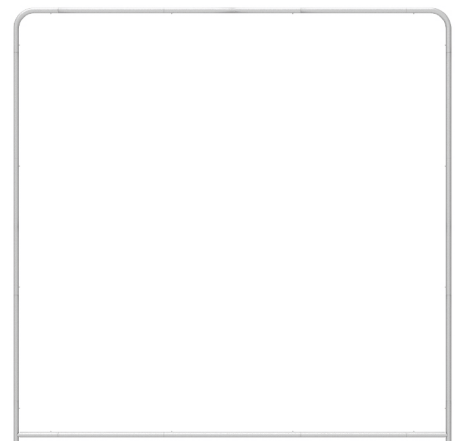
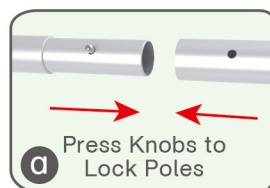
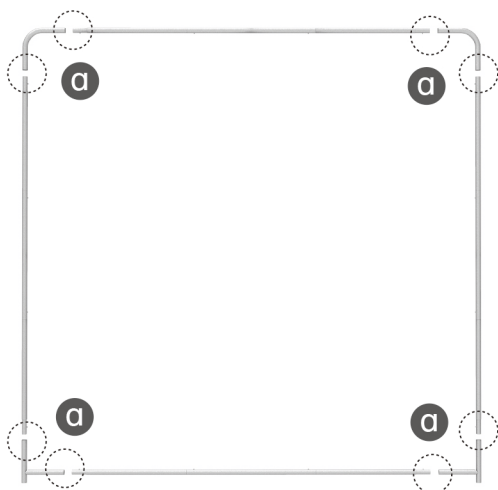

STEPS

STEP 03

Slide fabric banner on frame from top and zip up at bottom.

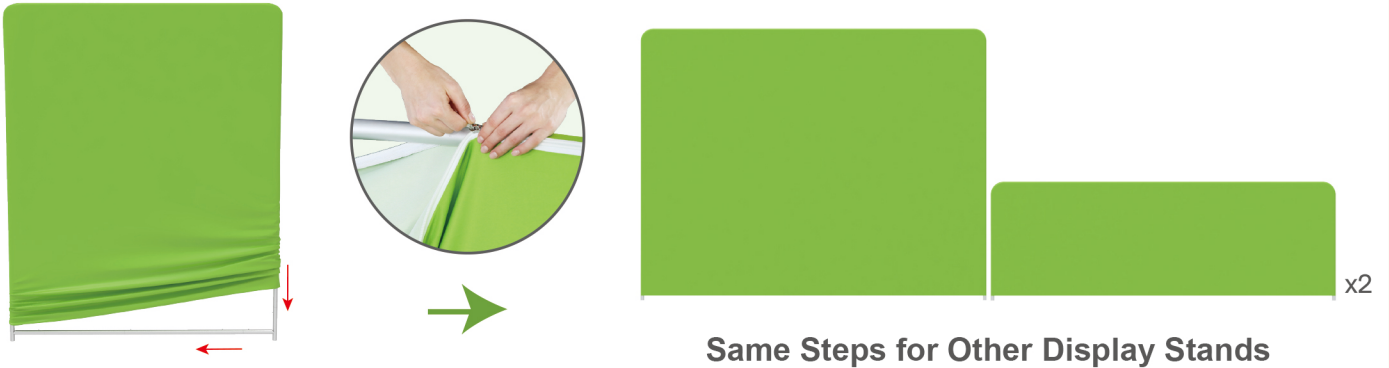

Booth Set Assembly

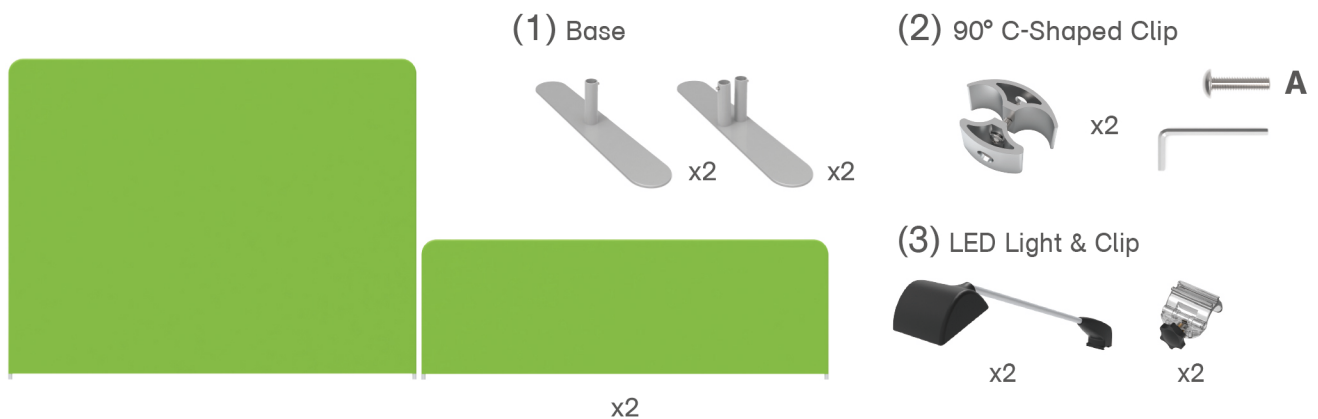

STEP 01

Insert display stands onto feet by pressing their knobs.

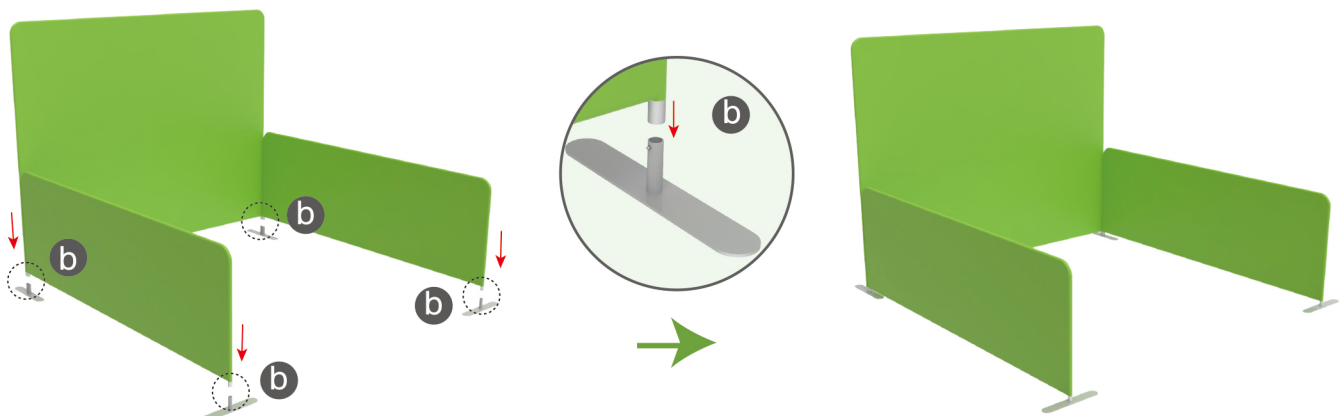

STEPS

STEP 02

Interconnect display stands with C-shaped clips.

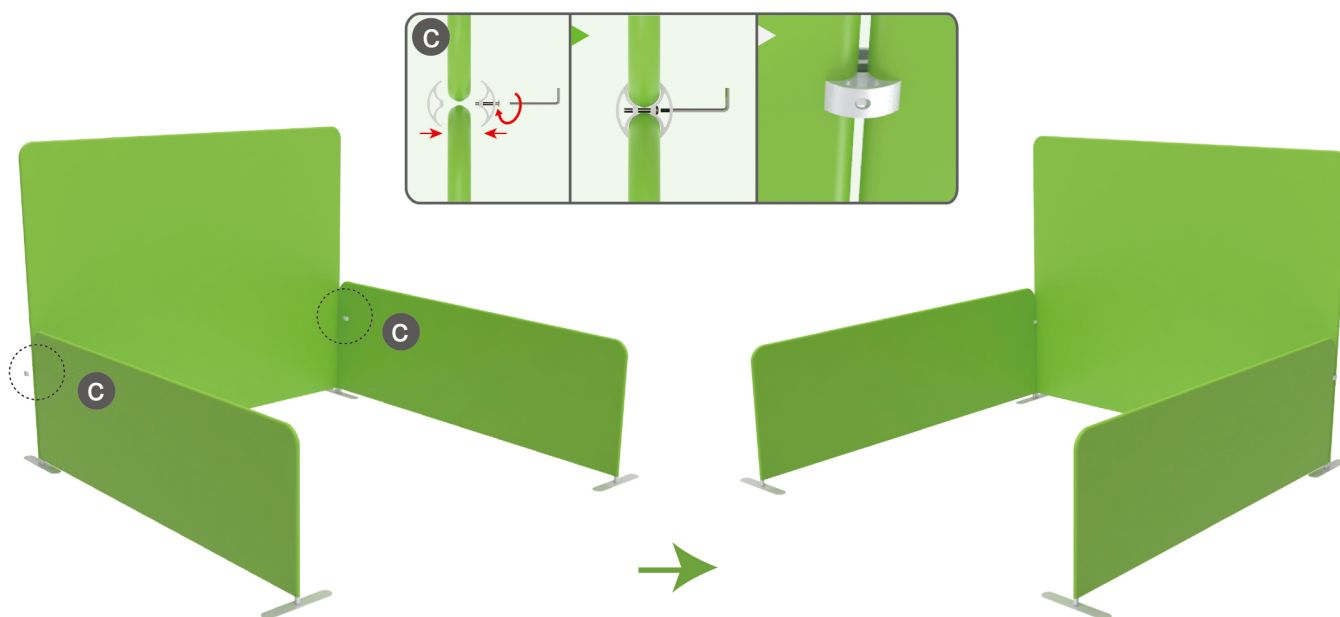

STEP 03

Screw light clips at top of display stands, slide lights onto them and adjust their direction.

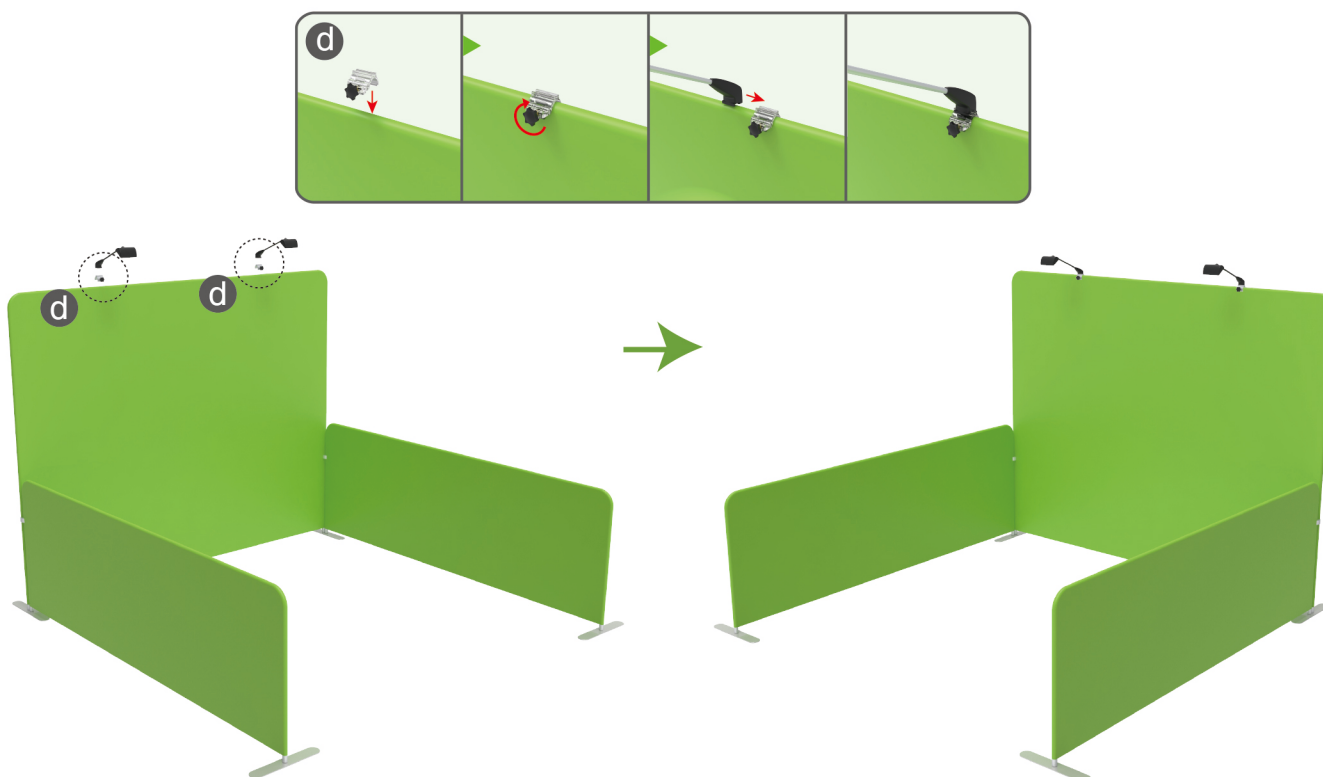

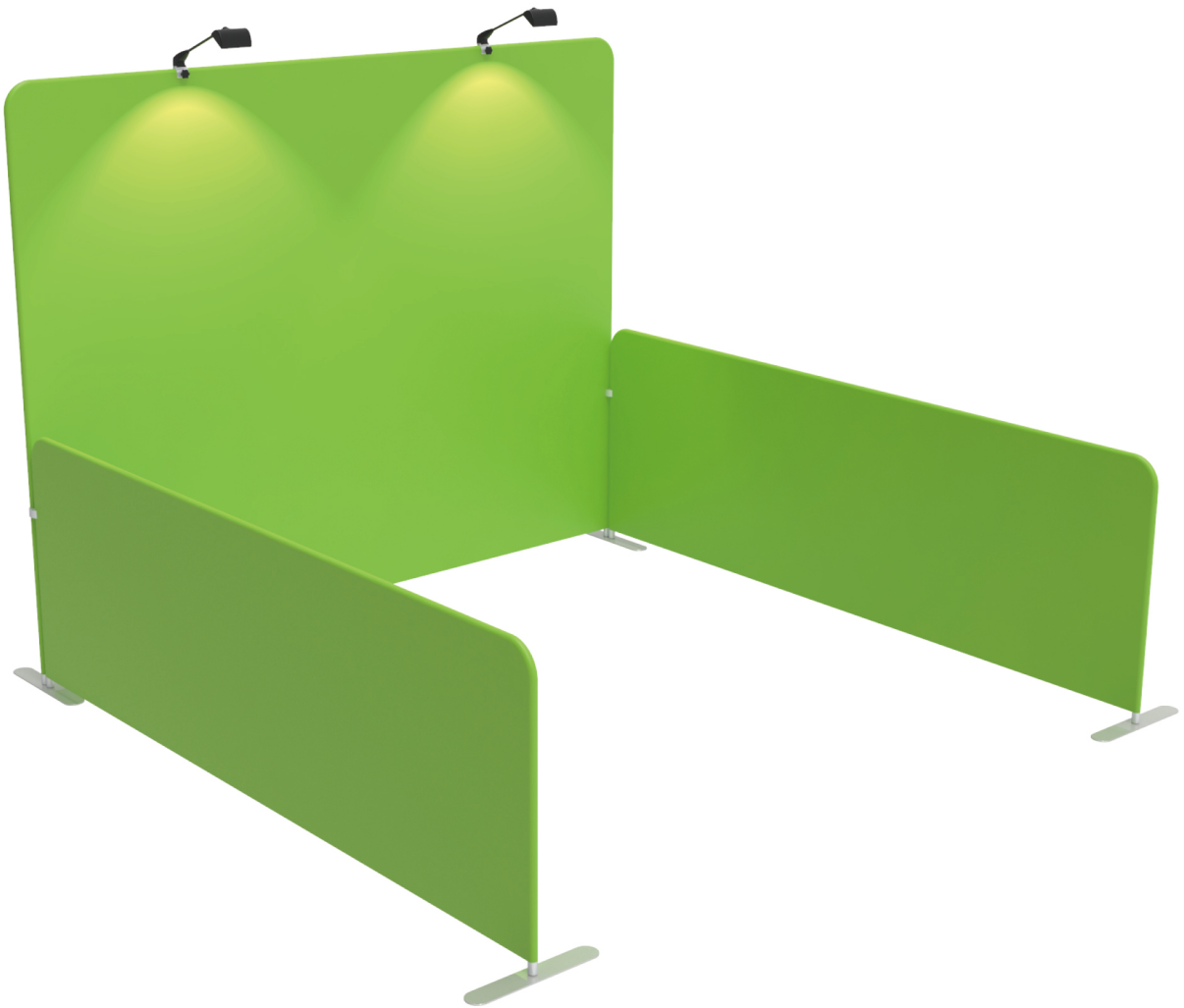
STEPS**10X10FT-BOOTH-01**