

STEPS

(1) Hardware

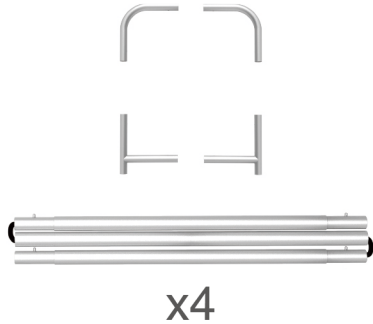

(2) Printed Graphic Fabric Banner



STEP 01

Connect to make long poles according to labelings.

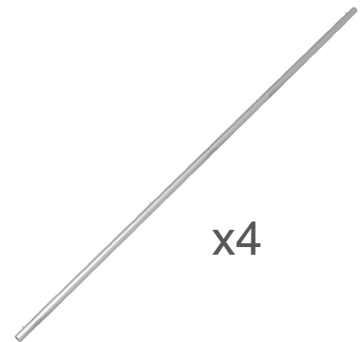
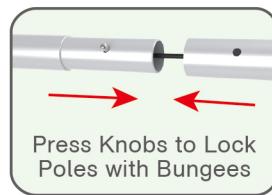
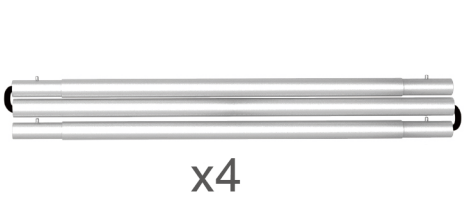

STEP 02

Connect long poles with corner poles according to labelings.

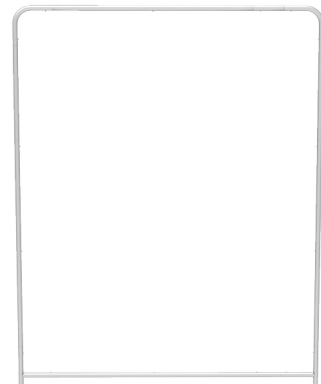
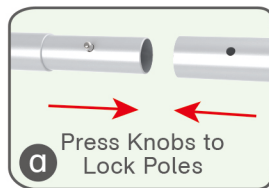
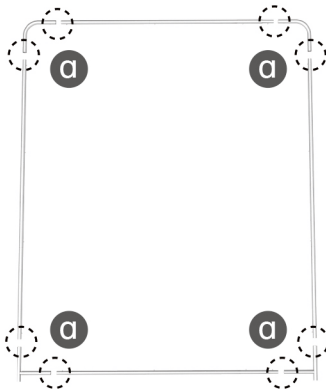

STEP 03

Slide fabric banner on frame from top and zip up at bottom.



Same Steps for Other Display Stands

STEPS

(1) Hardware



(2) Printed Graphic Fabric Banner



STEP 01

Connect poles according to labelings.

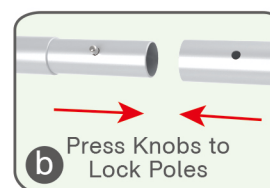
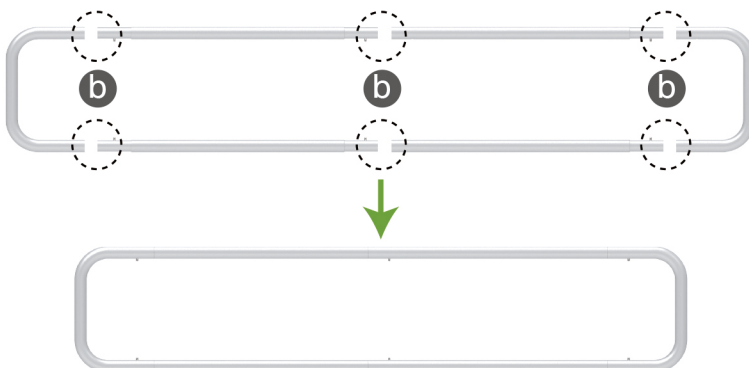

STEP 02

Slide fabric banner on frame from left and zip up at right.

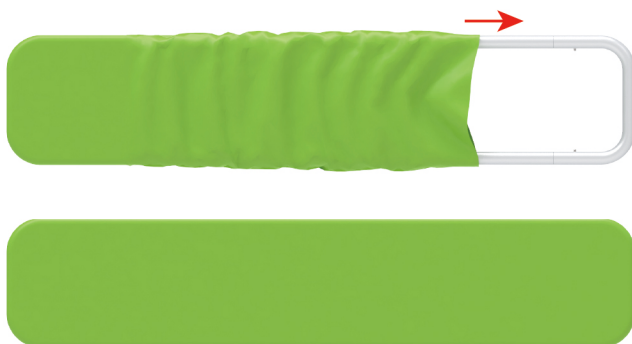

Booth Set Assembly



(3) 90° C-Shaped Clip & 180° C-Shaped Clip

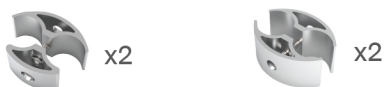

(1) Base

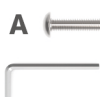
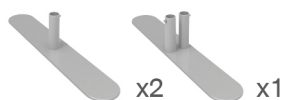

(4) LED Light & Clip



(2) Shelving Board

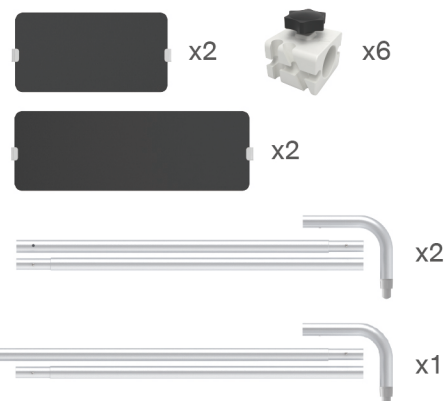

STEPS

STEP 01

Insert display stands onto feet by pressing their knobs.

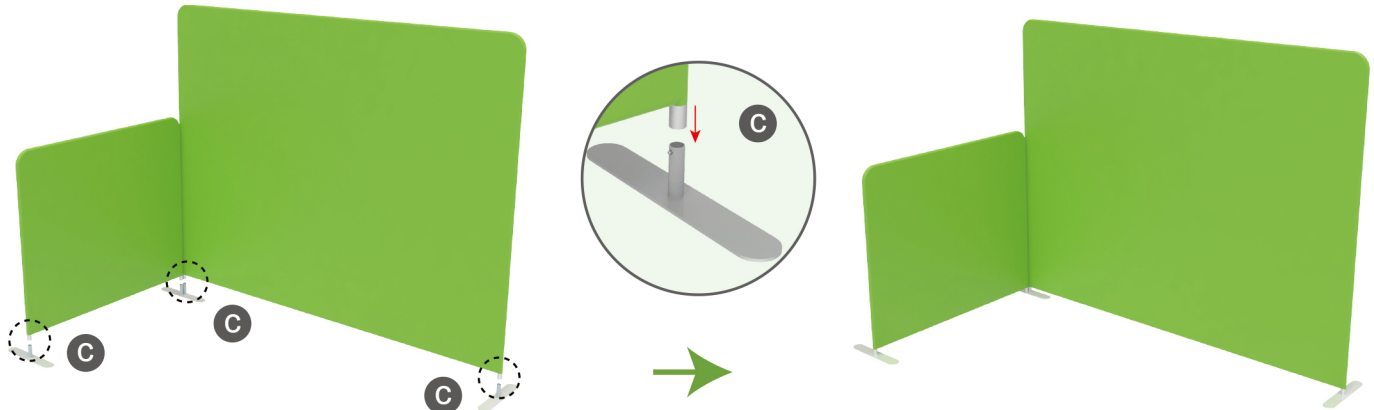

STEP 02

Interconnect display stands with C-shaped clips.

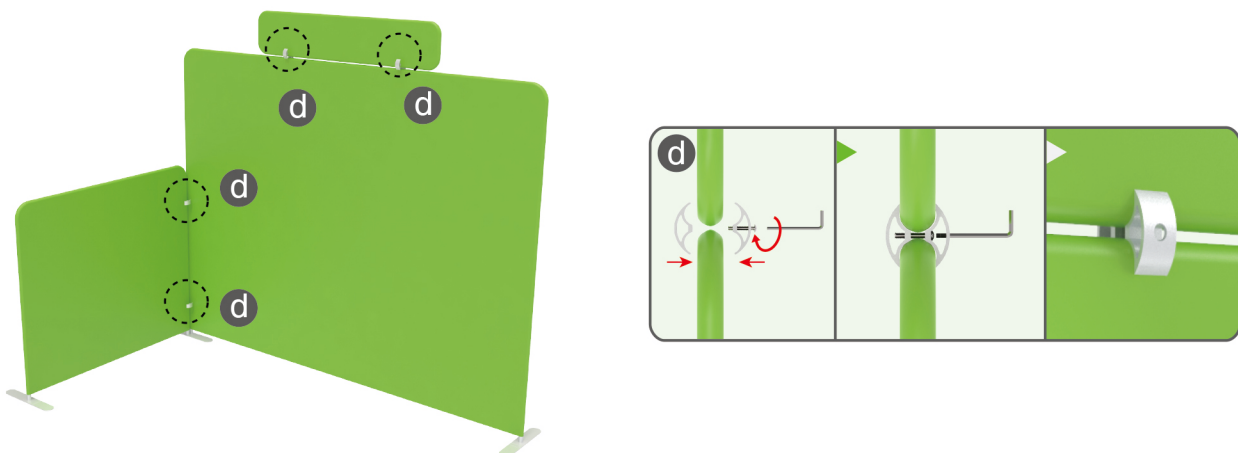

STEP 03

Connect to make long poles according to labelings, slide three-way clips onto long poles, insert short curved poles onto their top by pressing their knobs.

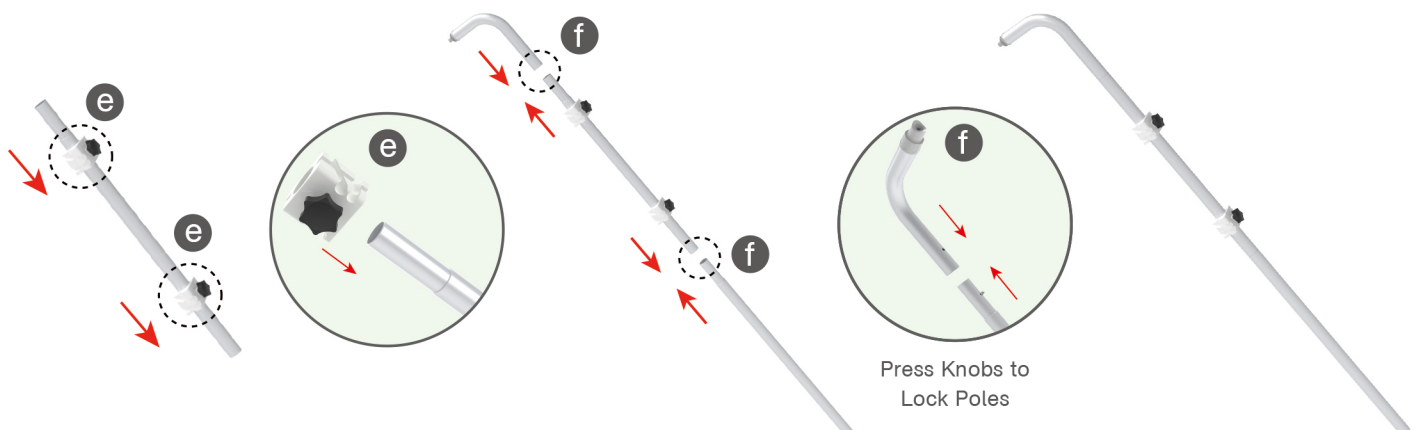

STEPS

STEP 04

Connect support poles onto frame, clip into hanging boards based on directions of three-way clips & tightening with thumb screws.

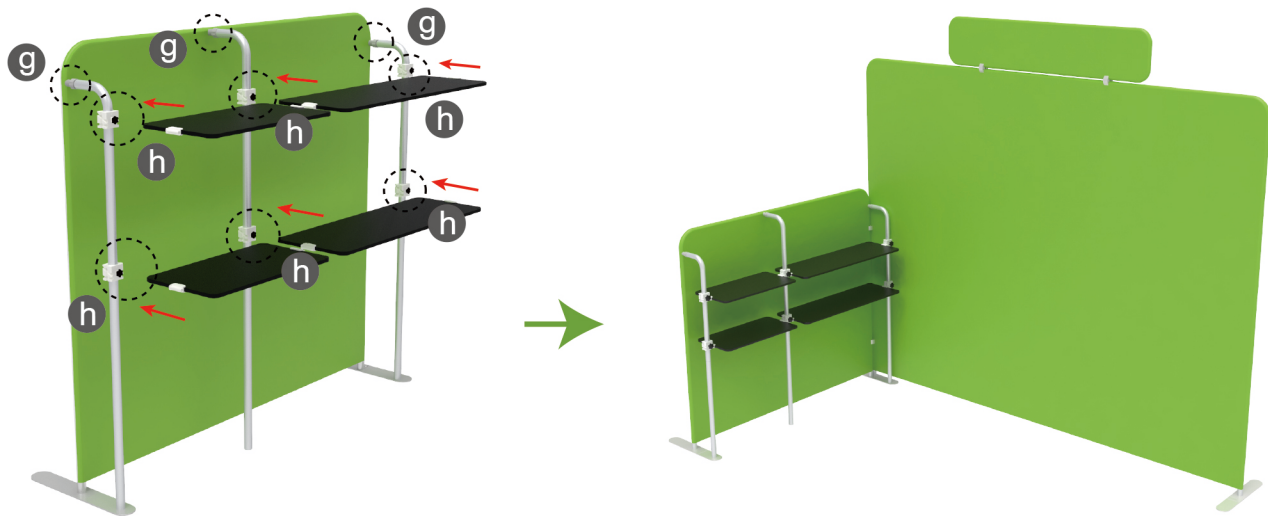
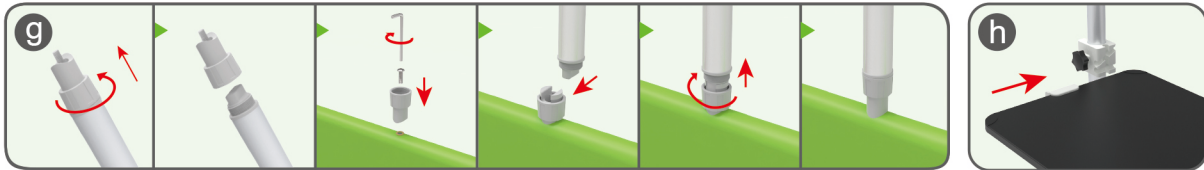

STEP 05

Screw light clips at top of display stands, slide lights onto them and adjust their direction.

