

★ One Tool (Hex Wrench) 

## STEPS

## (1) Hardware

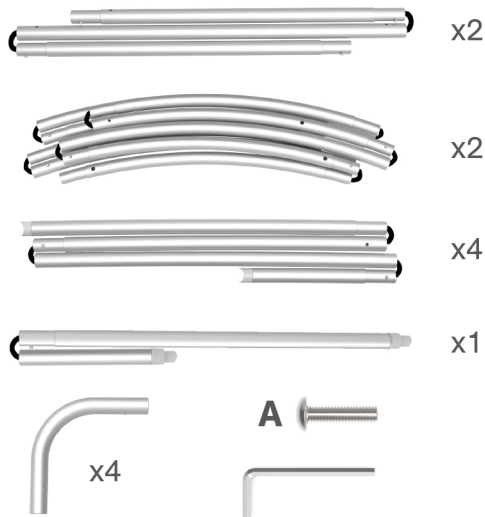

## (2) Printed Graphic Fabric Banner (Optional)

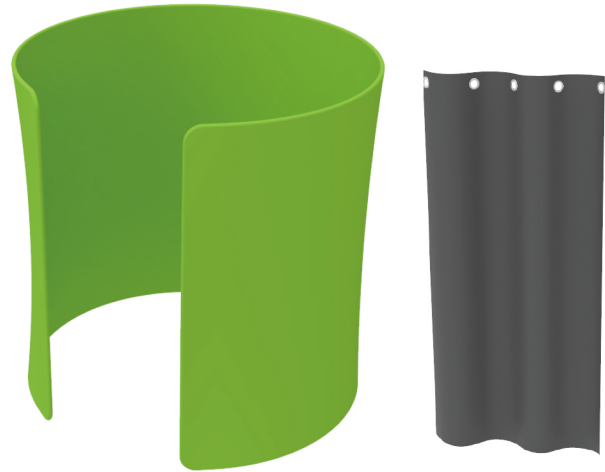

## STEP 01

Connect to make long poles according to labelings.

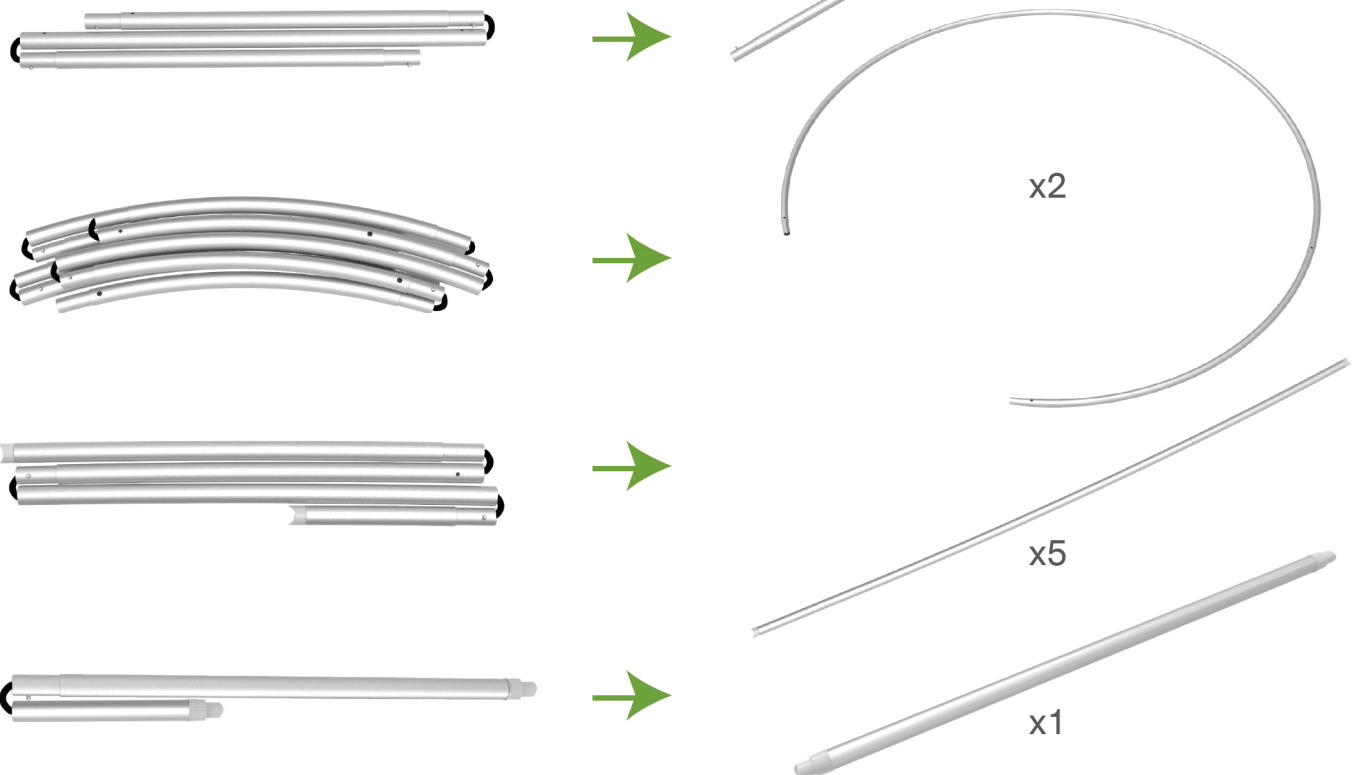
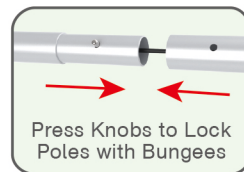

## STEPS

## STEP 02

Connect long poles with corner poles according to labelings.

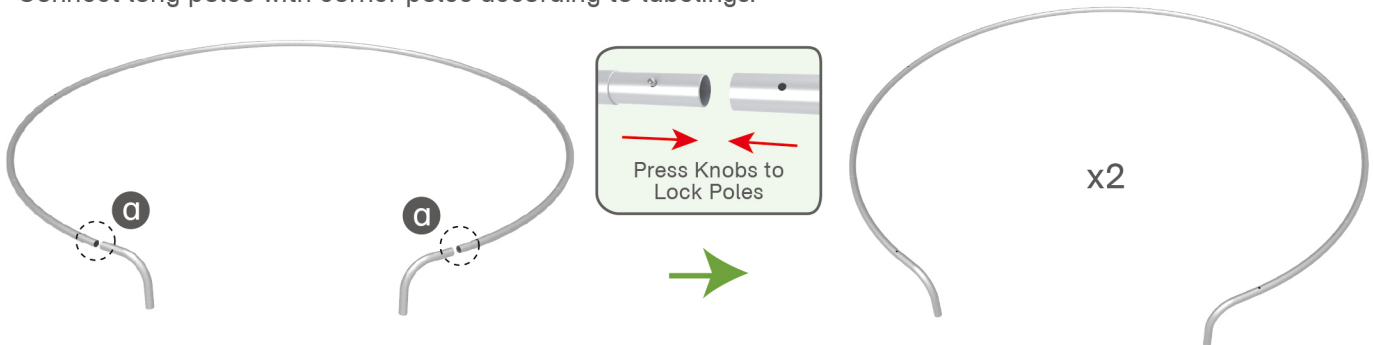

## STEP 03

Connect long poles with corner poles according to labelings.

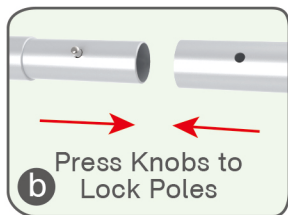
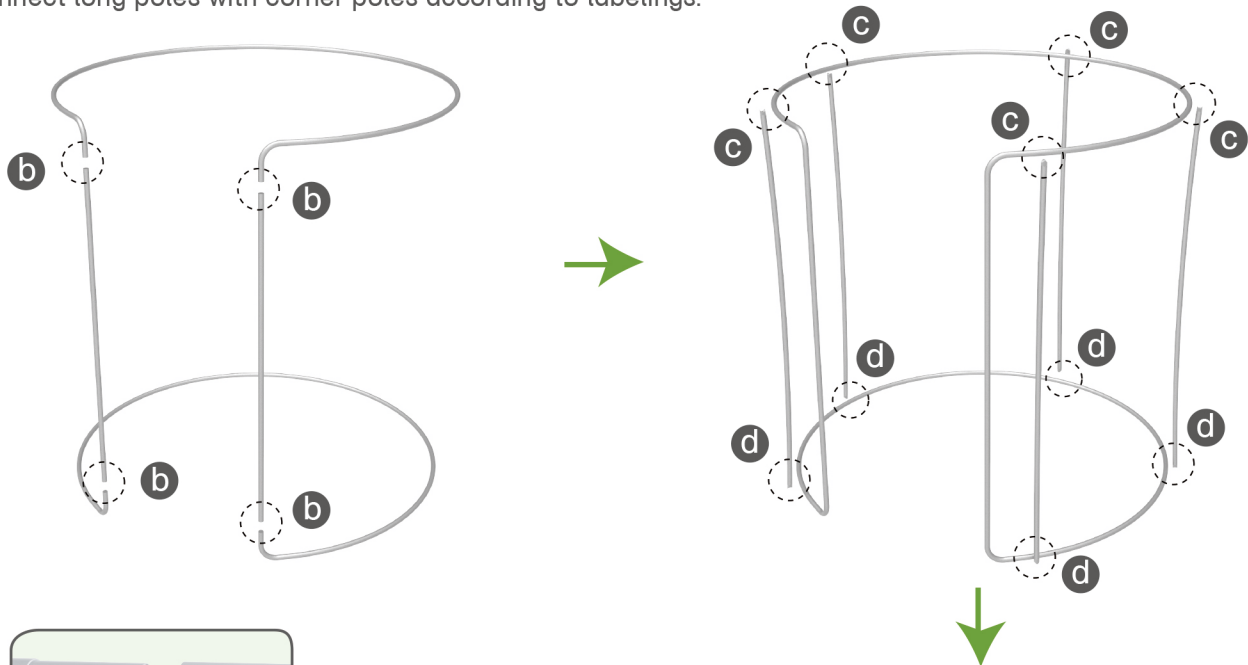

Connect support poles onto frame with screws.

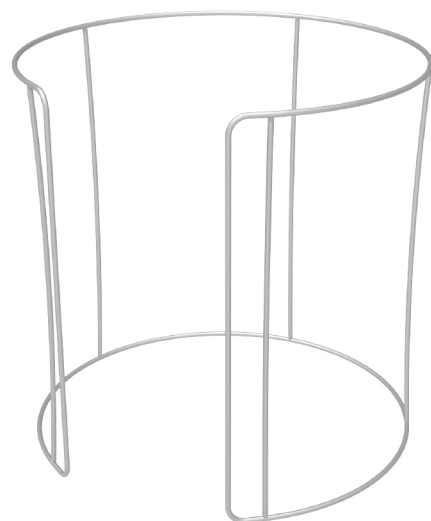
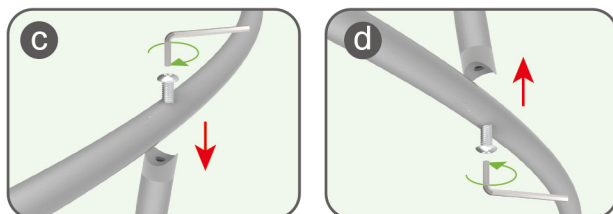

## STEPS

## STEP 04

Slide fabric banner on frame from bottom and zip up at top.

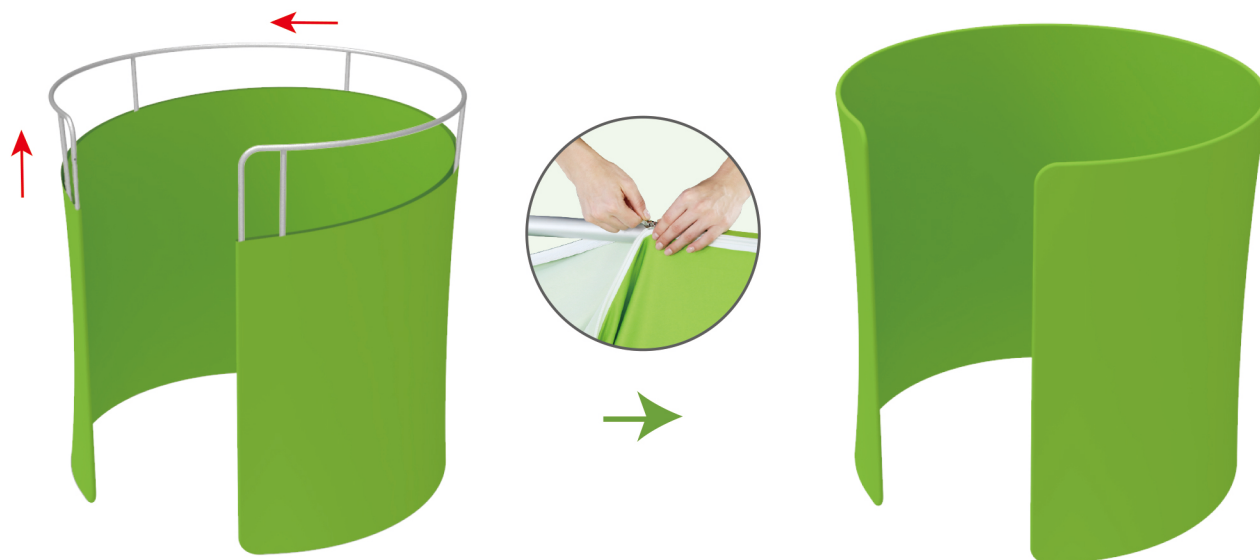

## STEP 05

① Disassemble slots from support pole.

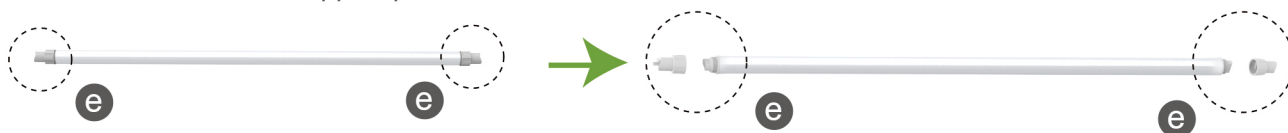

② Install slots onto enclosure.

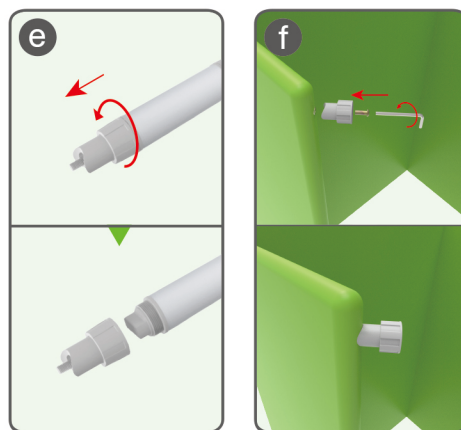

## STEPS

- ③ Slip support pole through curtain with grommets.

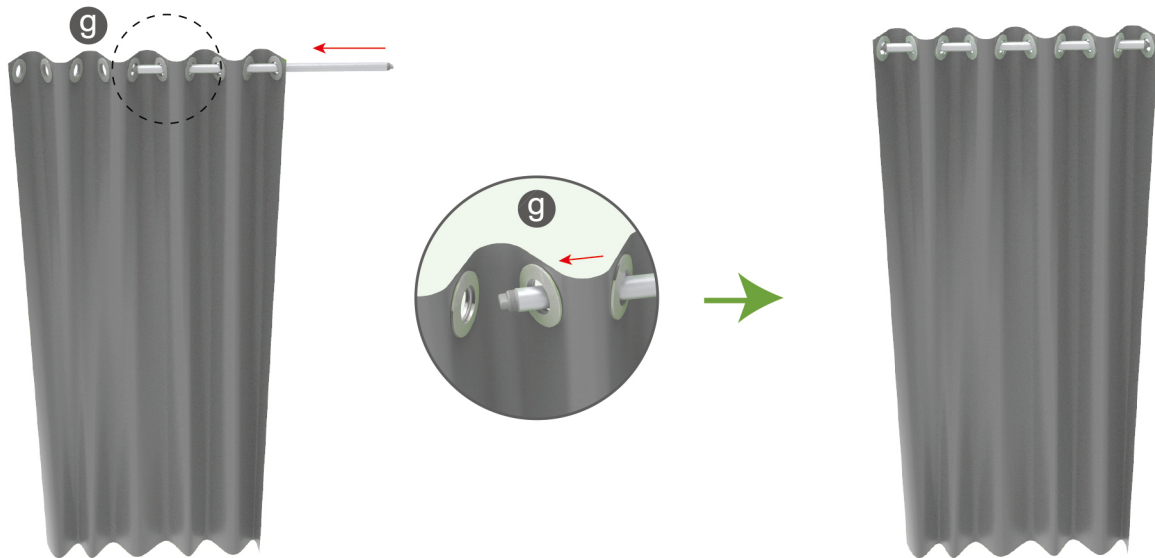

- STEP 06** Screw support pole with curtain into slots.

