

★ One Tool (Hex Wrench) 

STPES

(1) Hardware

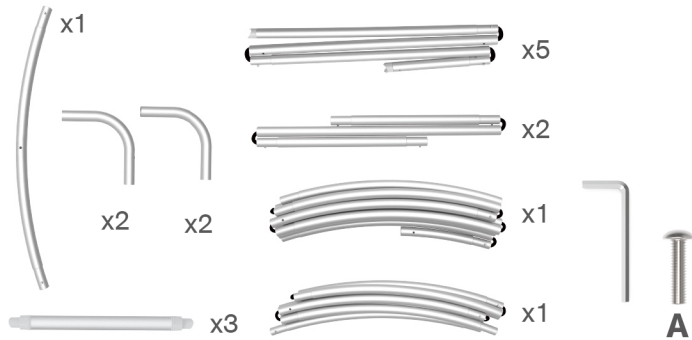

(2) Printed Graphic Fabric Banner (Optional)

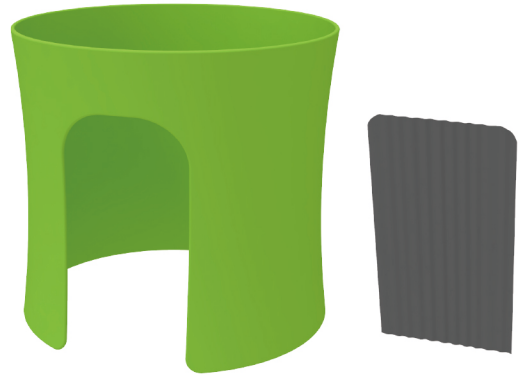

STEP 01

Connect to make long poles according to labelings.

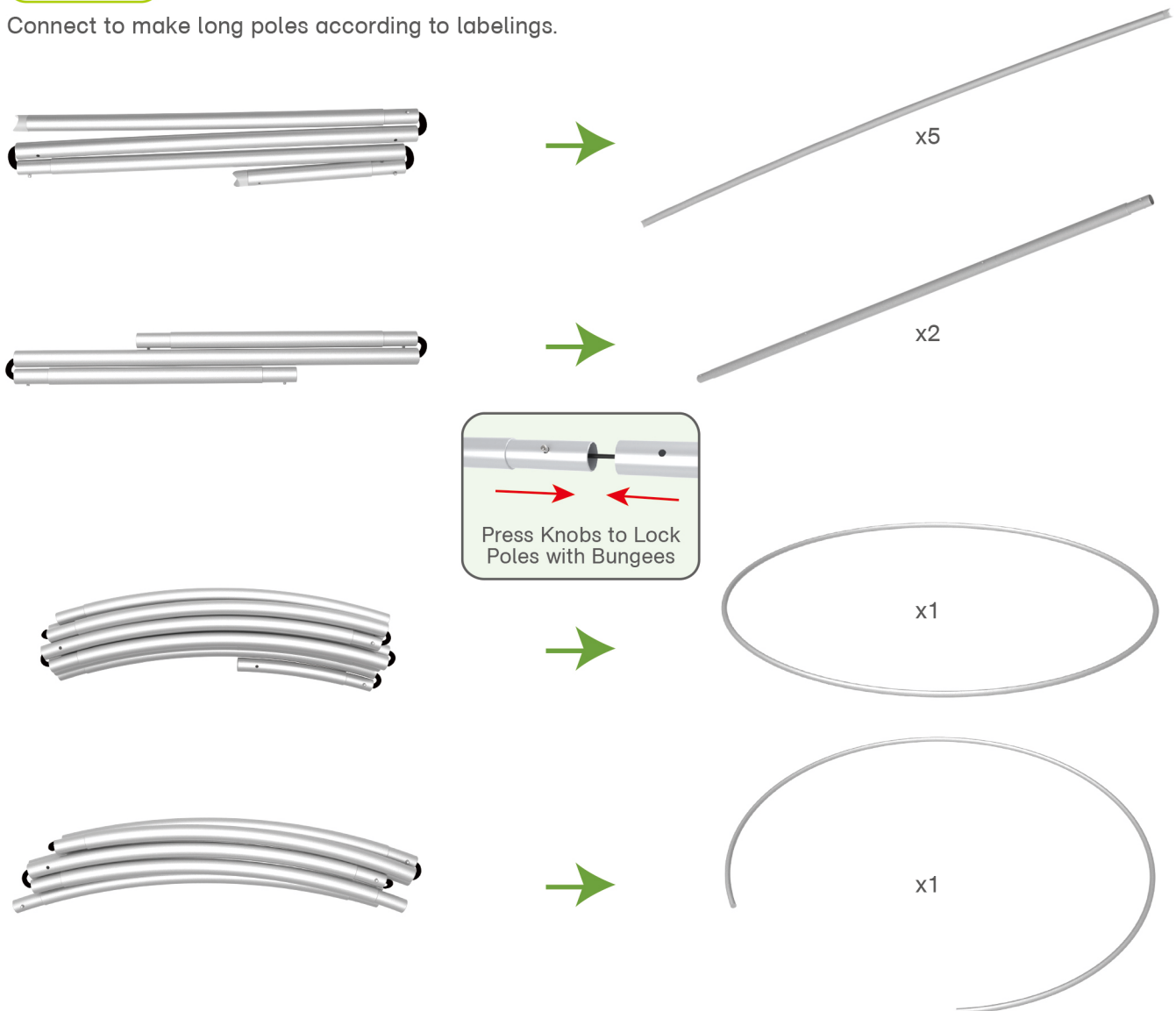

STPES

STEP 02

Connect long poles with corner poles according to labelings.

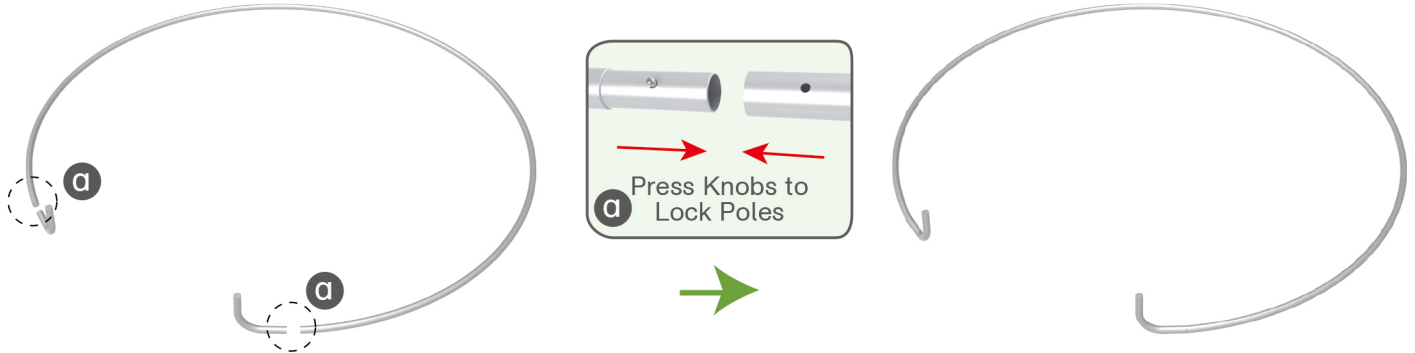

STEP 03

Connect support poles onto frame with screws.

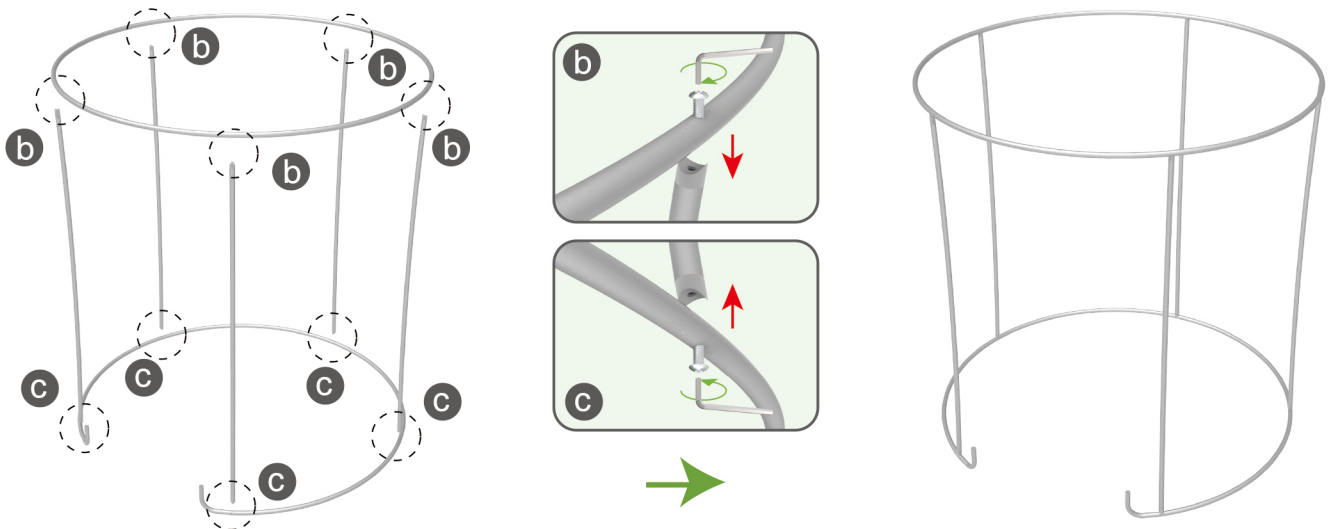

STEP 04

Connect long poles with corner poles according to labelings.

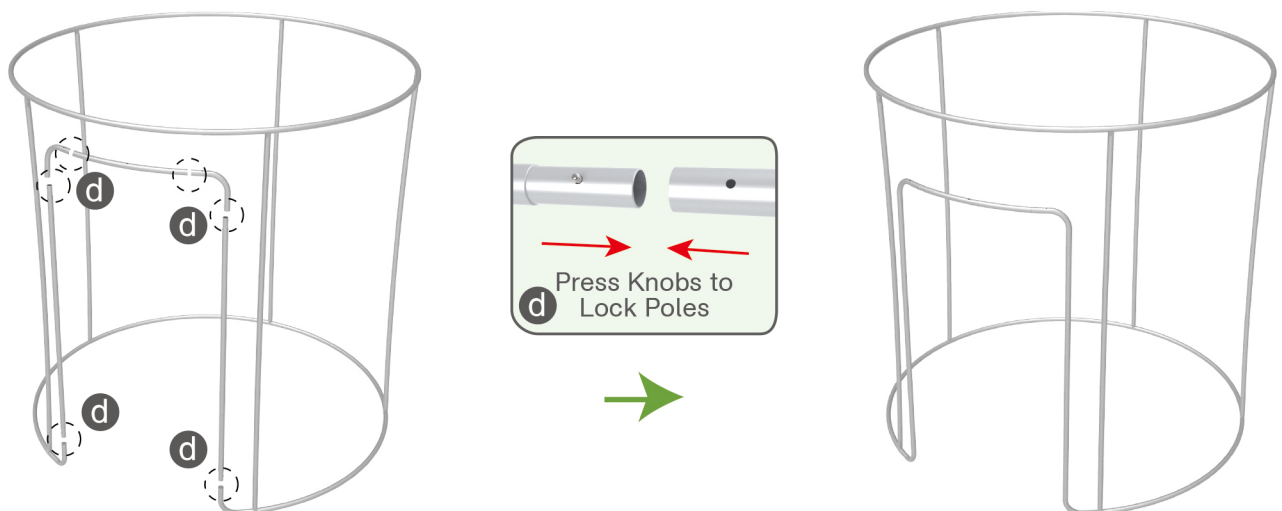

STPES

STEP 05

Connect support poles onto frame.

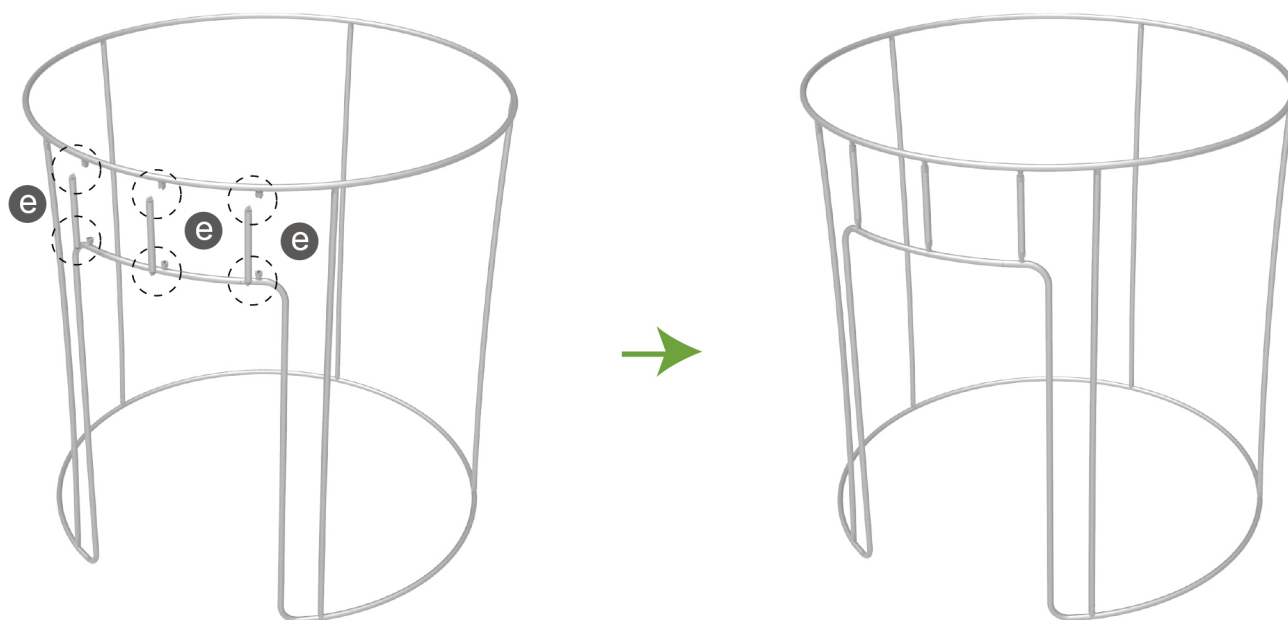
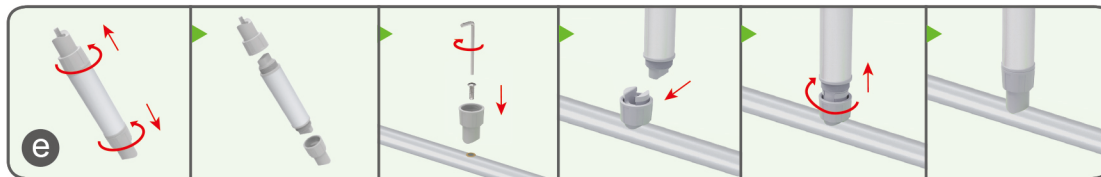

STEP 06

Slide fabric banner on frame from bottom and zip up at top.

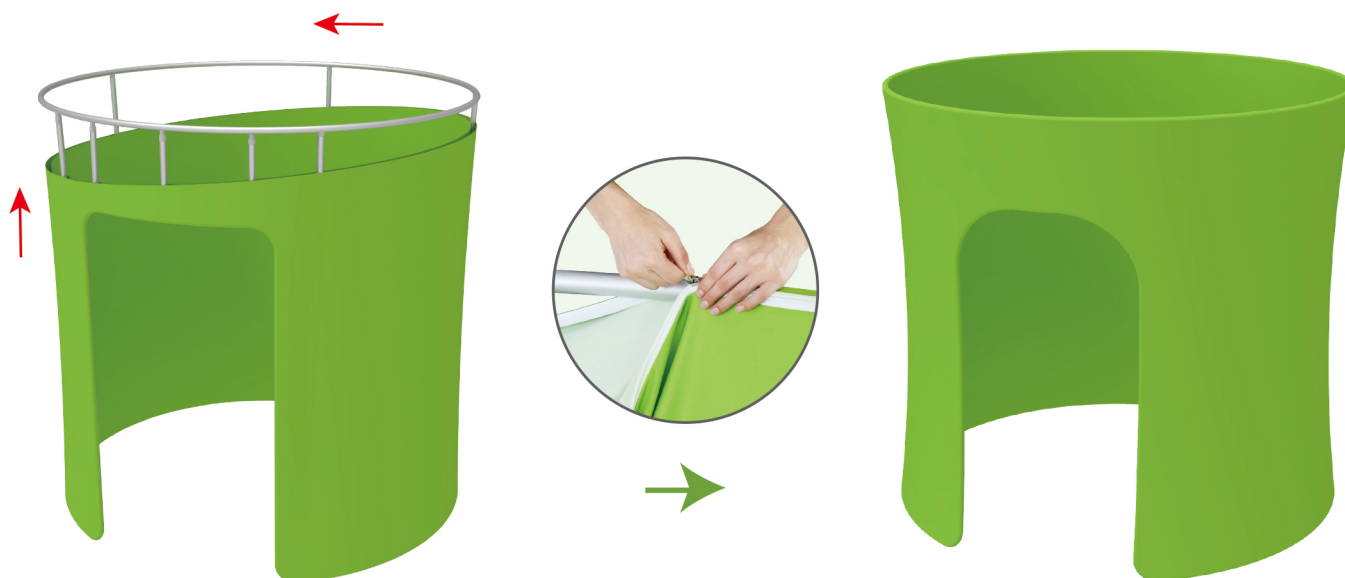

STPES

STEP 07

Stick curtain to doorway's top with velcro.

Stick

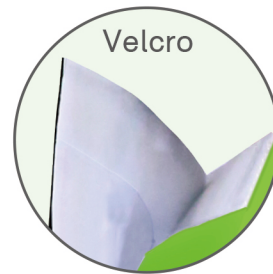
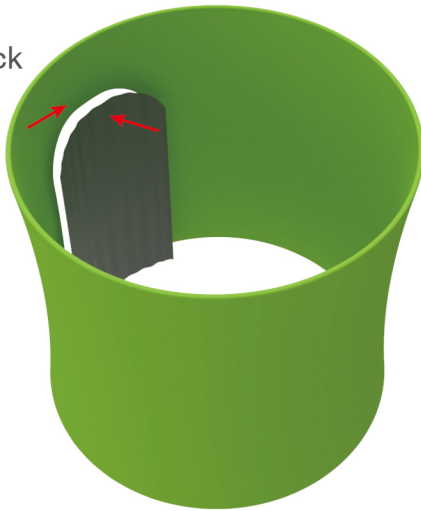

ES-EN-03