

# INSTRUCTION

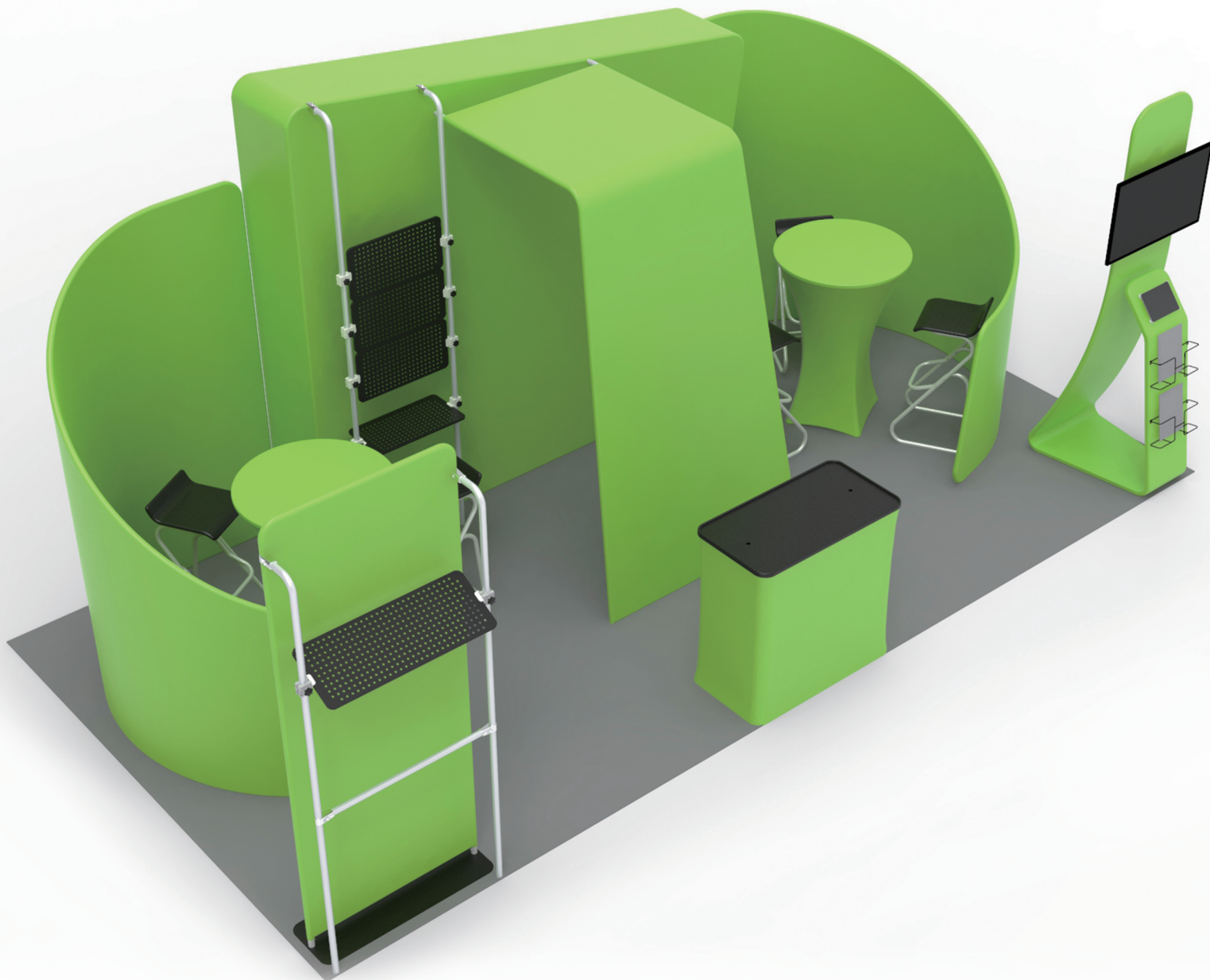

**10X20FT-BOOTH-U**



## STEPS

## (1) Hardware

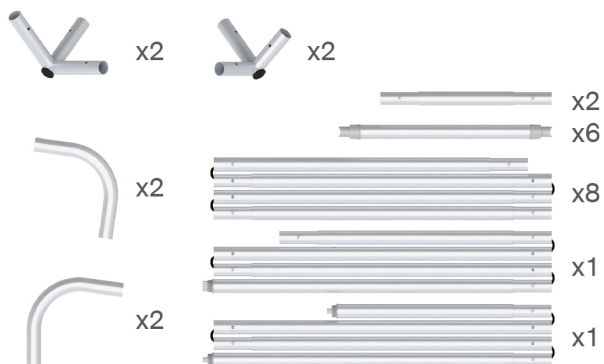

## (2) Printed Graphic Fabric Banner (Optional)



## STEP 01

Connect to make long poles according to labelings.

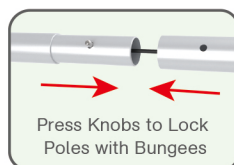

## STEP 02

Connect long poles with corner poles according to labelings.

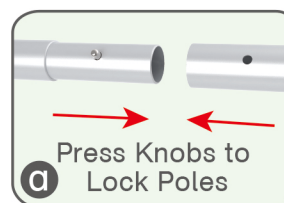
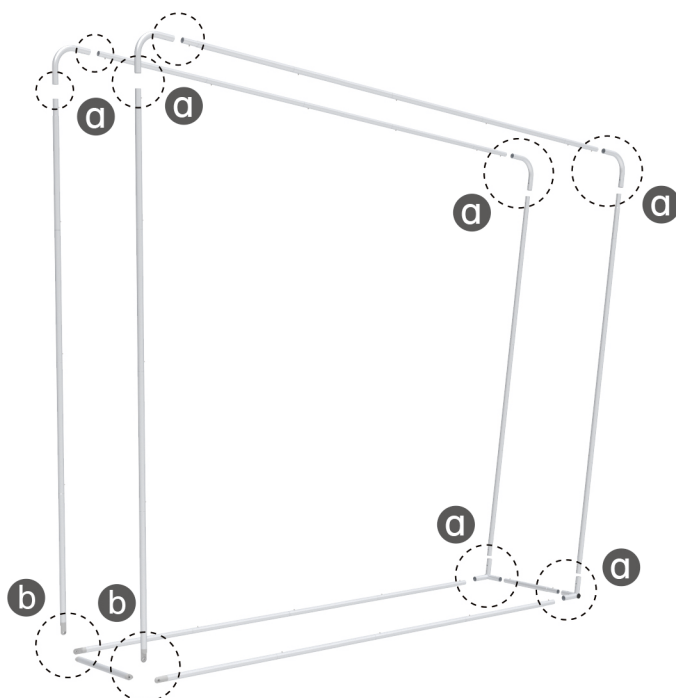



## STEPS

**STEP 03** Connect cross bars in the middle according to labelings.

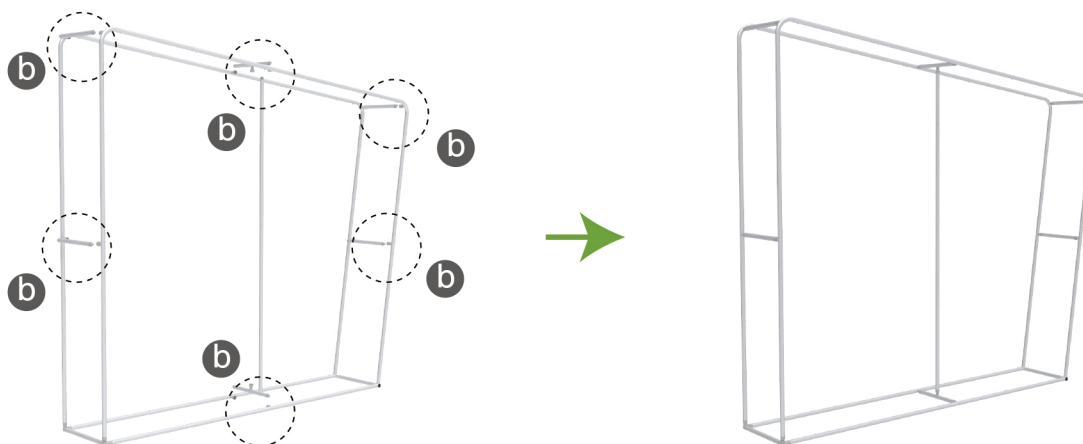
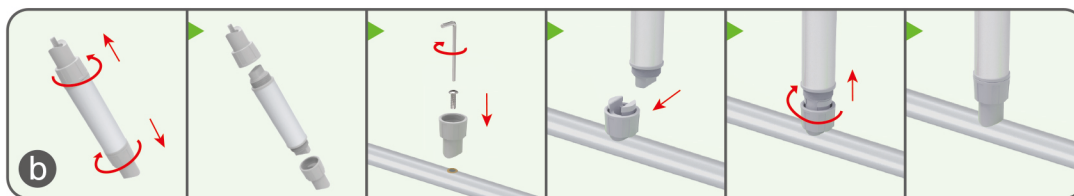

**STEP 04** Slide fabric banner on frame from top and zip up at bottom.

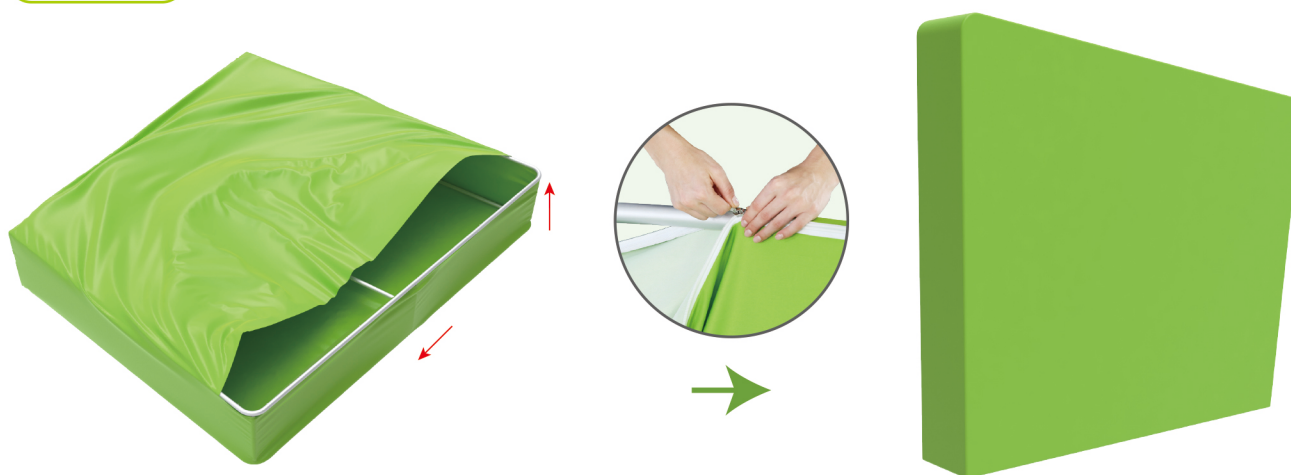

## (1) Hardware

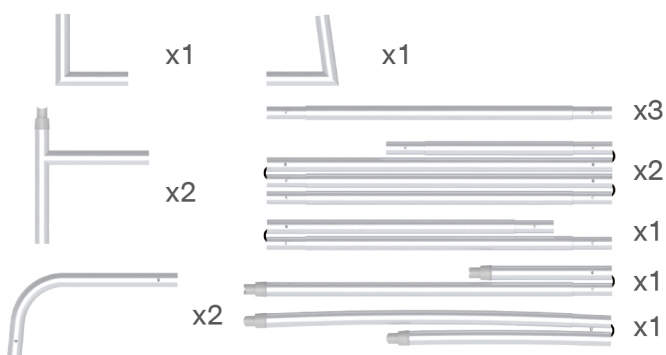

## (2) Printed Graphic Fabric Banner (Optional)



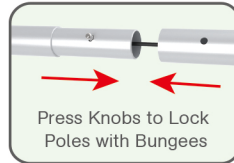
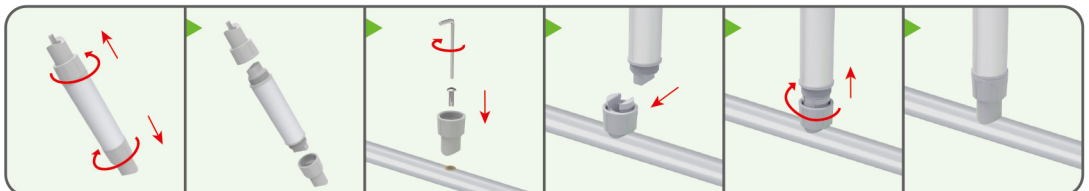
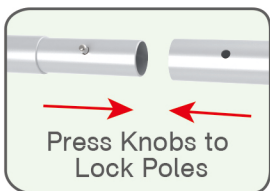
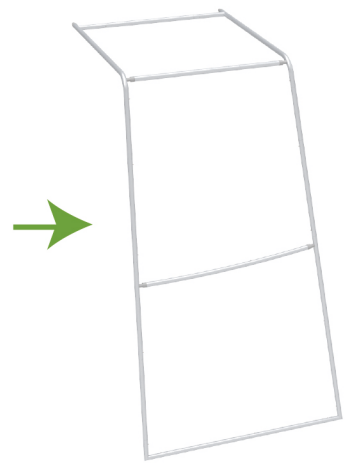
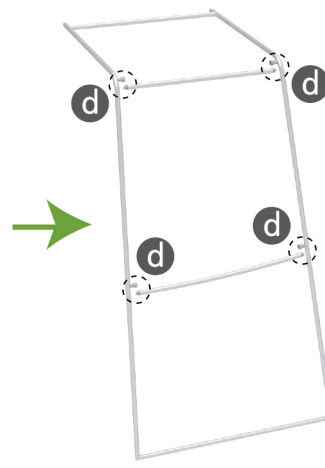
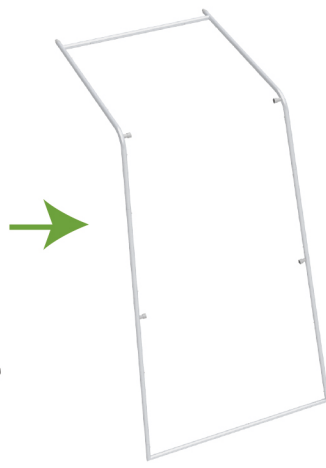
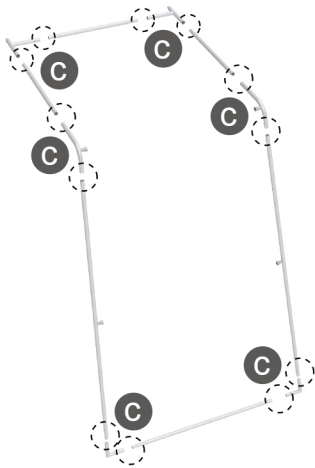

## STEPS

**STEP 01** Connect to make long poles according to labelings.**STEP 02** Connect long poles with corner poles according to labelings, connect cross bars in the middle according to labelings.**STEP 03** Wrap enclosure frame with fabric banner & zip up at top.



## STEPS

## (1) Hardware

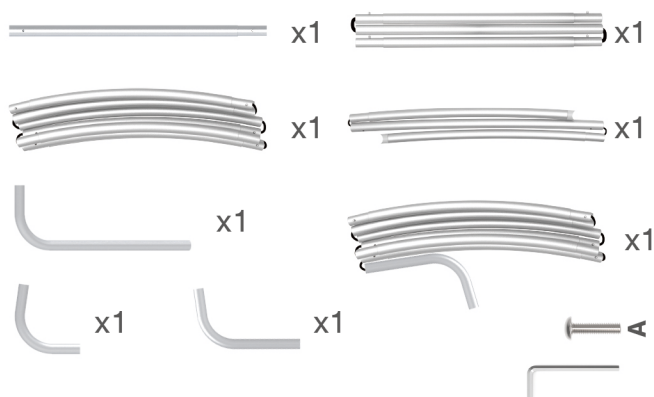

## (2) Printed Graphic Fabric Banner (Optional)



## STEP 01

Connect to make long poles according to labelings.

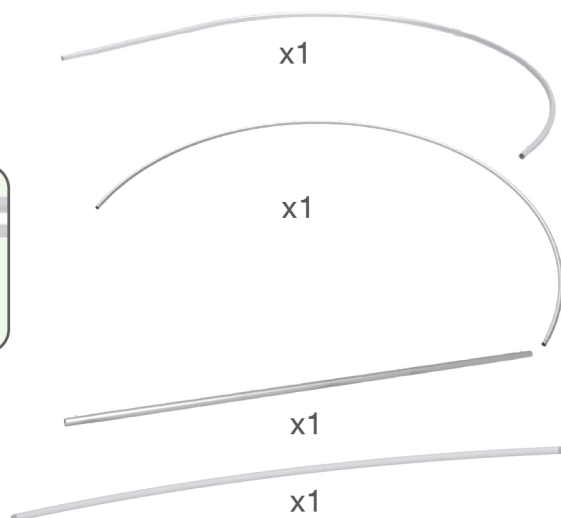
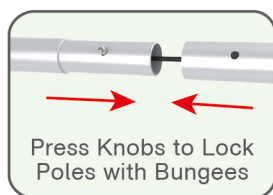

## STEP 02

Connect long poles with corner poles according to labelings.

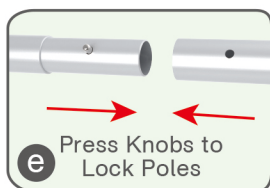
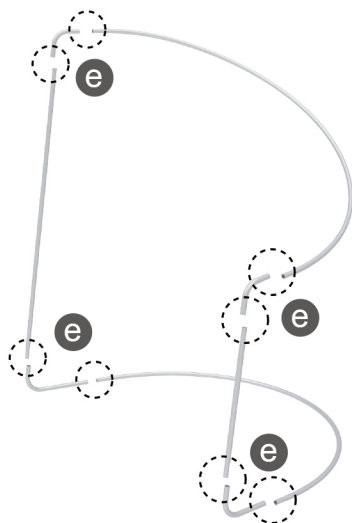



★ One Tool (Hex Wrench) 

## STEPS

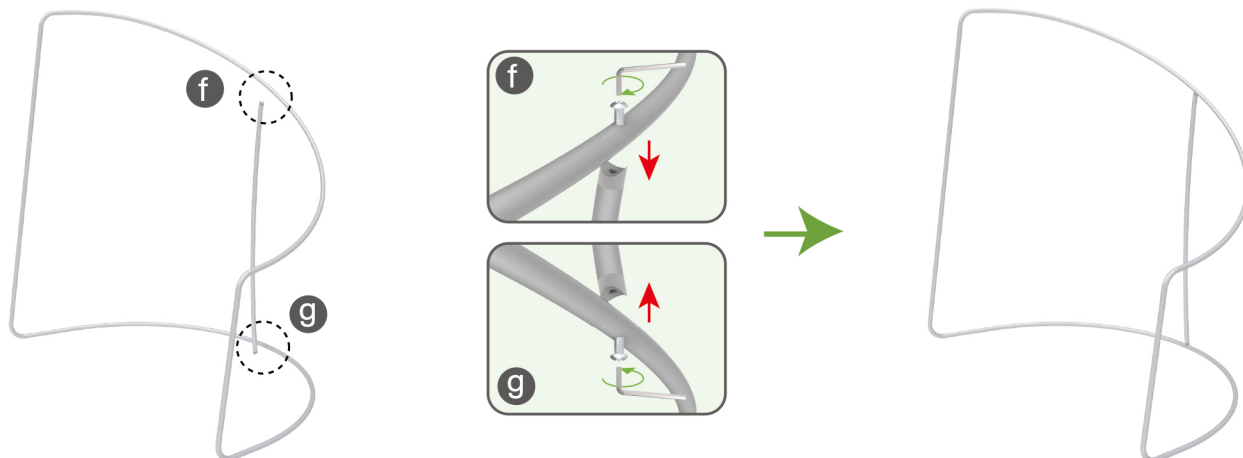
**STEP 03** Connect support poles onto frame.**STEP 04**

Slide fabric banner on frame from bottom and zip up at top.

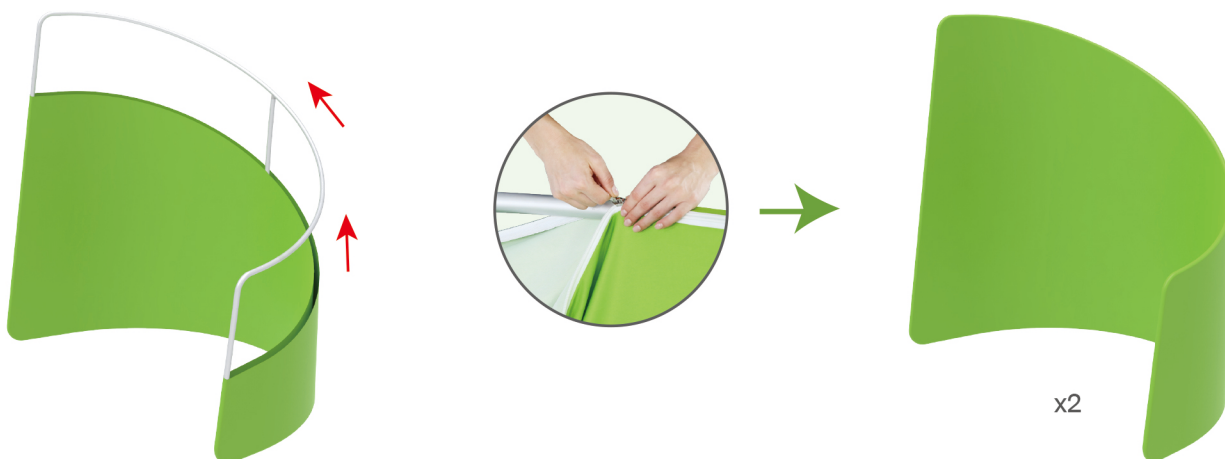

## Booth Set Assembly

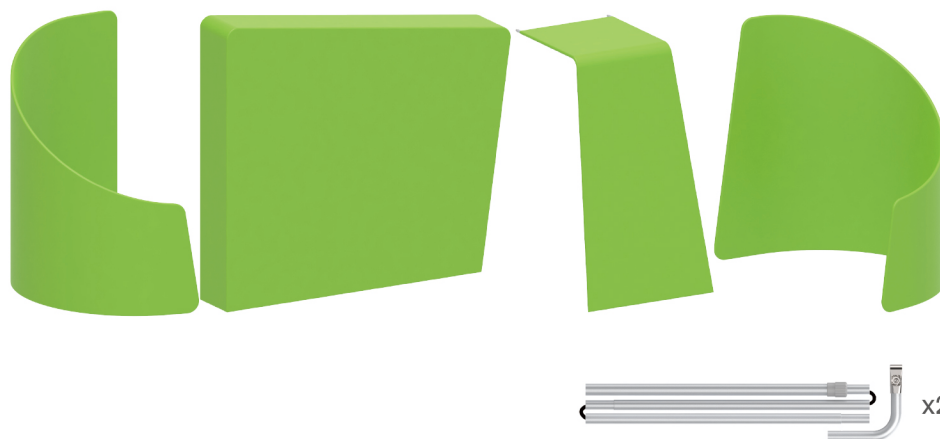

(1) 90° C-Shaped Clip



(2) Shelving Board





## STEPS

## STEP 01

Connect to make long poles according to labelings, slide three-way clips onto long poles, insert short curved poles onto their top by pressing their knobs.

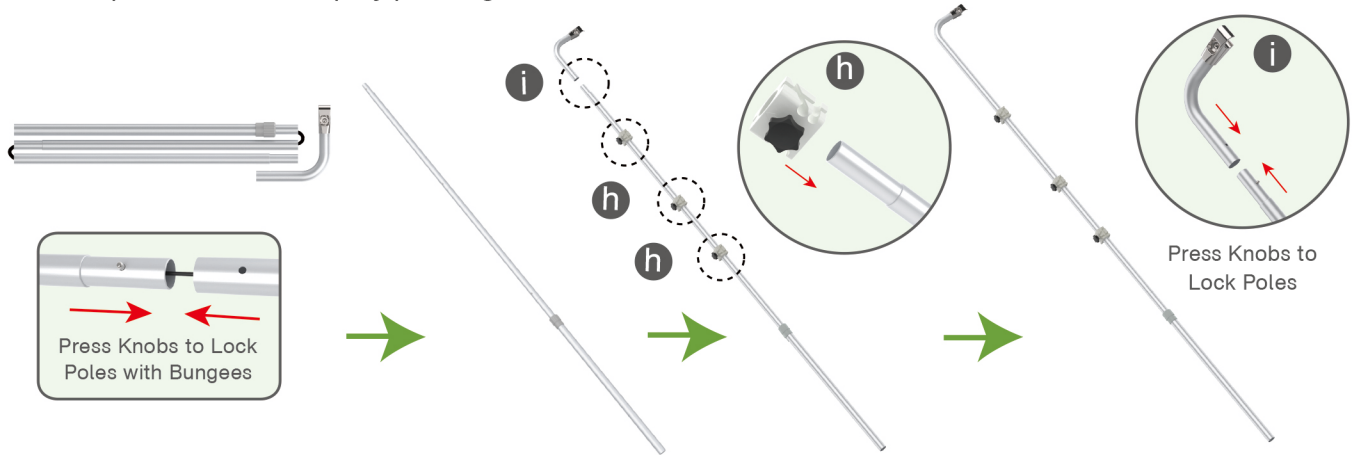

## STEP 02

Connect long poles and display stand with clamps, adjust their height properly as needed by loosening and tightening screws.

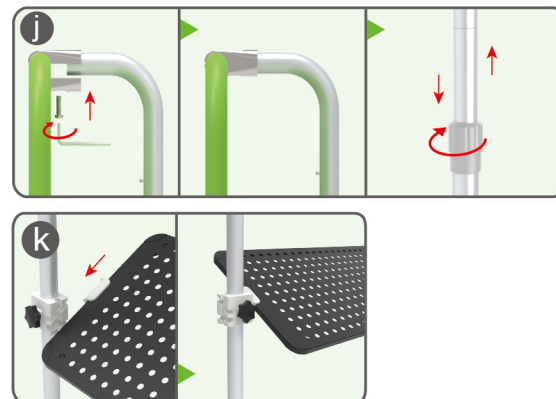
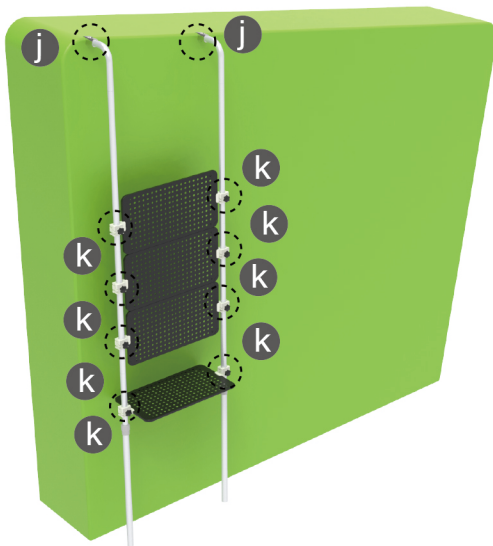

Clip into hanging boards based on directions of three-way clips & tightening with thumb screws.

## STEP 03

Connect header and display stand with support poles.

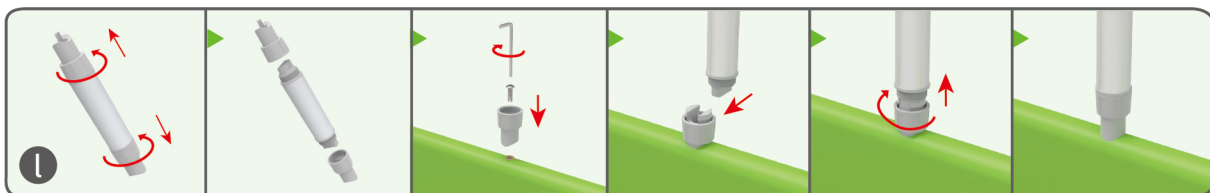



## STEPS

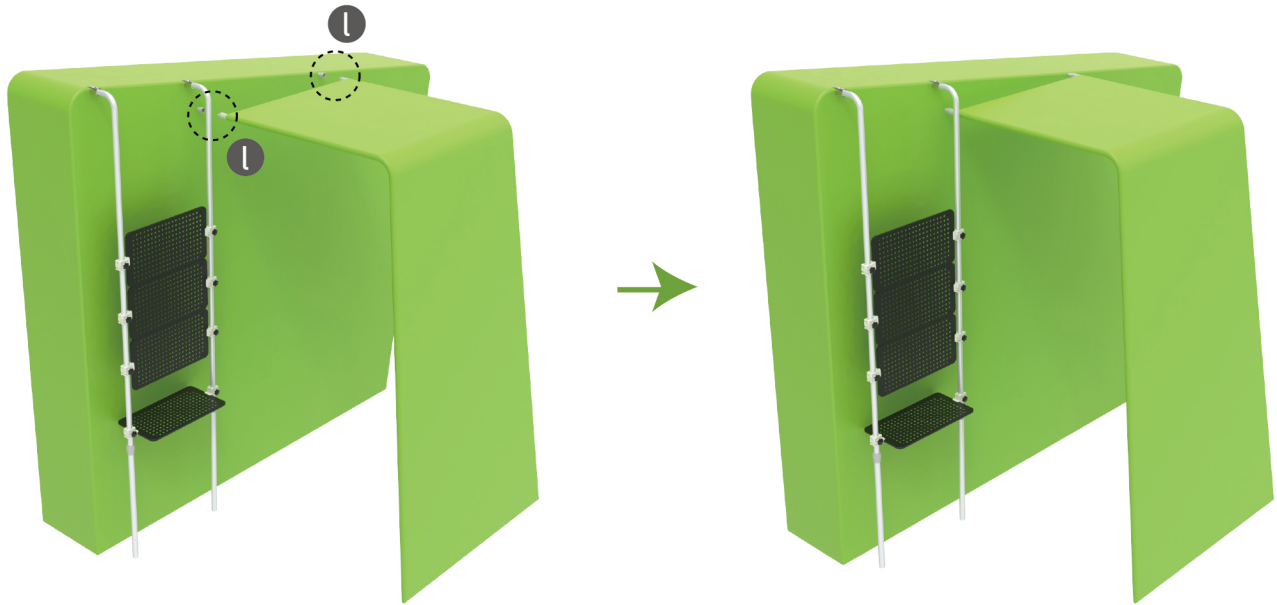

## STEP 04

Interconnect display stands with C-shaped clips.

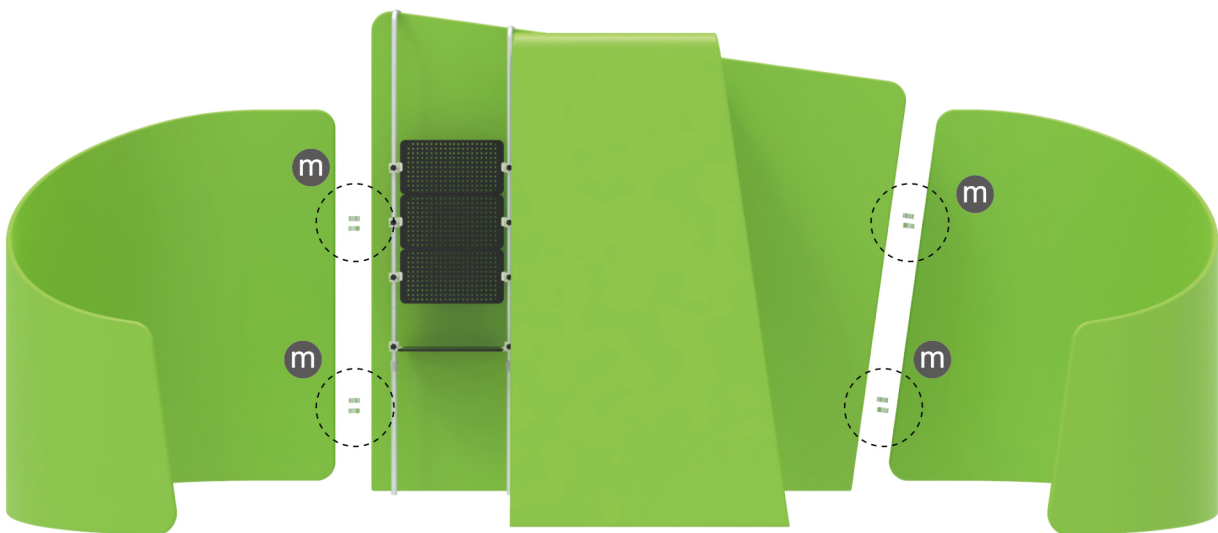
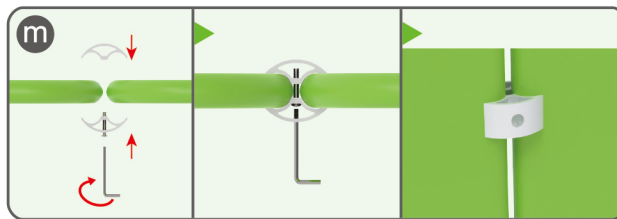

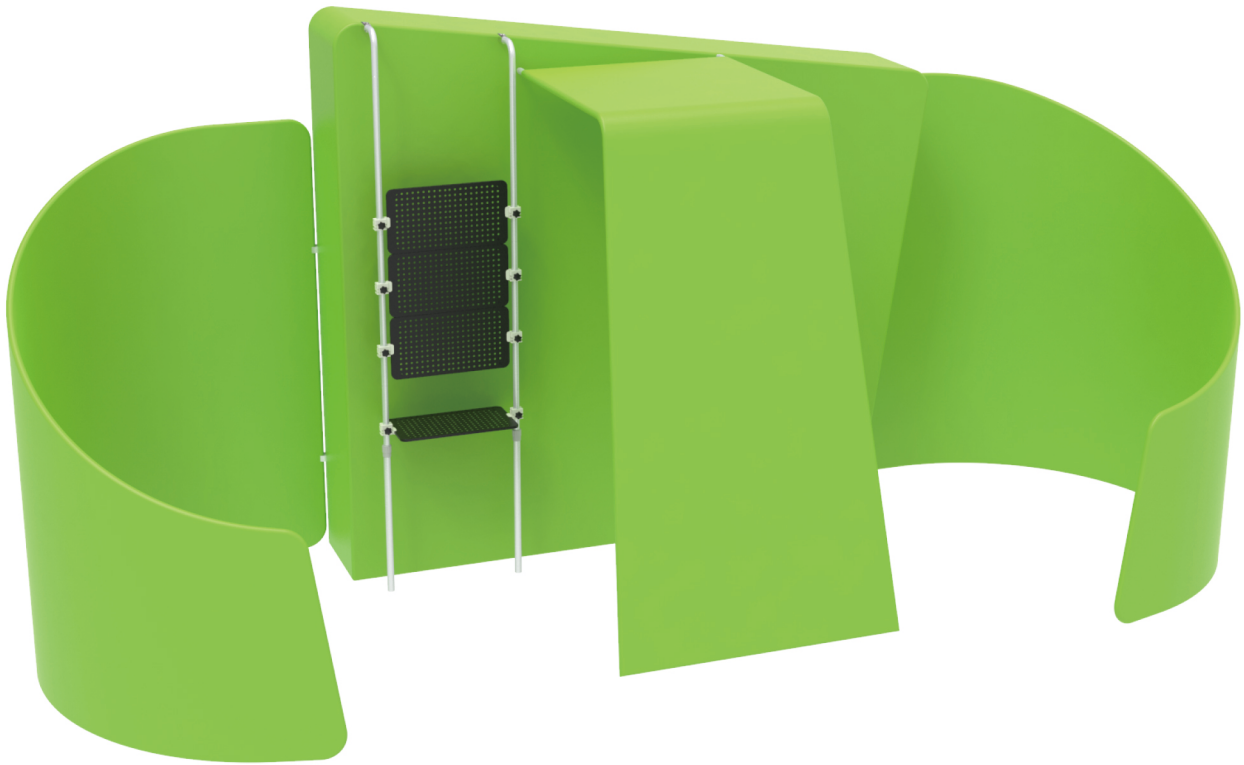

**STEPS****10X20FT-BOOTH-U**



## STEPS

(1) Hardware

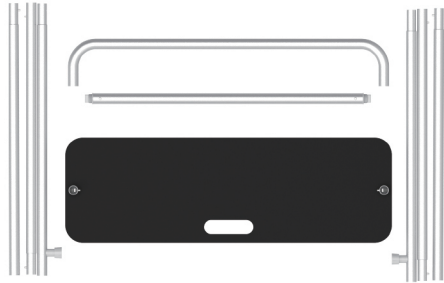

(2) Printed Graphic Fabric Banner (Optional)



(3) LED Light &amp; Clip



x1



x1

(4) Shelving Board

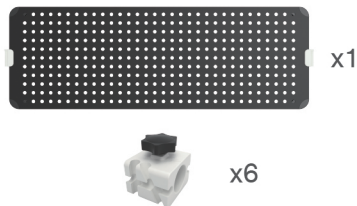

x1

x6



x1



x2

(5) Arm Clip



x2

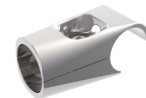

x2

## STEP 01

Connect long poles with corner poles according to labelings.

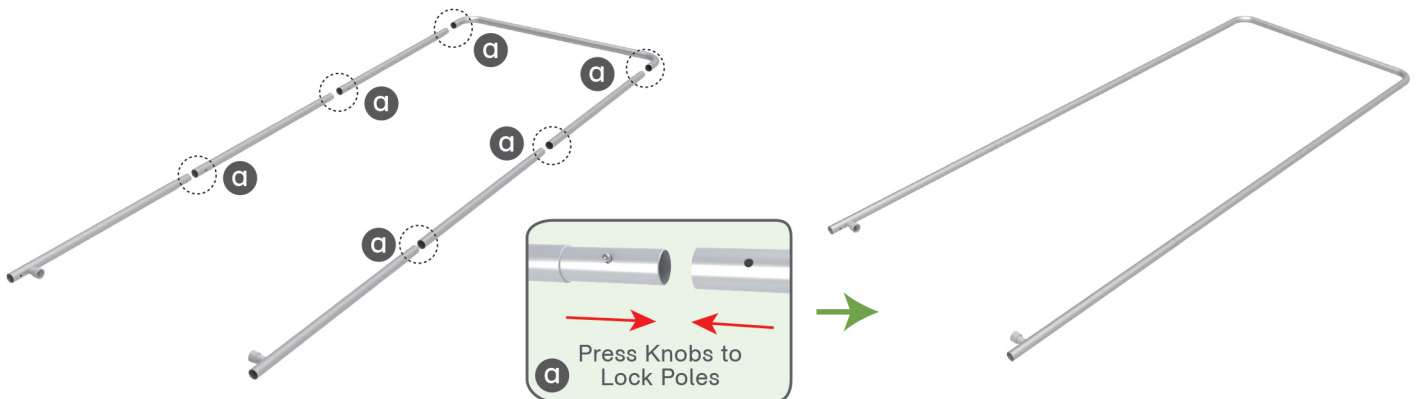

## STEP 02

Connect cross bars in the middle according to labelings.

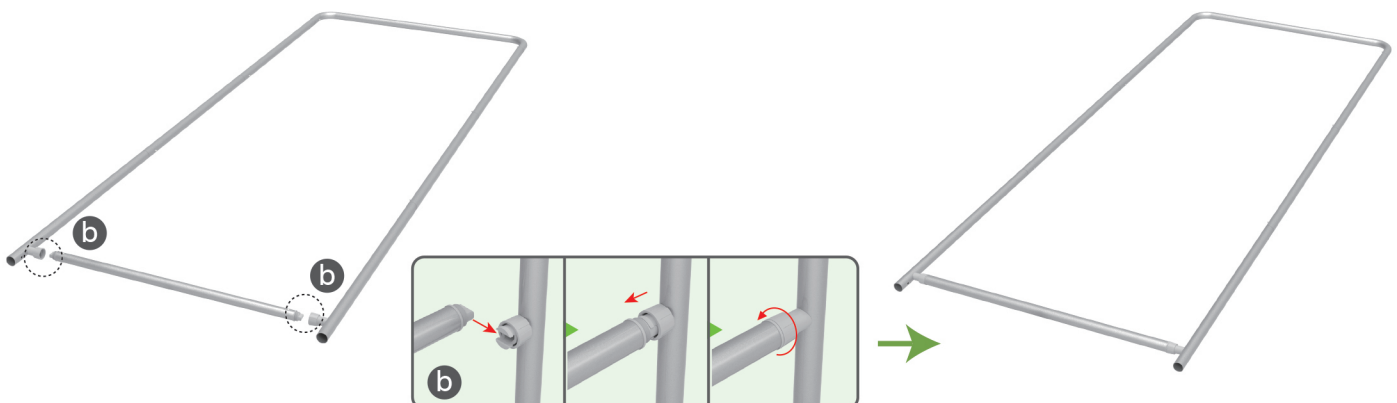



## STEPS

## STEP 03

Slide fabric banner on frame from top and zip up at bottom.

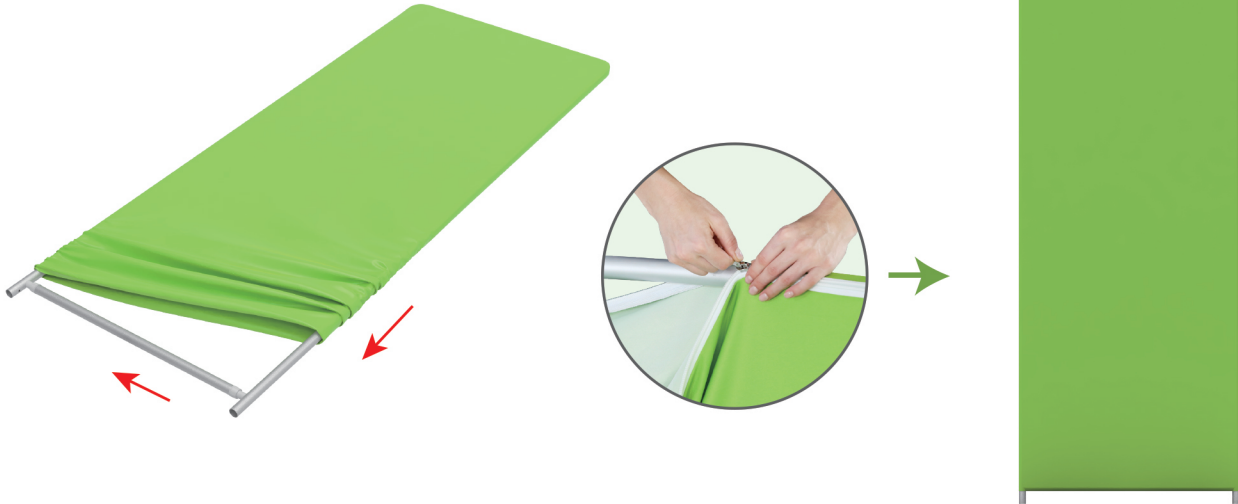

## STEP 04

Screw light clips at top of display stands, slide lights onto them and adjust their direction.

\*\*\*LED Lights are optional\*\*\*

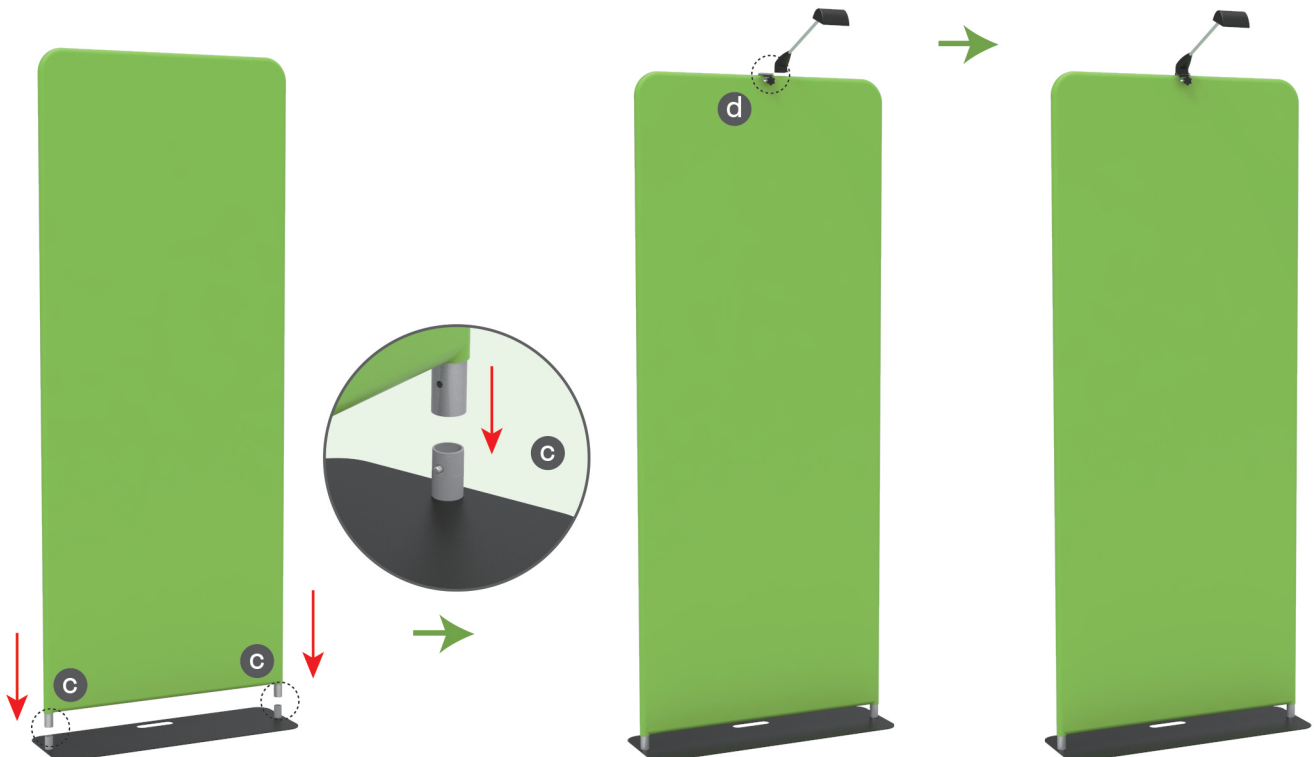
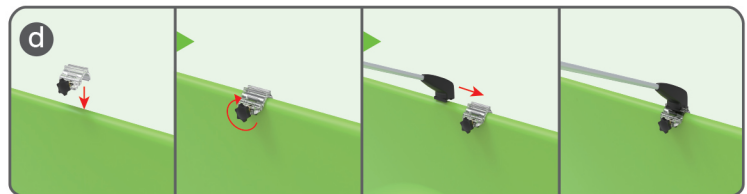



## STEPS

## STEP 05

Connect to make long poles according to labelings, slide three-way clips onto long poles, insert short curved poles onto their top by pressing their knobs.

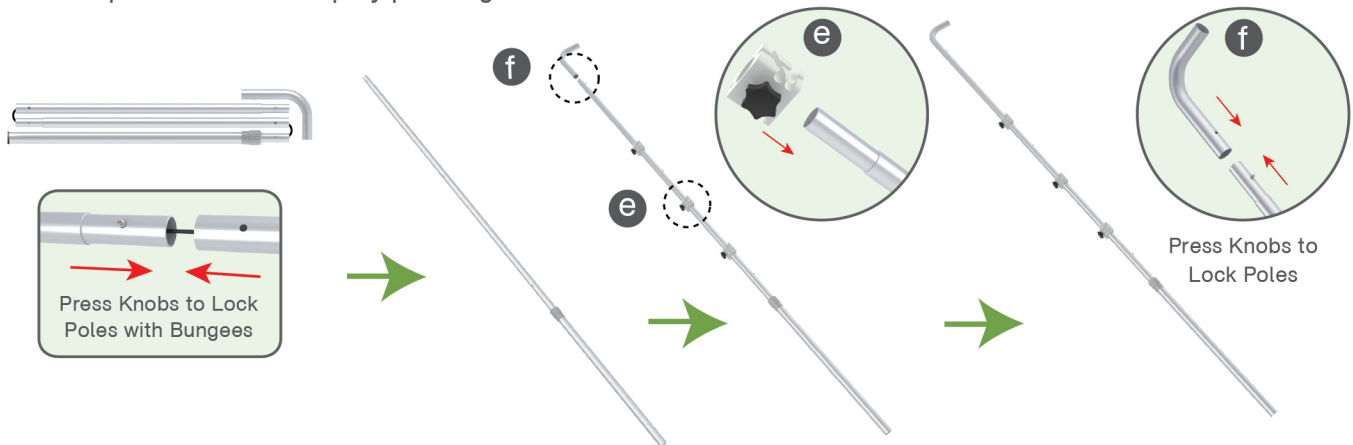

## STEP 06

Connect long poles and display stand with clamps, adjust their height properly as needed by loosening and tightening screws.



② Connect cross bars and long poles with clamps.

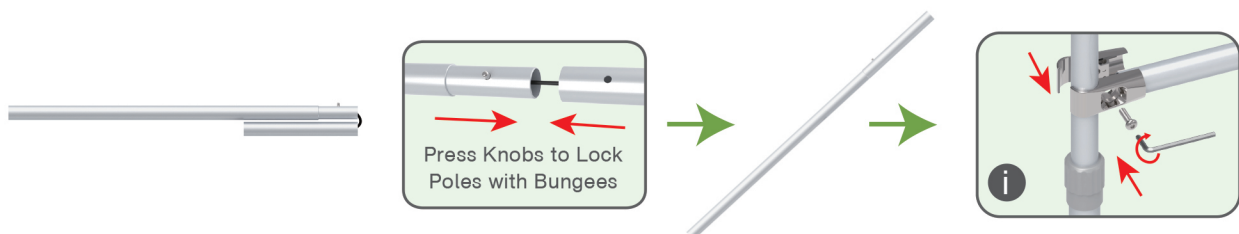



## STEPS

(1) Durable Plastic Hard Case, Aluminum Support Poles



(2) Printed Graphic Fabric Banner



## STEP 01

Put hard case's top into fabric banner.

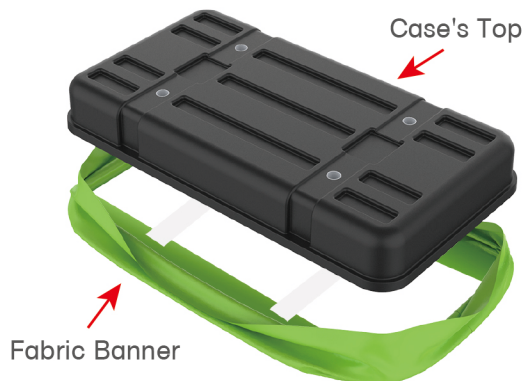

## STEP 02

Insert support poles into hard case's top &amp; bottom.

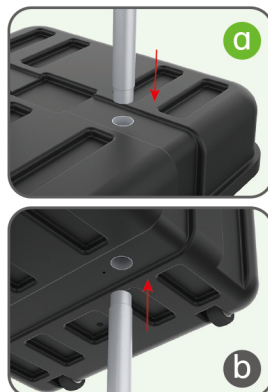
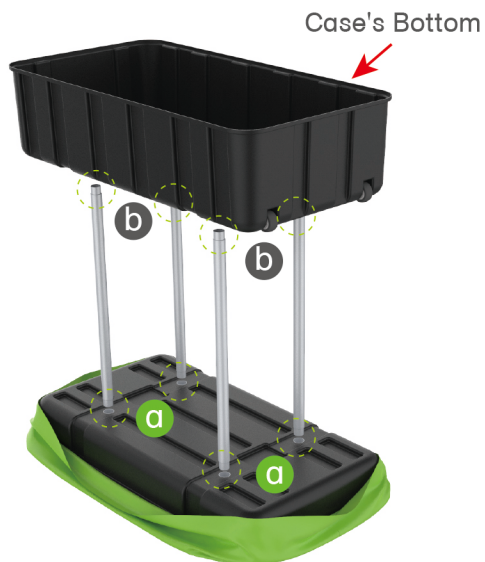



## STEPS

## STEP 04

Wrap fabric banner from bottom to top & twist it to be smooth, lay hard case's intermediate panel on podium's top.

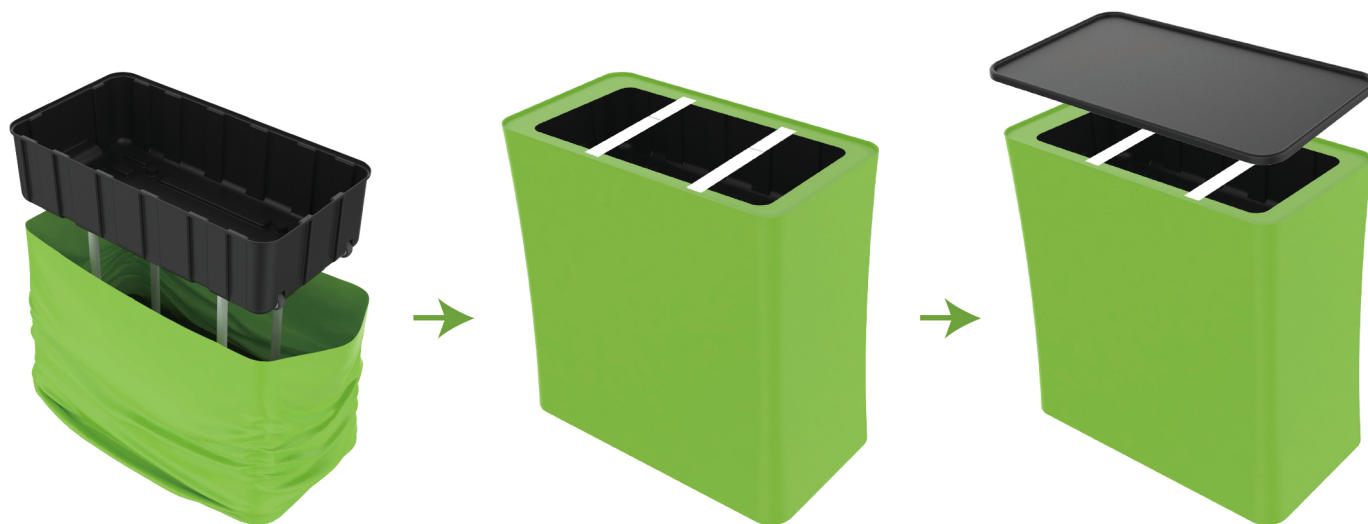



## STEPS

(1) Hardware

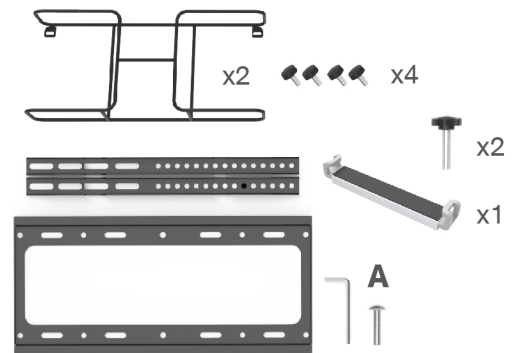

(2) Fabric banner

(3) TV mount x1 / Brochure rack x2  
Tablet PC holder x1

## STEP 01

To connect the poles according to the labellings

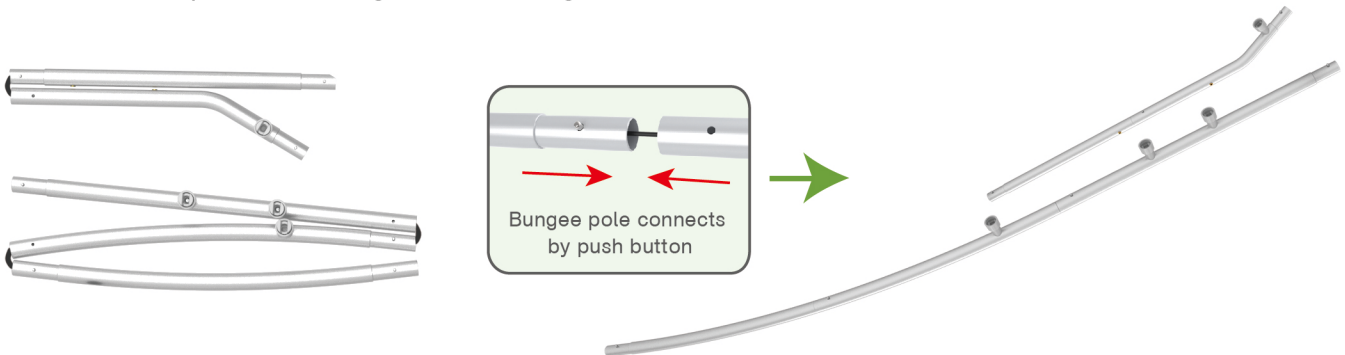

## STEP 02

To use corner pieces to connect the poles to be display stand

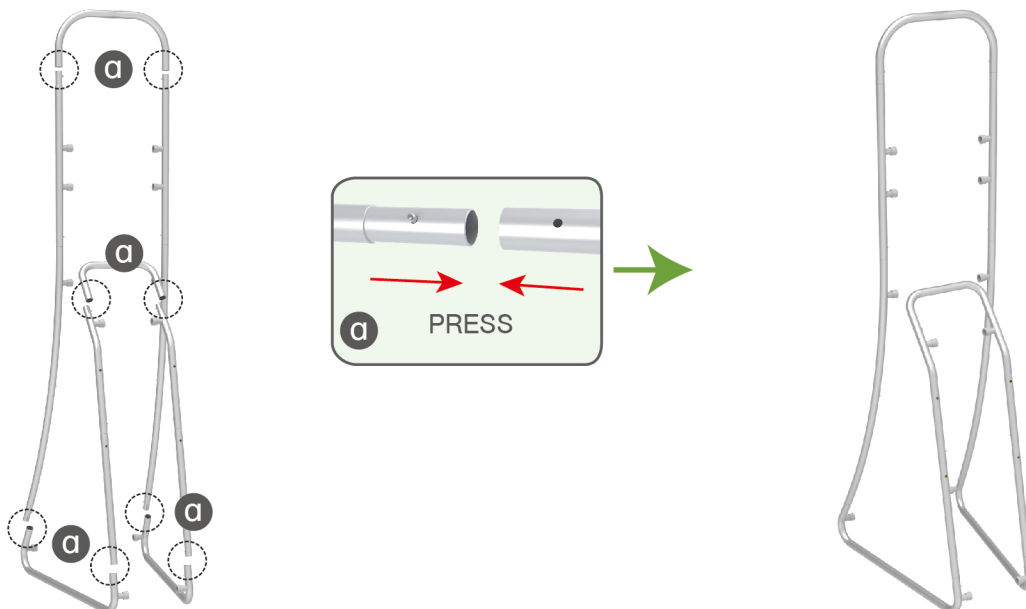



## STEPS

## STEP 03

To install the cross bar according to labellings

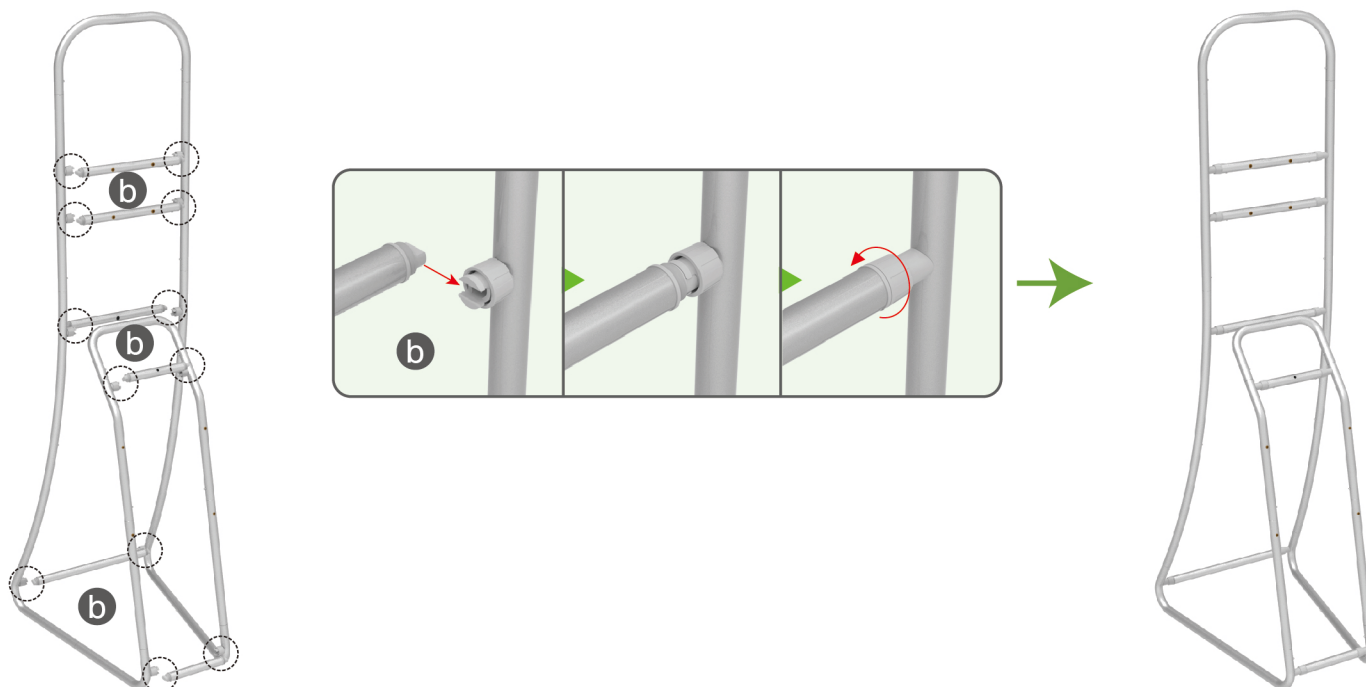

## STEP 04

To wrap the fabric from ipad end to the top where the TV located and zip up, afterwards use big screw for fastening the whole unit

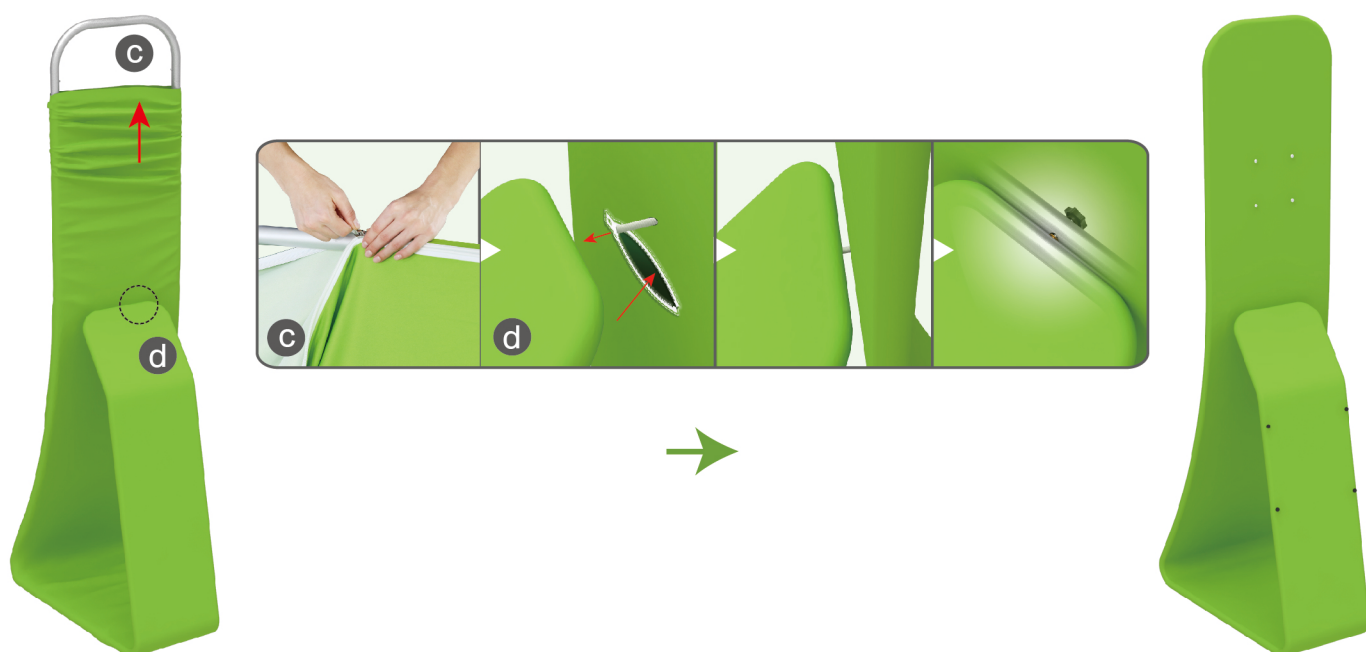



## STEPS

## STEP 05

To install TV rack

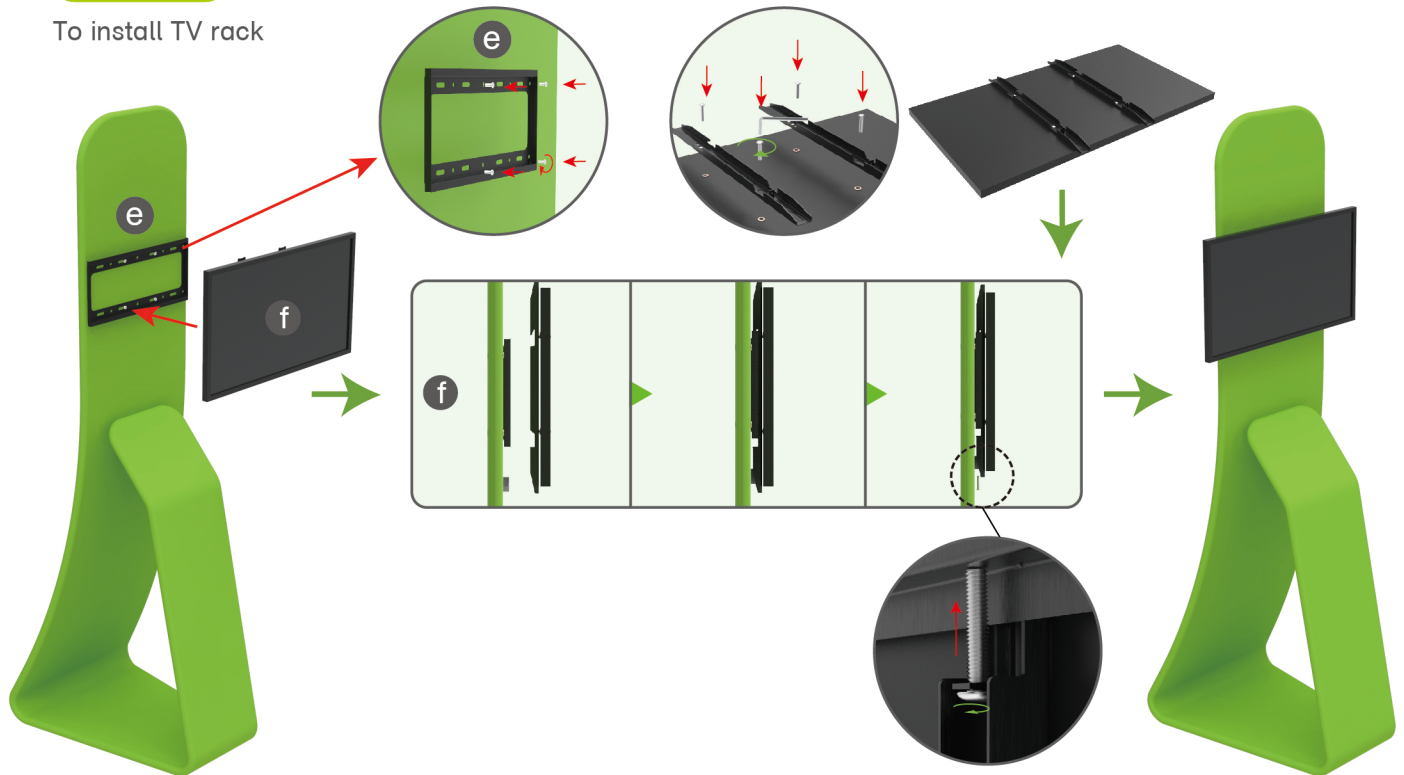

## STEP 06

To adjust the holder size and put the tablet PC in position then use Allen Key for fastening, afterwards whole kit install onto the stand by using screw.

\*\*\*The holder is suitable for mini iPad to 14" of Tablet PC\*\*\*

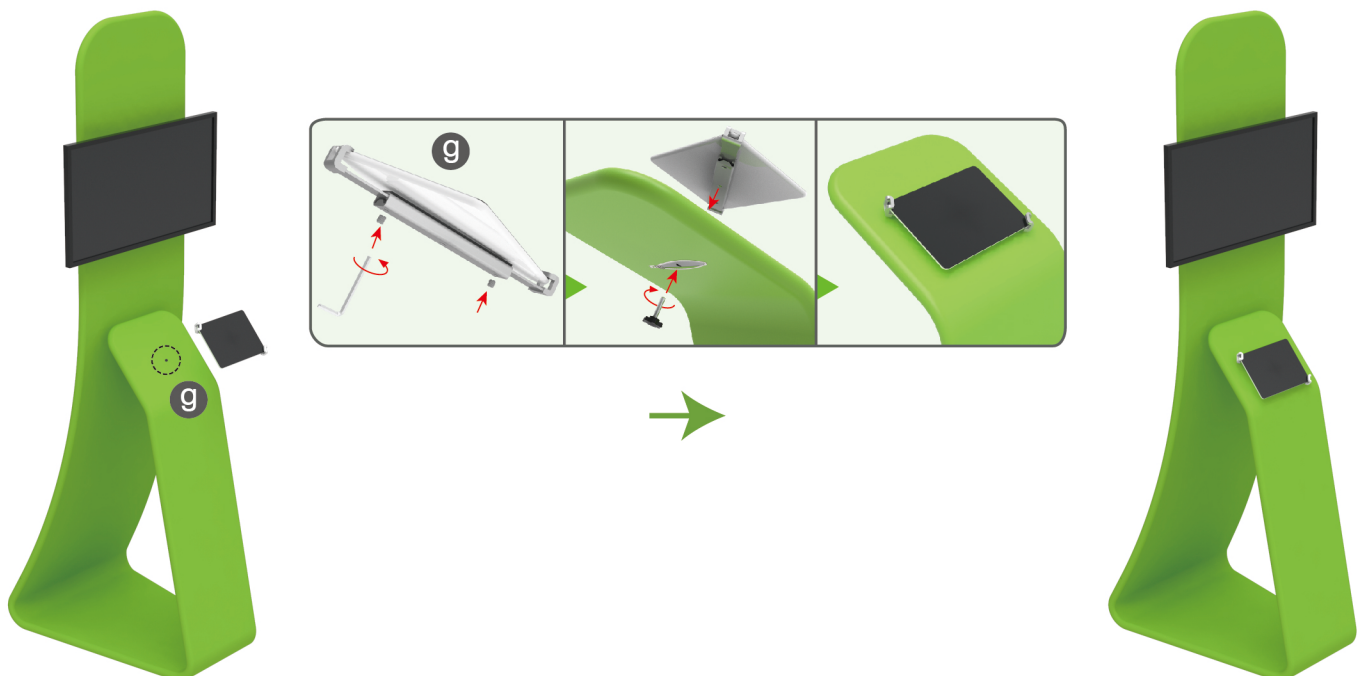



## STEPS

## STEP 07

To install 2 racks by screws in position

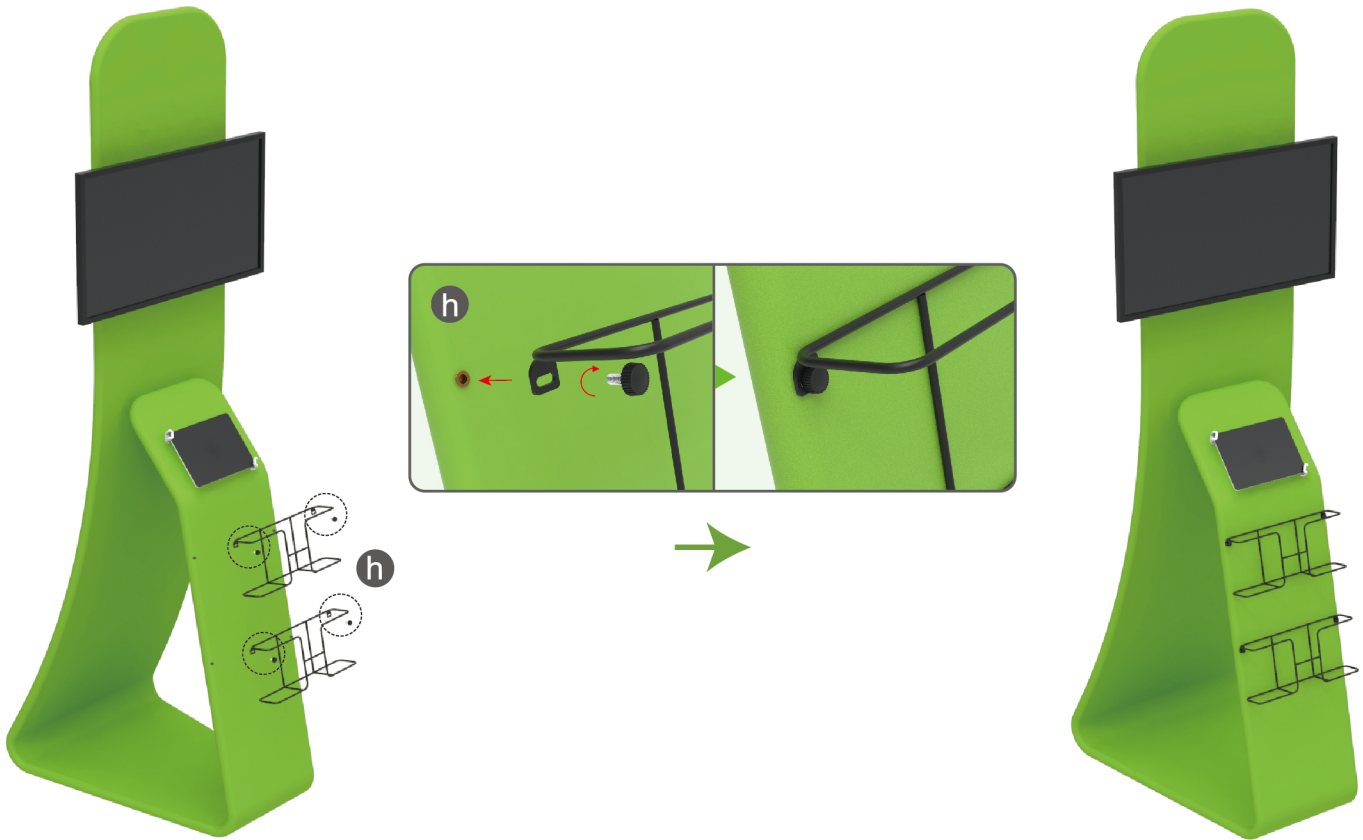



## STEPS

## (1) Hardware



## (2) Countertop Panel

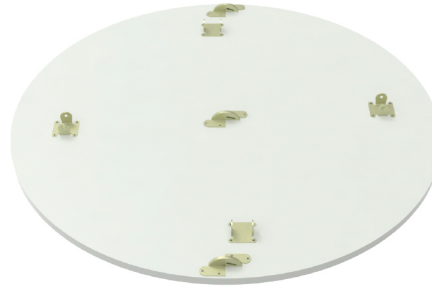

## (3) Fixing Accessory



## (4) Printed Graphic Fabric Banner



## STEP 01

Connect to make long poles according to labelings.

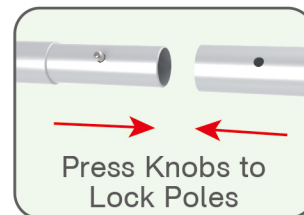

## STEP 02

Insert poles into fixing accessory until you hear a 'Ding' sound to make poles' knobs clip into it & its concave parts pop out.





## STEPS

**STEP 03** Press poles' knobs to clip into countertop's slot.

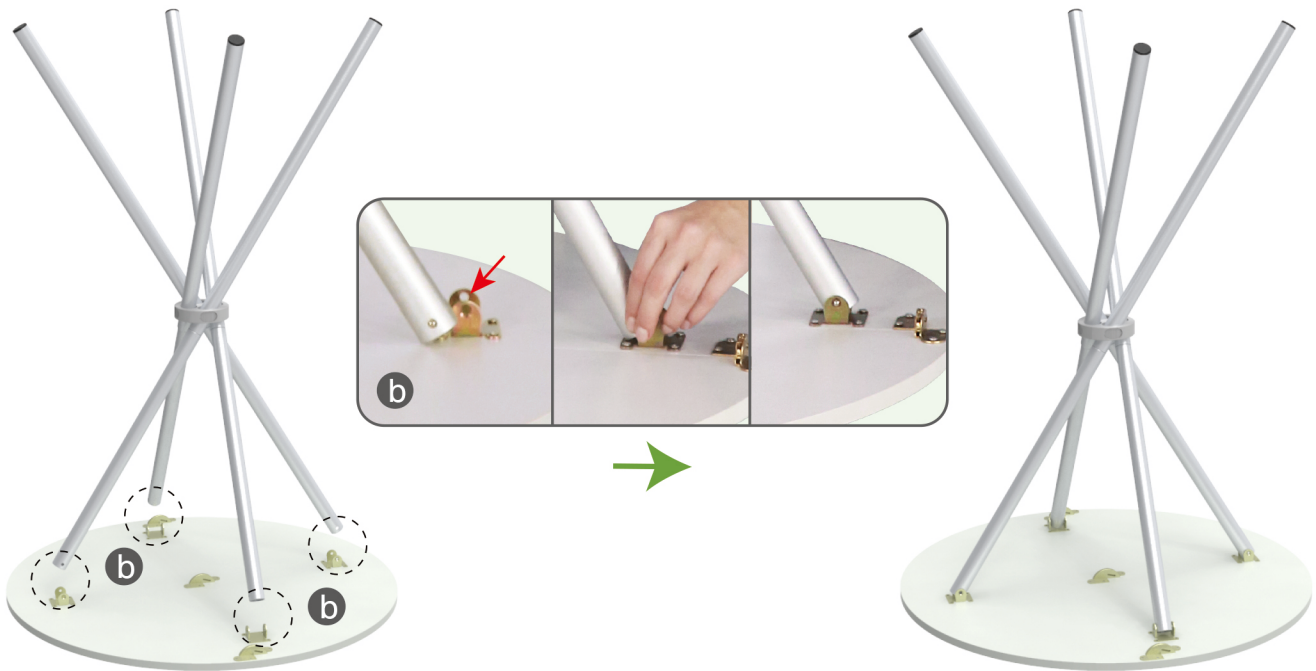
**STEP 04**

Wrap fabric banner from top to bottom, put poles into pockets & zip up.

