

INSTRUCTION



10X20FT-BOOTH-P

STEPS

(1) Hardware

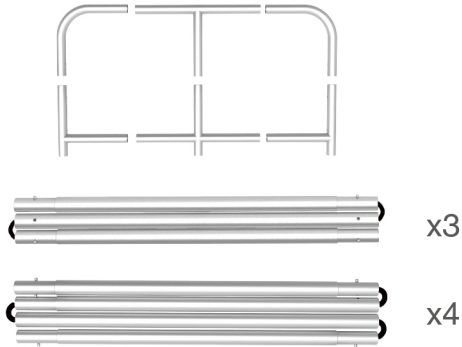

(2) Printed Graphic Fabric Banner (Optional)



STEP 01

Connect to make long poles according to labelings.

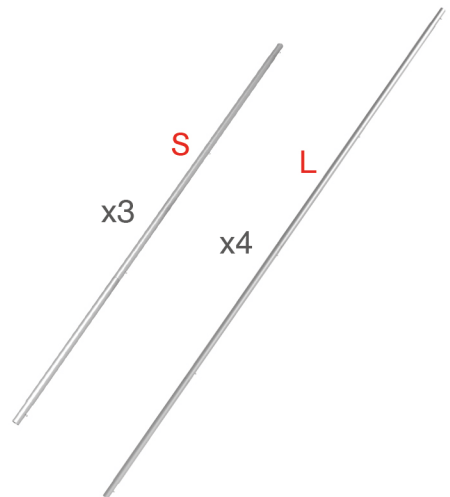
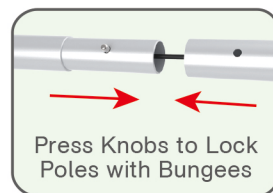
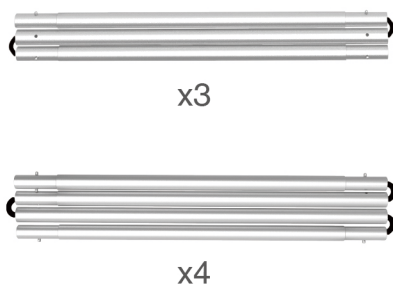

STEP 02

Connect long poles with corner poles according to labelings.

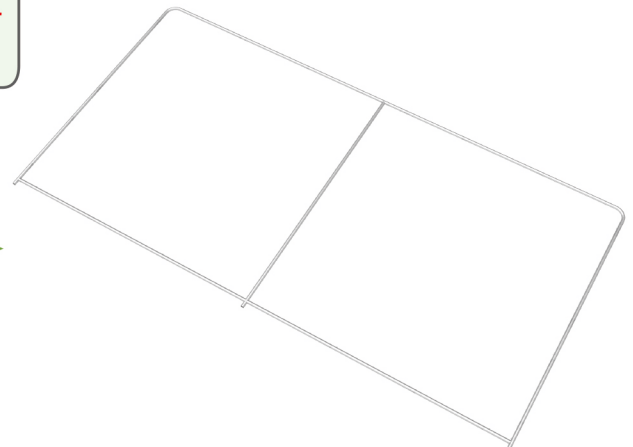
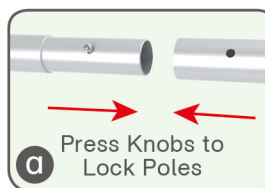
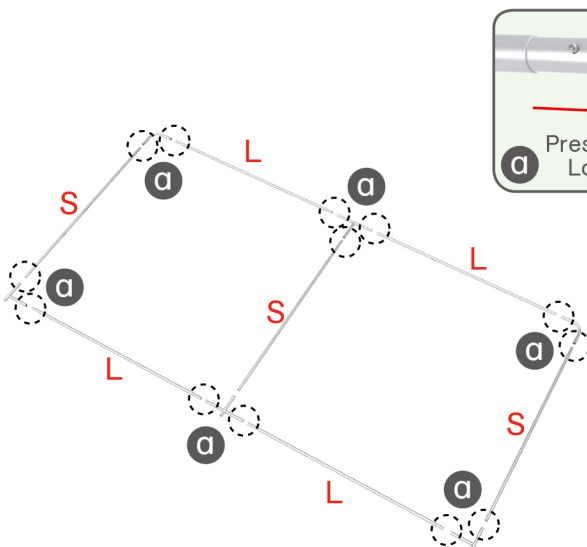

STEPS

STEP 03

Slide fabric banner on frame from top and zip up at bottom.



(1) Hardware

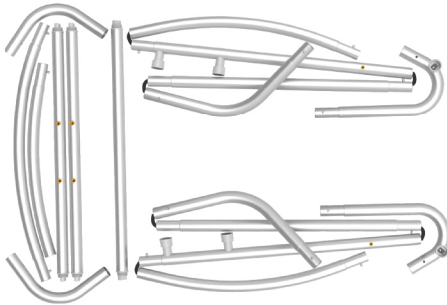

(2) Printed Graphic Fabric Banner (Optional)



STEP 01

Connect to make long poles according to labelings.

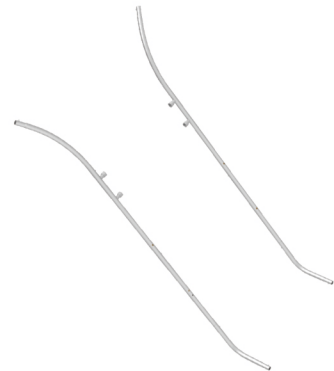
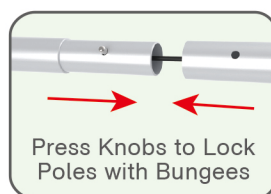
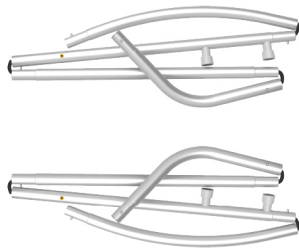

STEP 02

Connect long poles with corner poles according to labelings.

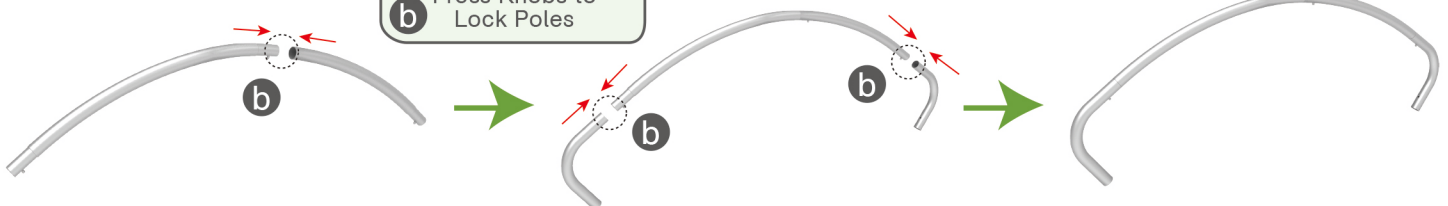
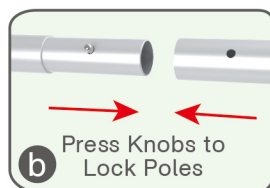

★ One Tool (Hex Wrench) 

STEPS

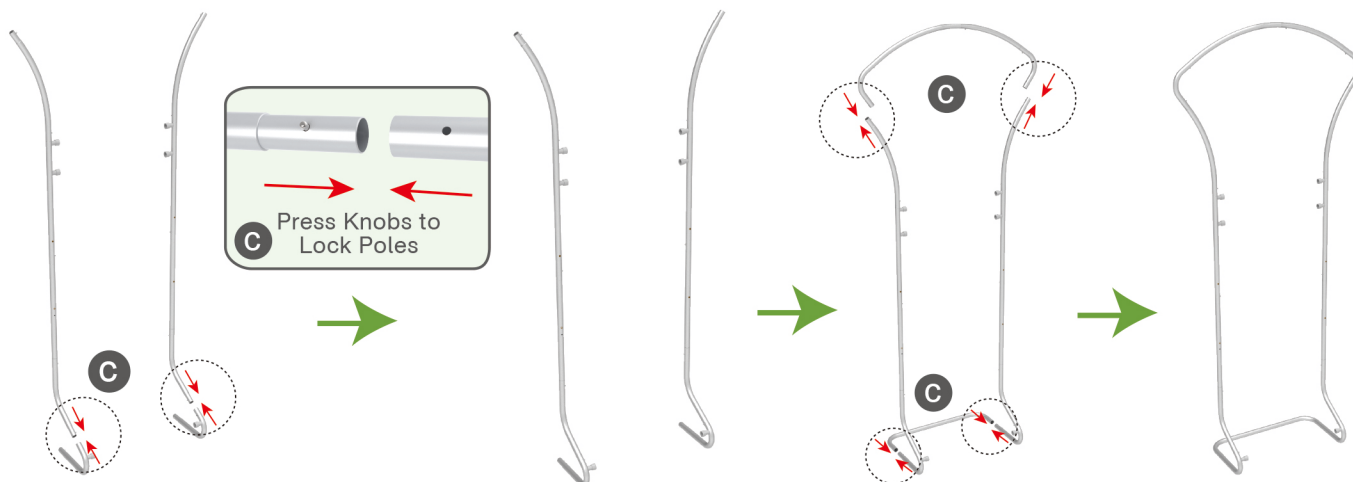
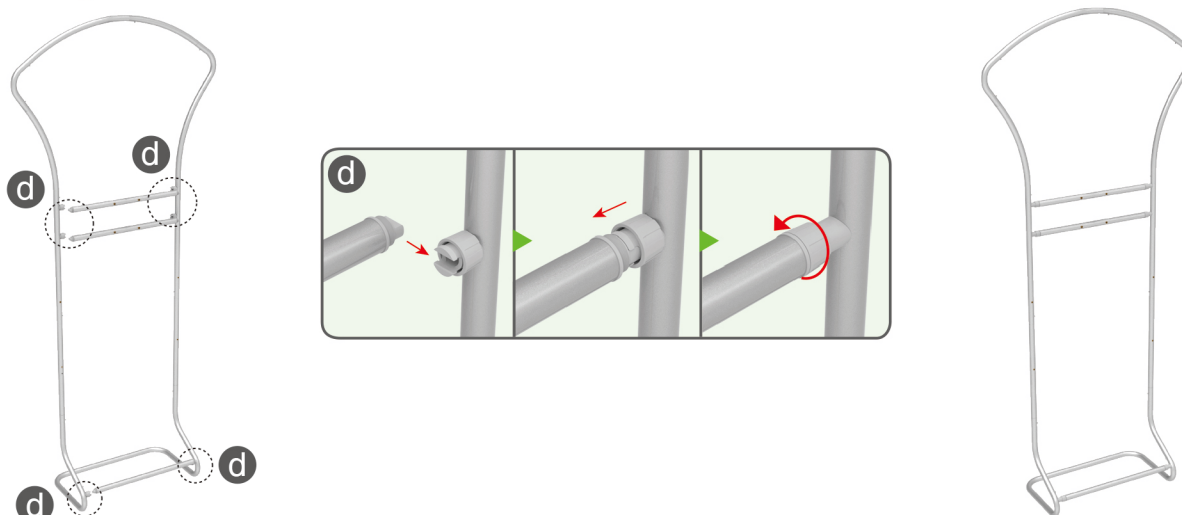
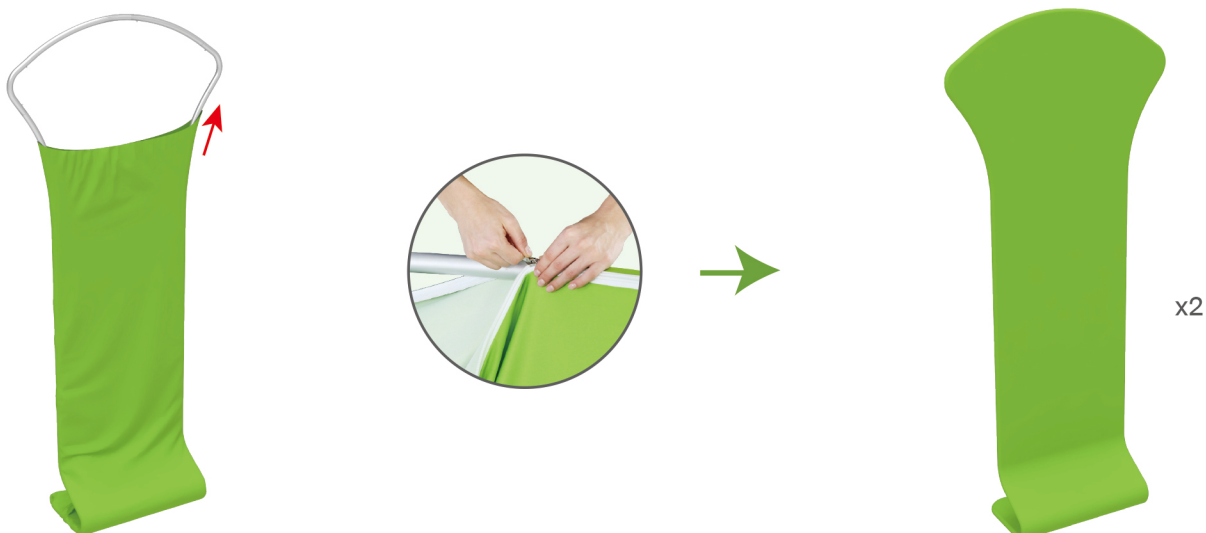
**STEP 03** Install cross bars in position.**STEP 04** Slide fabric banner on frame from bottom and zip up at top.

STEPS

(1) Hardware



(2) Printed Graphic Fabric Banner (Optional)



STEP 01

Connect poles according to labelings.

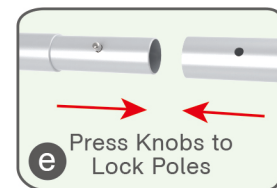
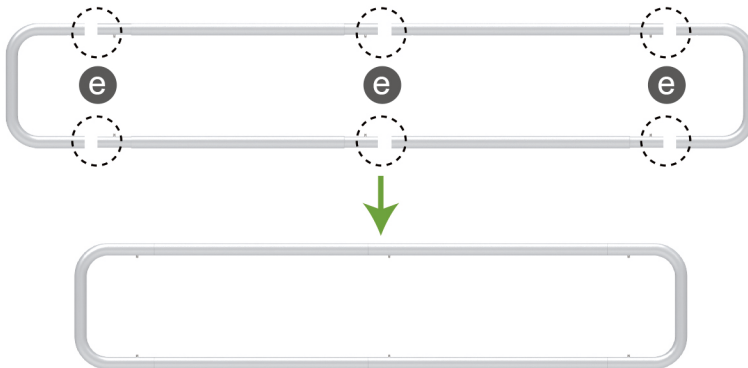

STEP 02

Slide fabric banner on frame from left and zip up at right.

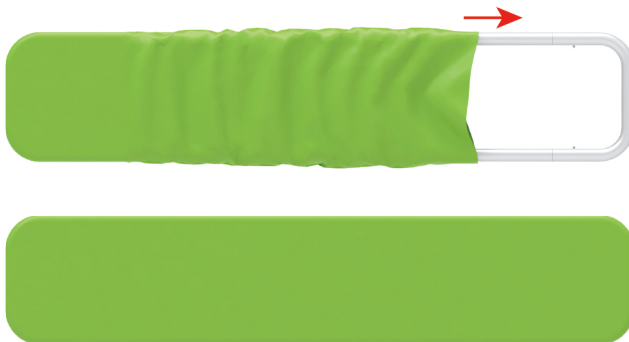

Booth Set Assembly

(1) Base



x3

(2) LED Light & Clip



x2

x2

(3) S-Shaped Clip



x4

(4) Shelf & Bracket



x4

(5) TV Mount

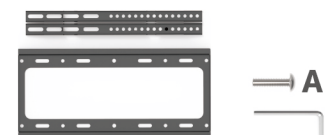

A

(6) Shelving Board



x6



x2



x12

x4

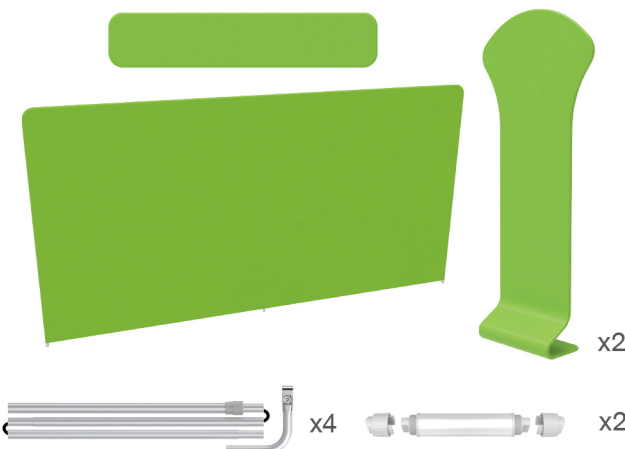

x4

x2

STEPS

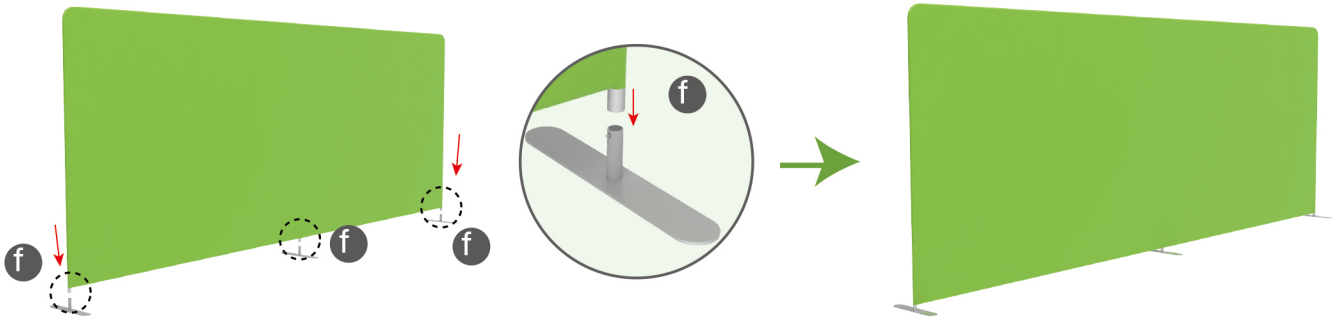
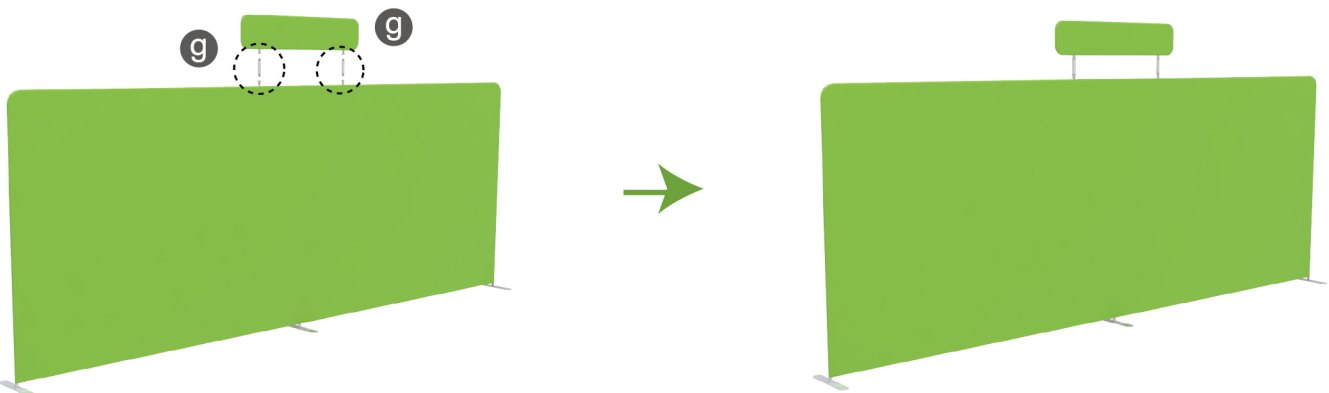
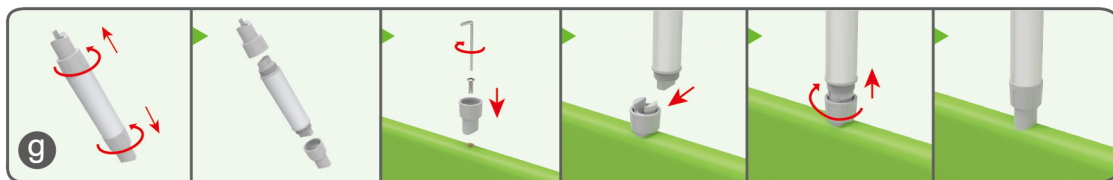
STEP 01 Insert display stands onto feet by pressing their knobs.**STEP 02** Connect header and display stand with support poles.**STEP 03**

Connect to make long poles according to labelings, slide three-way clips onto long poles, insert short curved poles onto their top by pressing their knobs.

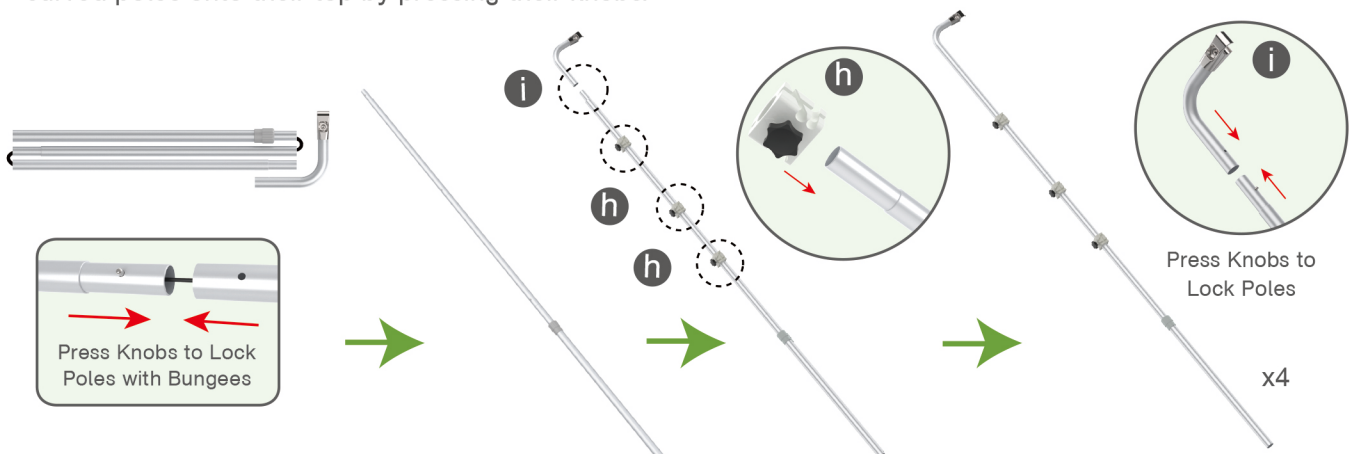

STEPS

STEP 04

Connect long poles and display stand with clamps, adjust their height properly as needed by loosening and tightening screws.

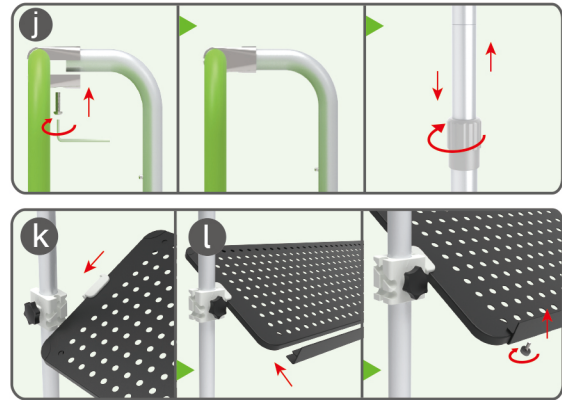
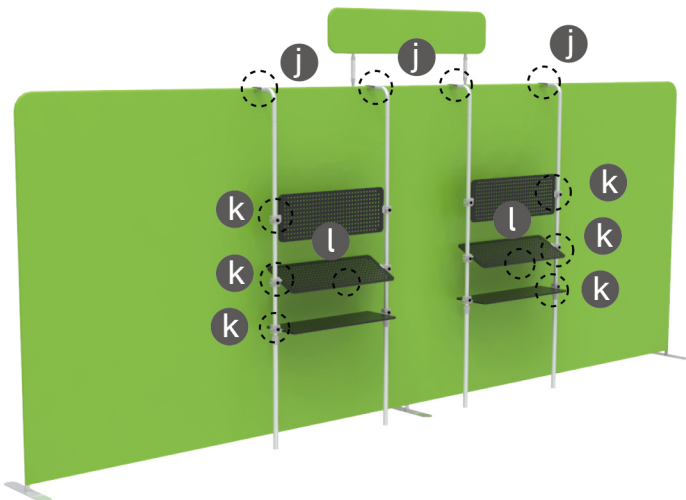

Clip into hanging boards based on directions of three-way clips & tightening with thumb screws, clip F-shaped bar onto hanging board with thumb screws.

STEP 05

Clamp display stands with S-shaped clips.

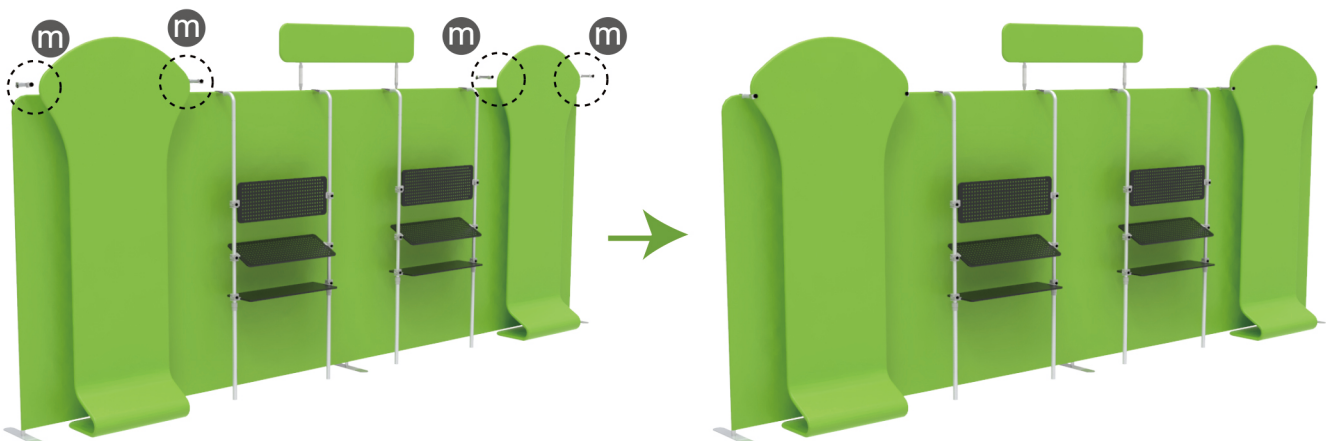
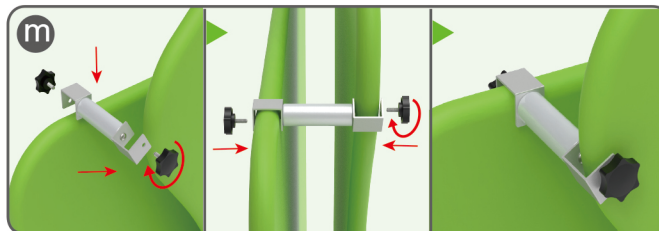

STEPS

STEP 06

Screw brackets onto display stand with hex wrench, insert shelves into slots.

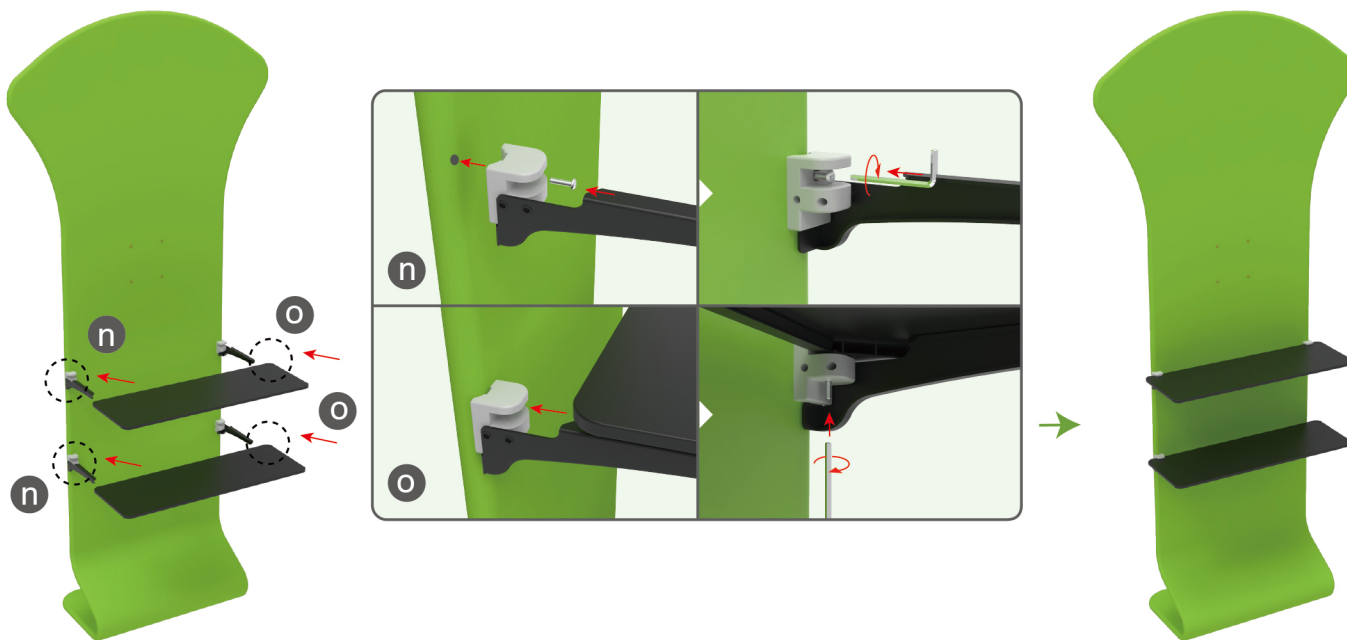

STEP 07

Screw TV mount onto display stand & support brackets onto TV's back with hex wrench, hang TV onto mount & screw.

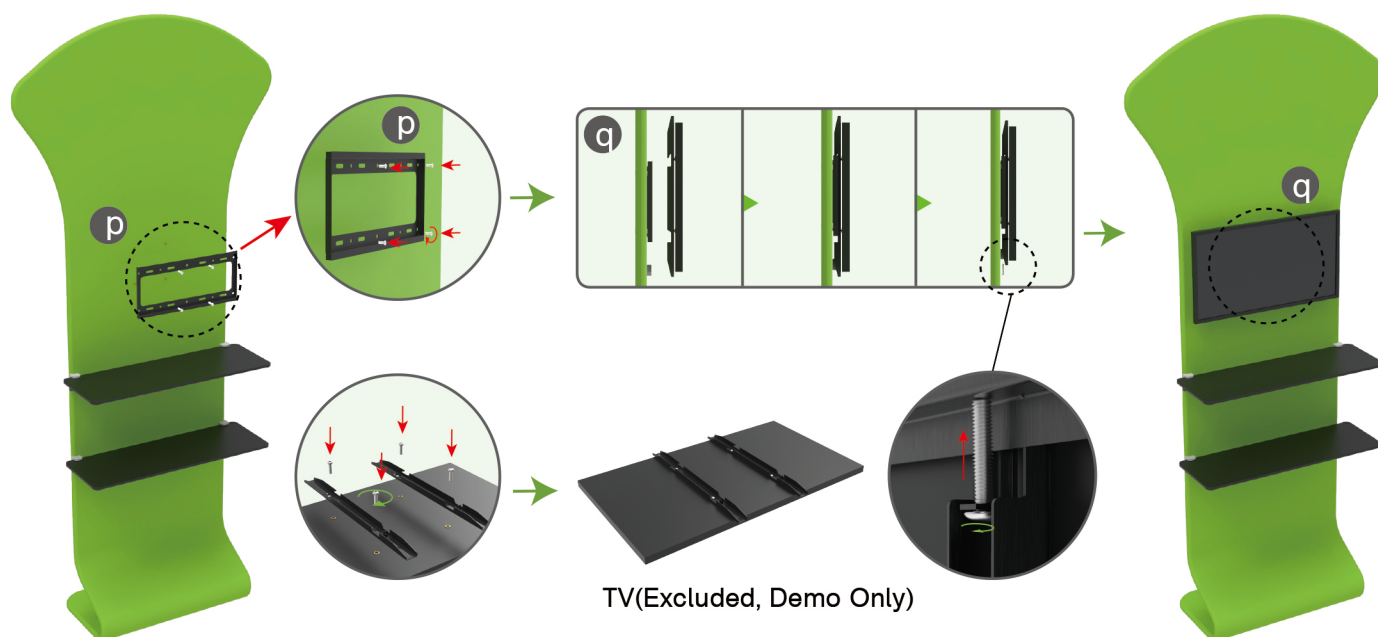

STEPS

STEP 08

Screw light clips at top of display stands, slide lights onto them and adjust their direction.

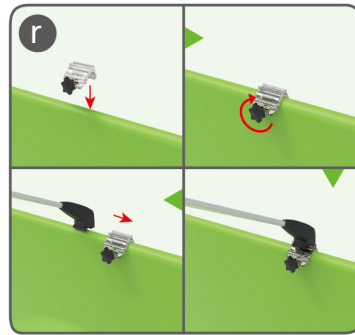
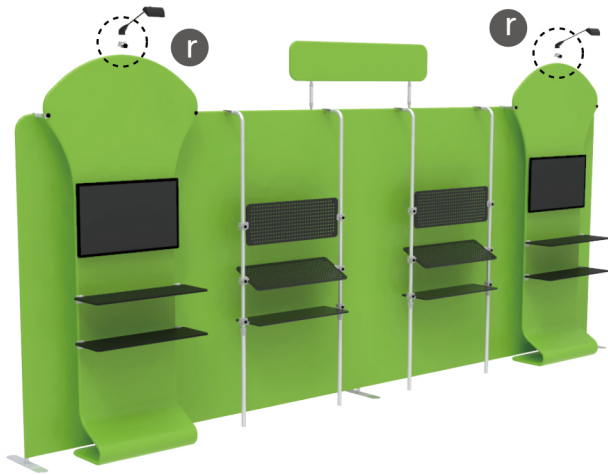

10X20FT-BOOTH-P

STEPS

(1) Durable Plastic Hard Case, Aluminum Support Poles



(2) Printed Graphic Fabric Banner



STEP 01

Put hard case's top into fabric banner.

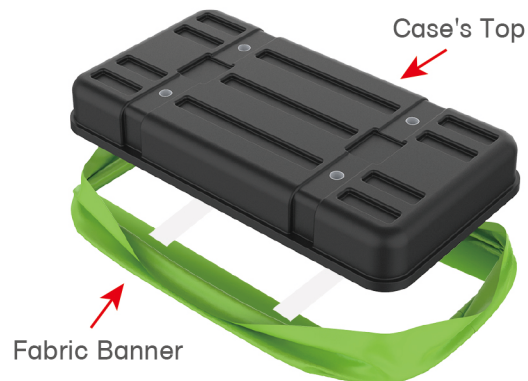

STEP 02

Insert support poles into hard case's top & bottom.

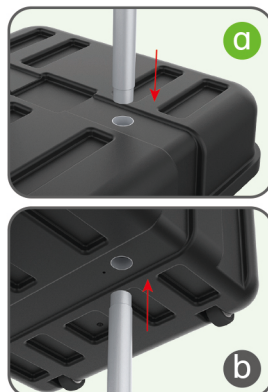
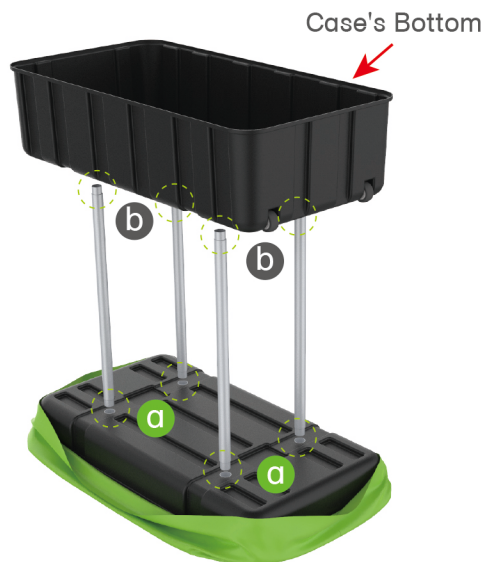

STEPS

STEP 04

Wrap fabric banner from bottom to top & twist it to be smooth, lay hard case's intermediate panel on podium's top.

