

## STEPS

## (1) Hardware

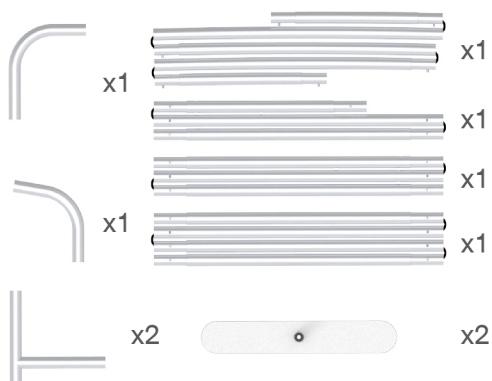

## (2) Printed Graphic Fabric Banner (Optional)



## STEP 01

Connect to make long poles according to labelings.

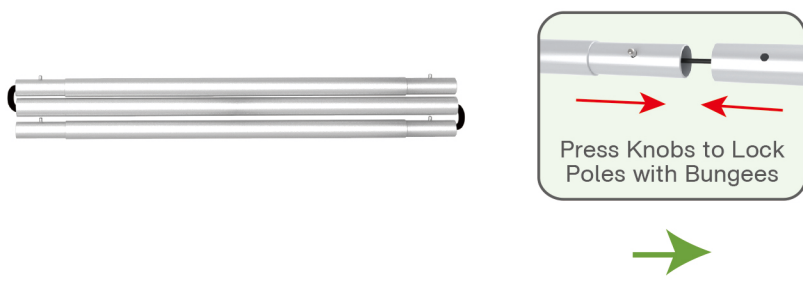

## STEP 02

Connect long poles with corner poles according to labelings, connect support pole onto frame.

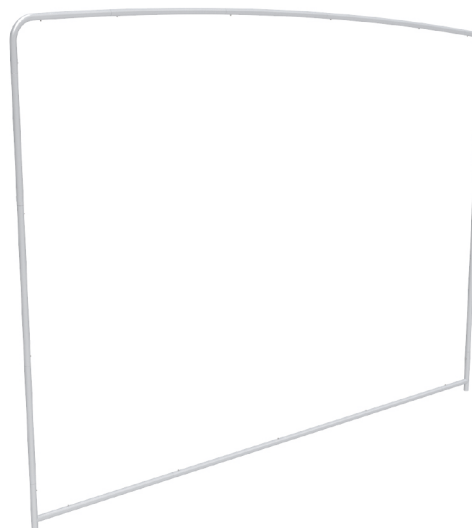
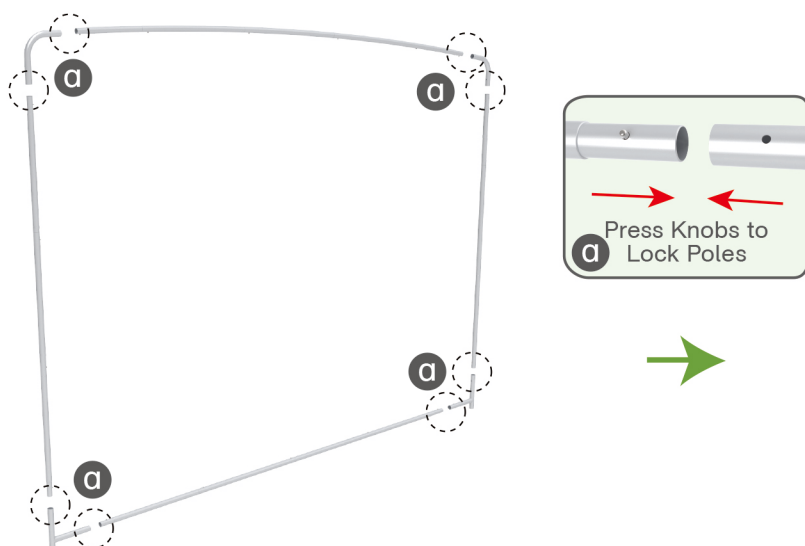

## STEPS

## STEP 03

Slide fabric banner on frame from top and zip up at bottom.

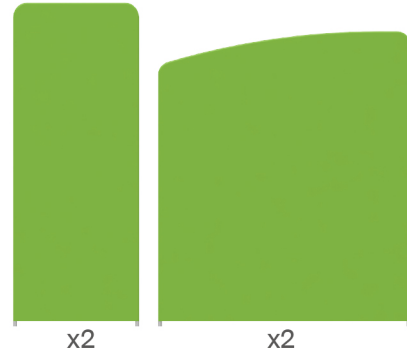
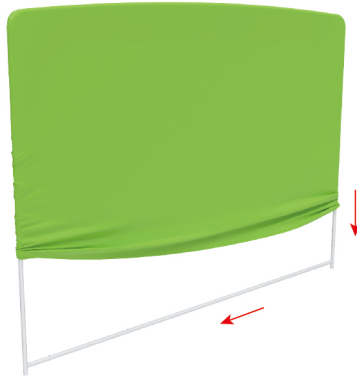

Same Steps for Other Display Stands

## (1) Hardware

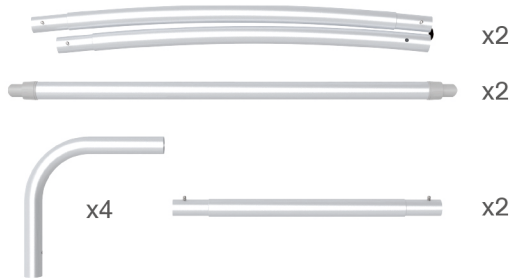

## (2) Printed Graphic Fabric Banner (Optional)



## STEP 01

Connect to make long poles according to labelings.

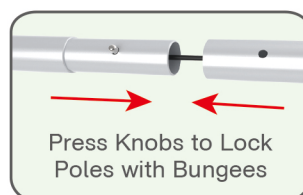

## STEP 02

Connect long poles with corner poles according to labelings.

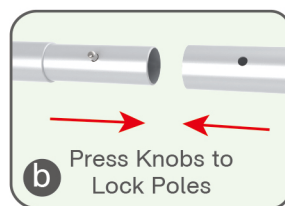
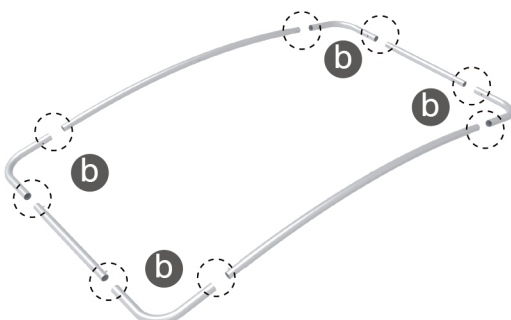

## STEPS

## STEP 03

Connect support poles onto frame.

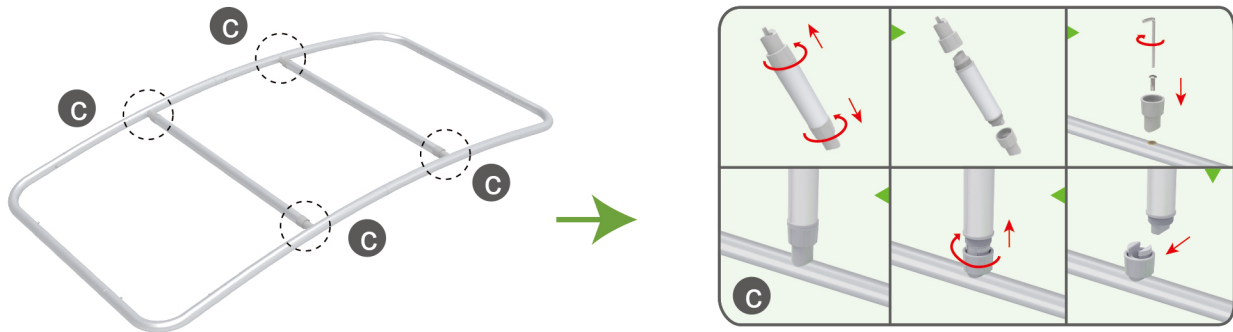

## STEP 04

Slide fabric banner on frame from left and zip up at right.

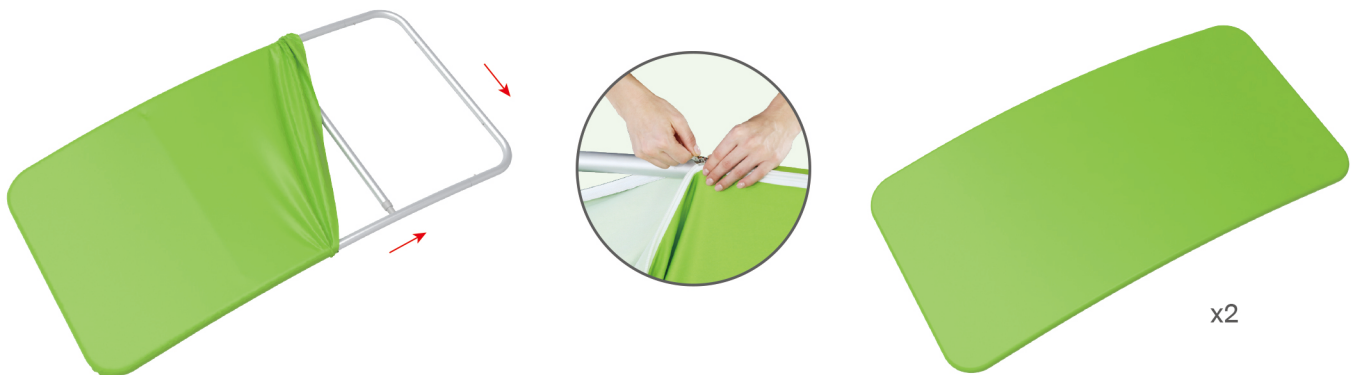

## Booth Set Assembly

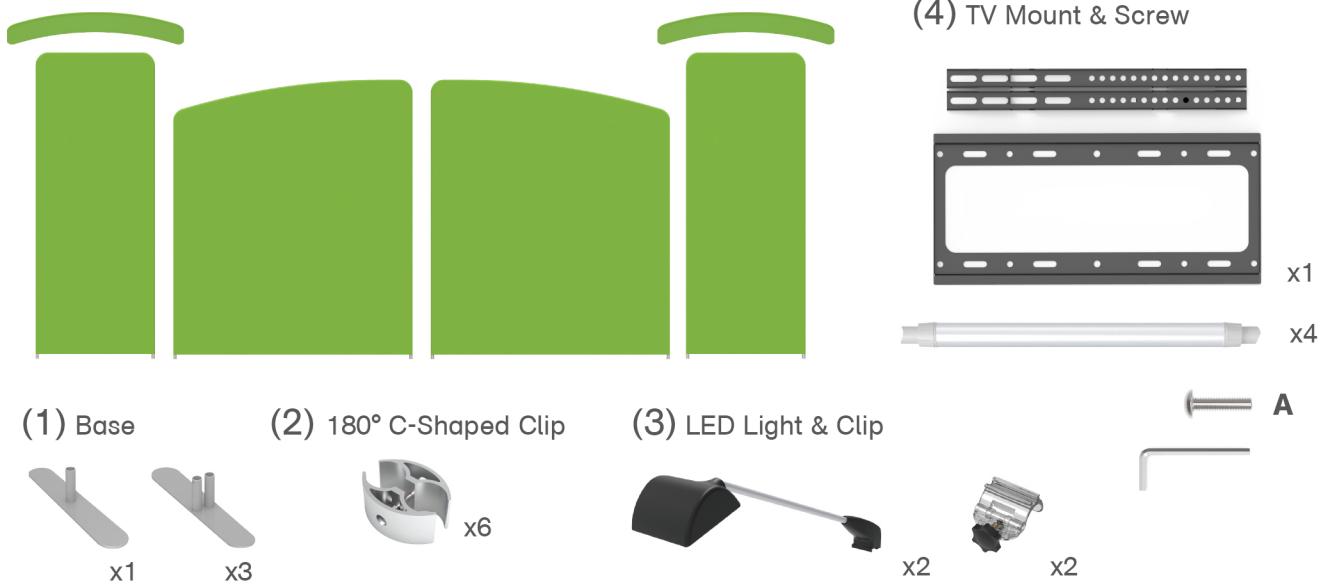

## STEPS

## STEP 01

Connect header and display stand with support poles.

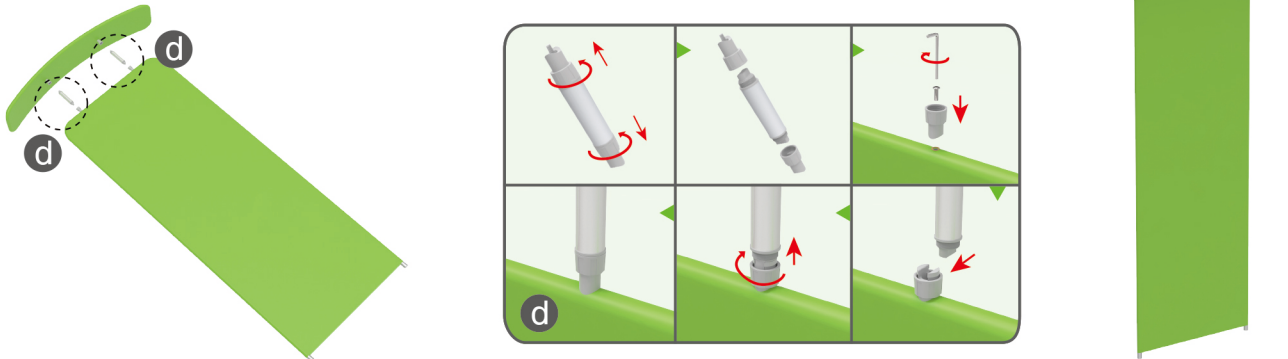

## STEP 02

Insert display stands onto feet by pressing their knobs.

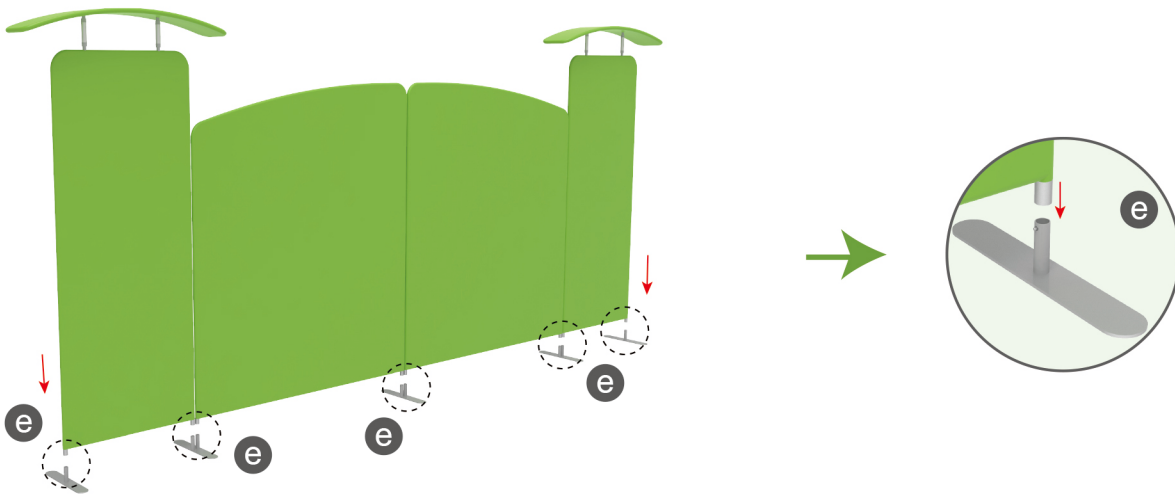

## STEP 03

Interconnect display stands with C-shaped clips.

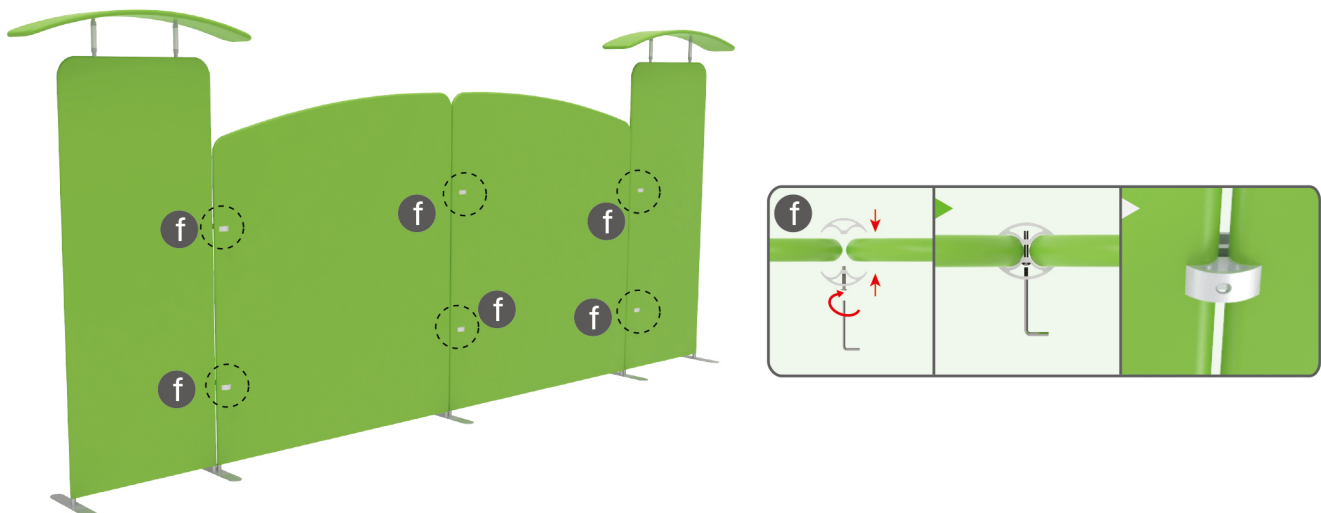

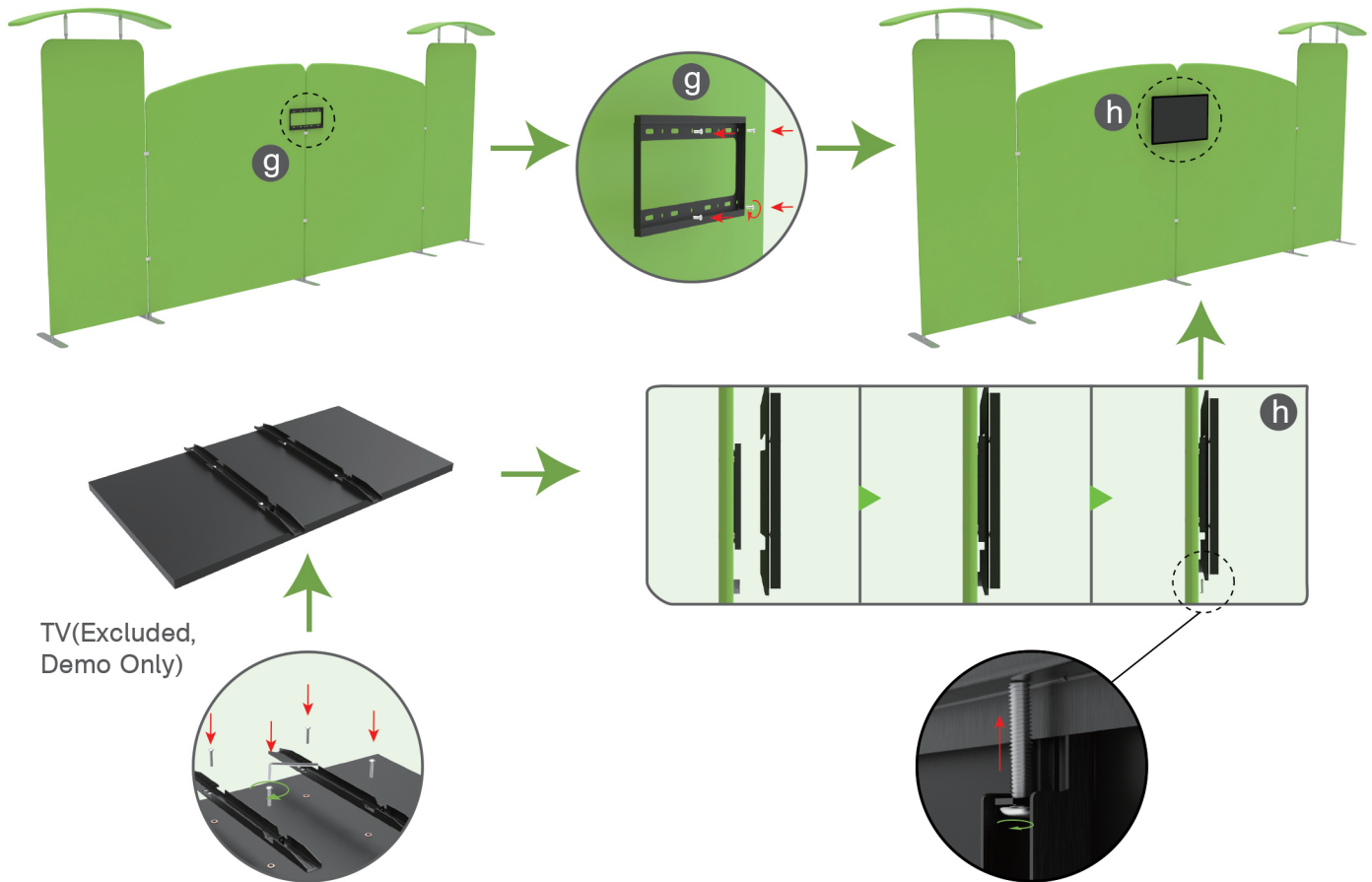

## STEPS

**STEP 04** Screw TV mount with hex wrench.**STEP 05**

Screw light clips at top of display stands, slide lights onto them and adjust their direction.

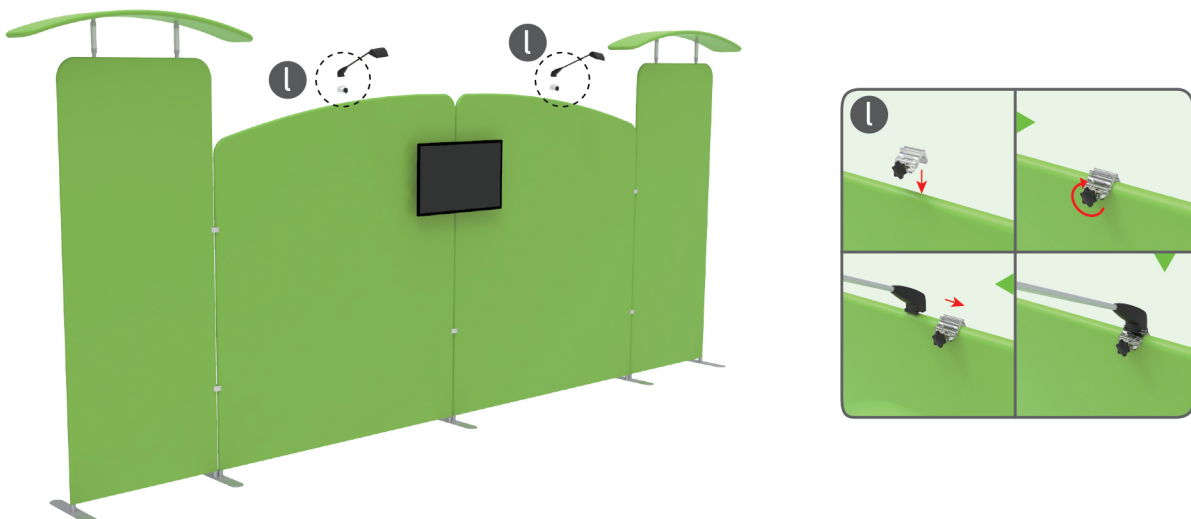

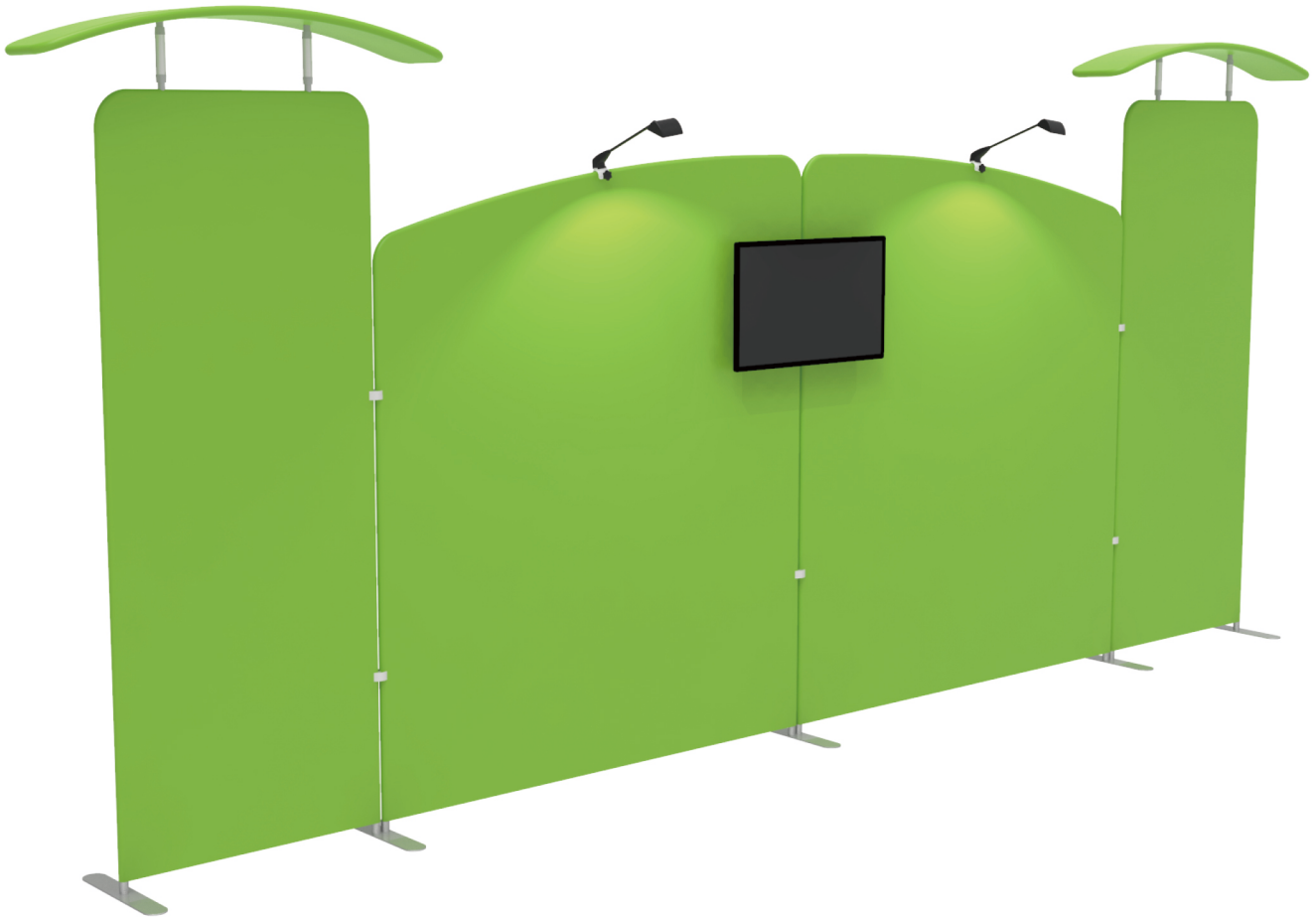
**STEPS****10X20FT-BOOTH-07**