

## STEPS

(1) Hardware

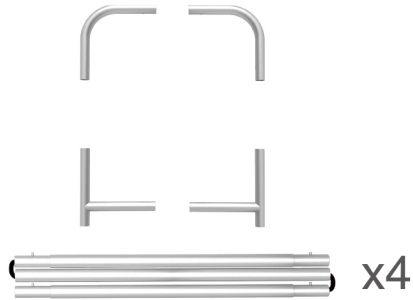
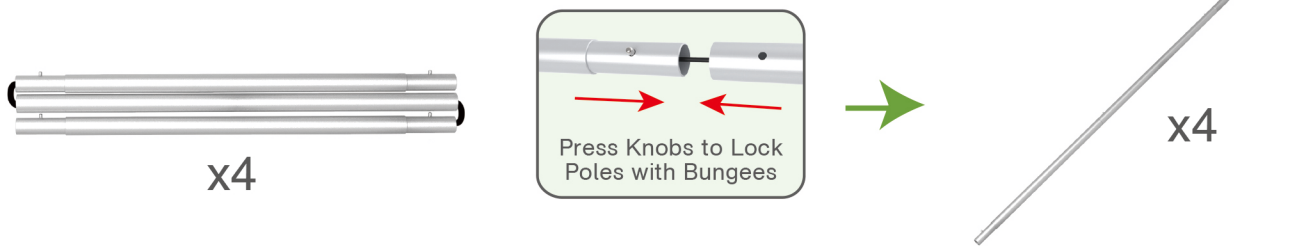
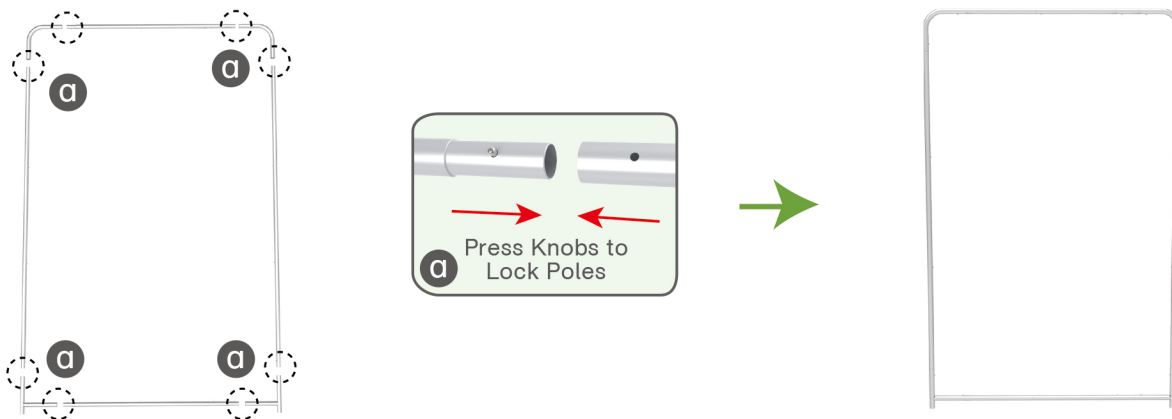
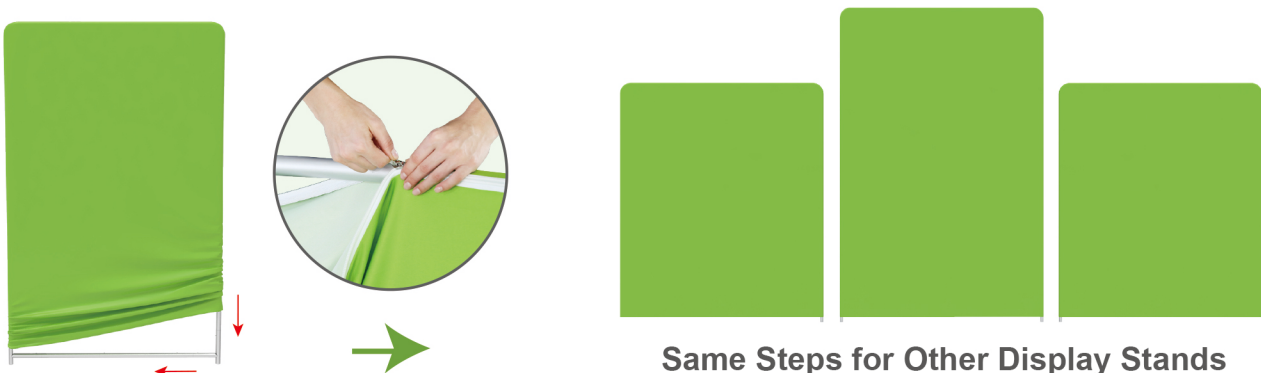

(2) Printed Graphic Fabric Banner (Optional)

**STEP 01** Connect to make long poles according to labelings.**STEP 02** Connect long poles with corner poles according to labelings.**STEP 03** Slide fabric banner on frame from top and zip up at bottom.

## STEPS

(1) Hardware

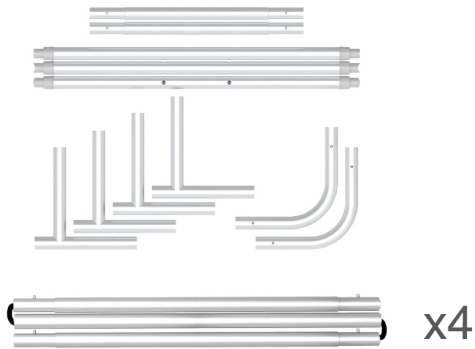

(2) Printed Graphic Fabric Banner (Optional)



## STEP 01

Connect to make long poles according to labelings.

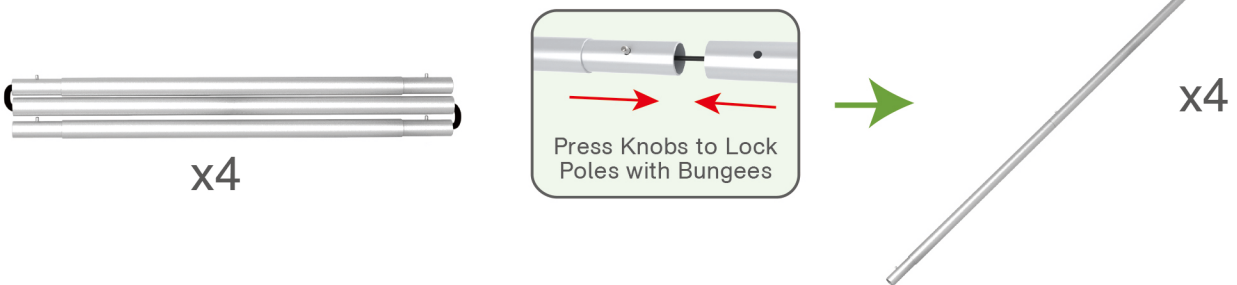

## STEP 02

Connect long poles with corner poles according to labelings.

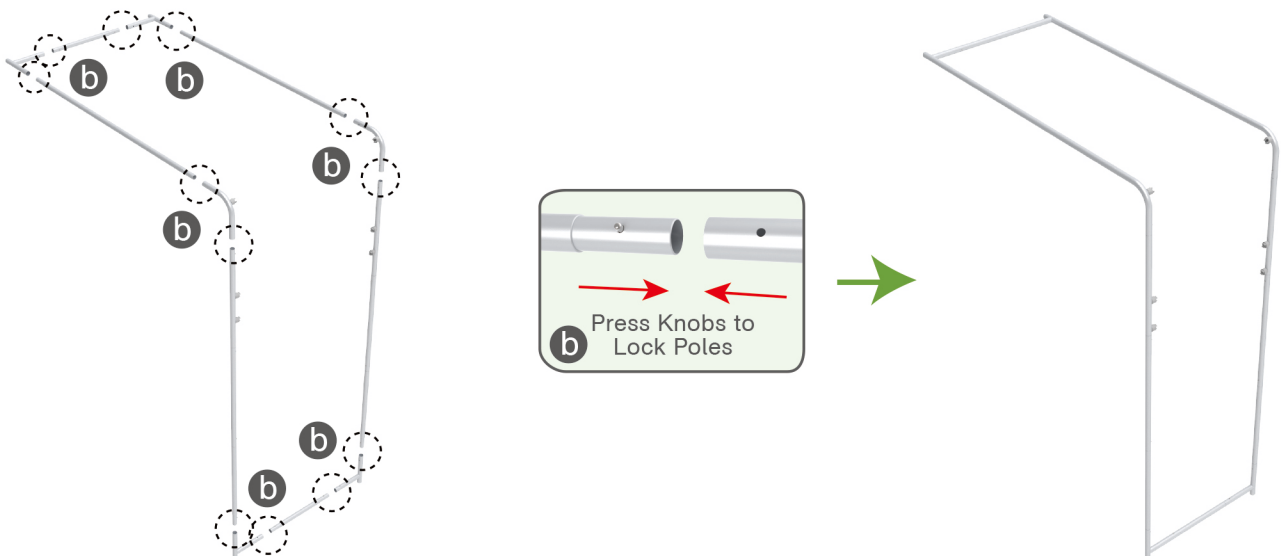

## STEPS

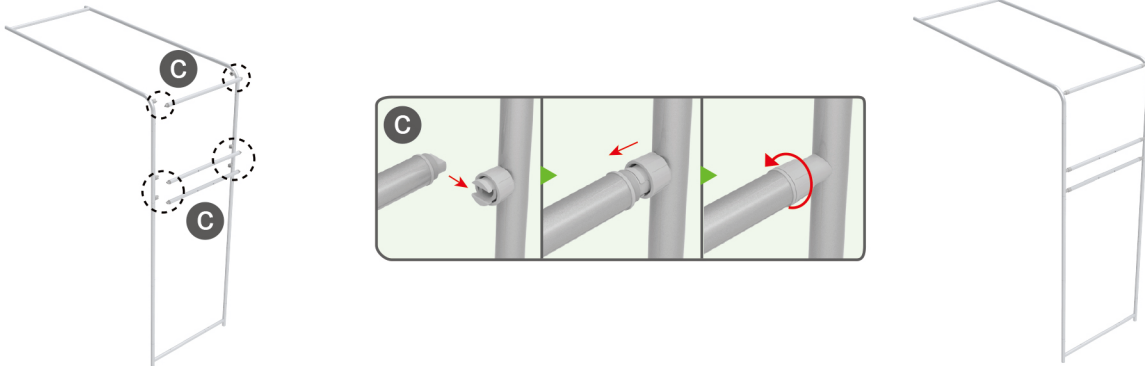
**STEP 03** Install cross bars in position.**STEP 04** Slide fabric banner on frame from top and zip up at bottom.

## Booth Set Assembly

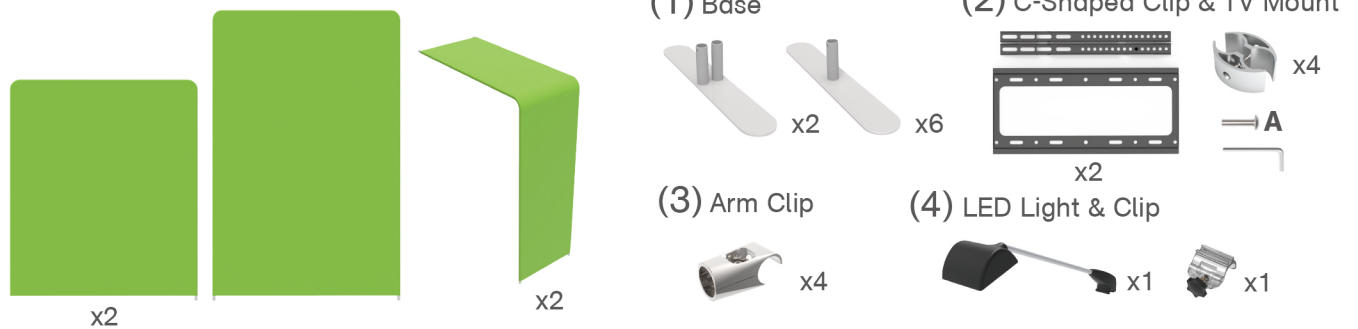
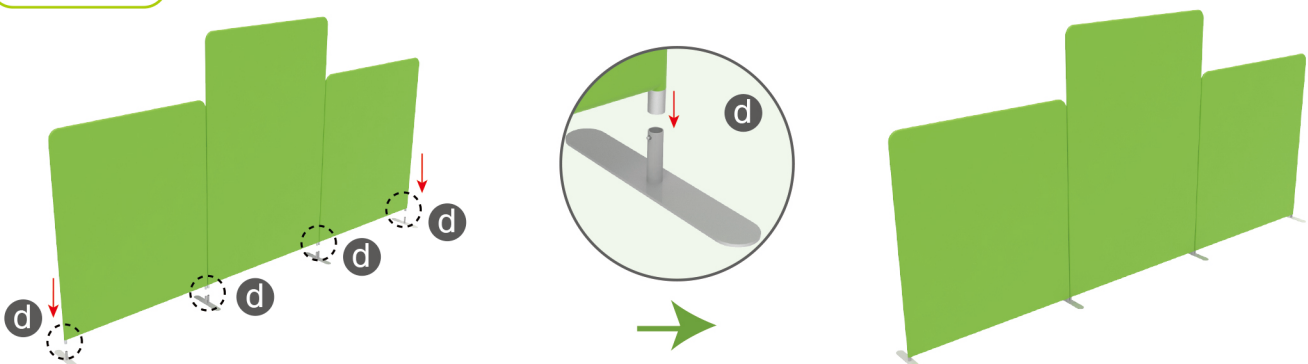
**STEP 01** Insert display stands onto feet by pressing their knobs.

## STEPS

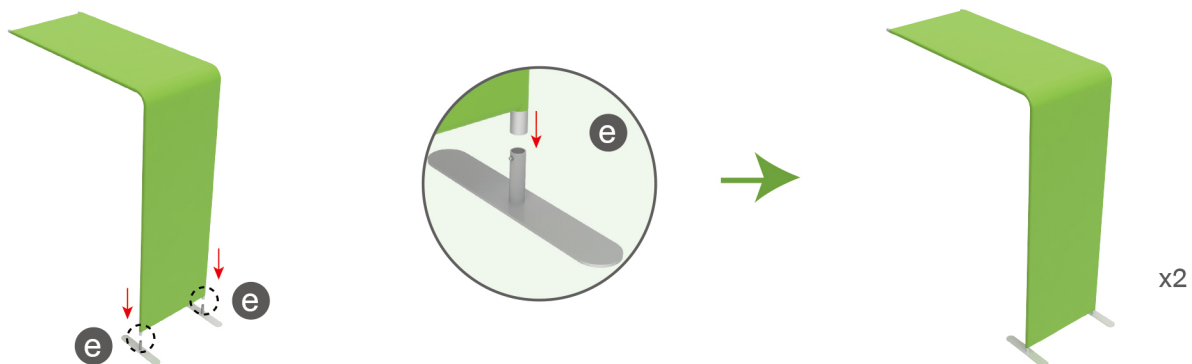

**STEP 02** Interconnect display stands with C-shaped clips.

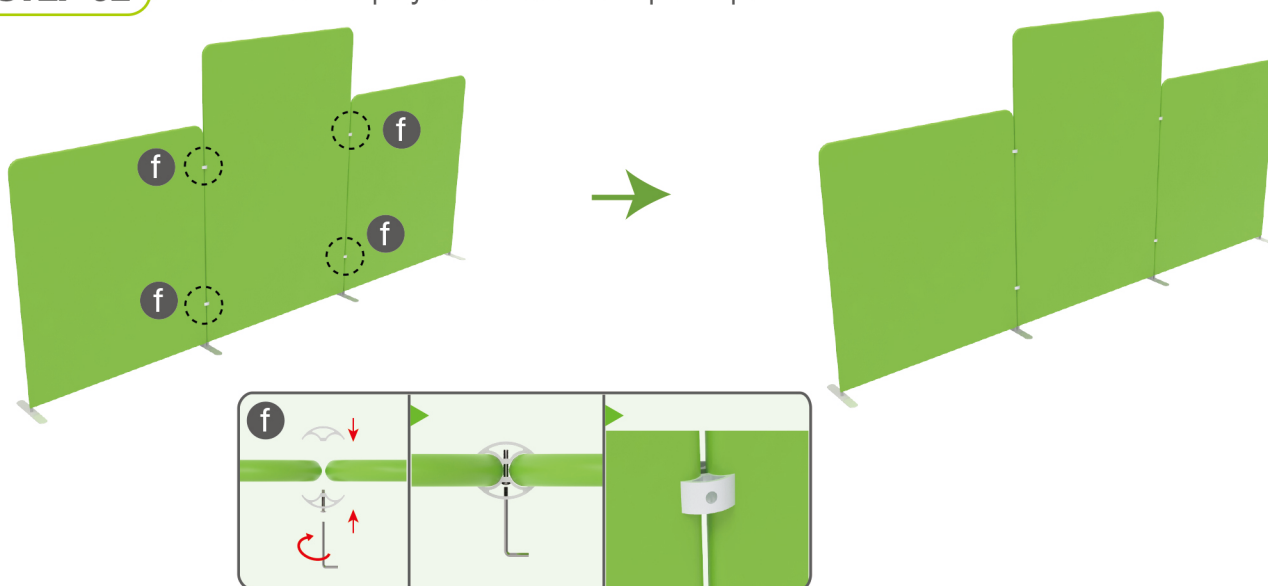

**STEP 03** Connect display stands with arm clips.

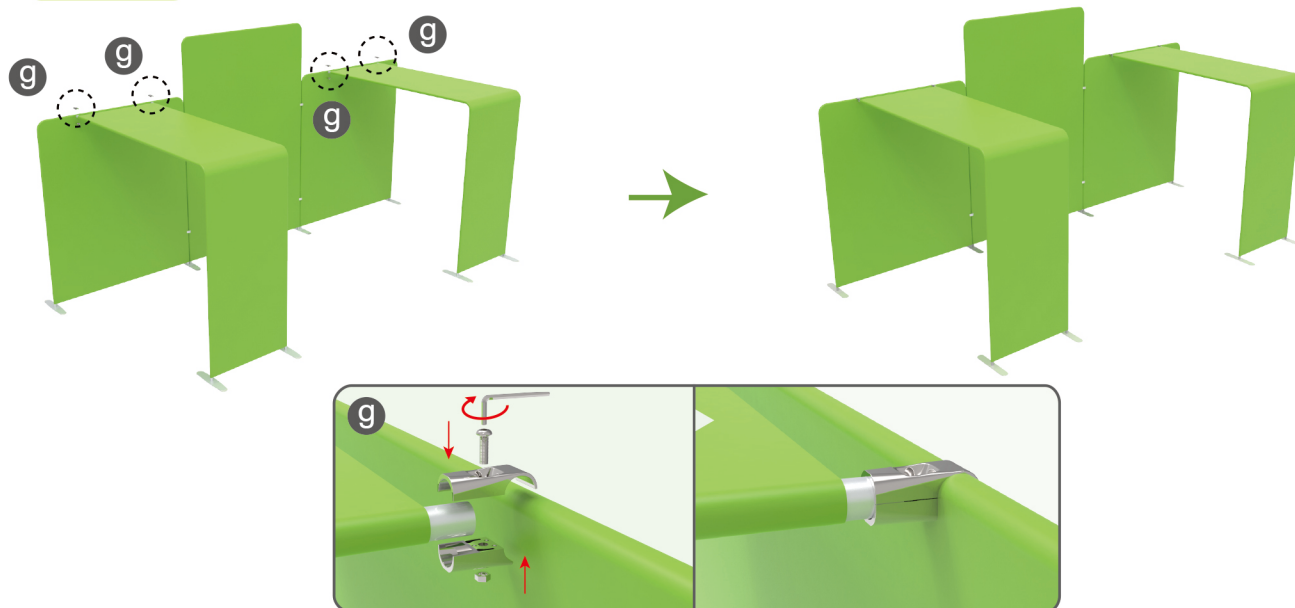

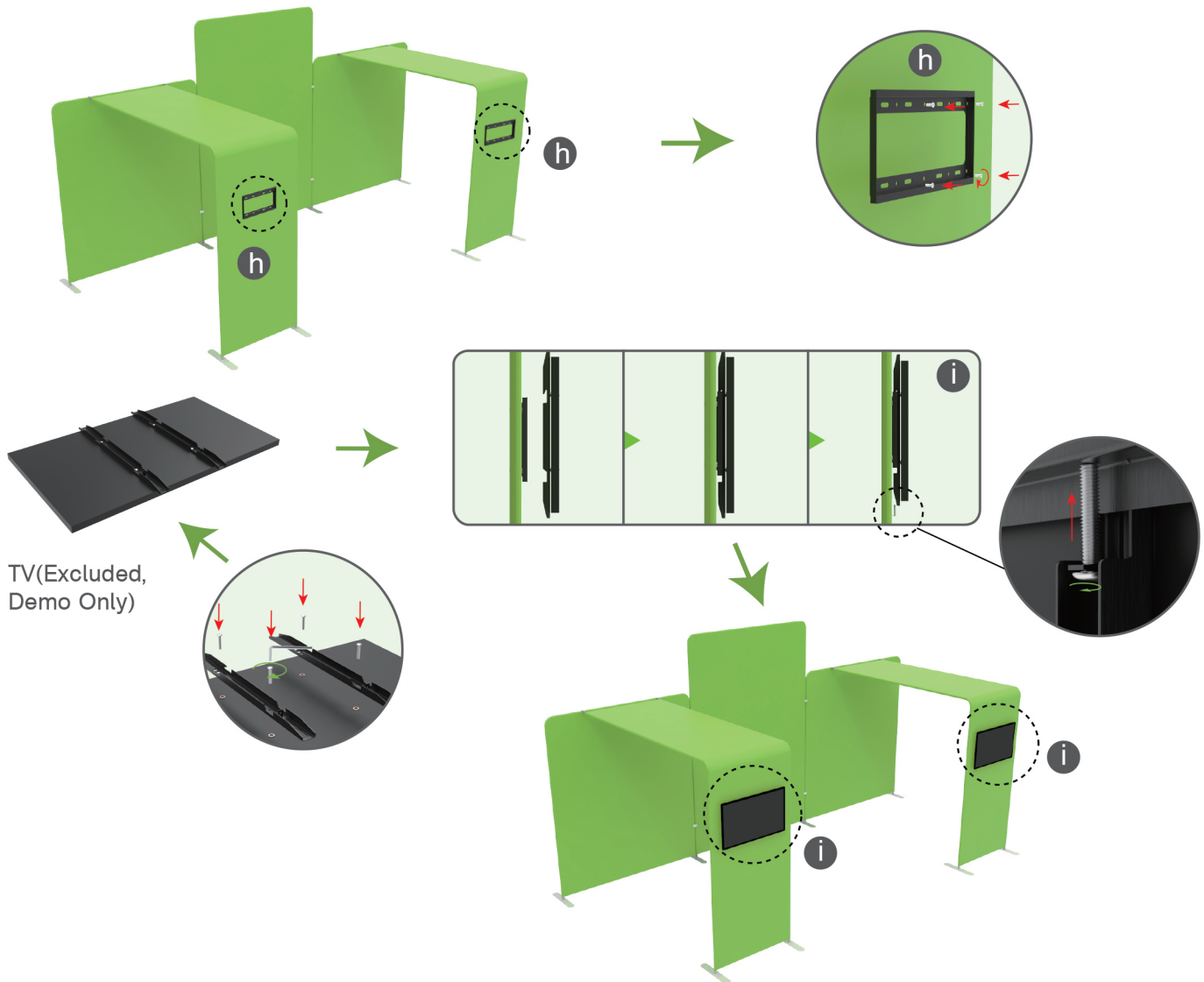
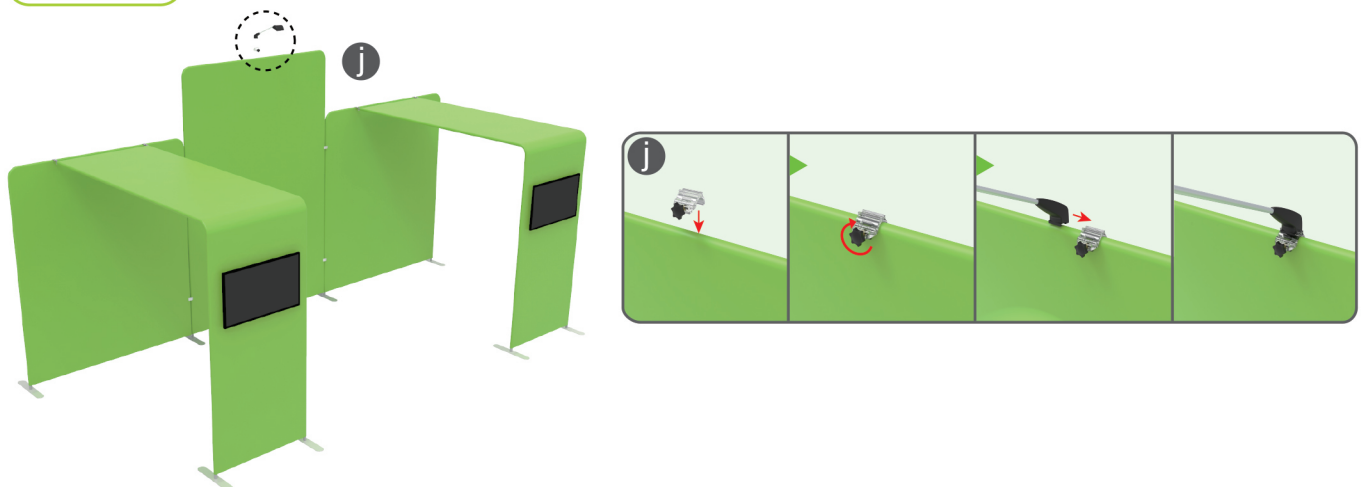

## STEPS

**STEP 04** Screw TV mount with hex wrench.**STEP 05** Screw light clips at top of display stands, slide lights onto them and adjust their direction.

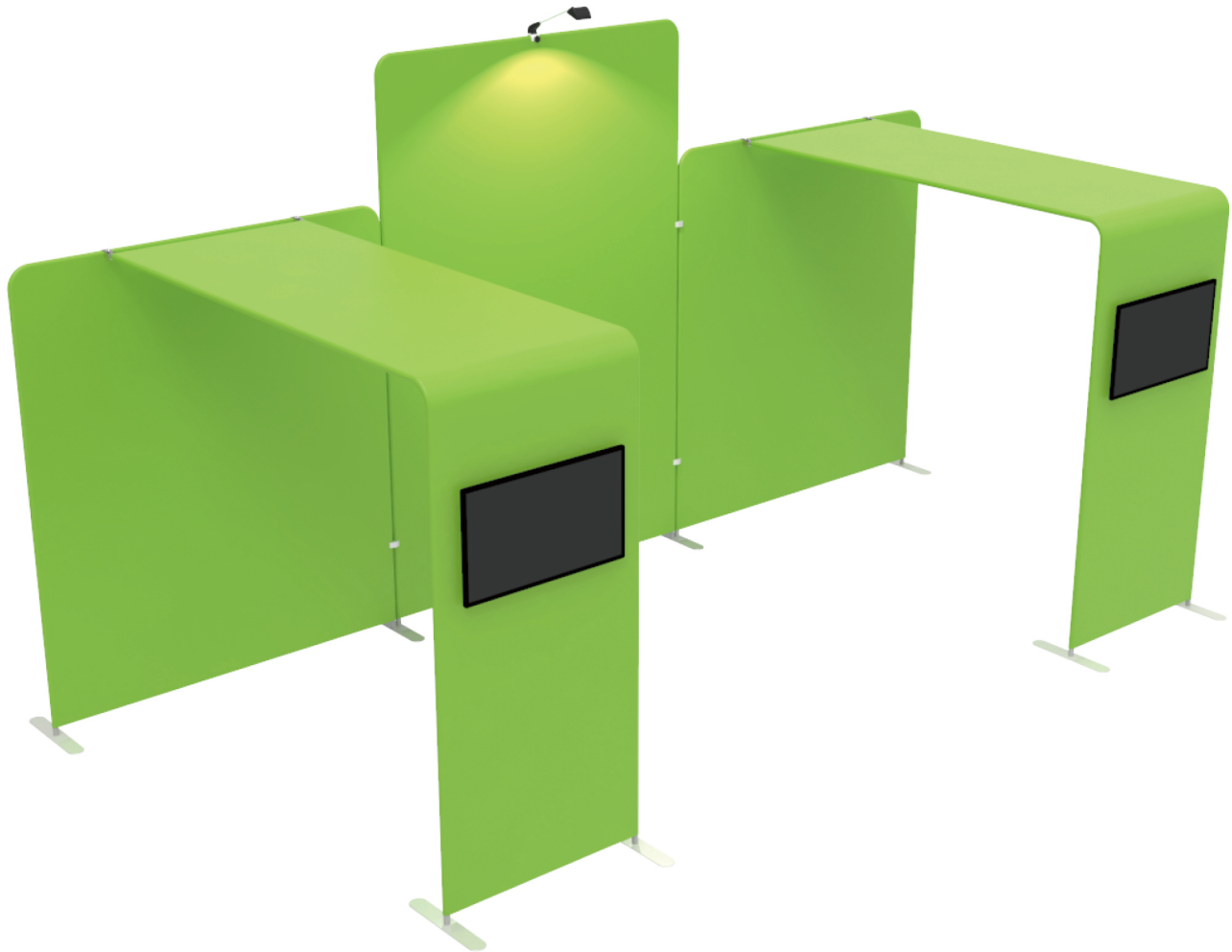
**STEPS****10X20FT-BOOTH-15**