

STEPS

(1) Hardware

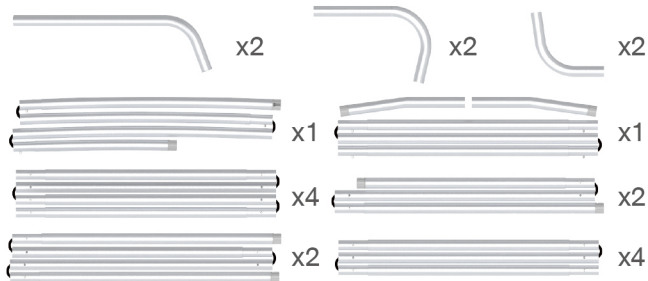

(2) Printed Graphic Fabric Banner (Optional)

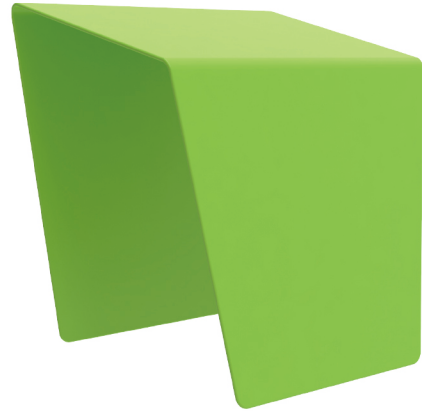

STEP 01

Connect to make long poles according to labelings.

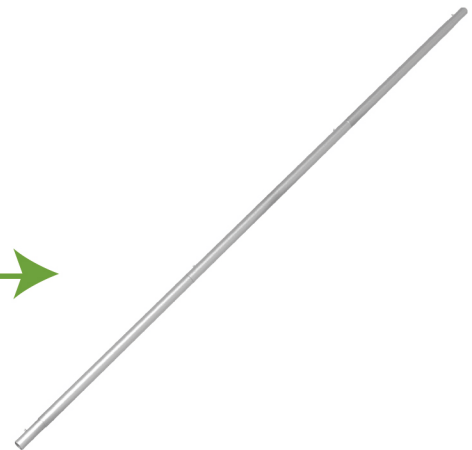
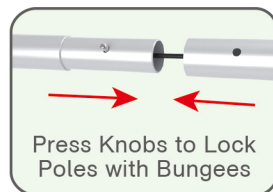

STEP 02

Connect support poles onto frame.

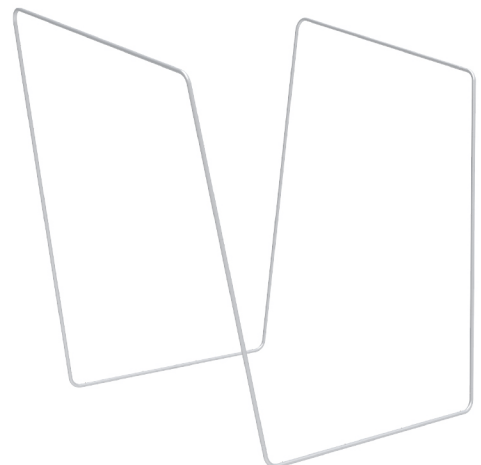
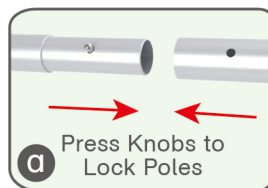
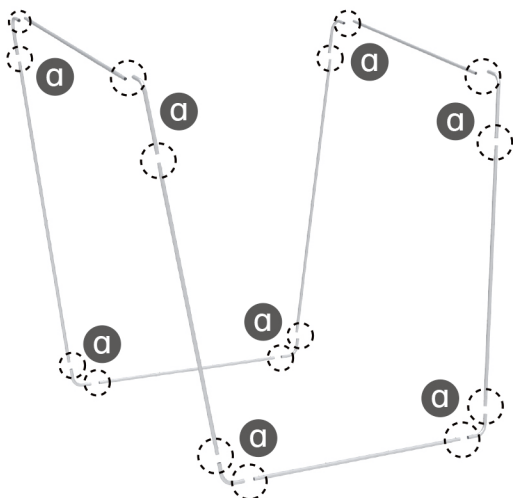

STEPS

STEP 03

Connect the support poles

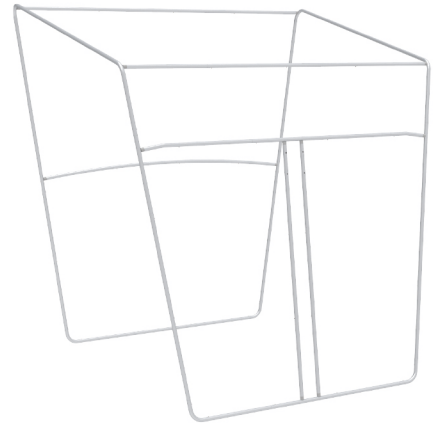
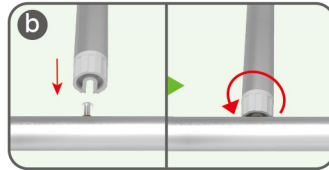
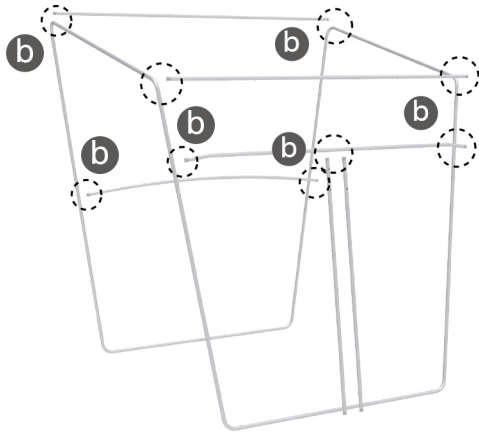

STEP 04

Wrap enclosure frame with fabric banner & zip up at top.

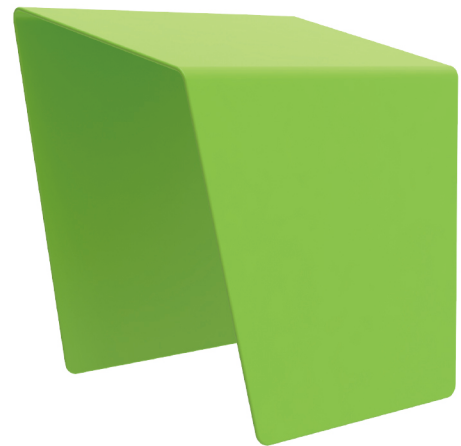
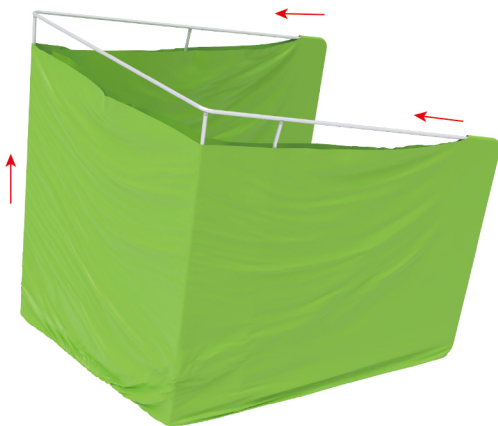

(1) Hardware

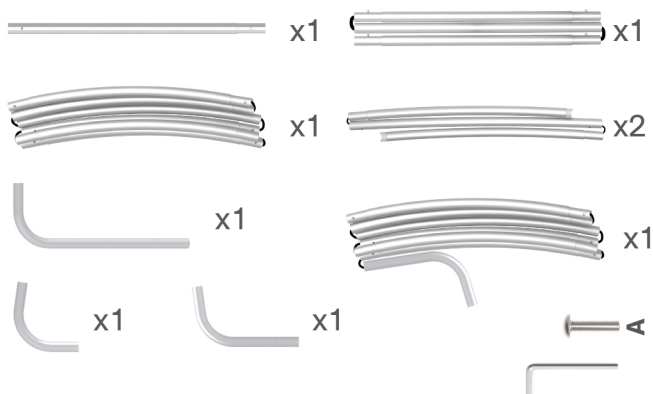

(2) Printed Graphic Fabric Banner (Optional)



STEPS

STEP 01

Connect to make long poles according to labelings.

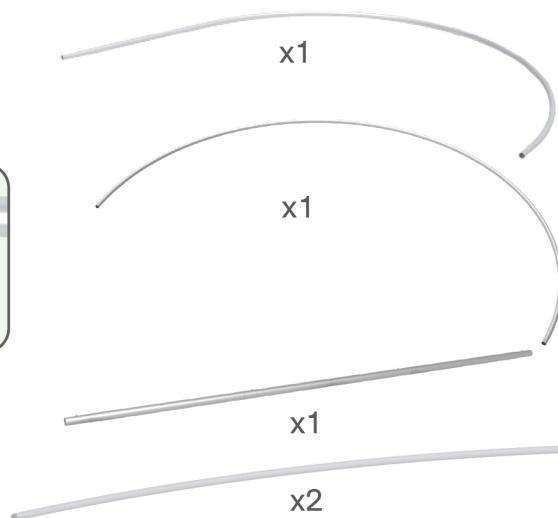
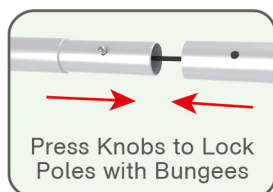

STEP 02

Connect long poles with corner poles according to labelings.

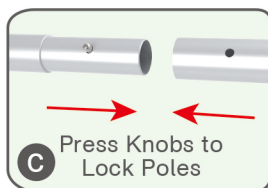
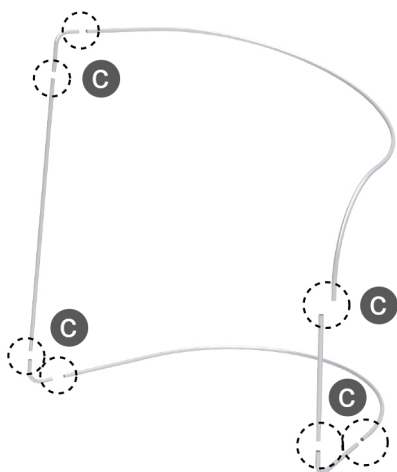

STEP 03

Connect support poles onto frame.

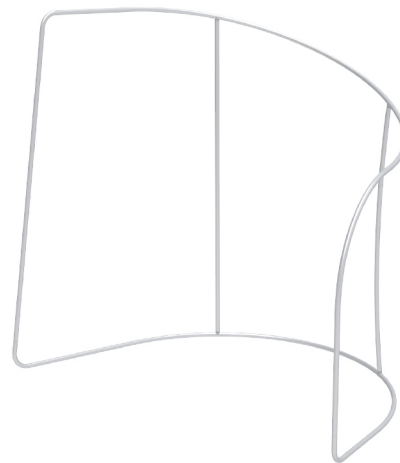
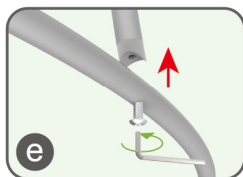
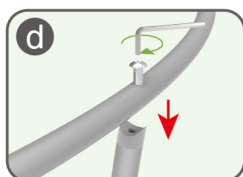
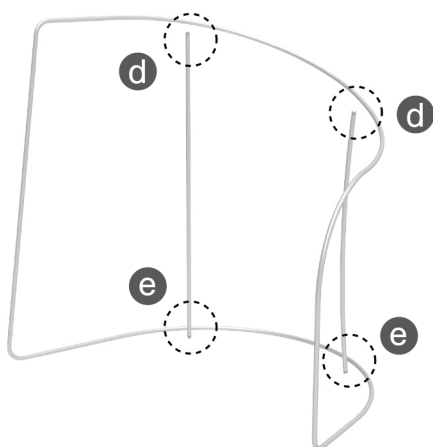

★ One Tool (Hex Wrench) 

STEPS

STEP 04

Slide fabric banner on frame from bottom and zip up at top.

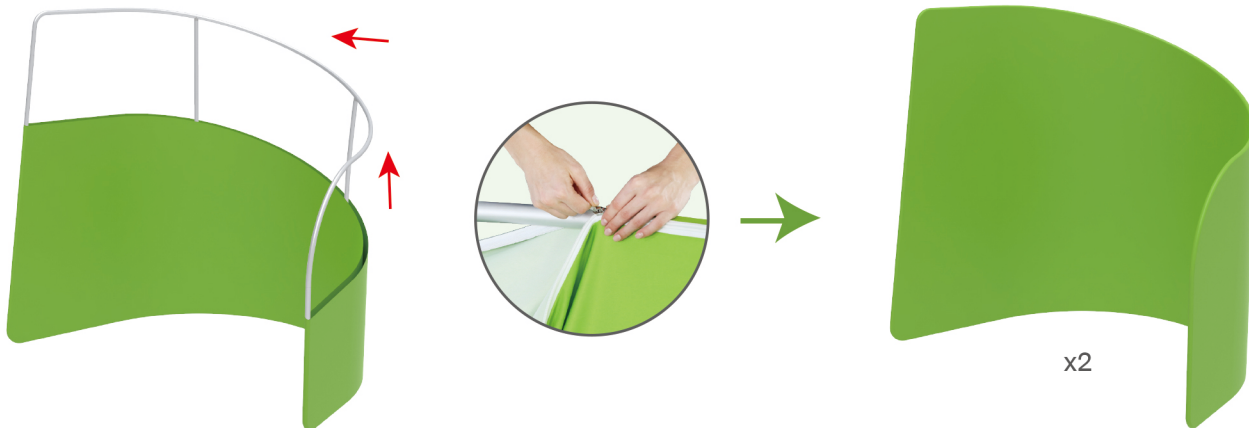

Booth Set Assembly

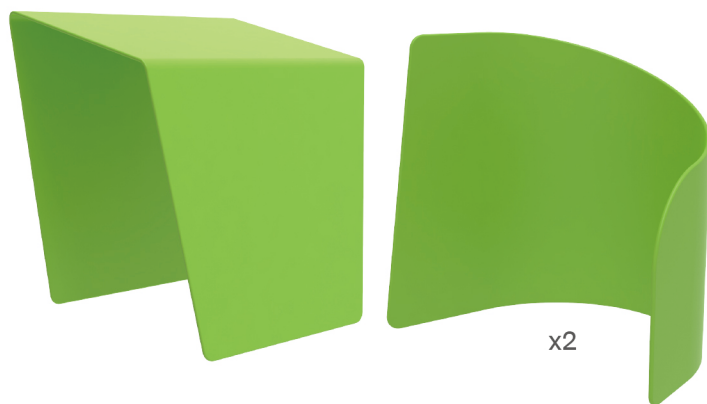

(1) 180° C-Shaped Clip

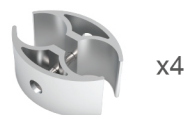

(2) TV Mount

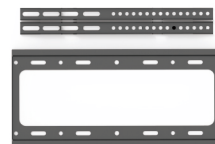

(3) LED Light & Clip

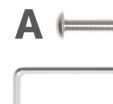

STEP 01

Screw TV mount with hex wrench.

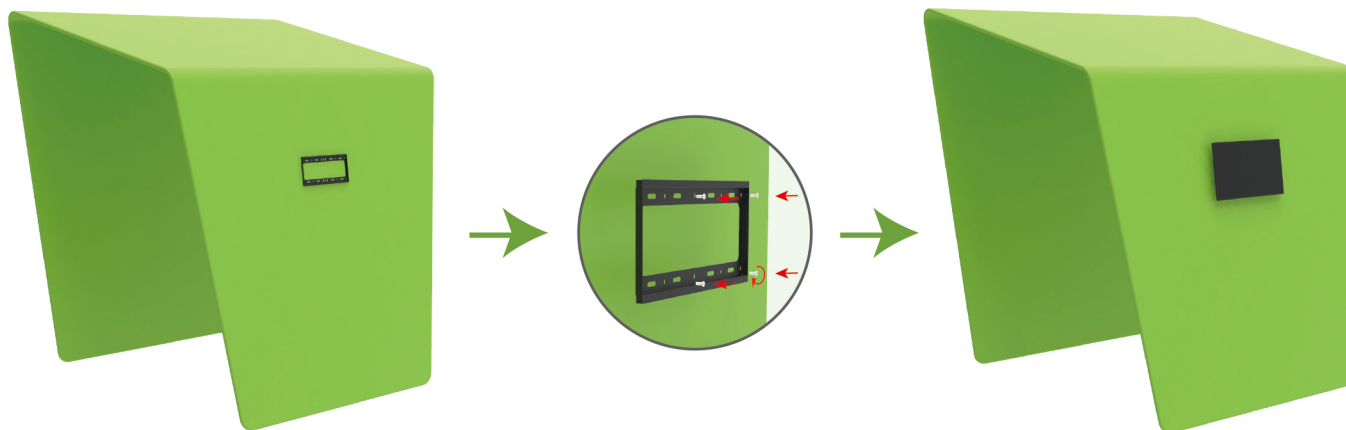

STEPS

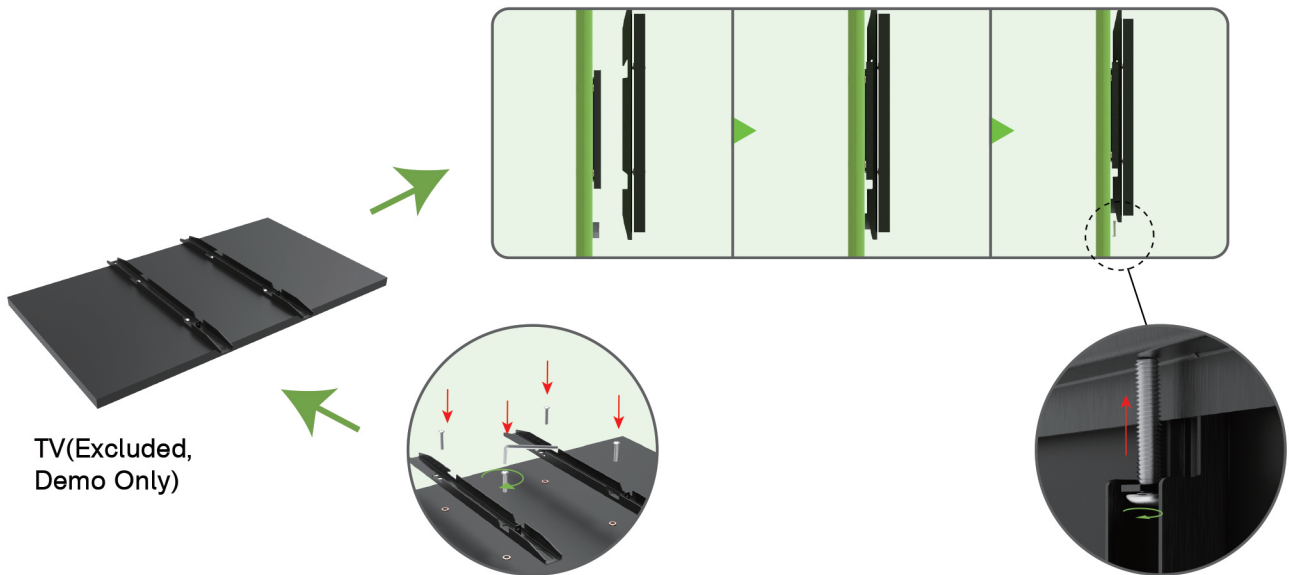
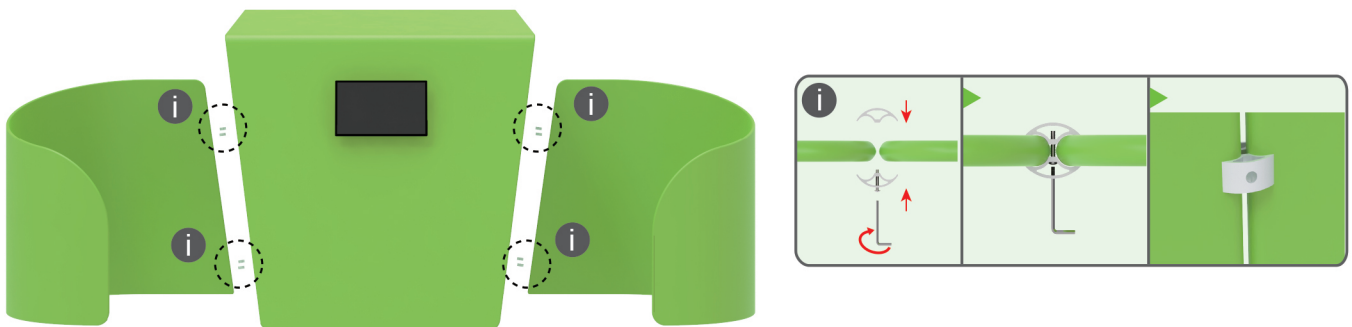
**STEP 02** Interconnect display stands with C-shaped clips.**STEP 03**

Screw light clips at top of display stands, slide lights onto them and adjust their direction.

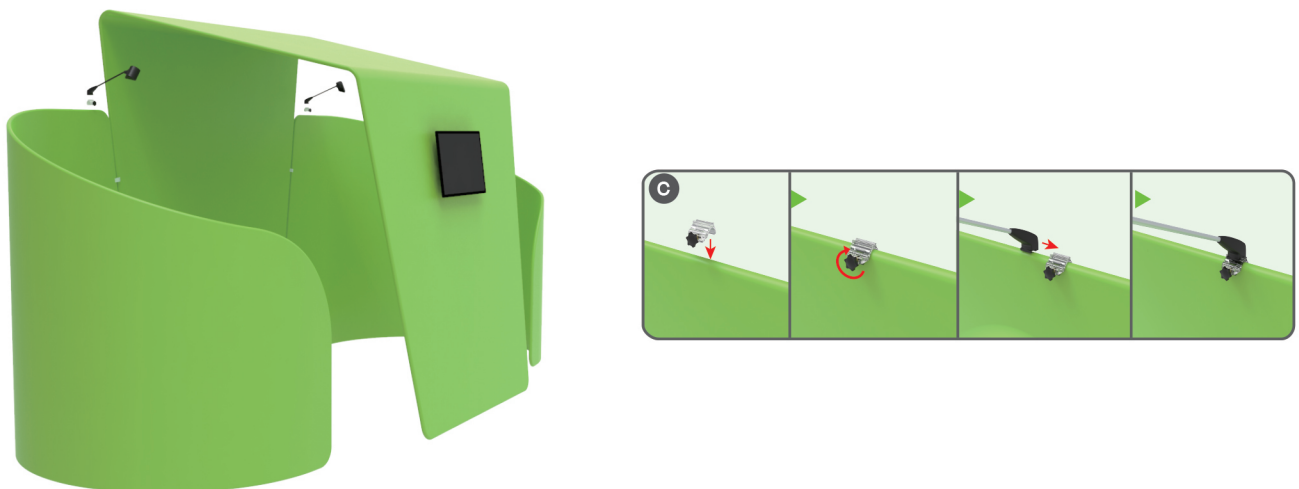

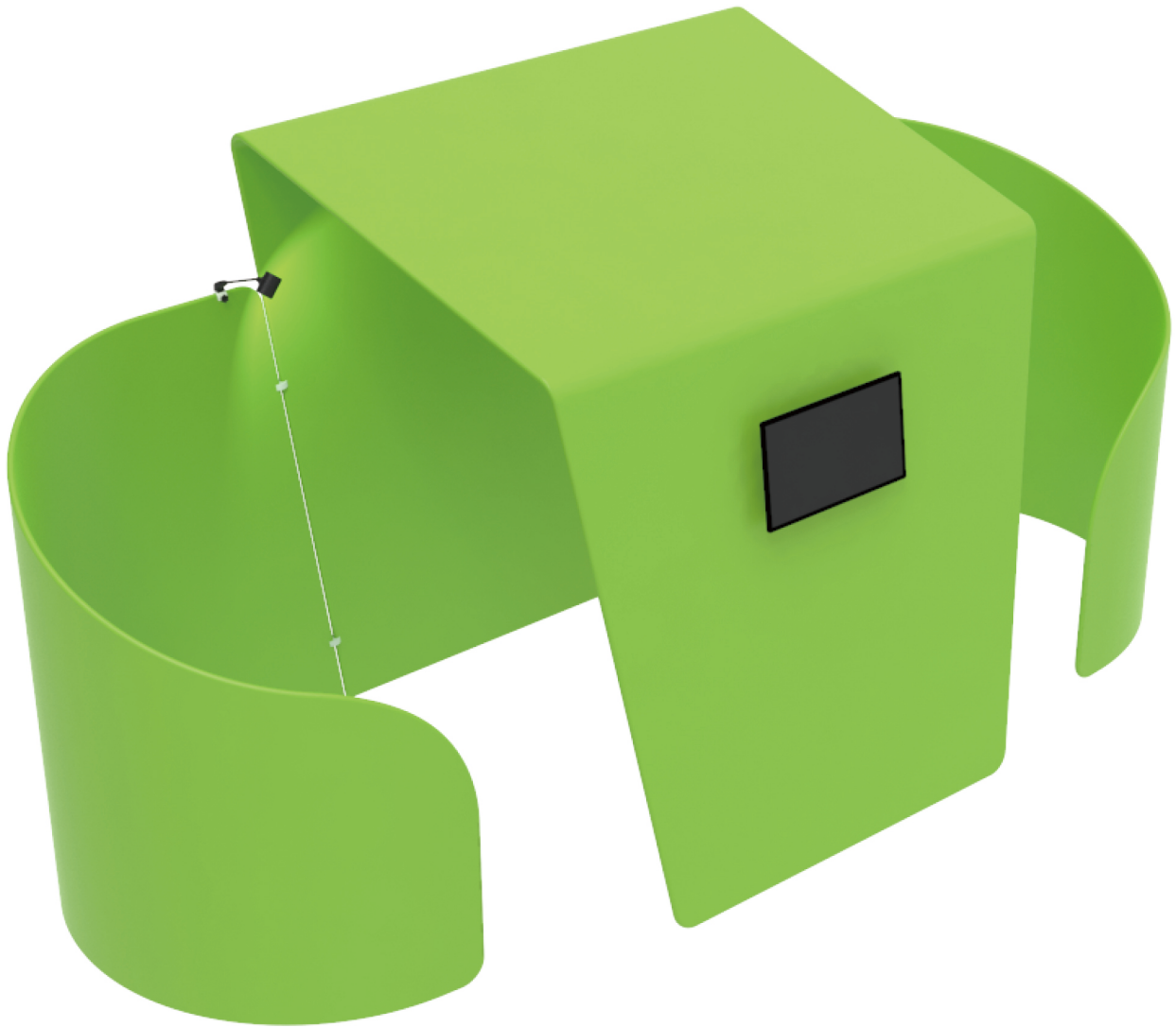
STEPS**10X20FT-BOOTH-T**