

STEPS

(1) Hardware

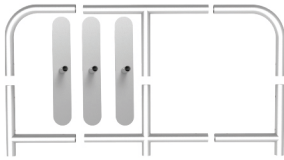

x3



x4

(2) Printed Graphic Fabric Banner (Optional)



STEP 01

Connect to make long poles according to labelings.



x3

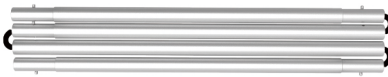

x4

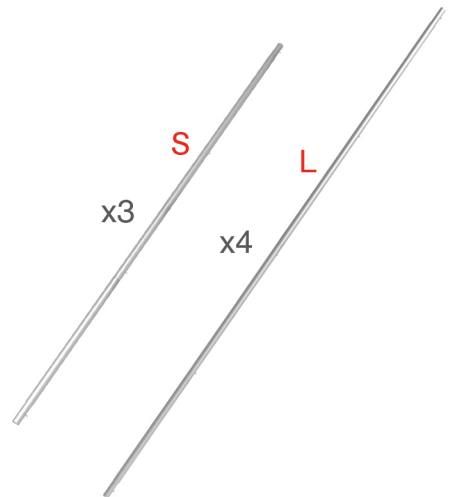
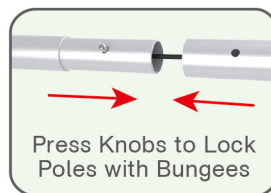

STEP 02

Connect long poles with corner poles according to labelings.

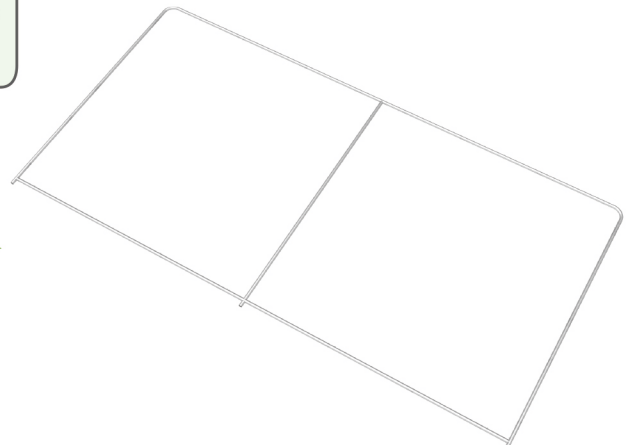
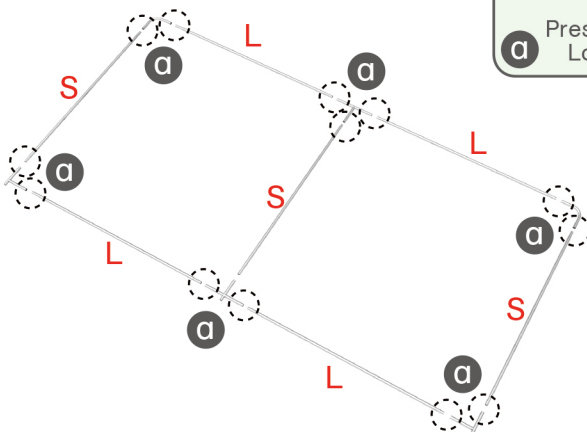
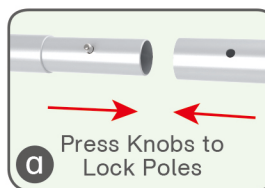

STEPS

STEP 03

Slide fabric banner on frame from top and zip up at bottom.



(1) Hardware

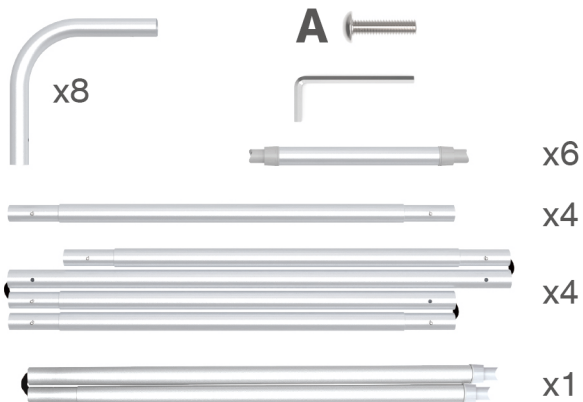

(2) Printed Graphic Fabric Banner (Optional)



STEP 01

Connect to make long poles according to labelings.

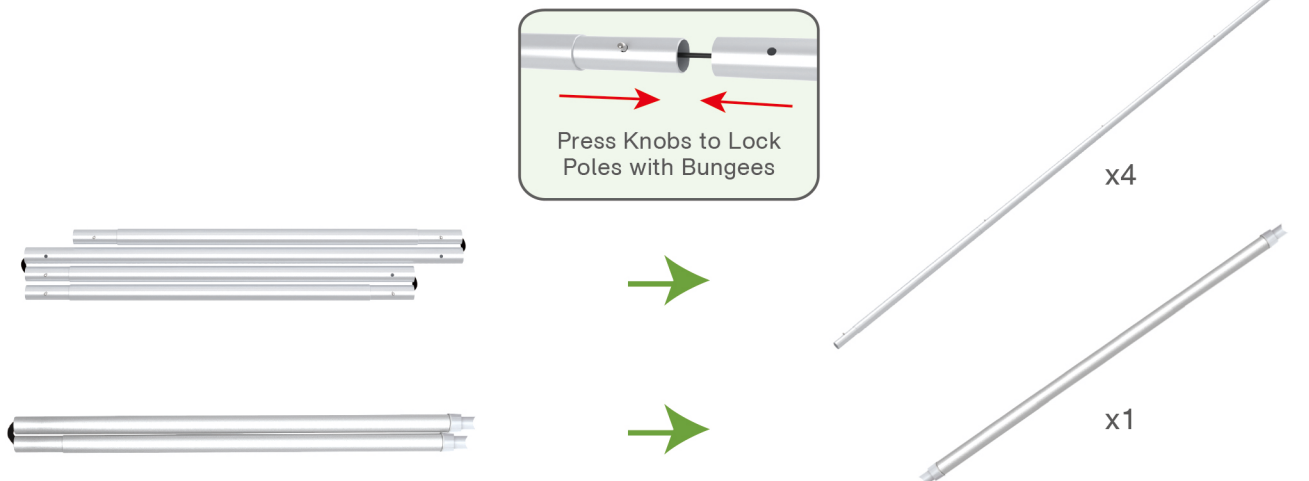

STEPS

STEP 02

Connect long poles with corner poles according to labelings.

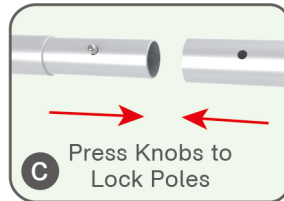
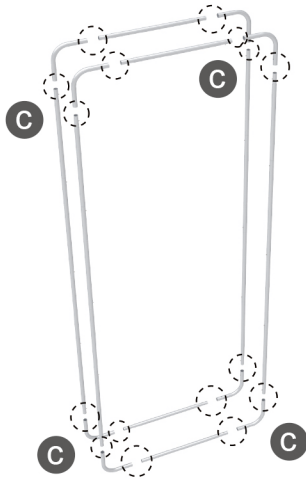

STEP 03

Connect support poles onto column frame.

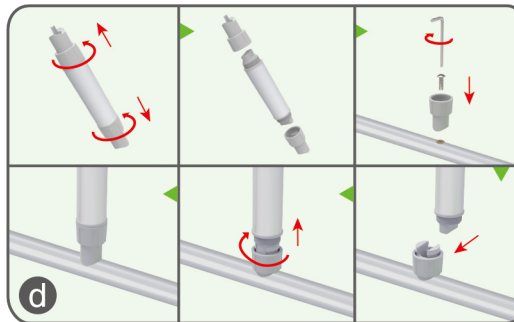
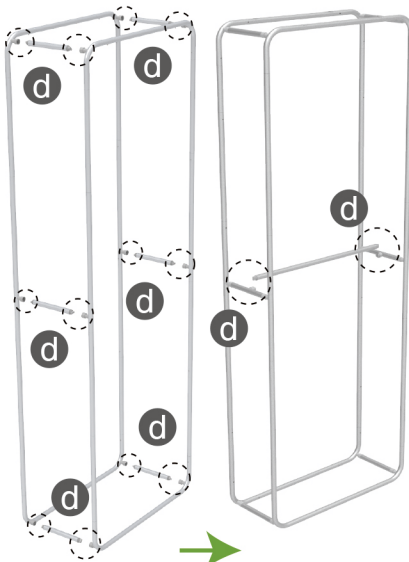

STEP 04

Slide fabric banner on frame from top and zip up at bottom.

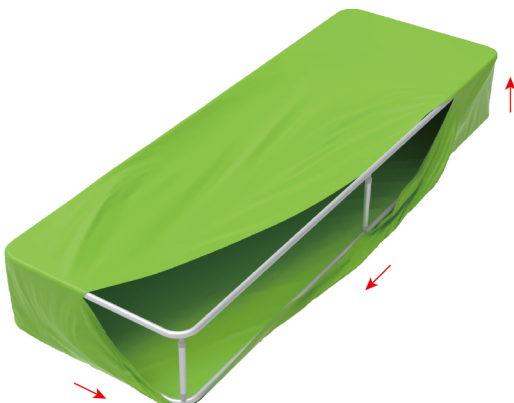

x3

STEPS

(1) Hardware



(2) Printed Graphic Fabric Banner (Optional)



STEP 01

Connect to make long poles according to labelings.

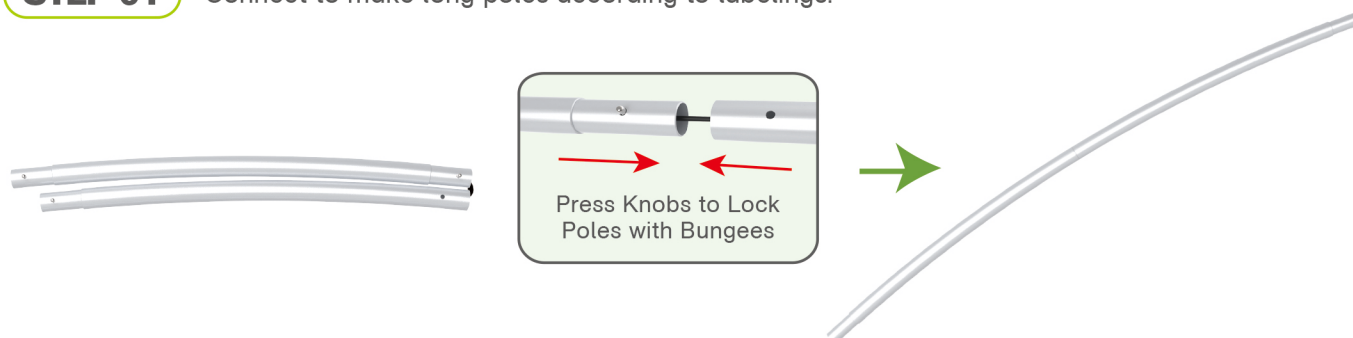

STEP 02

Connect long poles with corner poles according to labelings.

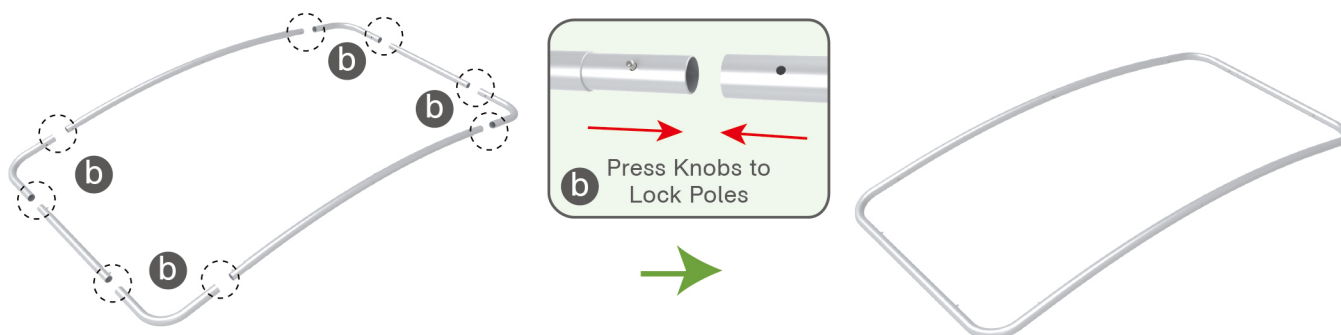

STEP 03

Connect support poles onto frame.

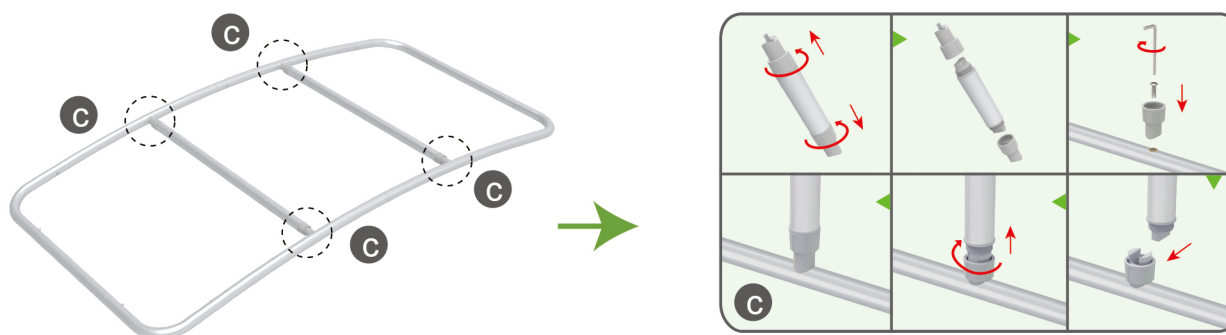

STEPS

STEP 04 Slide fabric banner on frame from left and zip up at right.

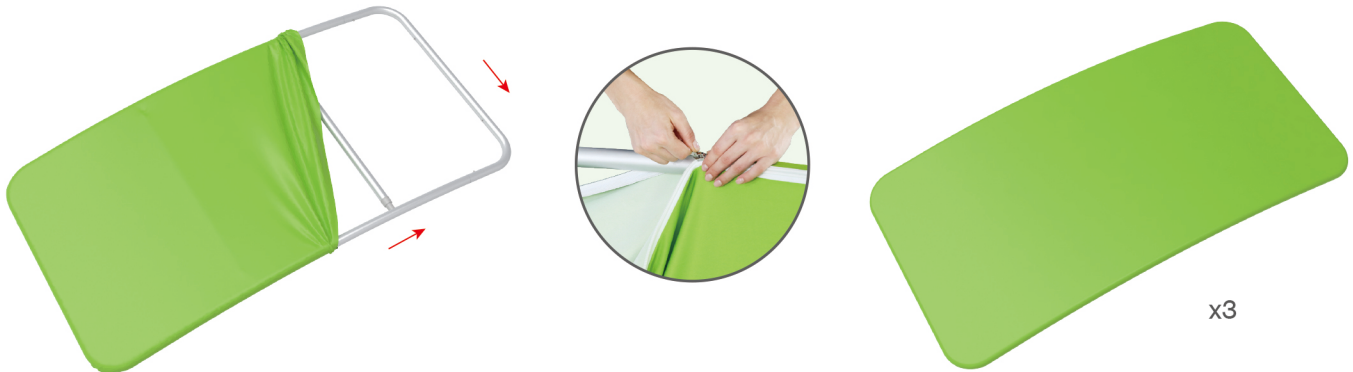

(1) Hardware

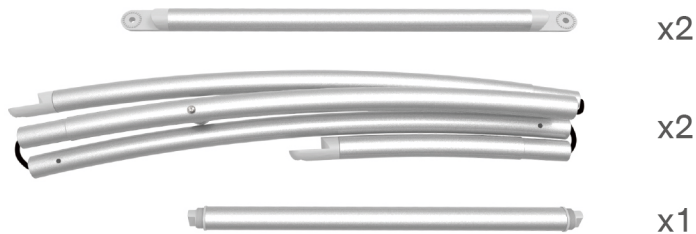

(2) Printed Graphic Fabric Banner (Optional)



STEP 01 Connect to make long poles according to labelings.

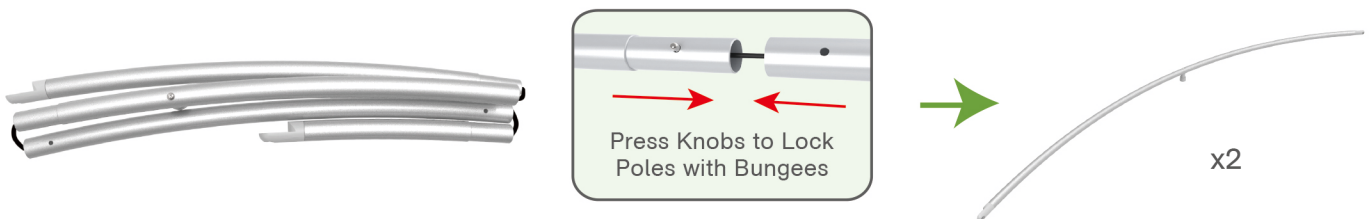

STEP 02

Connect long poles with corner poles according to labelings, then connect support poles onto frame.

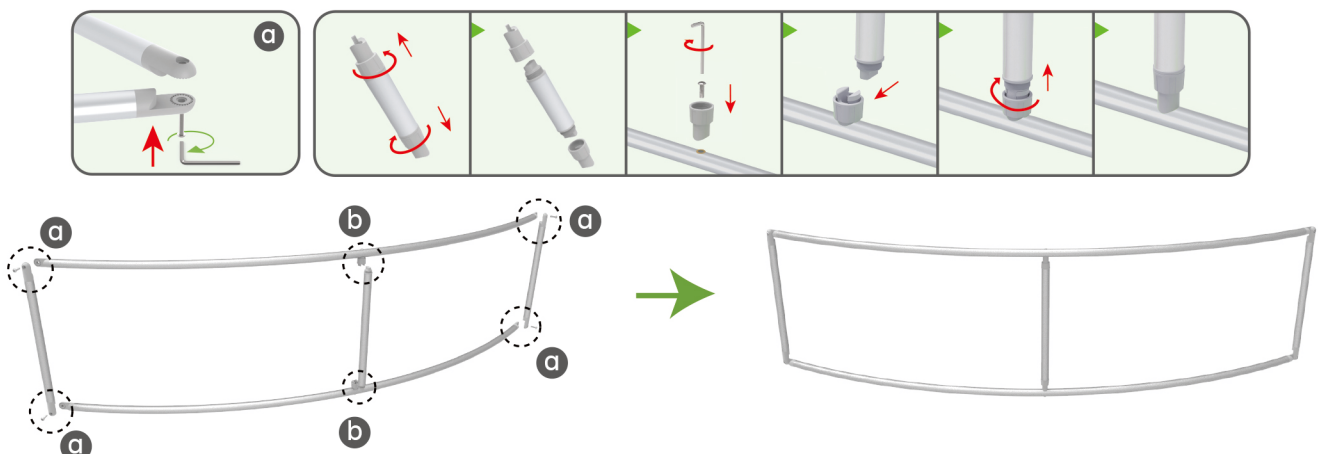

STEPS

STEP 03

Slide fabric banner on frame from left and zip up at right.



Booth Set Assembly

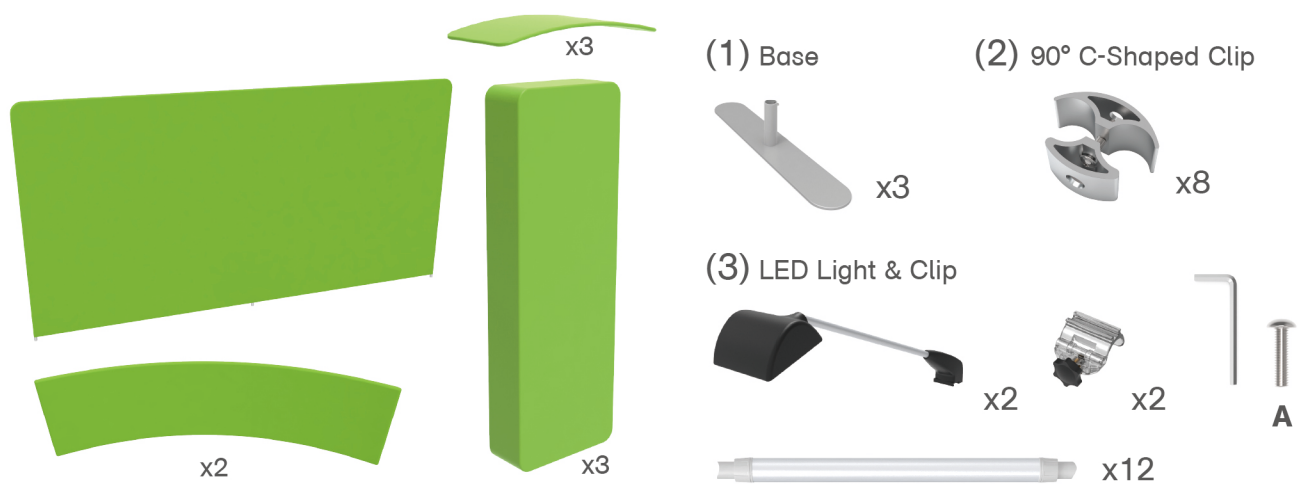

STEP 01

Connect support poles onto column frame and canopy.

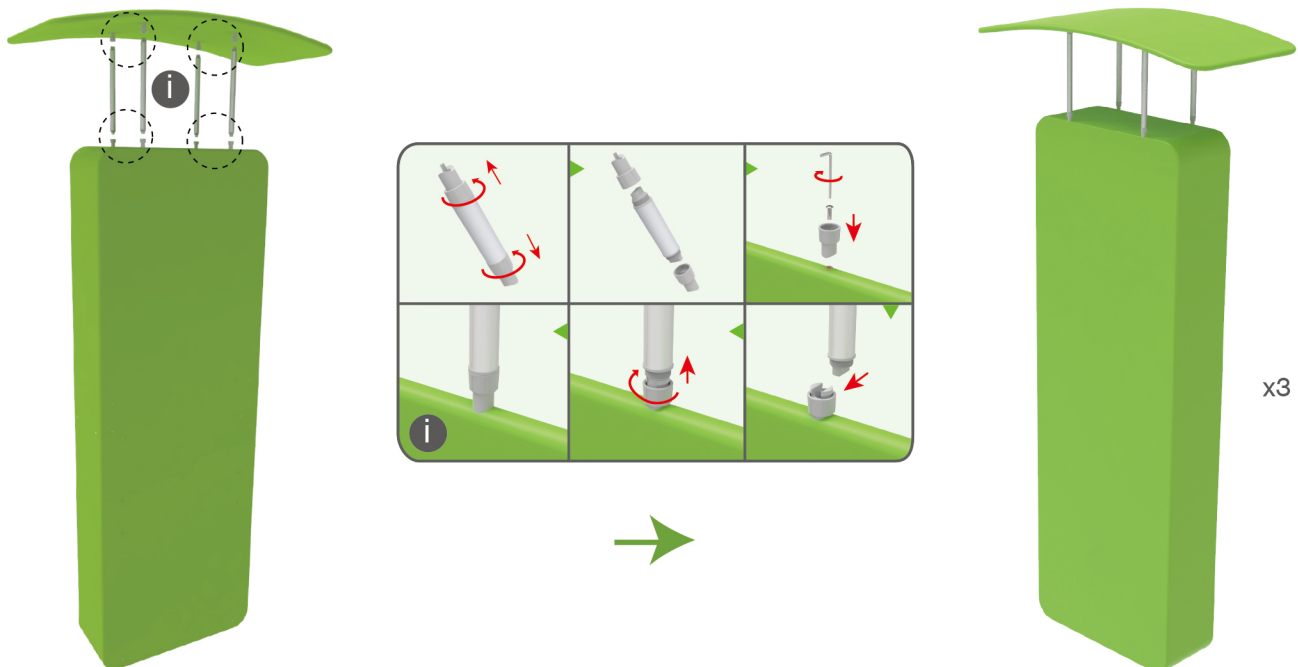

STEPS

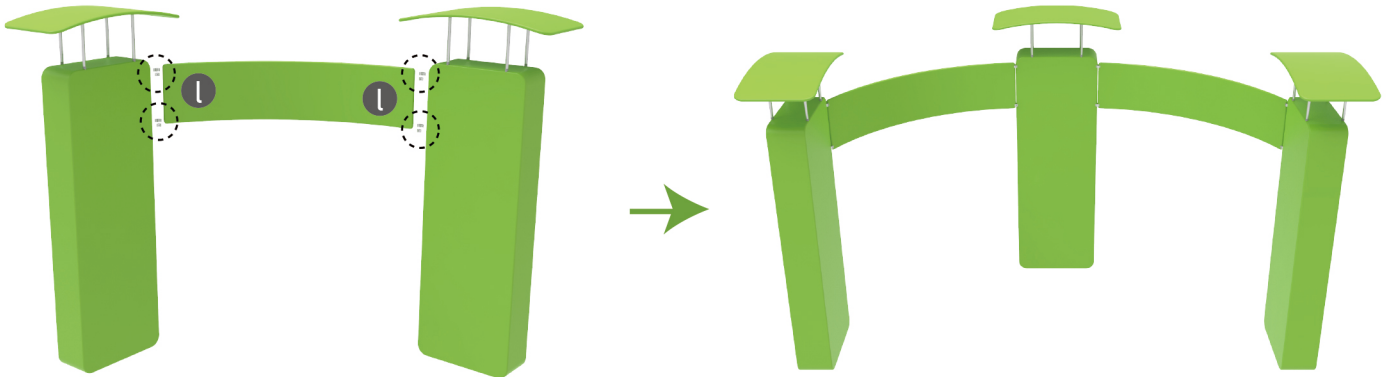
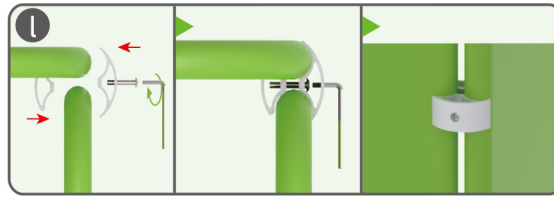
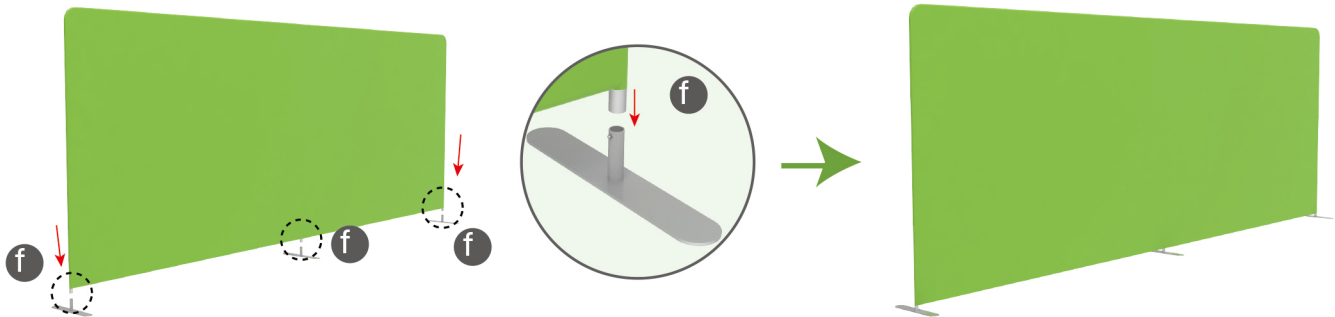
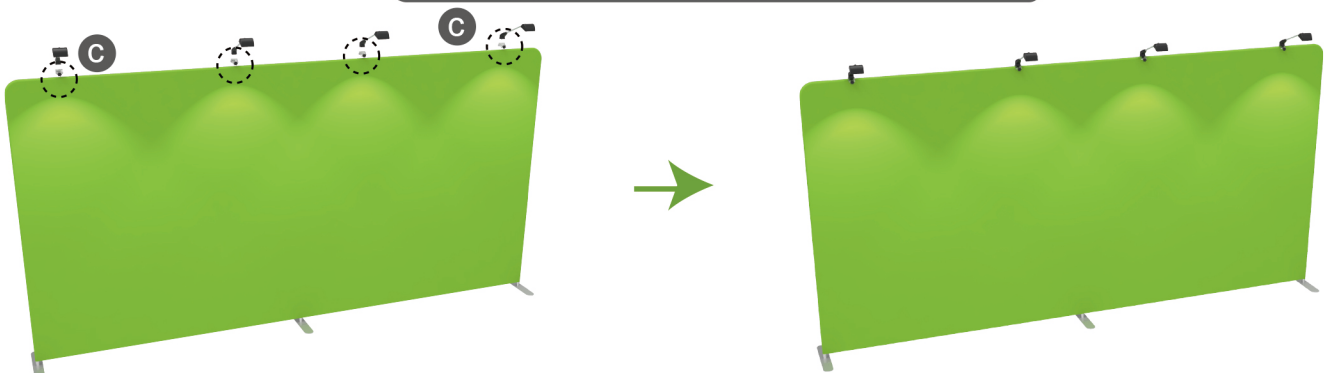
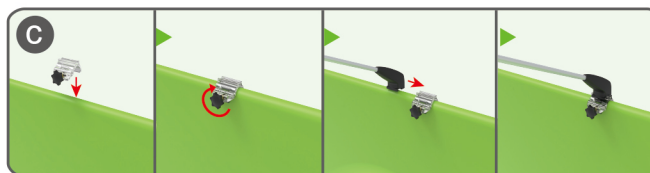
STEP 02 Interconnect display stands with C-shaped clips.**STEP 03** Insert display stands onto feet by pressing their knobs.**STEP 04** Screw light clips at top of display stands, slide lights onto them and adjust their direction.

STEPS

STEP 05

Interconnect display stands.

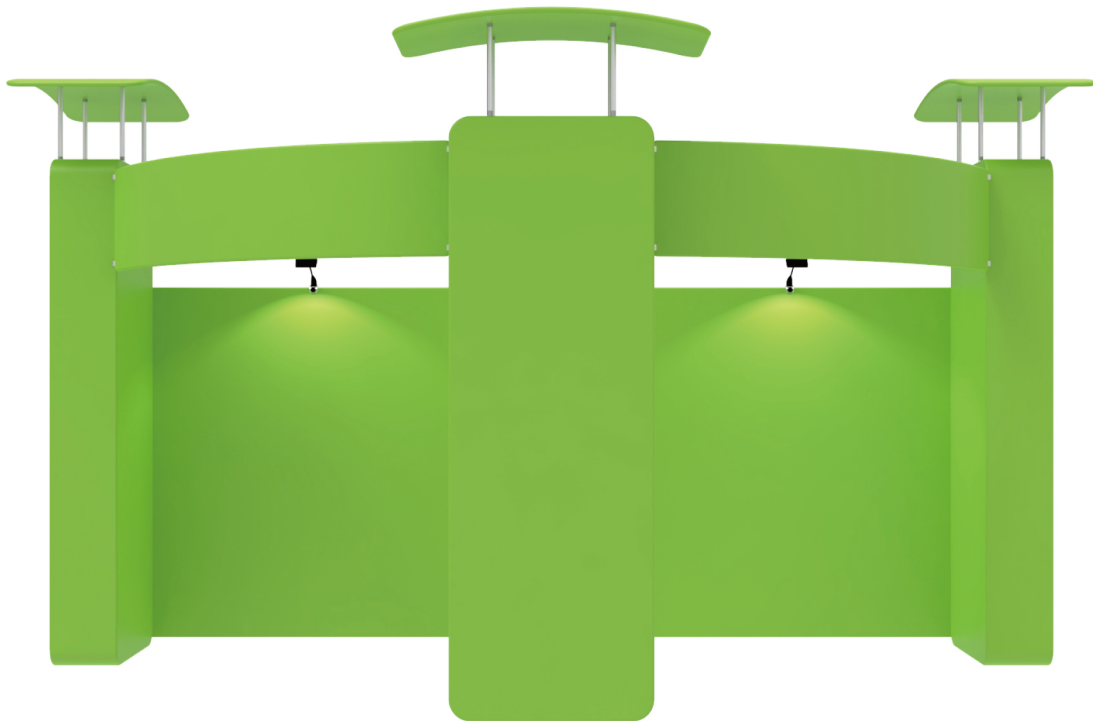
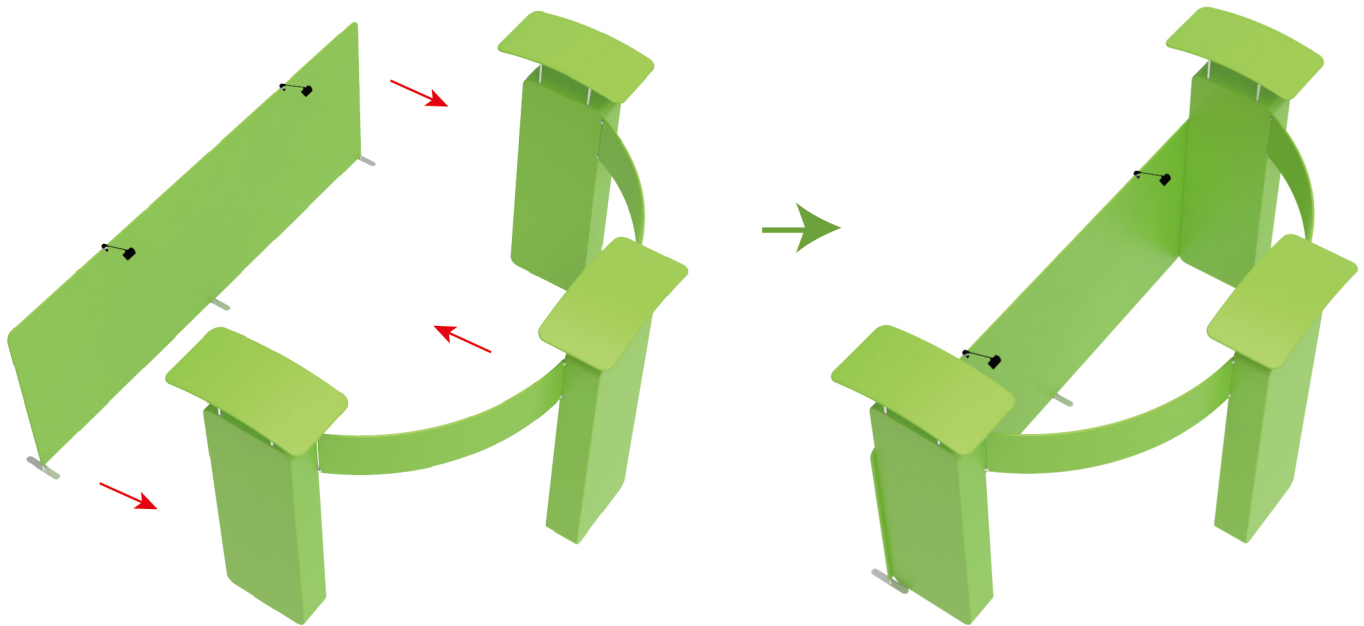

10X20FT-BOOTH-S