

STEPS

(1) Hardware



(2) Printed Graphic Fabric Banner (Optional)



STEP 01

Connect to make long poles according to labelings.

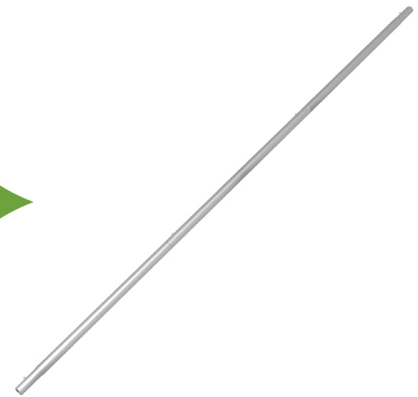
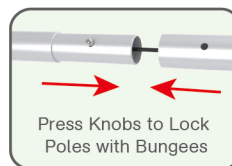
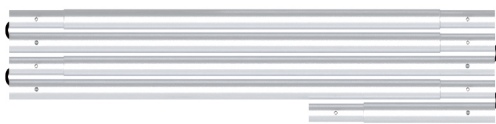

STEP 02

Connect long poles with corner poles according to labelings.

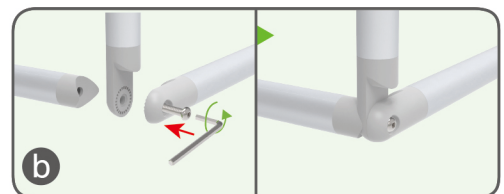
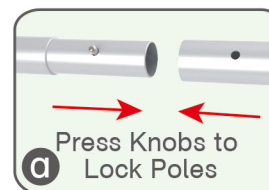
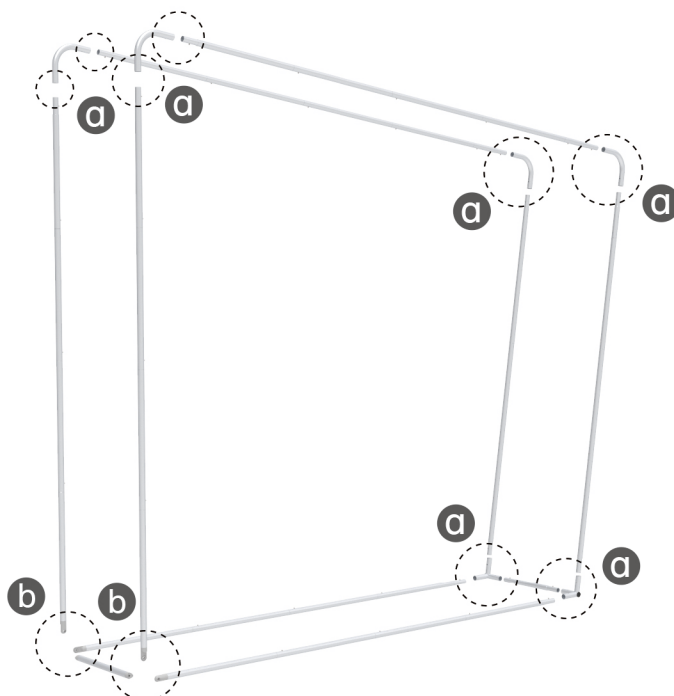

STEPS

STEP 03 Connect cross bars in the middle according to labelings.

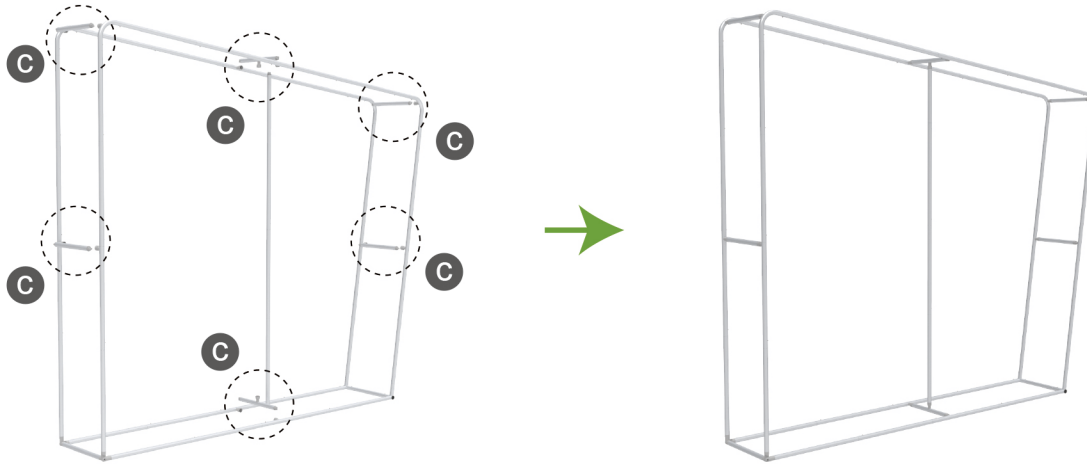
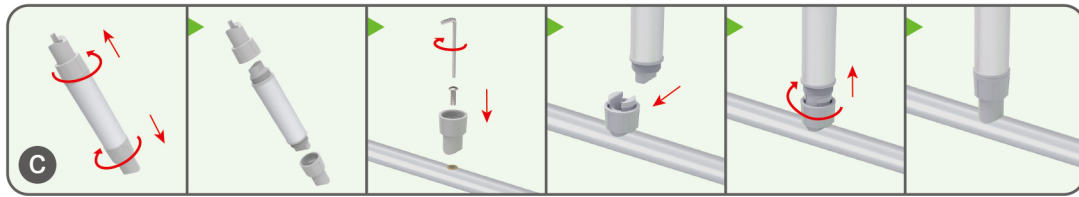

STEP 04 Slide fabric banner on frame from top and zip up at bottom.

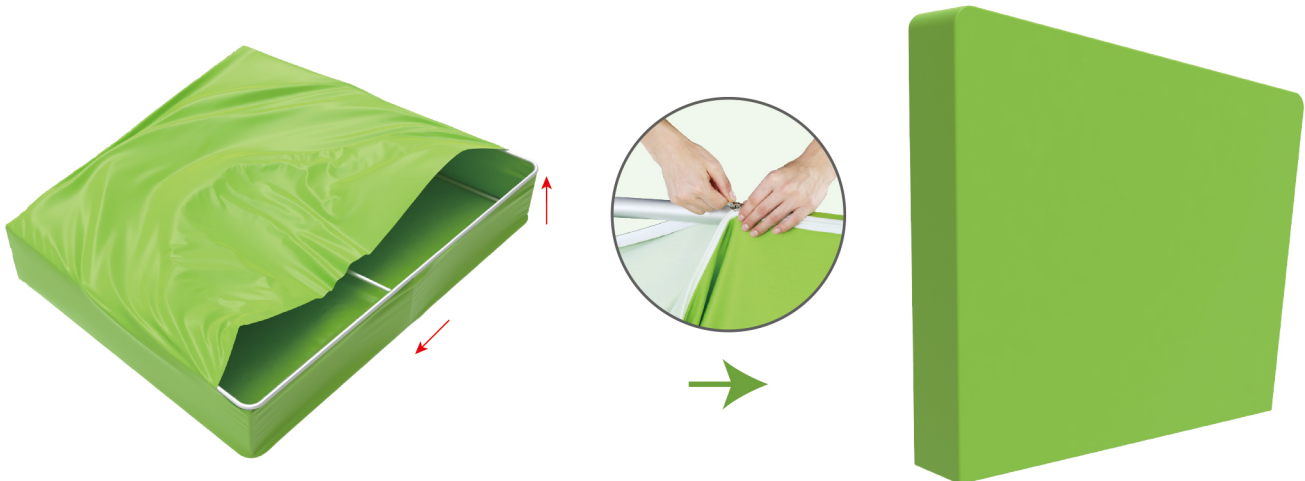

(1) Hardware

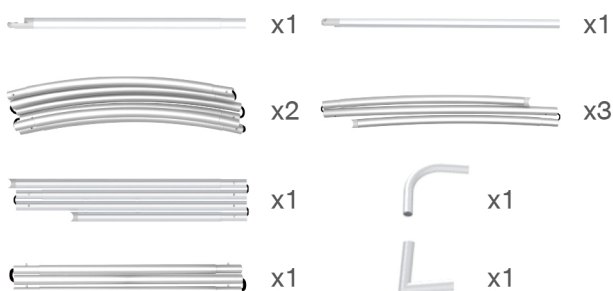

(2) Printed Graphic Fabric Banner (Optional)



★ One Tool (Hex Wrench) 

STEPS

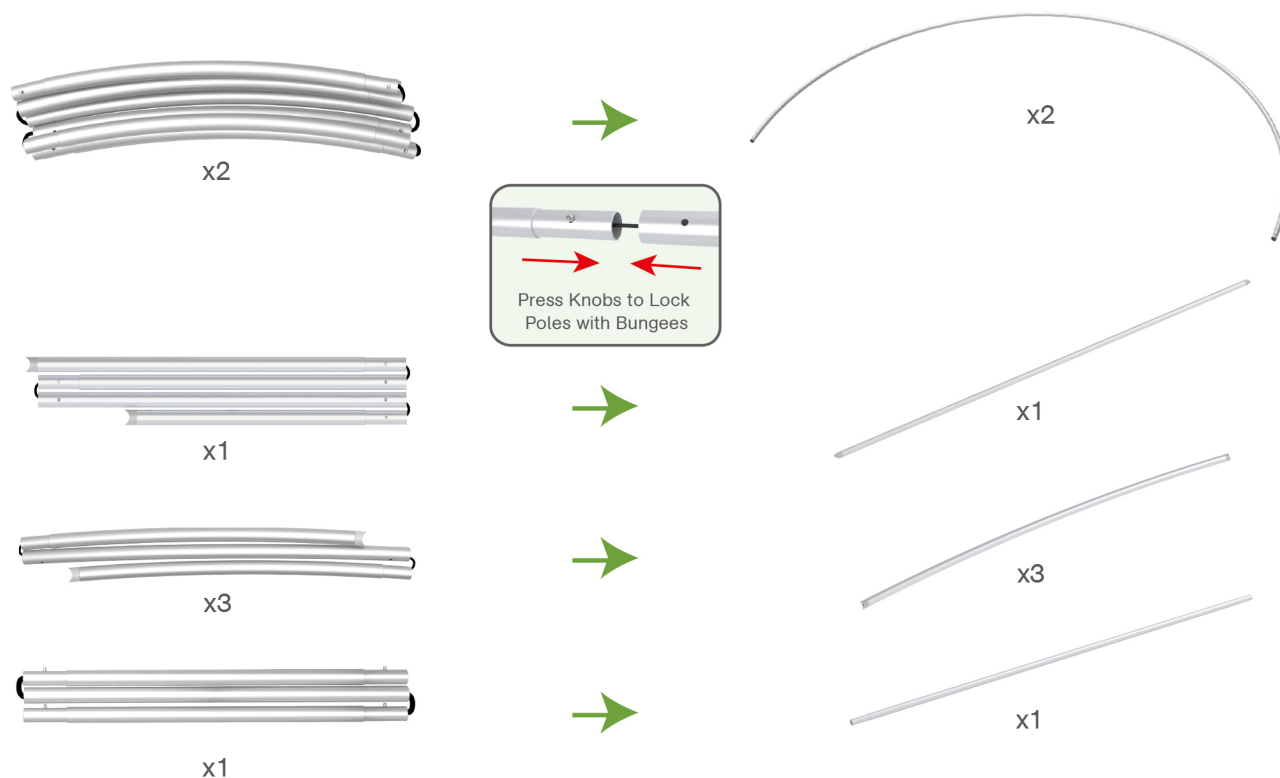
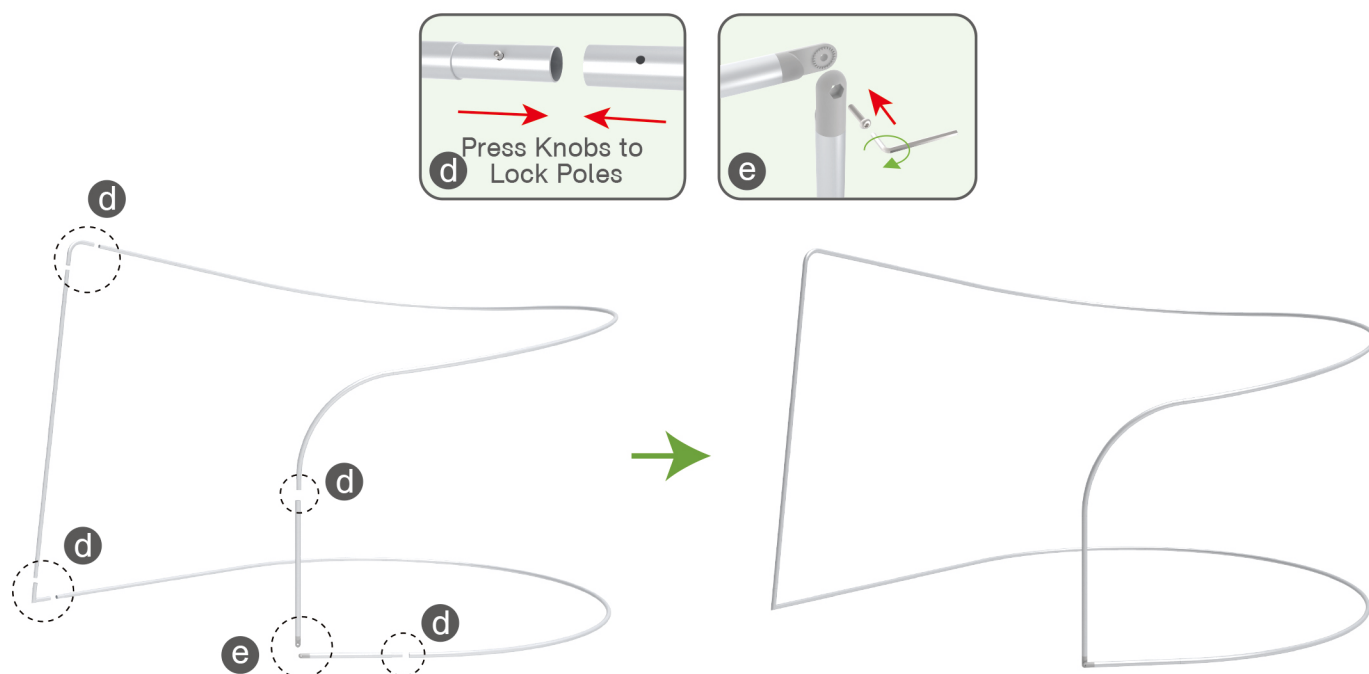
STEP 01 Connect to make long poles according to labelings.**STEP 02** Connect long poles with corner poles according to labelings.

STEPS

STEP 03

Connect support poles onto frame.

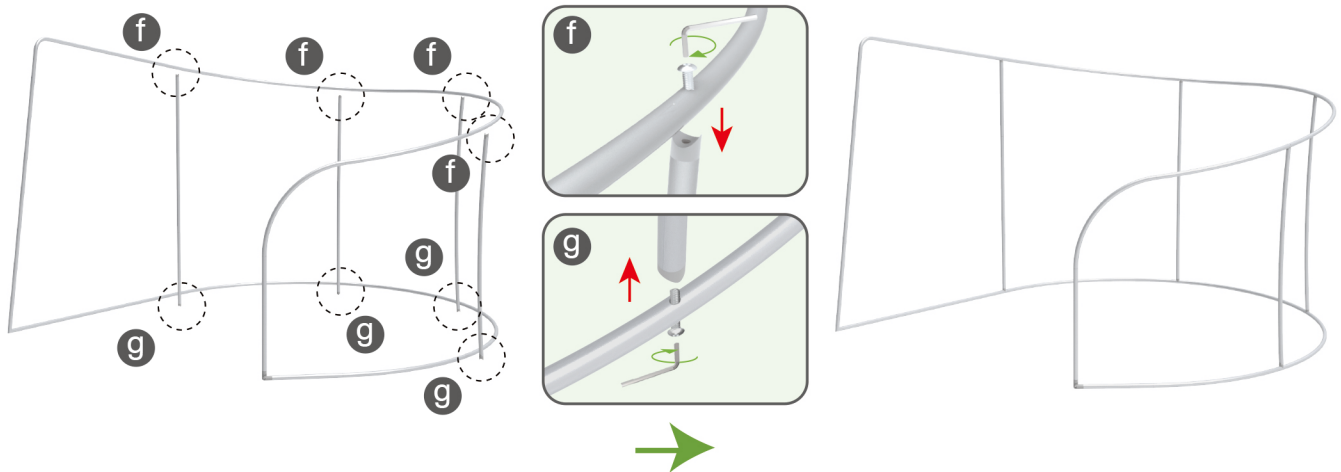

STEP 04

Wrap enclosure frame with fabric banner & zip up at top.

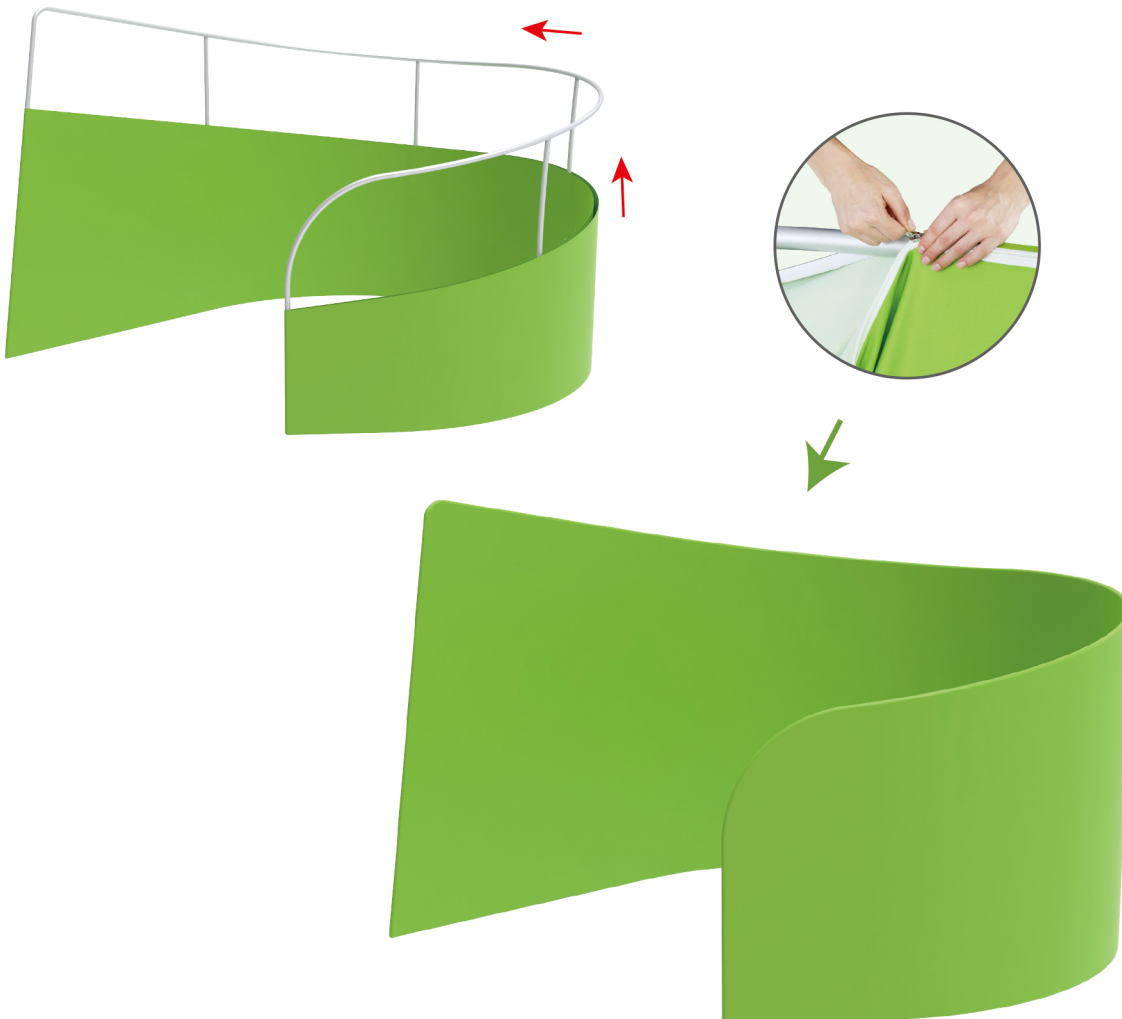

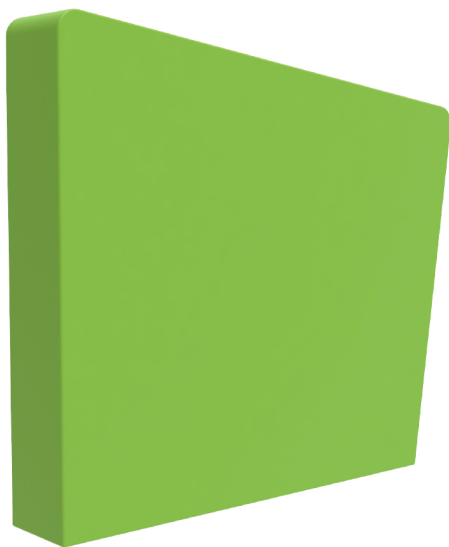
STEPS**Booth Set Assembly**

(1) 90° C-Shaped Clip



x2

(2) LED Light & Clip



x2



x2

STEP 05

Screw light clips at top of display stands, slide lights onto them and adjust their direction.

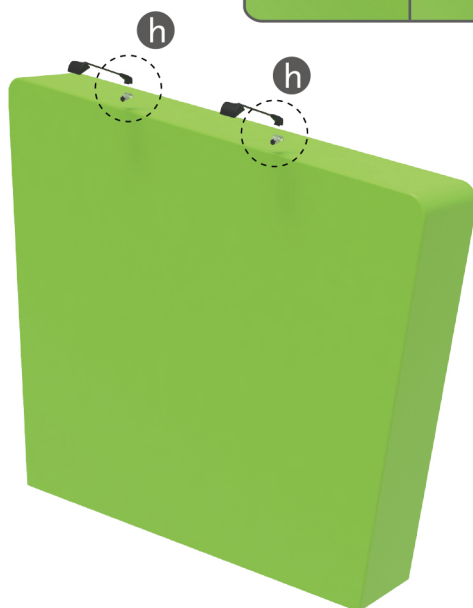
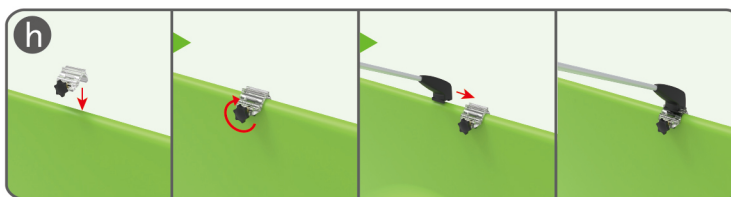

STEPS

STEP 06 Interconnect display stands with C-shaped clips.

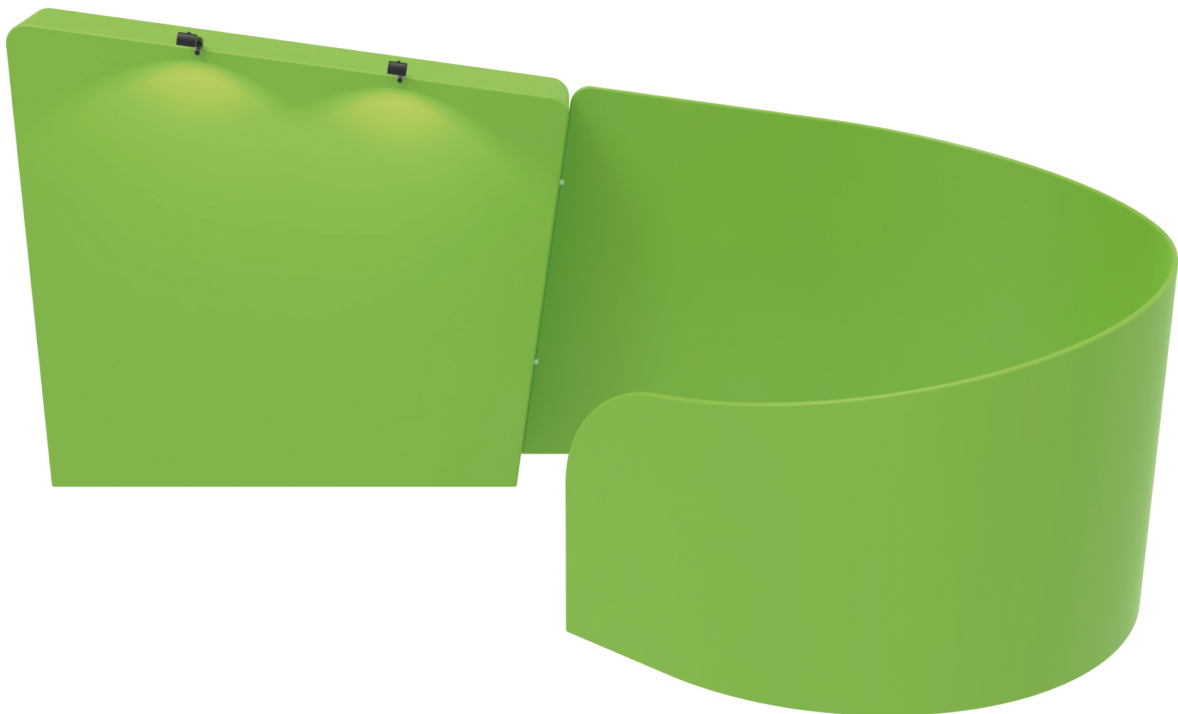
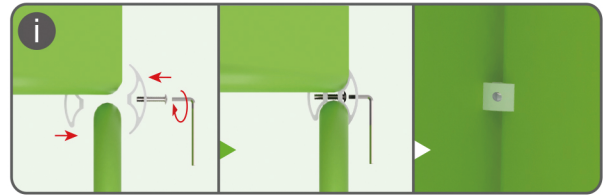

10X20FT-BOOTH-C