

## STEPS

## (1) Hardware

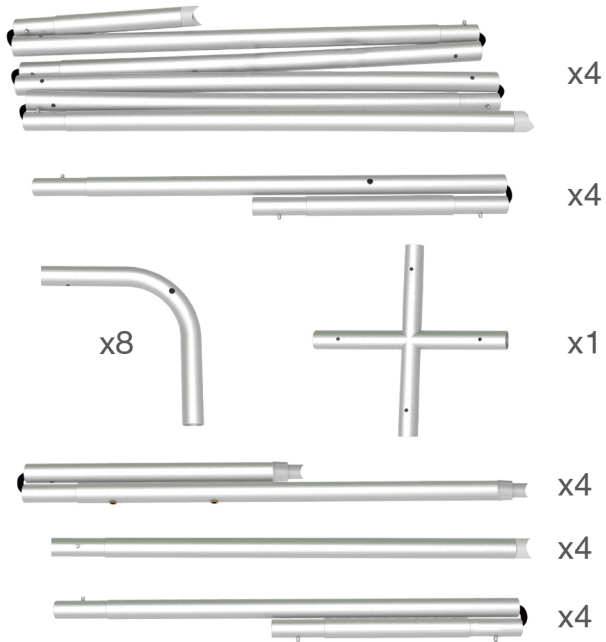

## (2) Printed Graphic Fabric Banner (Optional)



## STEP 01

Connect to make long poles according to labelings.

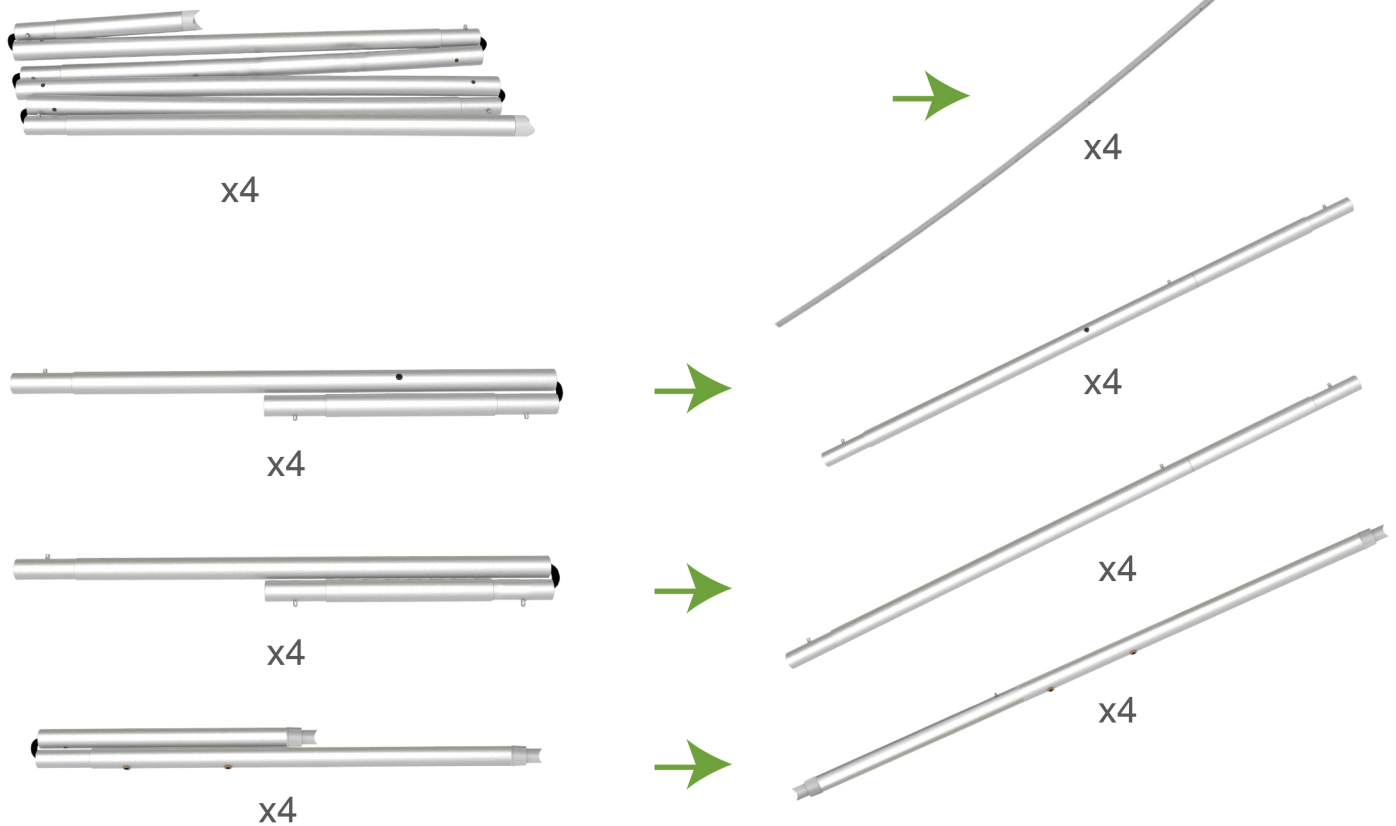

## STEPS

## STEP 02

Connect long poles with corner poles according to labelings.

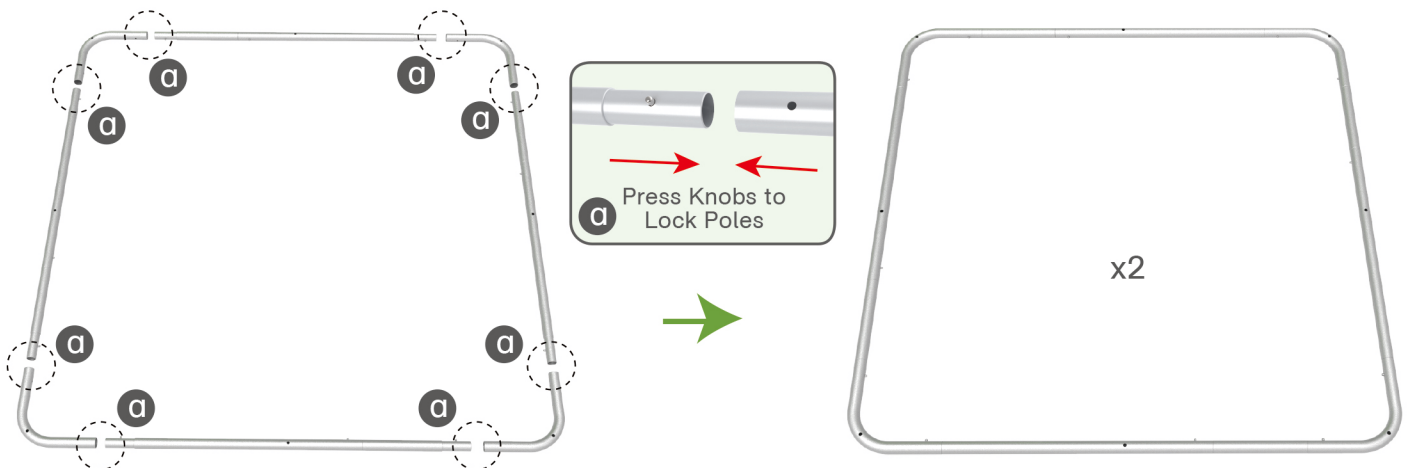

## STEP 03

Connect top and bottom square with support poles by screws.

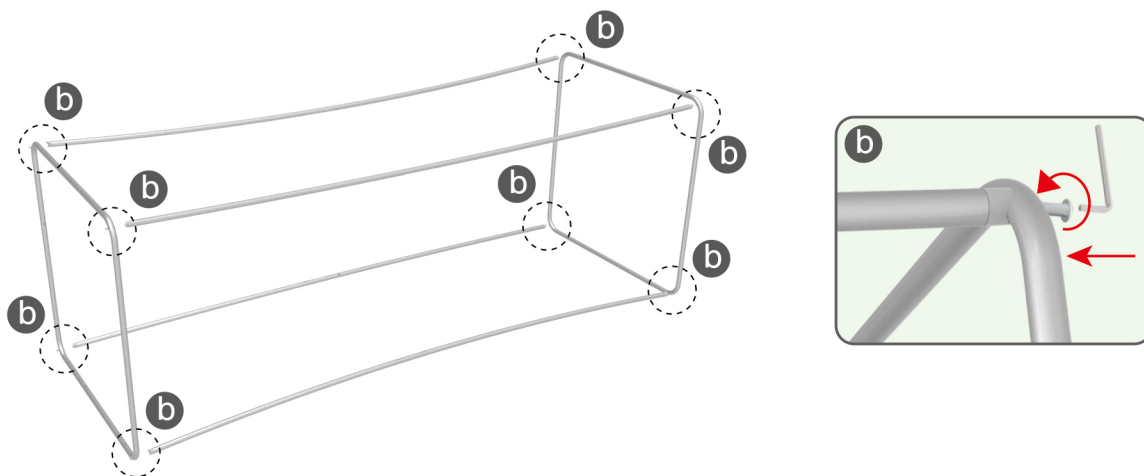

## STEP 04

① Connect to make support poles.

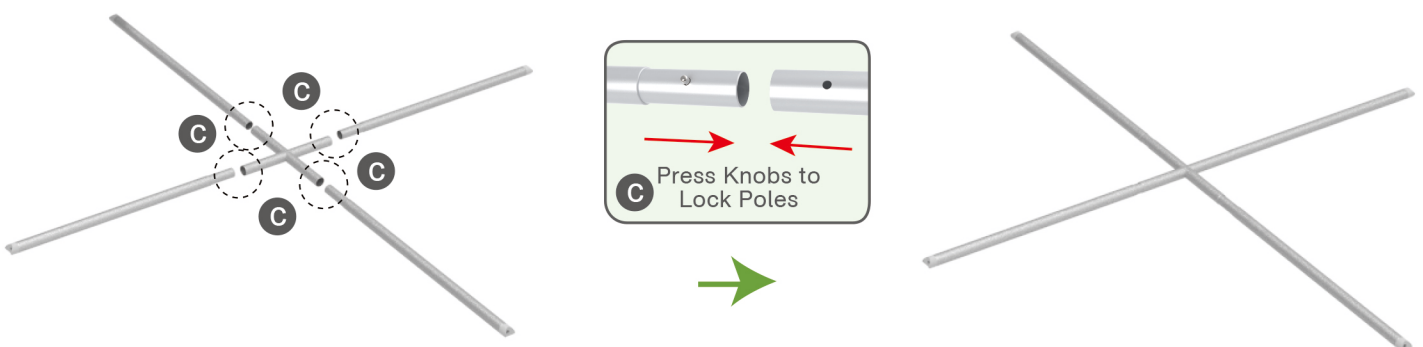

**STEPS**

② Connect support poles with screws.

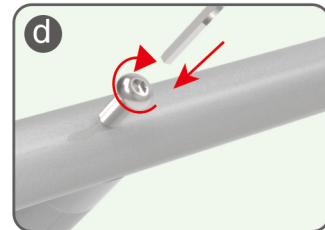
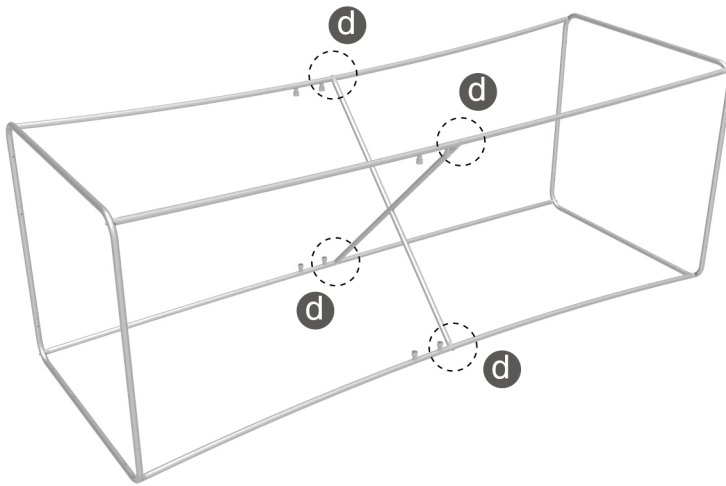

**STEP 05** Connect cross bars in the middle according to labelings.

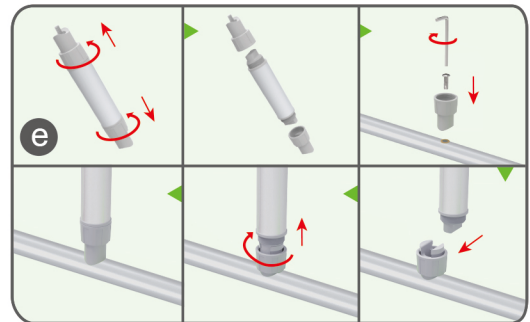
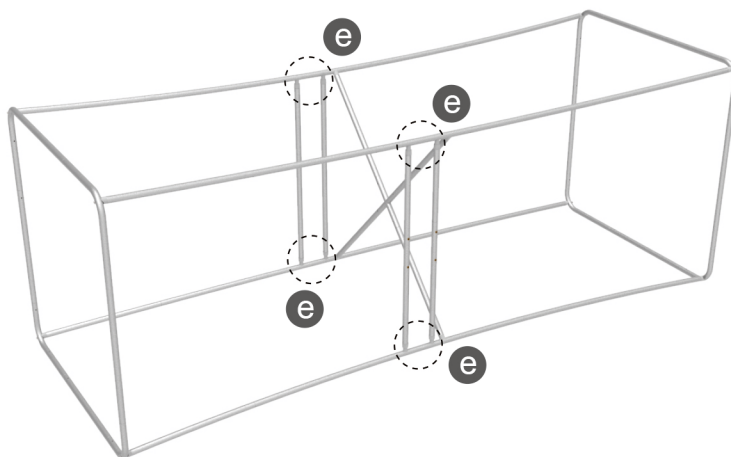

**STEP 06**

Wrap up frame with fabric banner from bottom and zip up at top.



## STEPS

## (1) Hardware

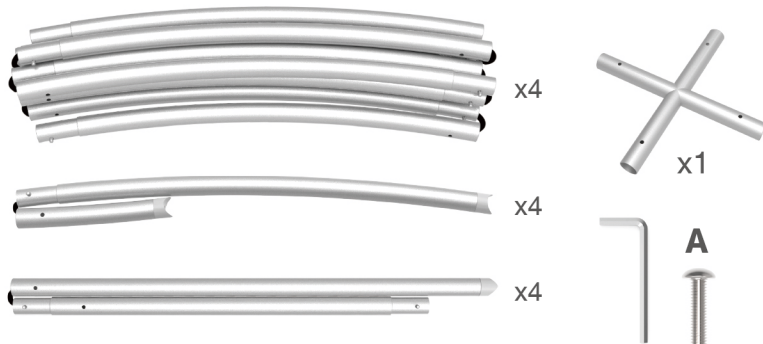

## (2) Printed Graphic Fabric Banner (Optional)

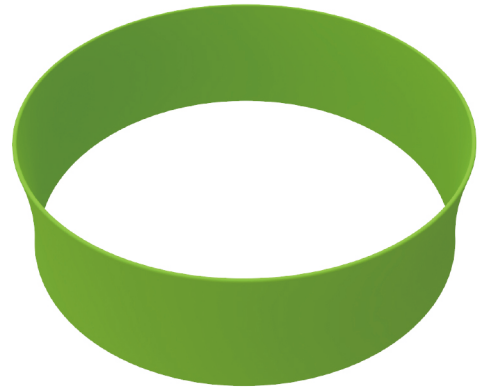

## STEP 01

Connect to make long poles according to labelings.

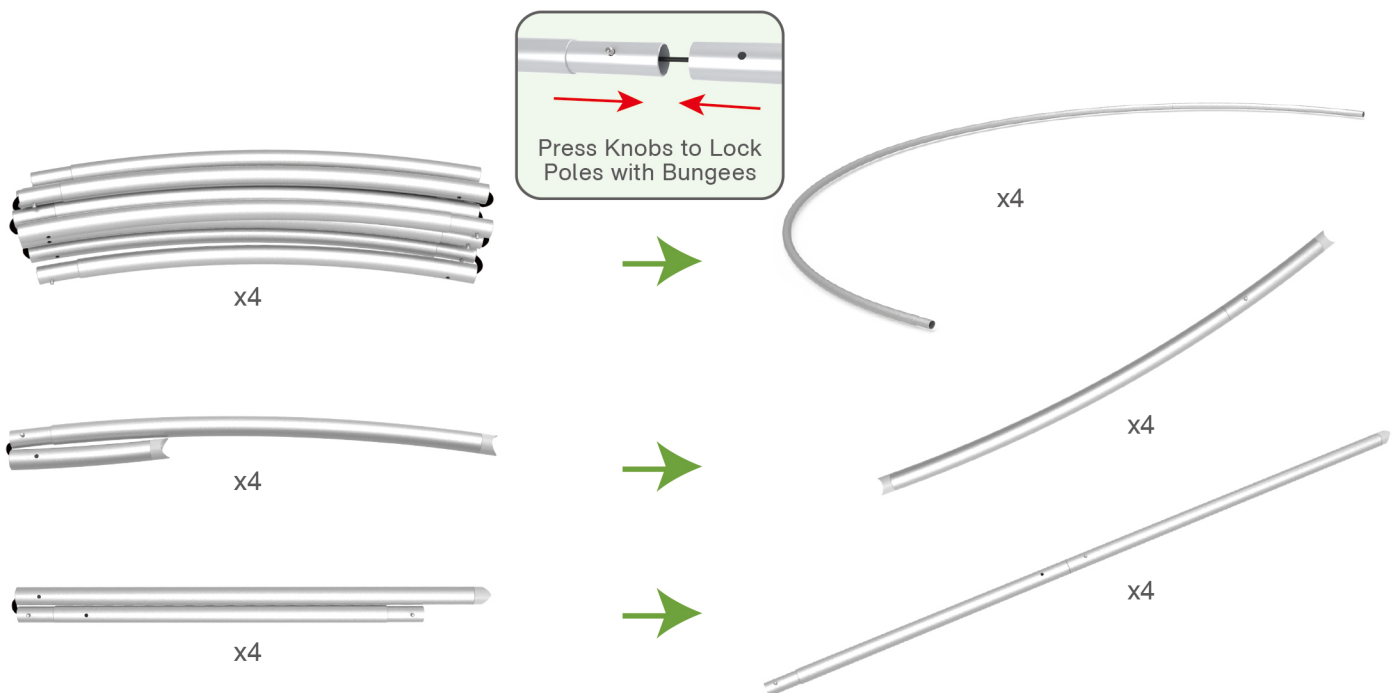

## STEP 02

Connect long poles to make frame according to labelings.

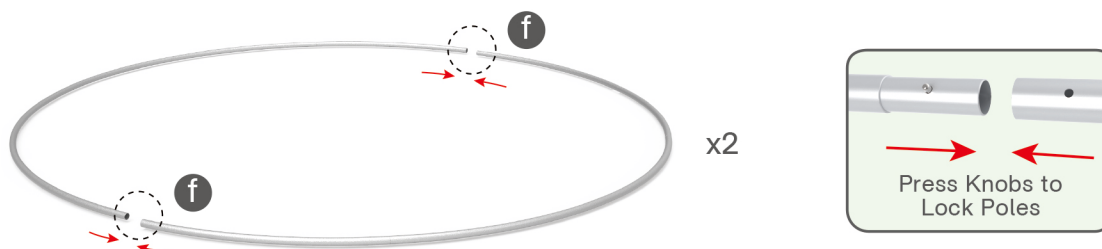



**STEPS****STEP 03**

Connect support poles onto frame.

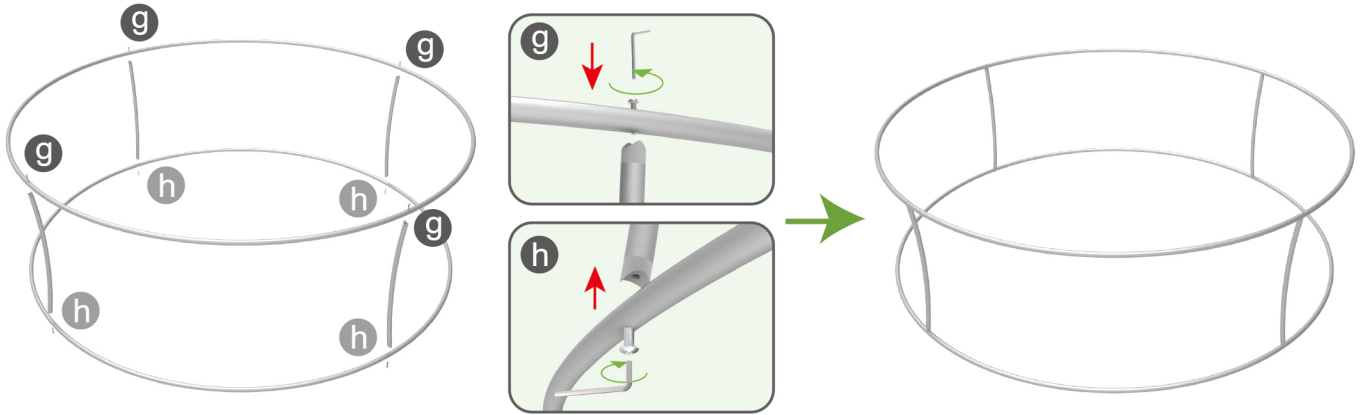
**STEP 04**

Connect to make cross bars.

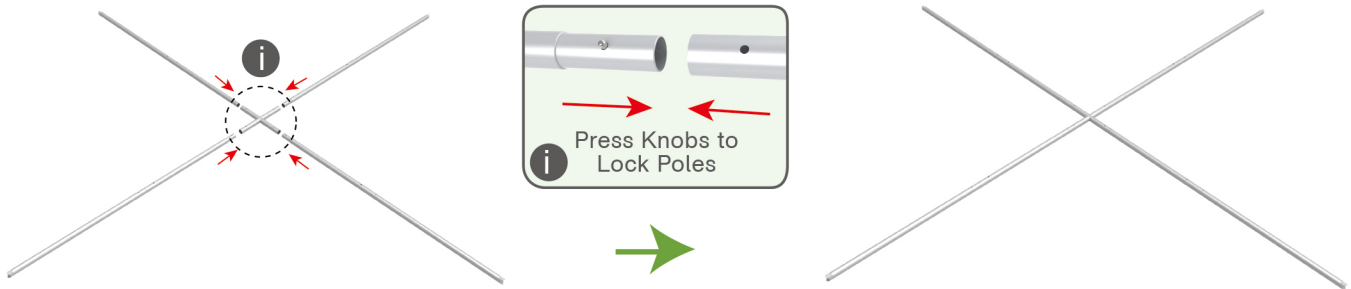
**STEP 05**

Connect cross bars onto frame & slide fabric banner on frame from bottom and zip up at top.

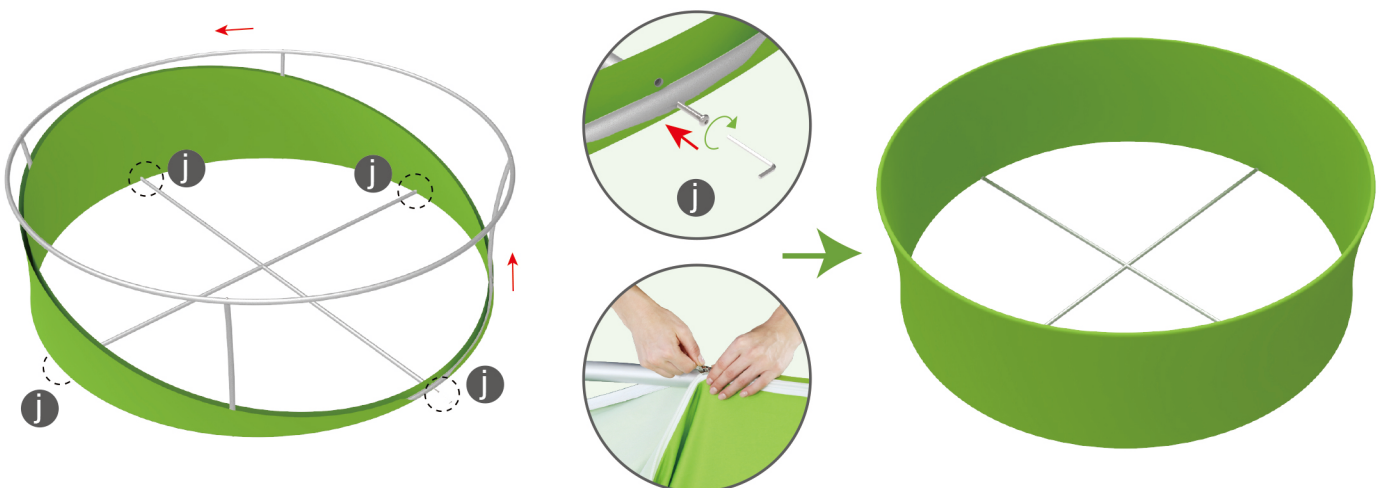

## STEPS

## STEP 06

Connect column with hanging sign by screws.

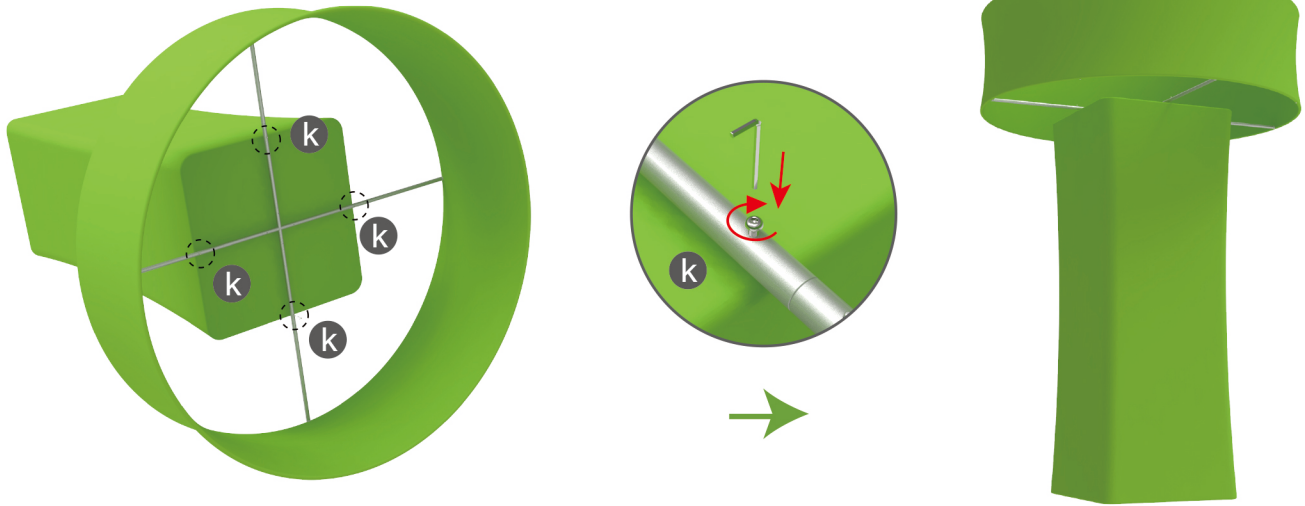

## (1) Hardware

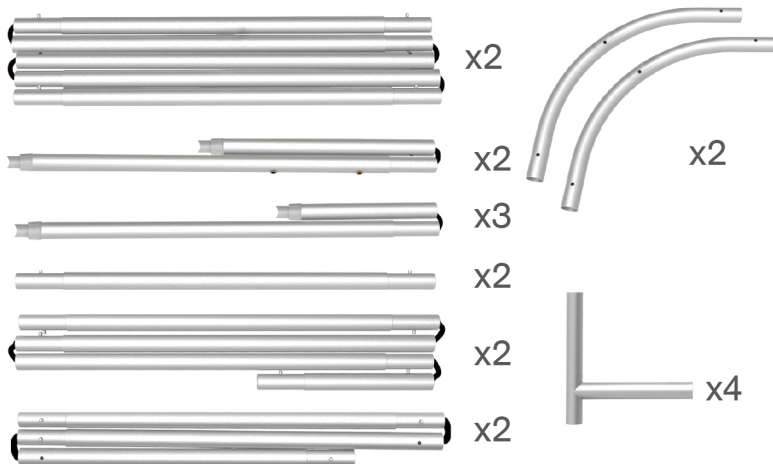

## (2) Printed Graphic Fabric Banner (Optional)



## STEP 01

Connect to make long poles according to labelings.

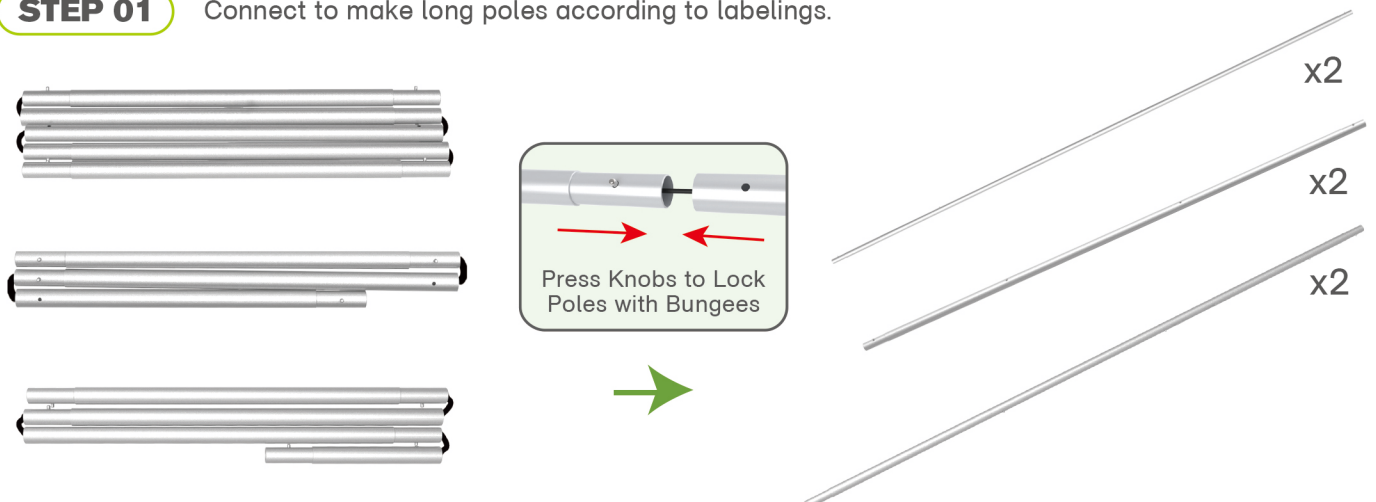

## STEPS

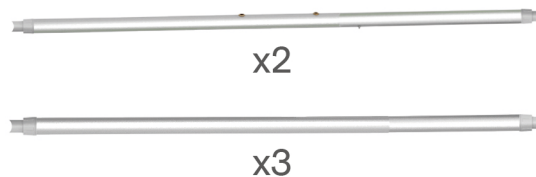

## STEP 02

Connect long poles with corner poles according to labelings.

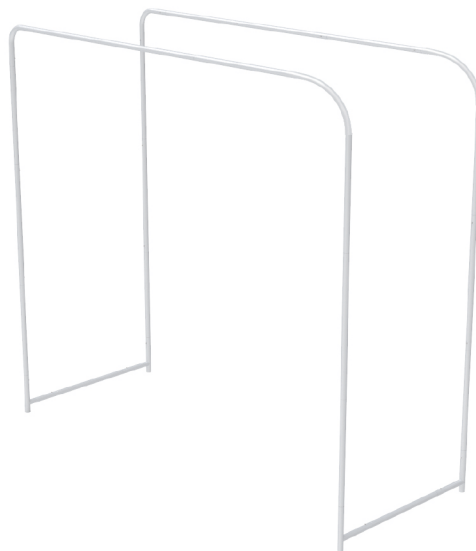
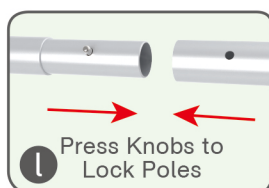
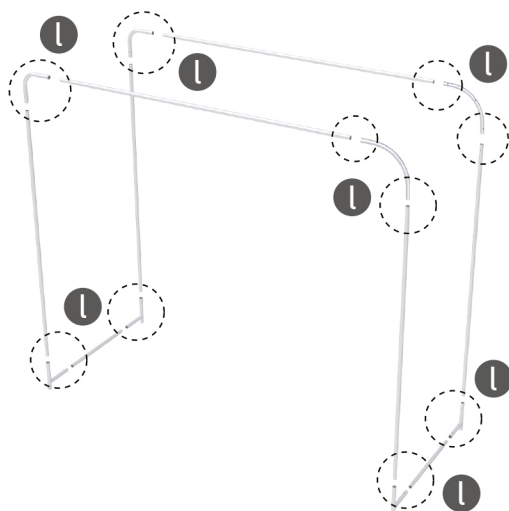

## STEP 03

Connect cross bars onto frame.

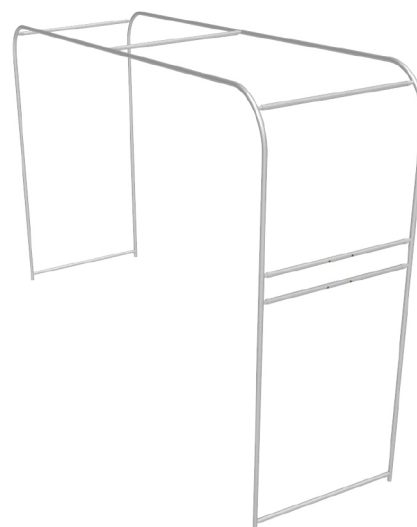
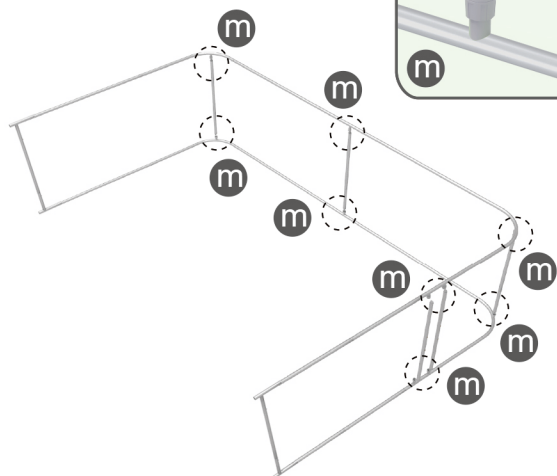
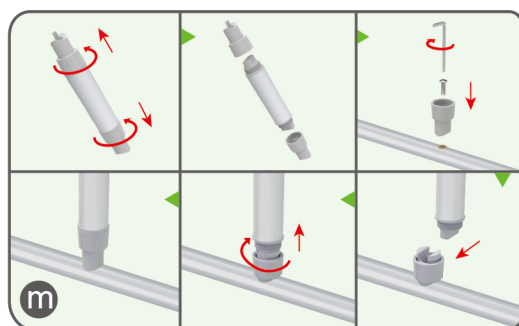

## STEPS

## STEP 04

Slide fabric banner on frame from bottom and zip up at top.

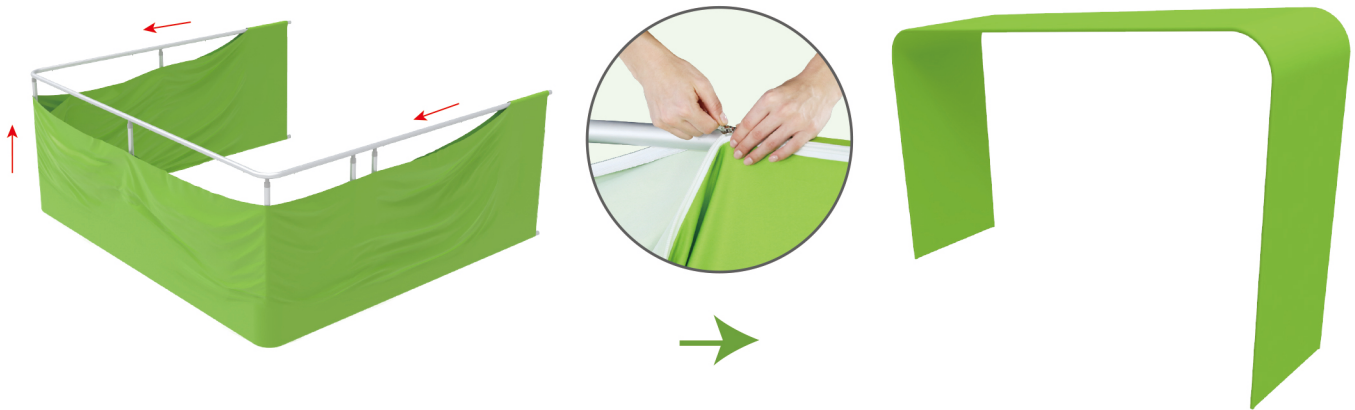

## (1) Hardware

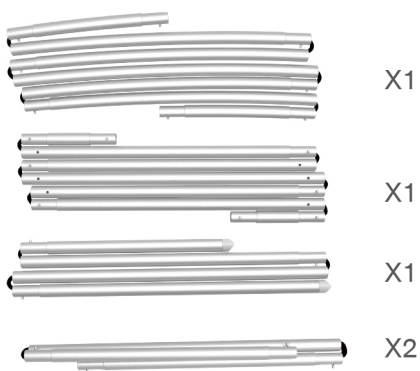

## (2) Printed Graphic Fabric Banner (Optional)

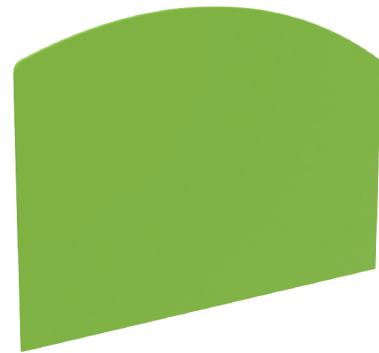

## STEP 01

Connect to make long poles according to labelings.

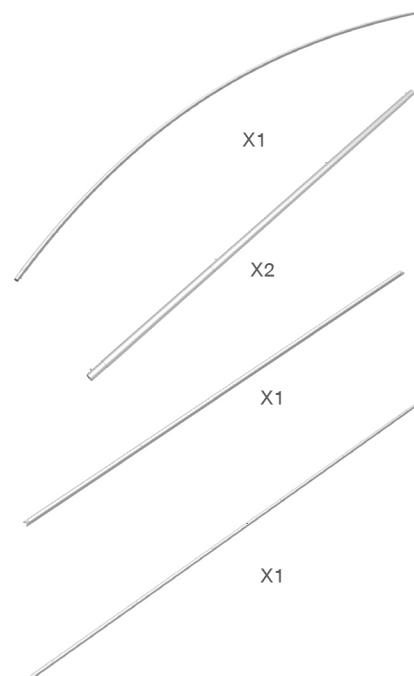
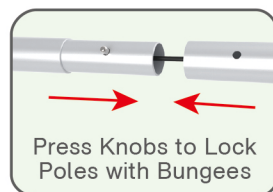
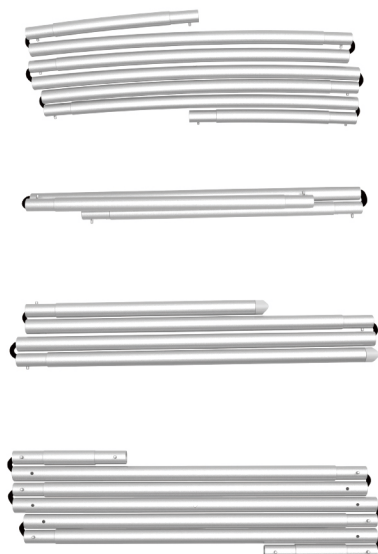

## STEPS

## STEP 02

Connect long poles with corner poles according to labelings, connect support pole onto frame.

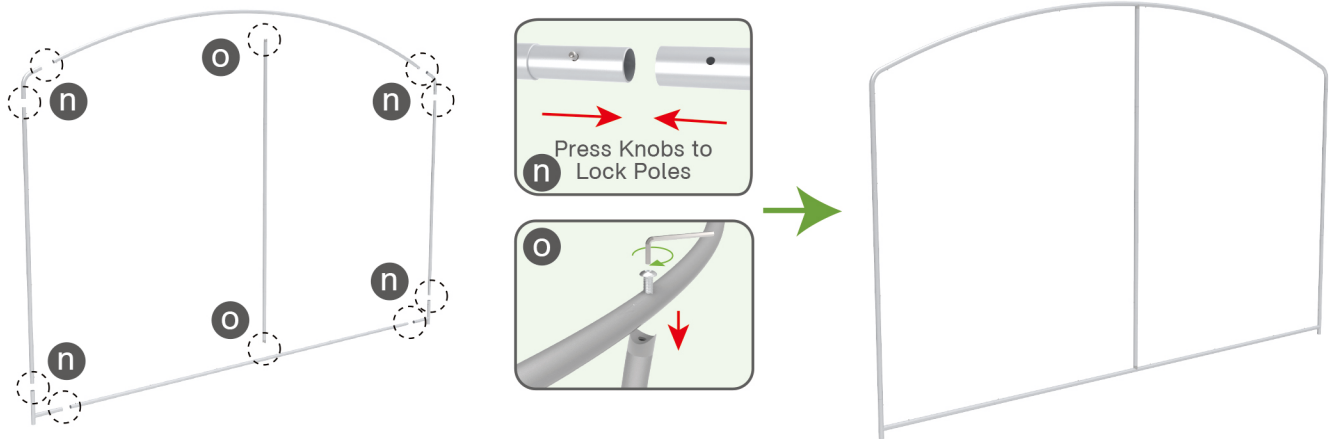

## STEP 03

Slide fabric banner on frame from top and zip up at bottom.

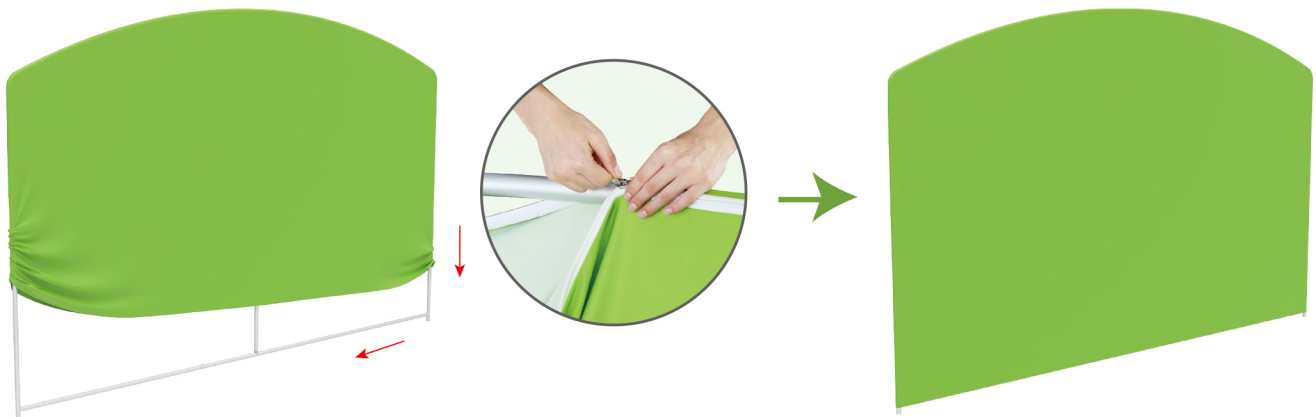

## Booth Set Assembly

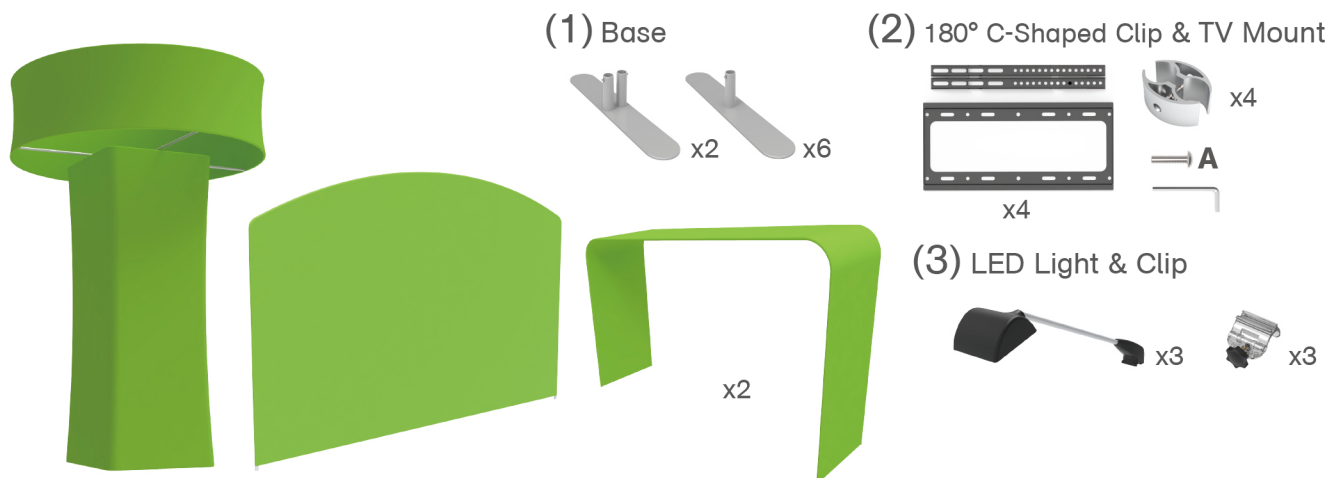



## STEPS

## STEP 01

Insert display stands onto feet by pressing their knobs.

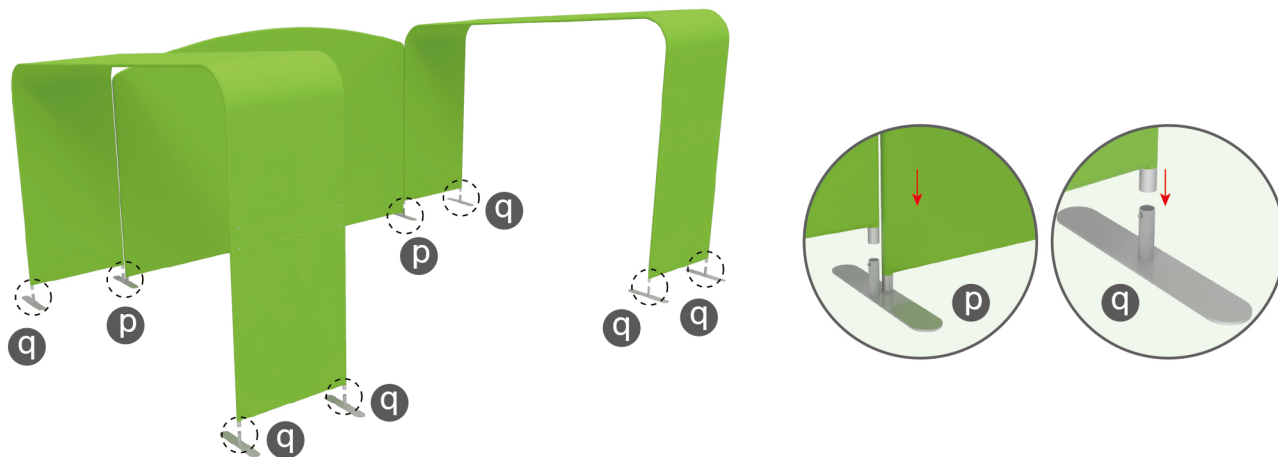

## STEP 02

Interconnect display stands with C-shaped clips.

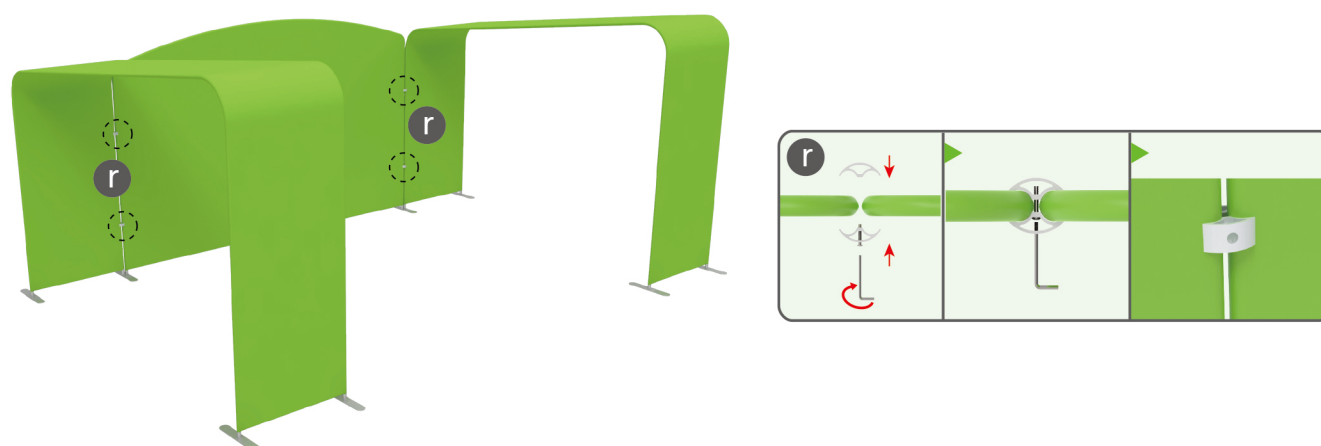

## STEP 03

Screw light clips at top of display stands, slide lights onto them and adjust their direction.

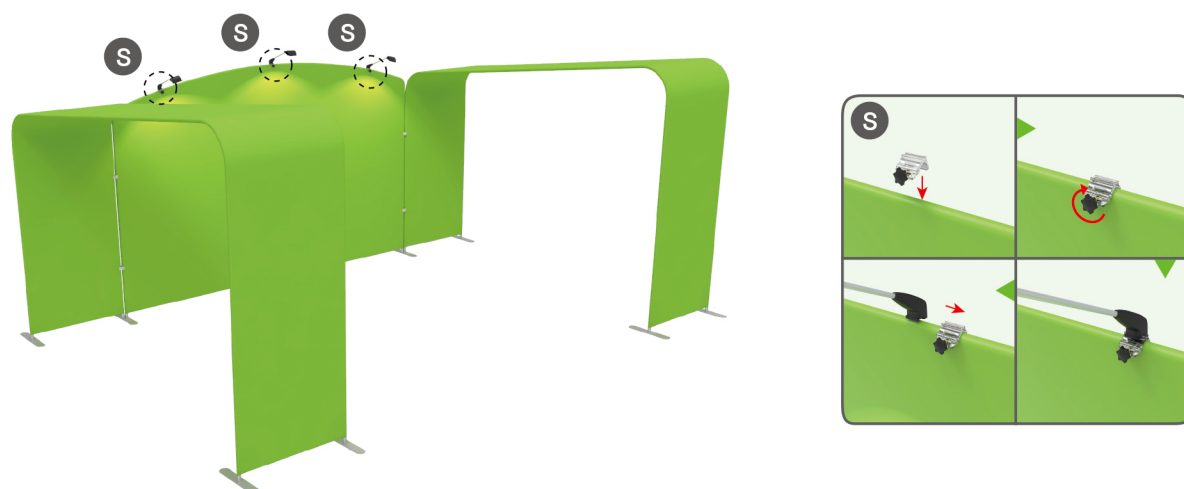



## STEPS

## STEP 04

Screw TV mount with hex wrench.

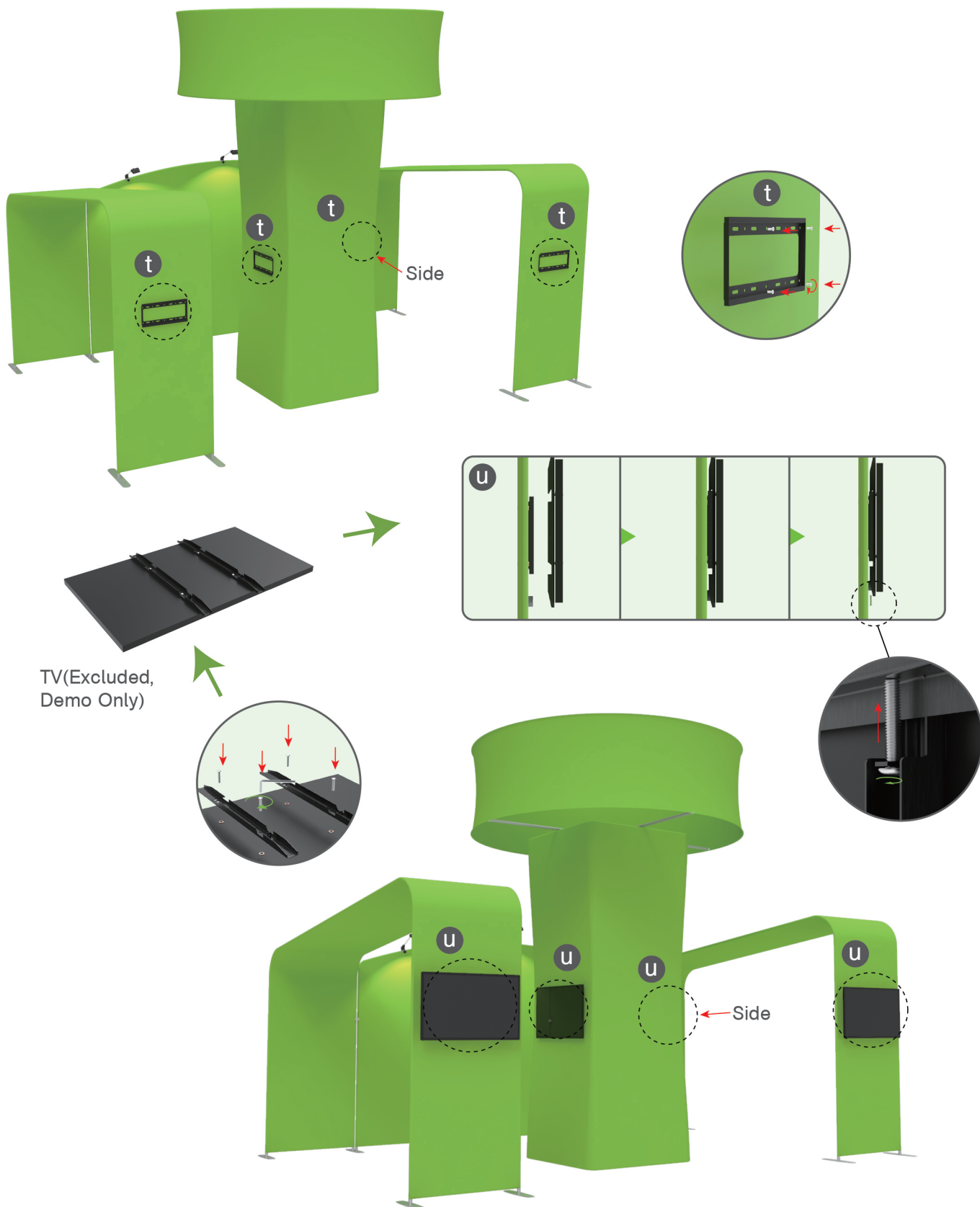

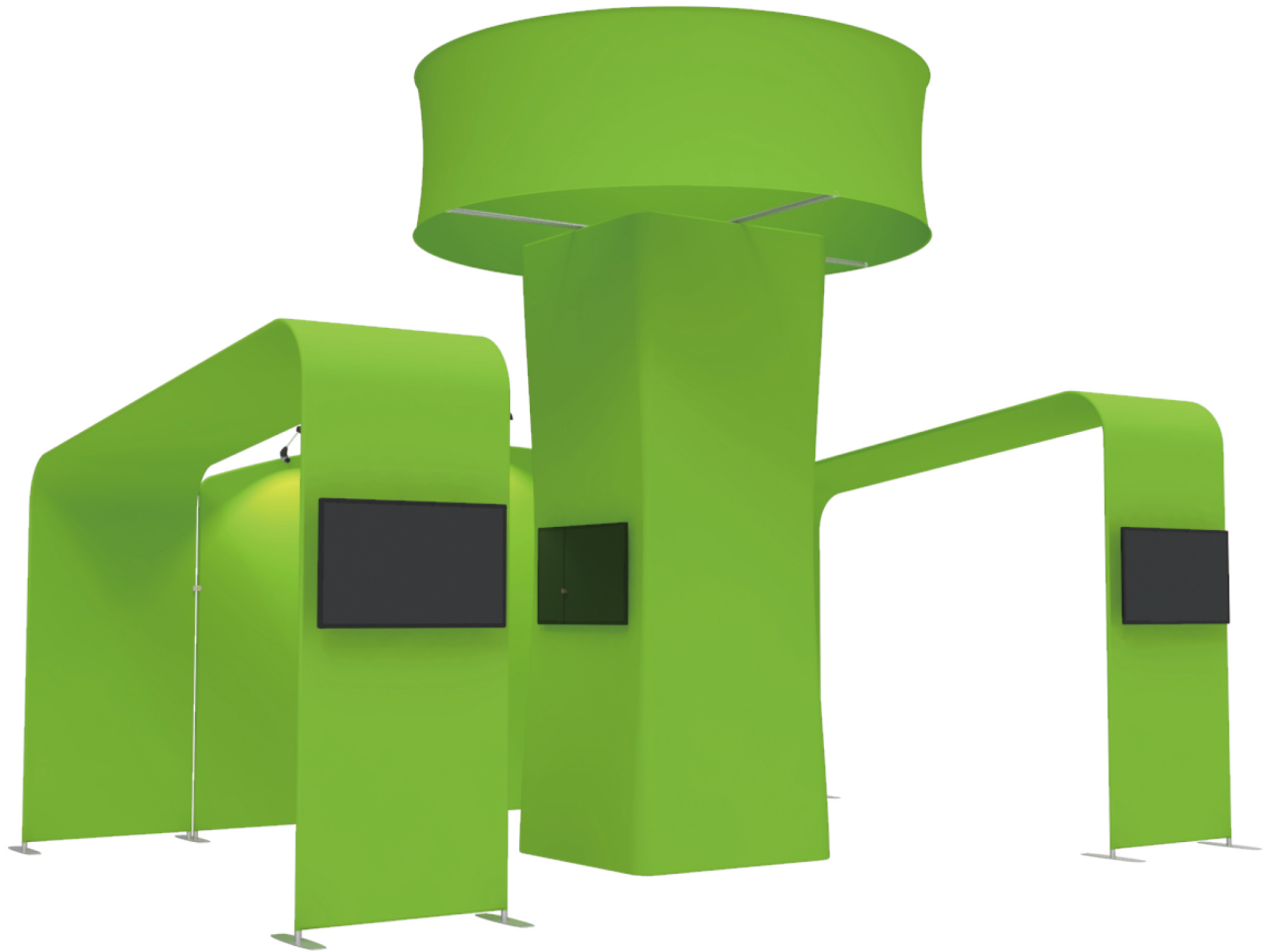
**STEPS****20X20FT-BOOTH-01**