

### STEPS

(1) Hardware

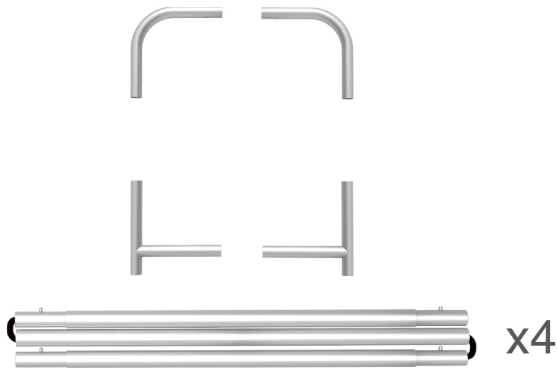

(2) Printed Graphic Fabric Banner (Optional)



**STEP 01** Connect to make long poles according to labelings.

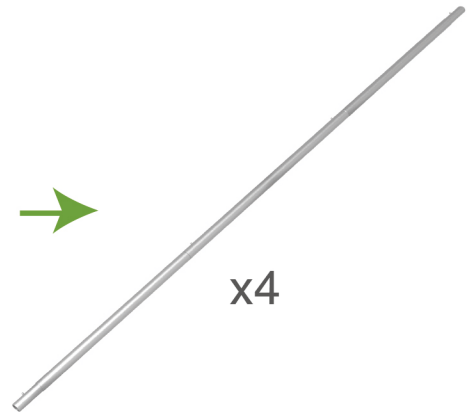
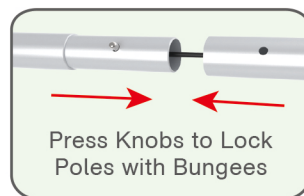
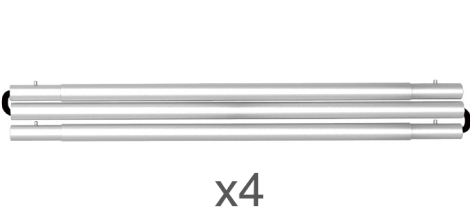

**STEP 02** Connect long poles with corner poles according to labelings.

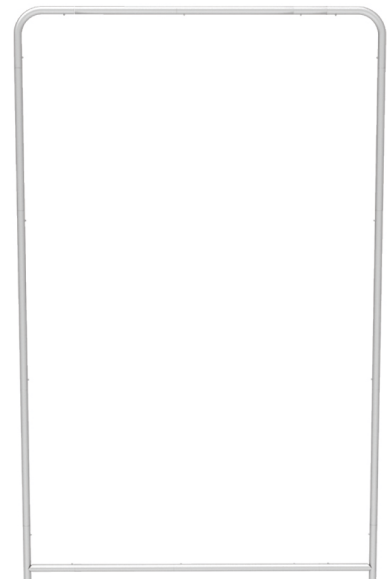
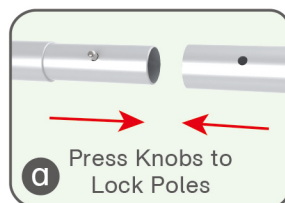
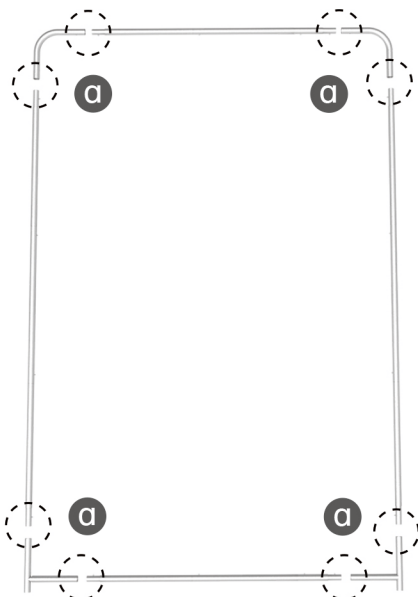

### STEPS

**STEP 03** Slide fabric banner on frame from top and zip up at bottom.



Same Steps for Other Display Stands

### Booth Set Assembly



(1) Base

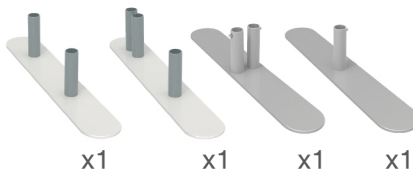

(2) LED Light & Clip



(3) Shoe Rack Shelving Kit



(4) C-Shaped Clip & TV Mount

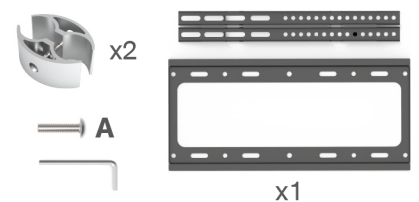

**STEP 01** Insert display stands onto feet by pressing their knobs.

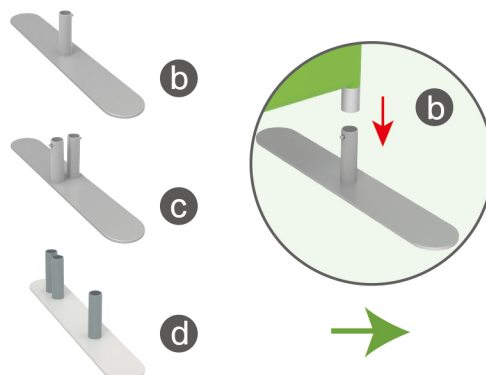
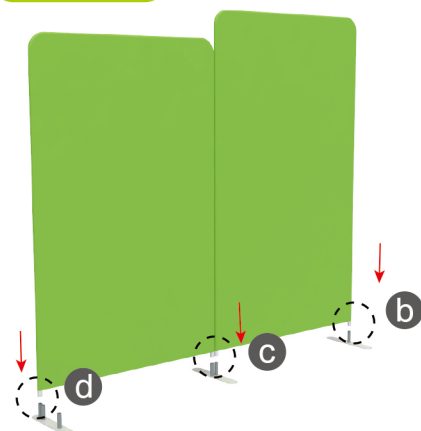

## STEPS

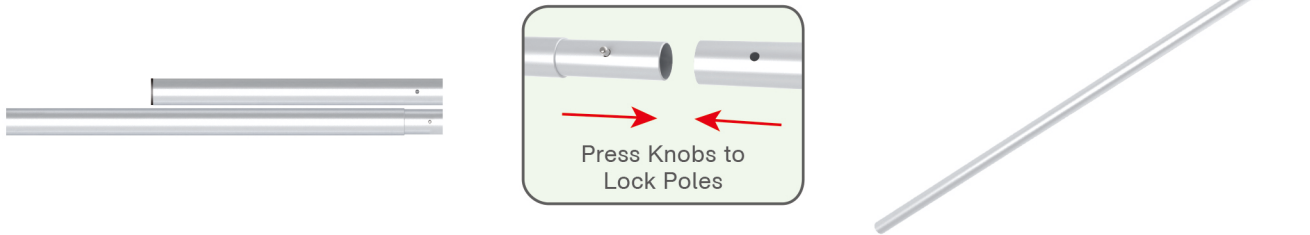
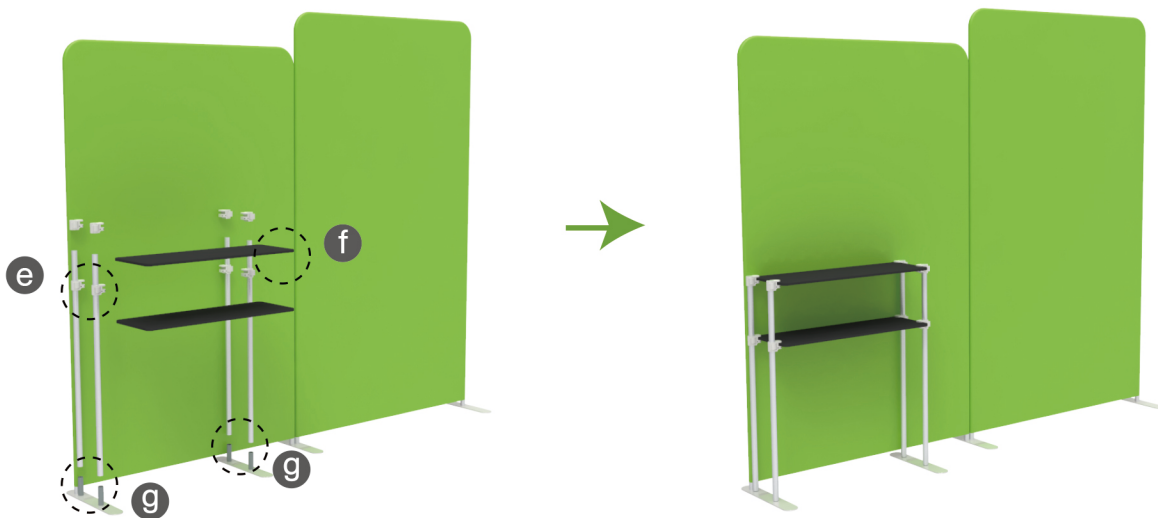
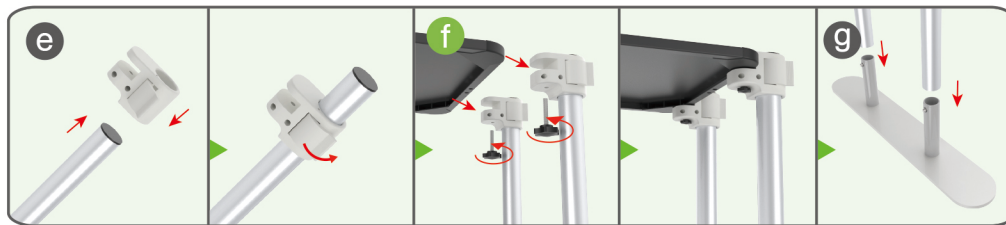
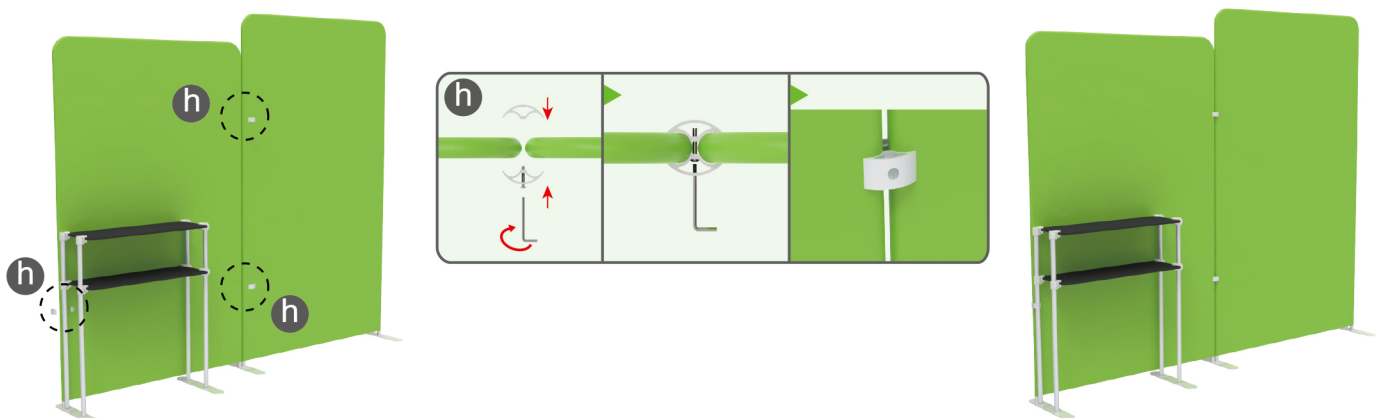
**STEP 02** Connect long poles with corner poles according to labelings.**STEP 03** Install shoe rack shelving kit on left.**STEP 04** Interconnect display stands with C-shaped clips.

## STEPS

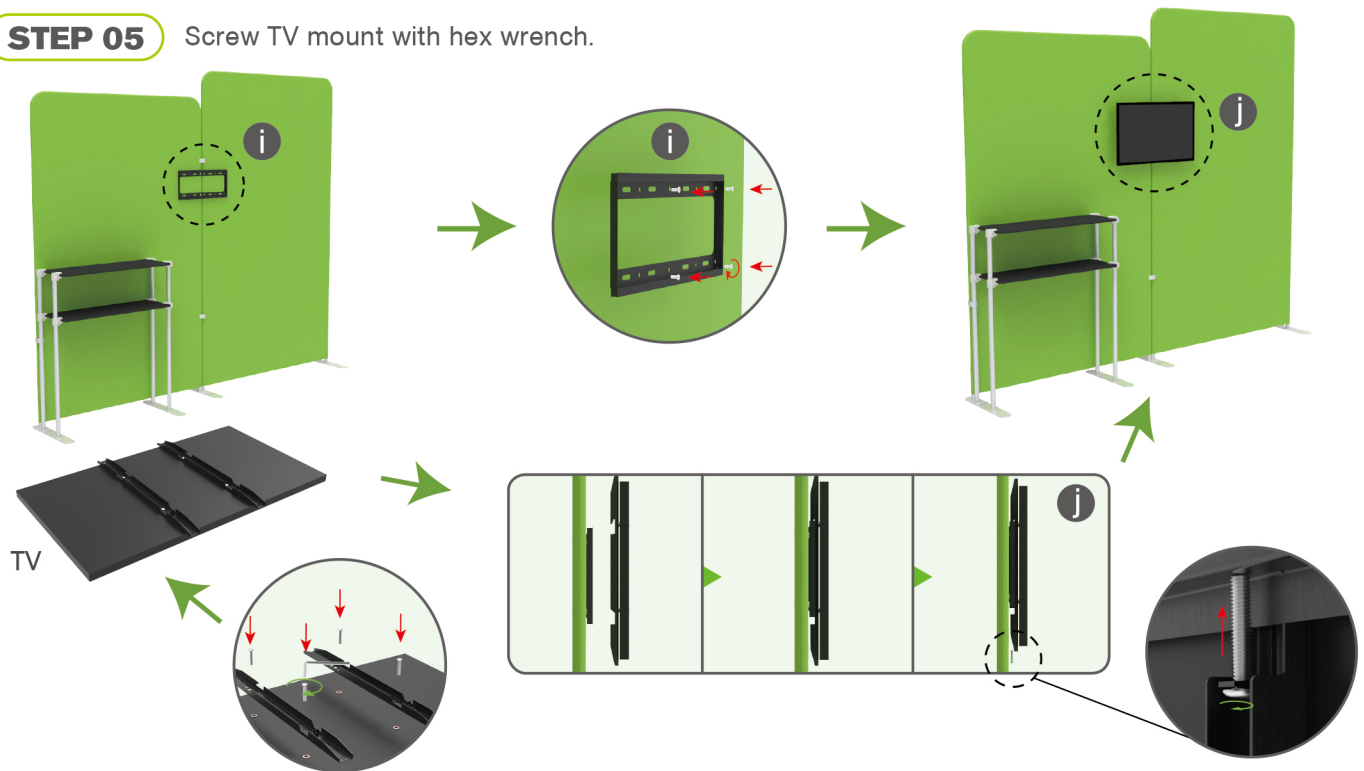
**STEP 05** Screw TV mount with hex wrench.**STEP 06** Screw light clips at top of display stands, slide lights onto them and adjust their direction.