

## STEPS

## (1) Hardware

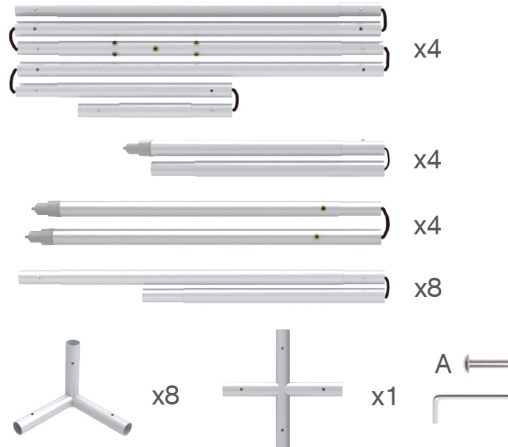

## (2) Printed Graphic Fabric Banner (Optional)



## STEP 01

Connect to make long poles according to labelings.

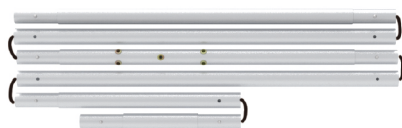

x4



x4



x4



x8

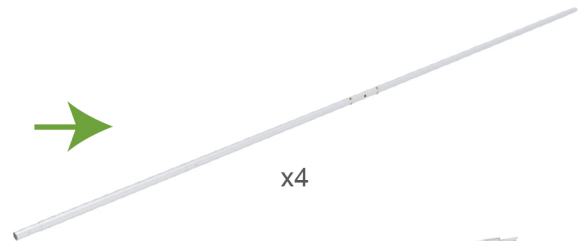
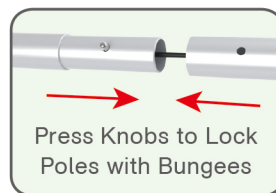

x4



x4



x4



x8

## STEP 02

Connect long poles with corner poles according to labelings.

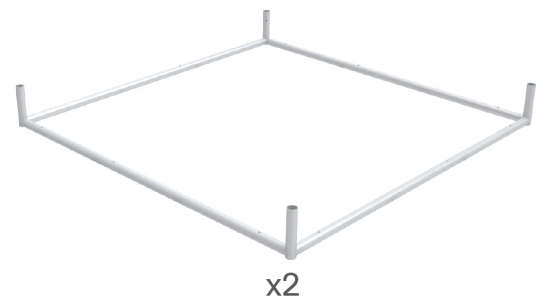
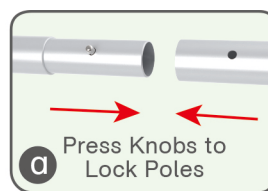
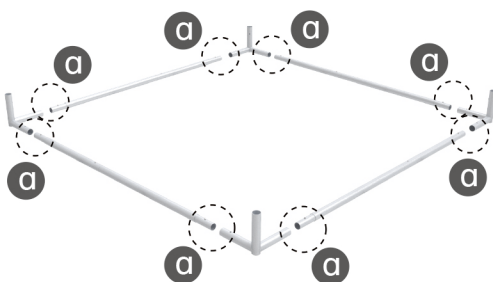

x2

## STEPS

**STEP 03** Connect top and bottom square with long poles according to labelings.

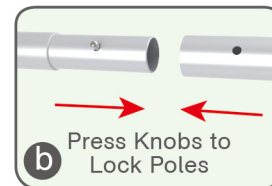
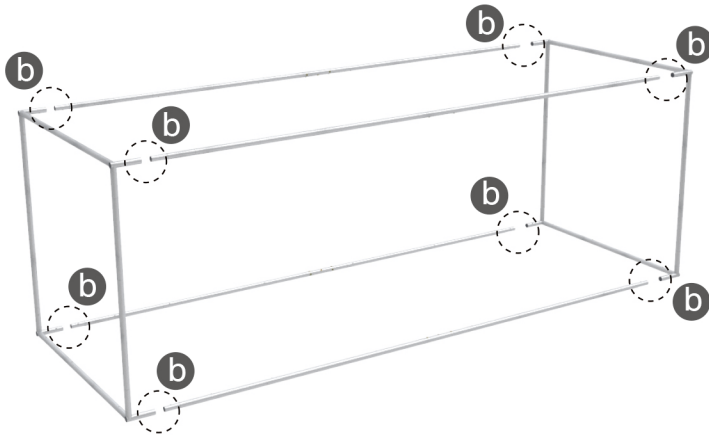
**STEP 04**

Connect to make support poles.

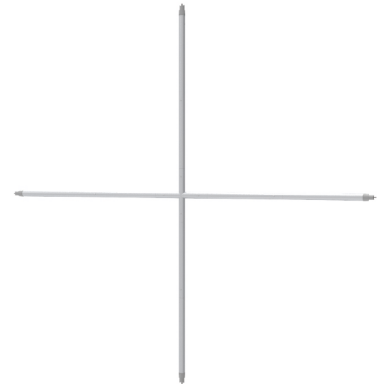
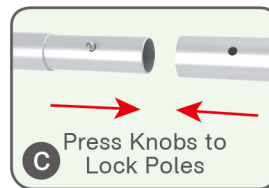
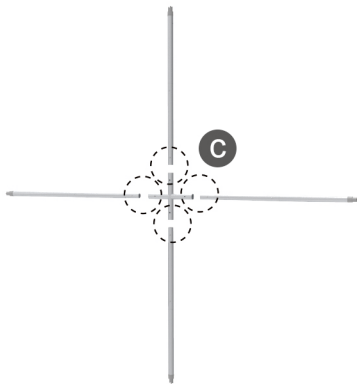

**STEP 05** Connect support poles onto frame.

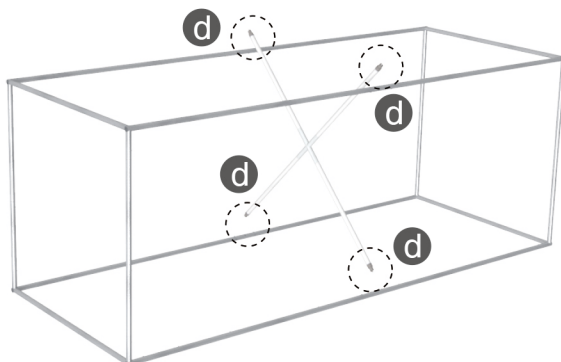
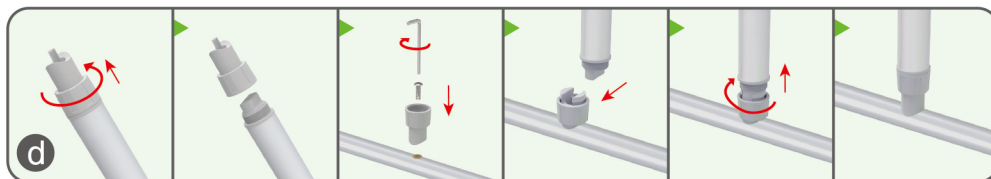

## STEPS

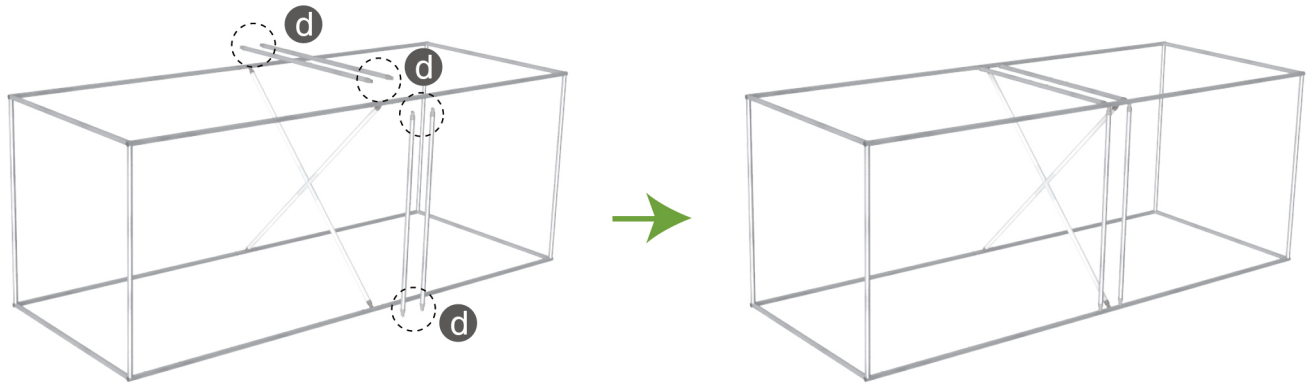

## STEP 06

Slide fabric banner on frame from top and zip up at bottom.

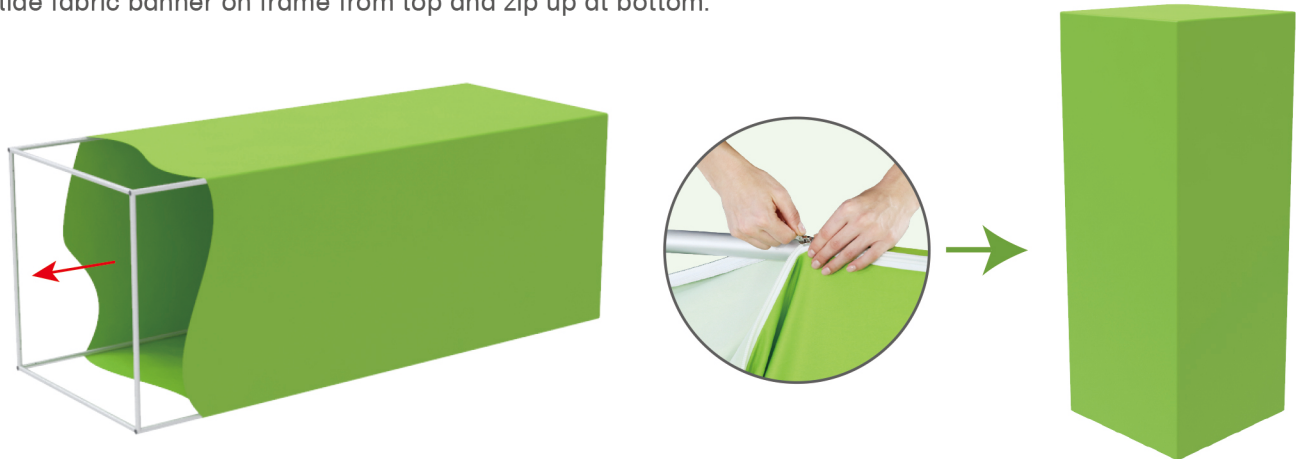

## STEP 07

Screw TV mount with hex wrench.

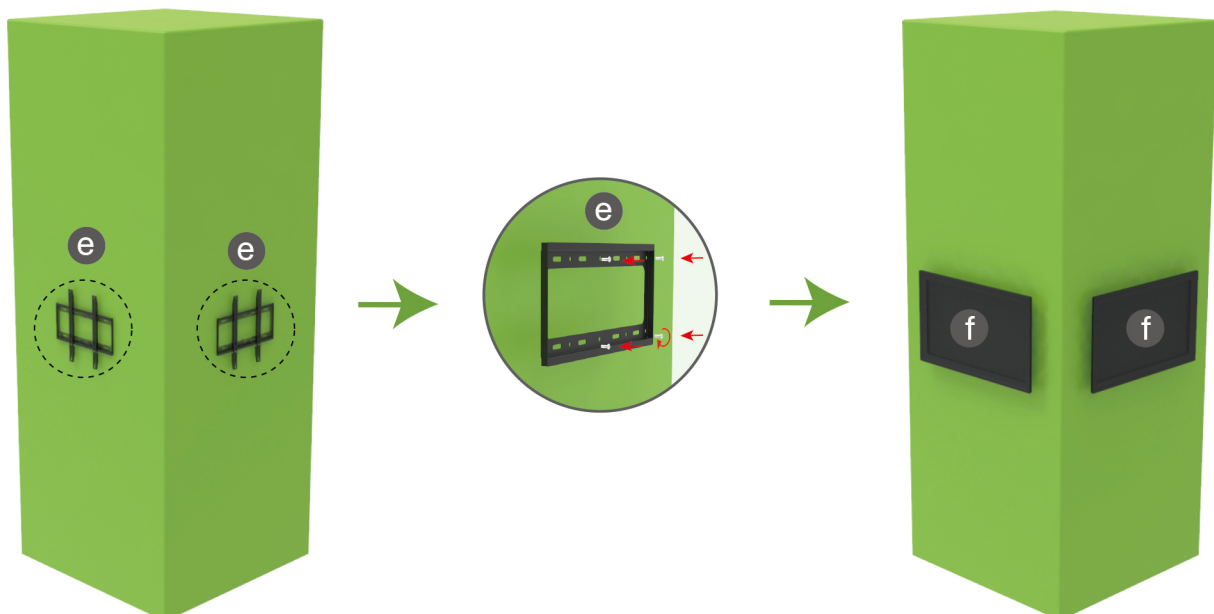

## STEPS

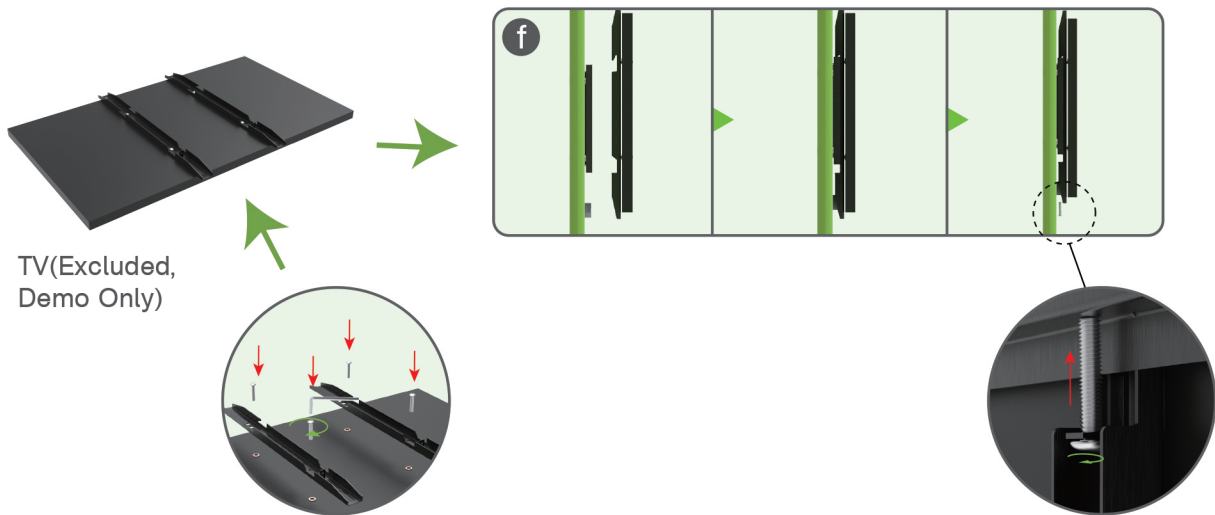

## (1) Hardware



## (2) Printed Graphic Fabric Banner (Optional)



## (3) LED Ladder Light &amp; Switching Power Supply

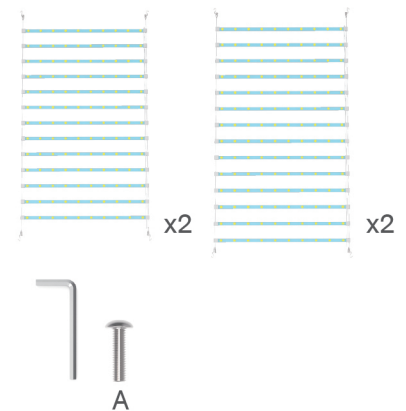

## STEP 01

Connect to make long poles according to labelings.

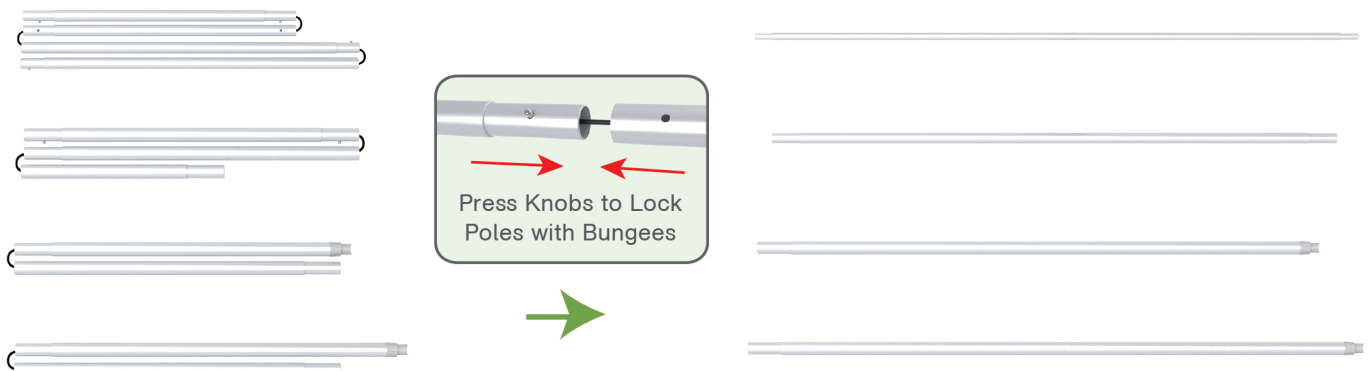

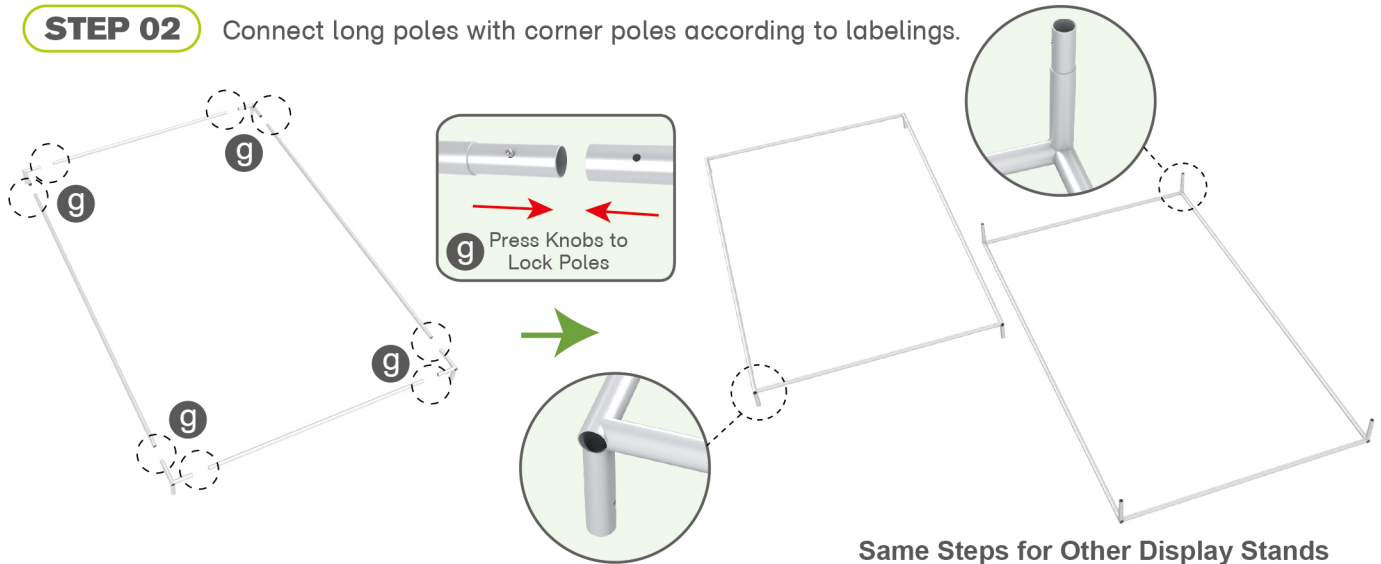
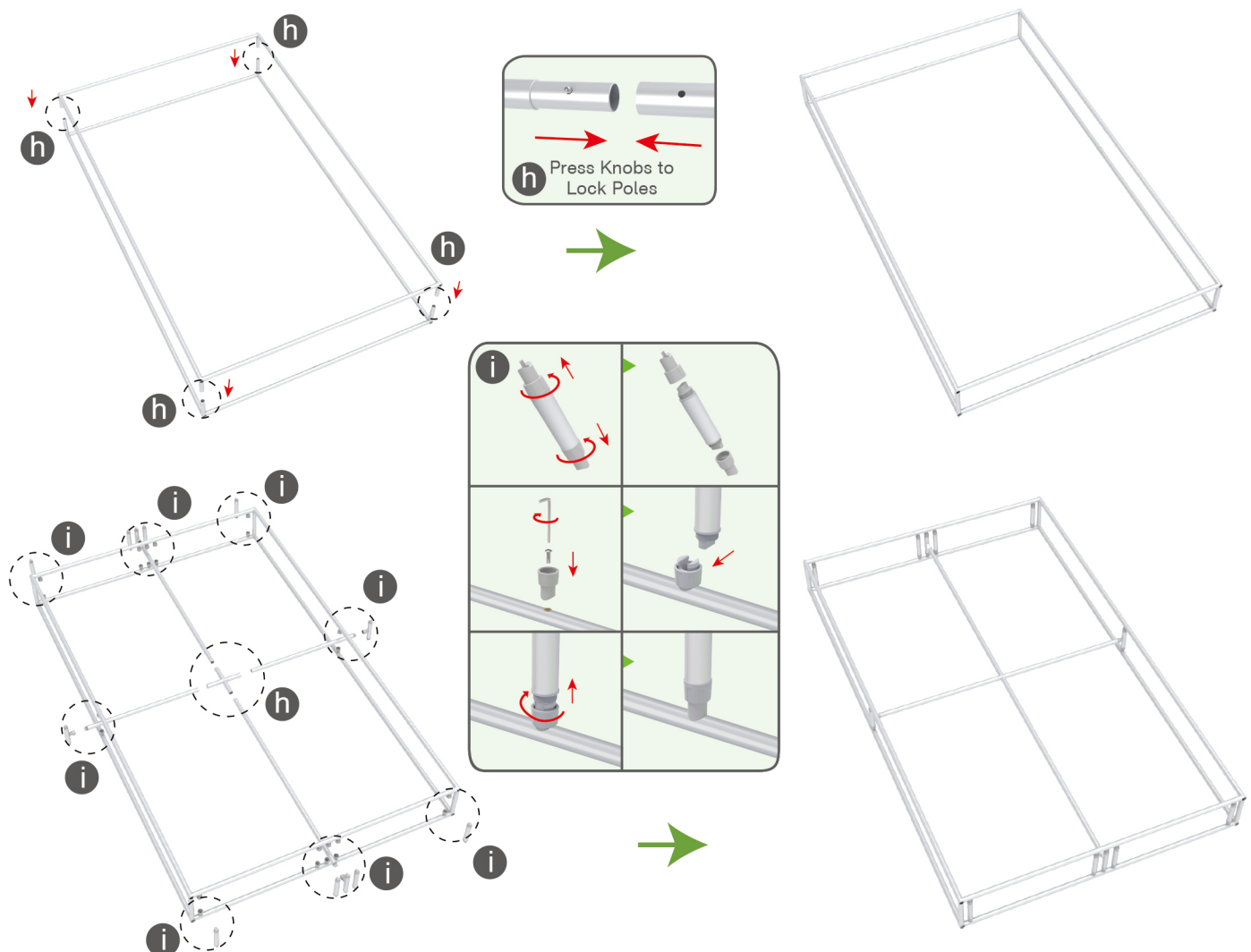

## STEPS

**STEP 02** Connect long poles with corner poles according to labelings.**STEP 03** Connect to make column frame according to labelings, connect support poles onto column frame according to labelings.



## STEPS

## STEP 01

Connect to make long poles according to labelings.

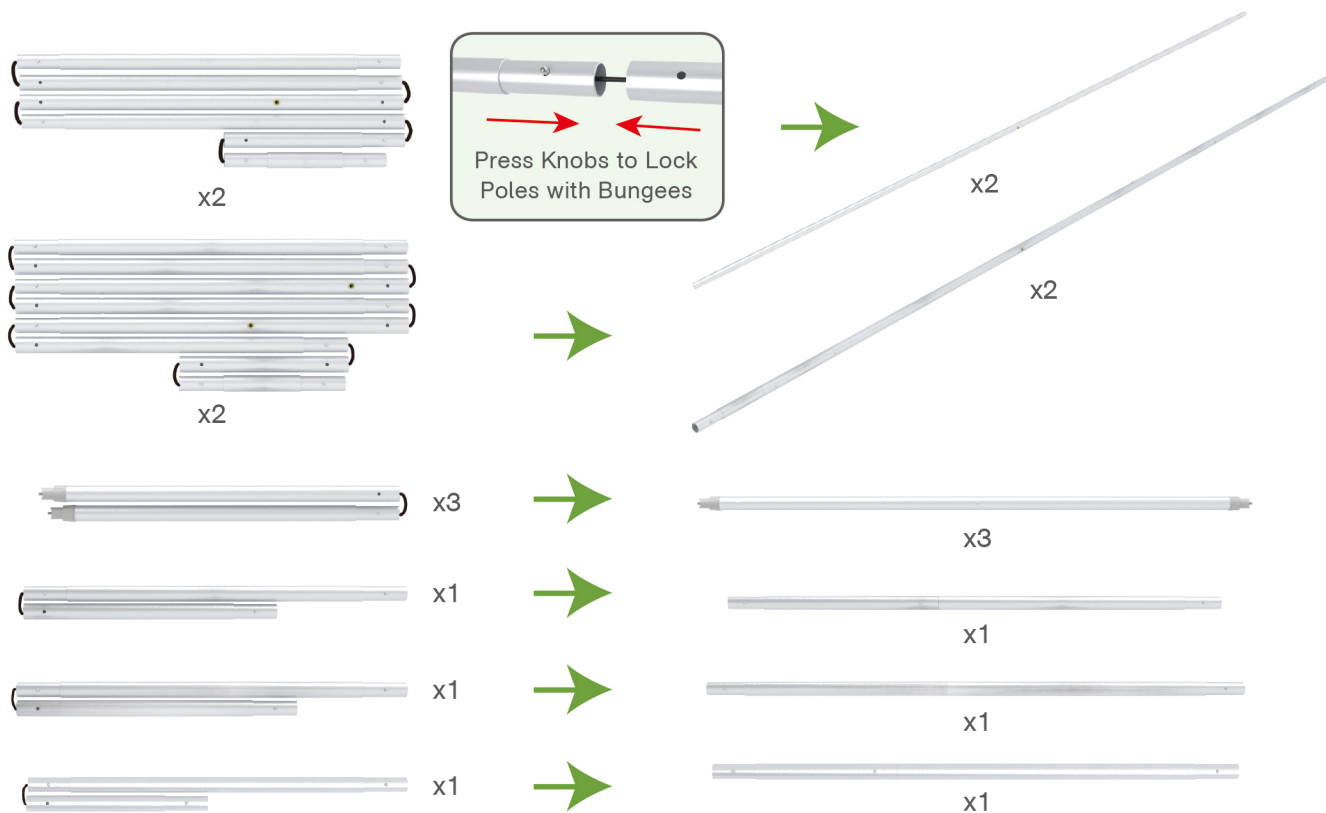

## STEP 02

Connect long poles with corner poles according to labelings.

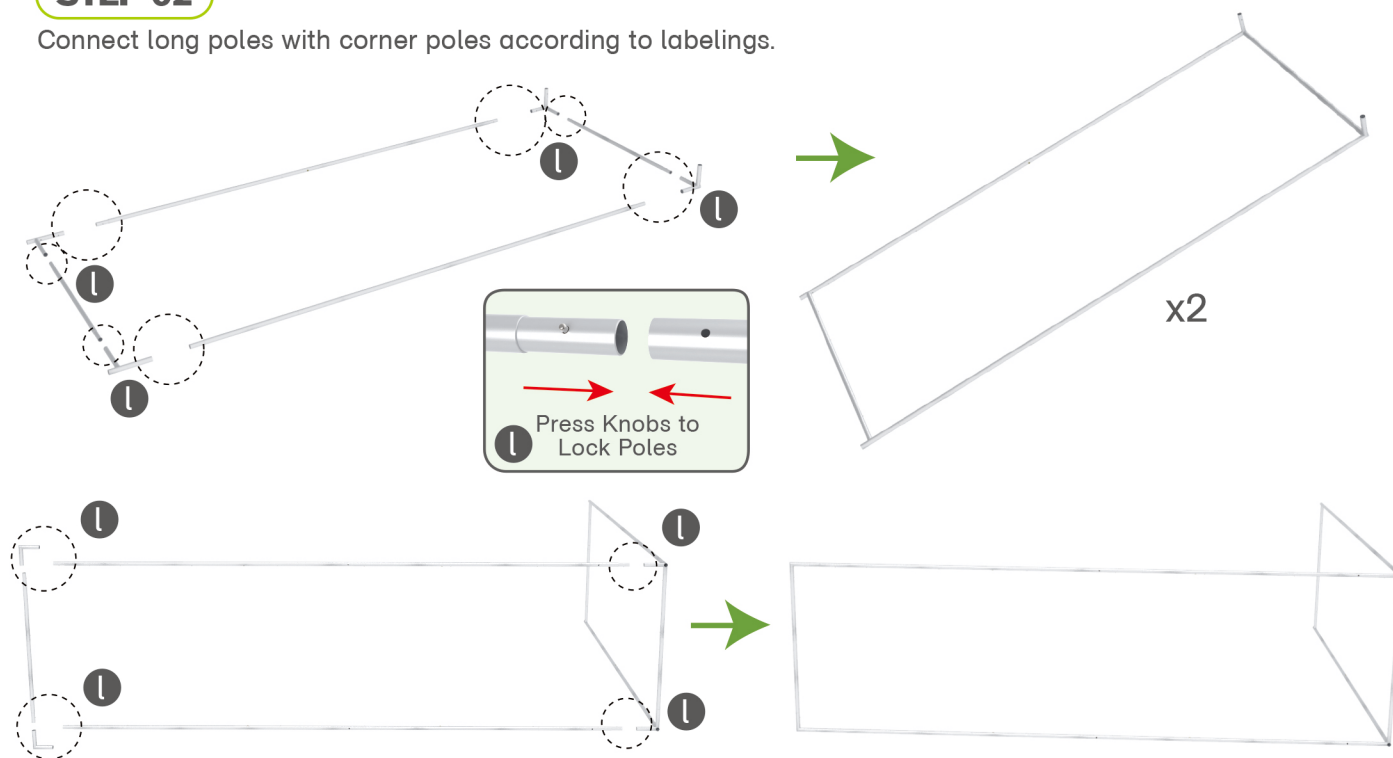

## STEPS

## STEP 03

Connect support poles onto frame.

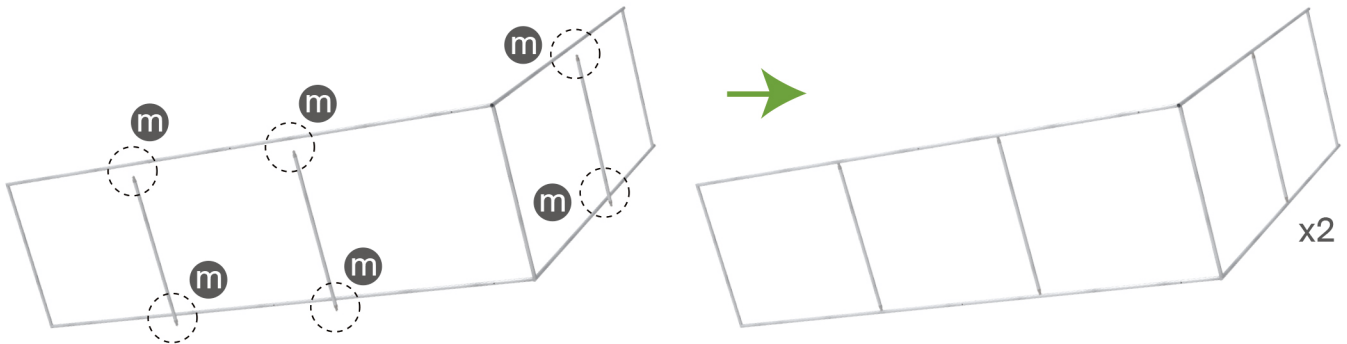
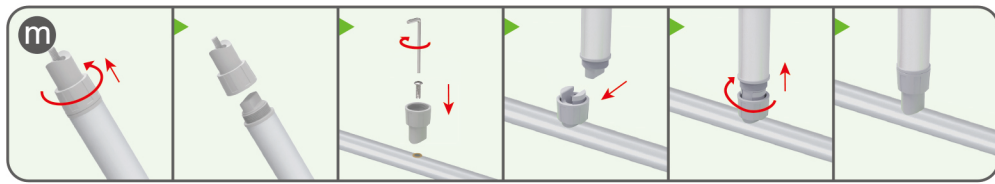

## STEP 04

① Slide fabric banner on arch frame from bottom and zip up at top's hole.

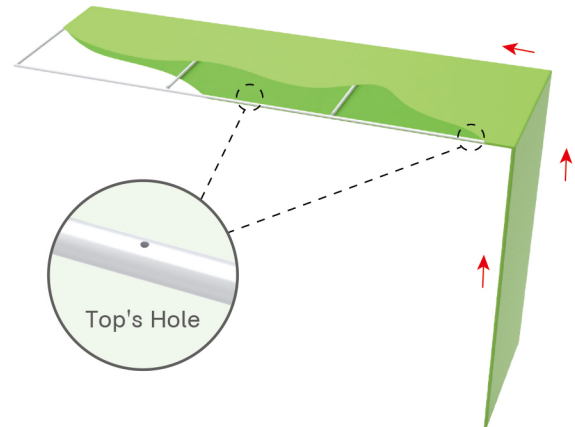

② Insert support poles into backlit display column's top.

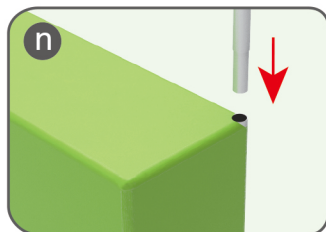
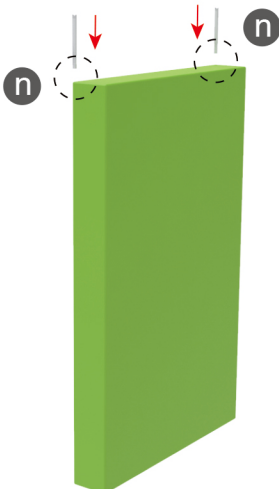



## STEPS

- ③ Install support poles onto top's holes of arch frame with hex wrench & screws.

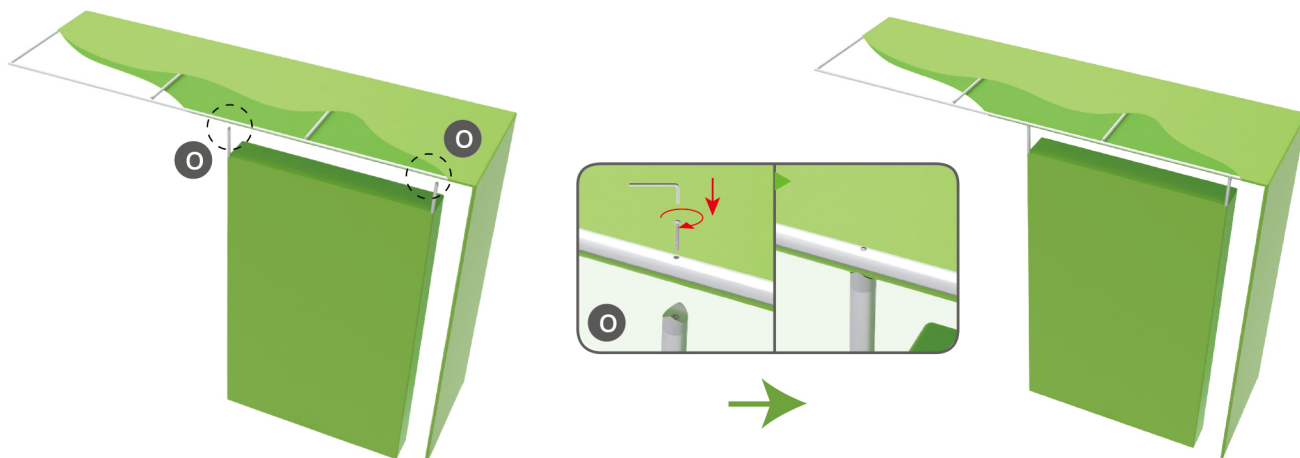

- ④ Continue sliding fabric banner on frame and zip up at end.

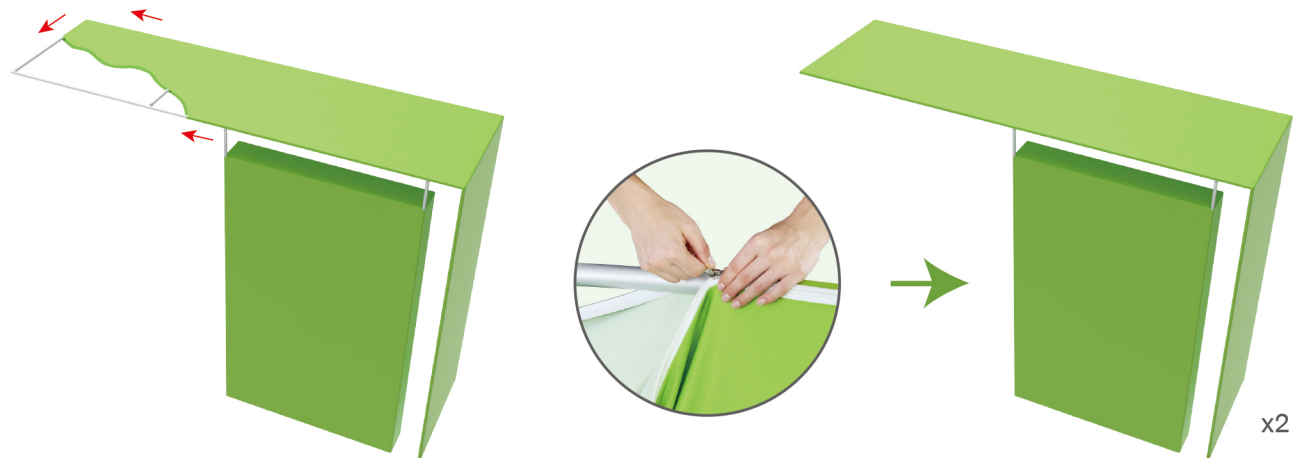

## STEP 05

Insert display stands onto feet by pressing their knobs, interconnect display stands with C-shaped clips.

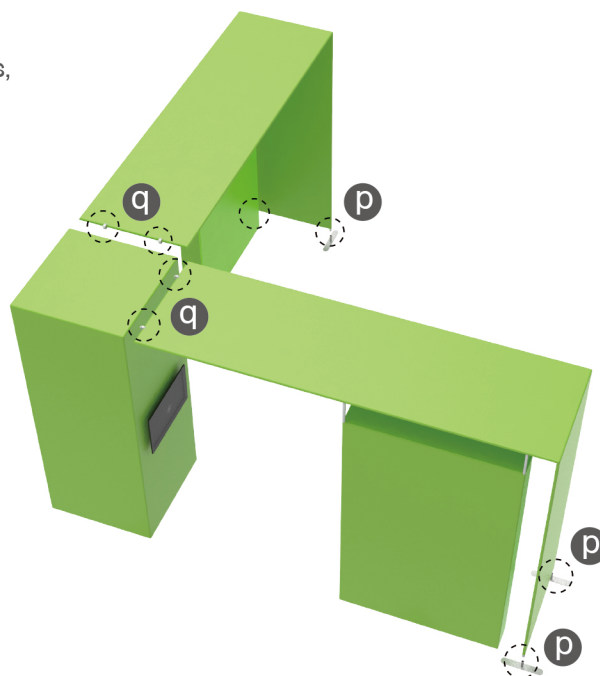
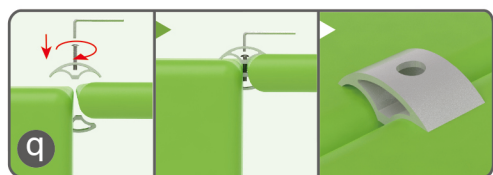
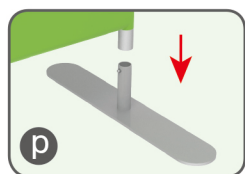

## STEPS

## Effect with Lights On

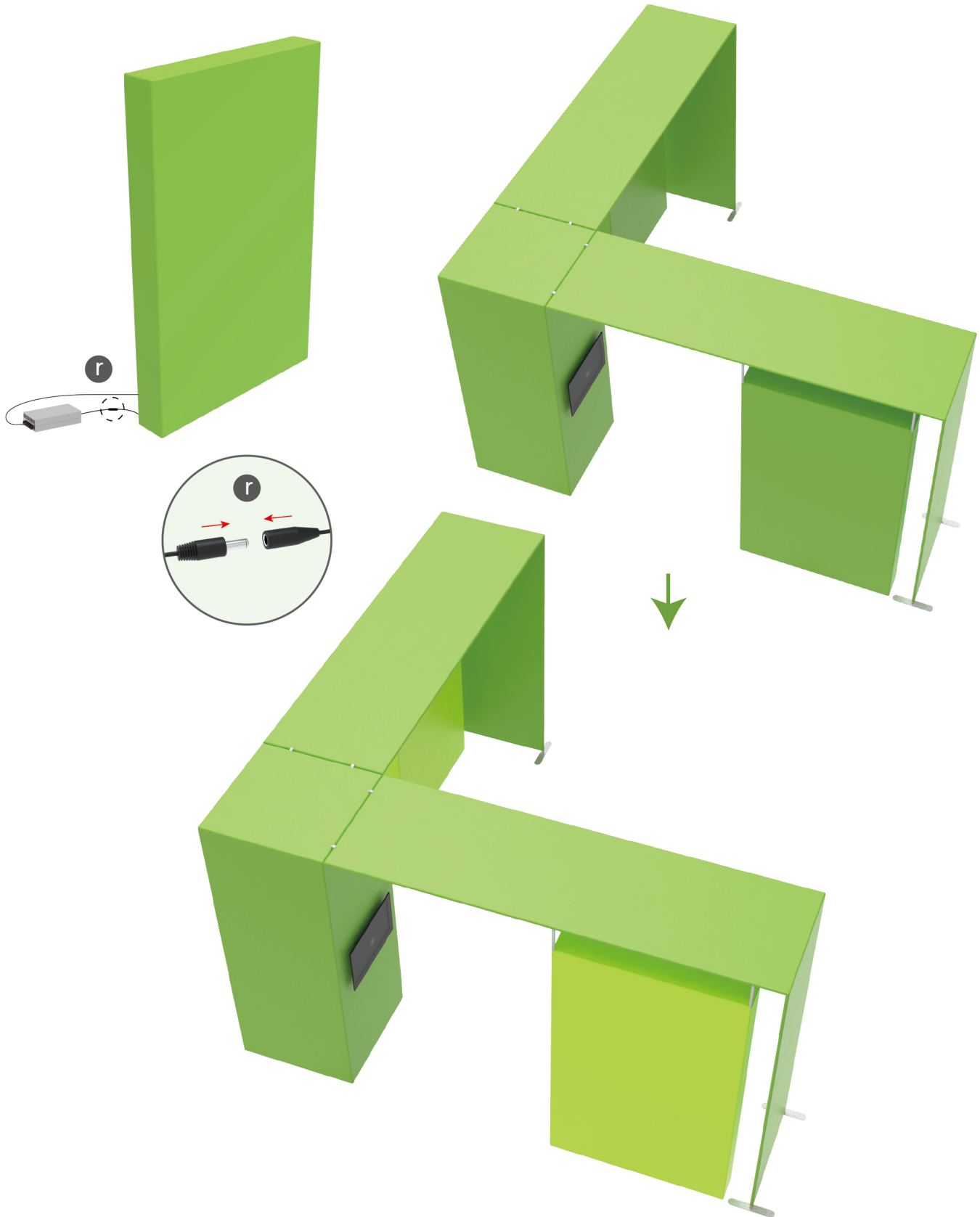



## STEPS

## (1) Hardware

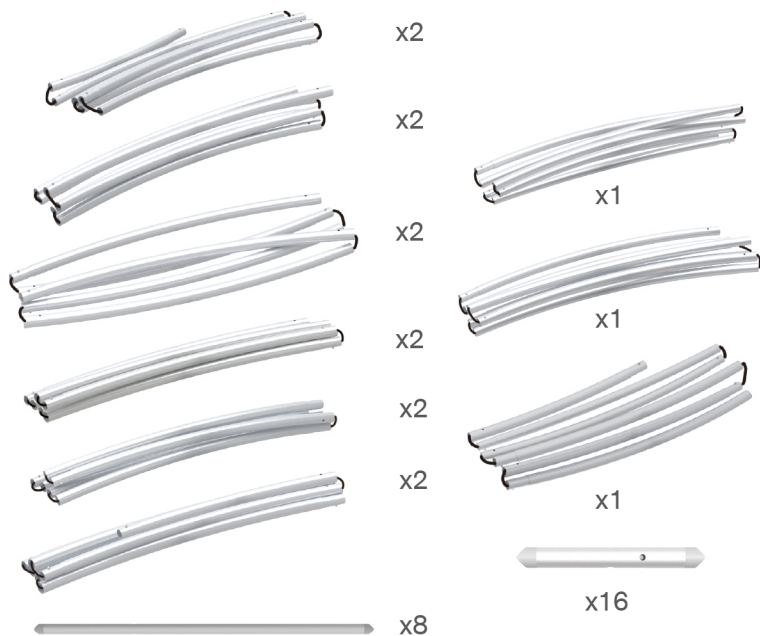

## (2) LED Ladder Light &amp; Switching Power Supply

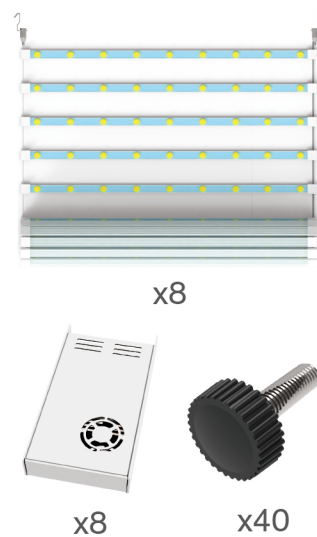

## (3) Screw A, Screw B, Wire with Hook

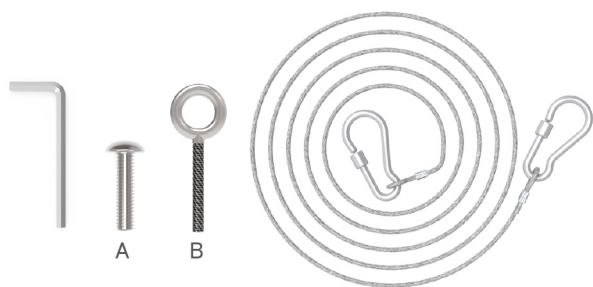

## (4) Printed Graphic Fabric Banner (Optional)

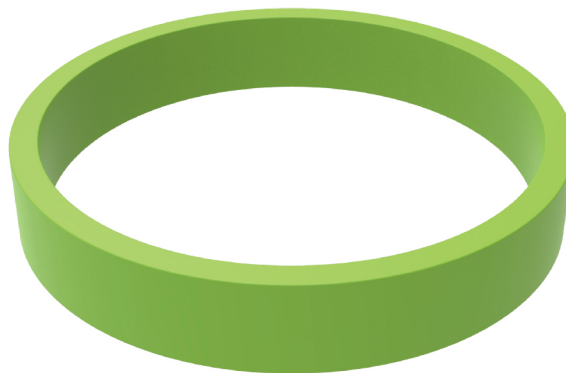

## STEP 01

Connect to make long poles according to labelings.

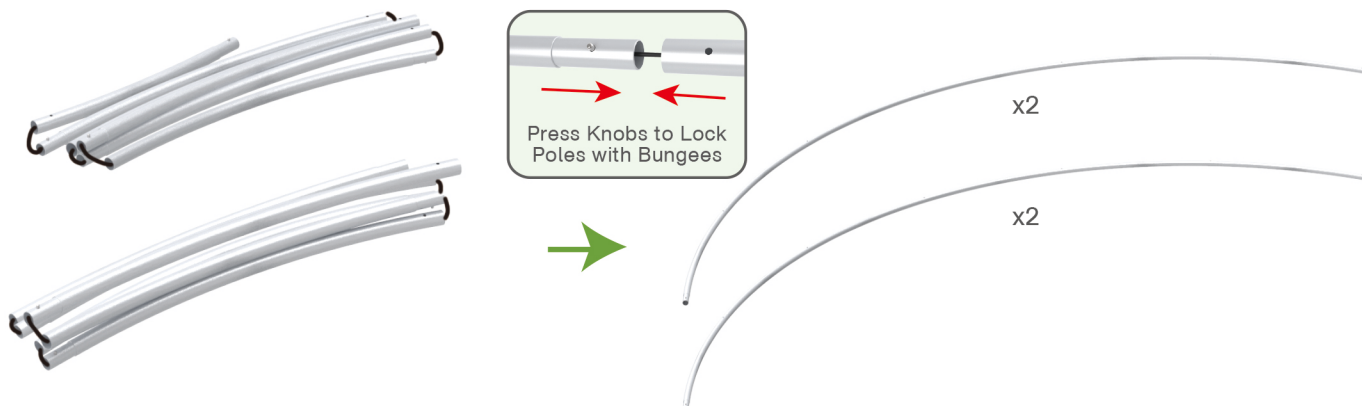

## STEPS

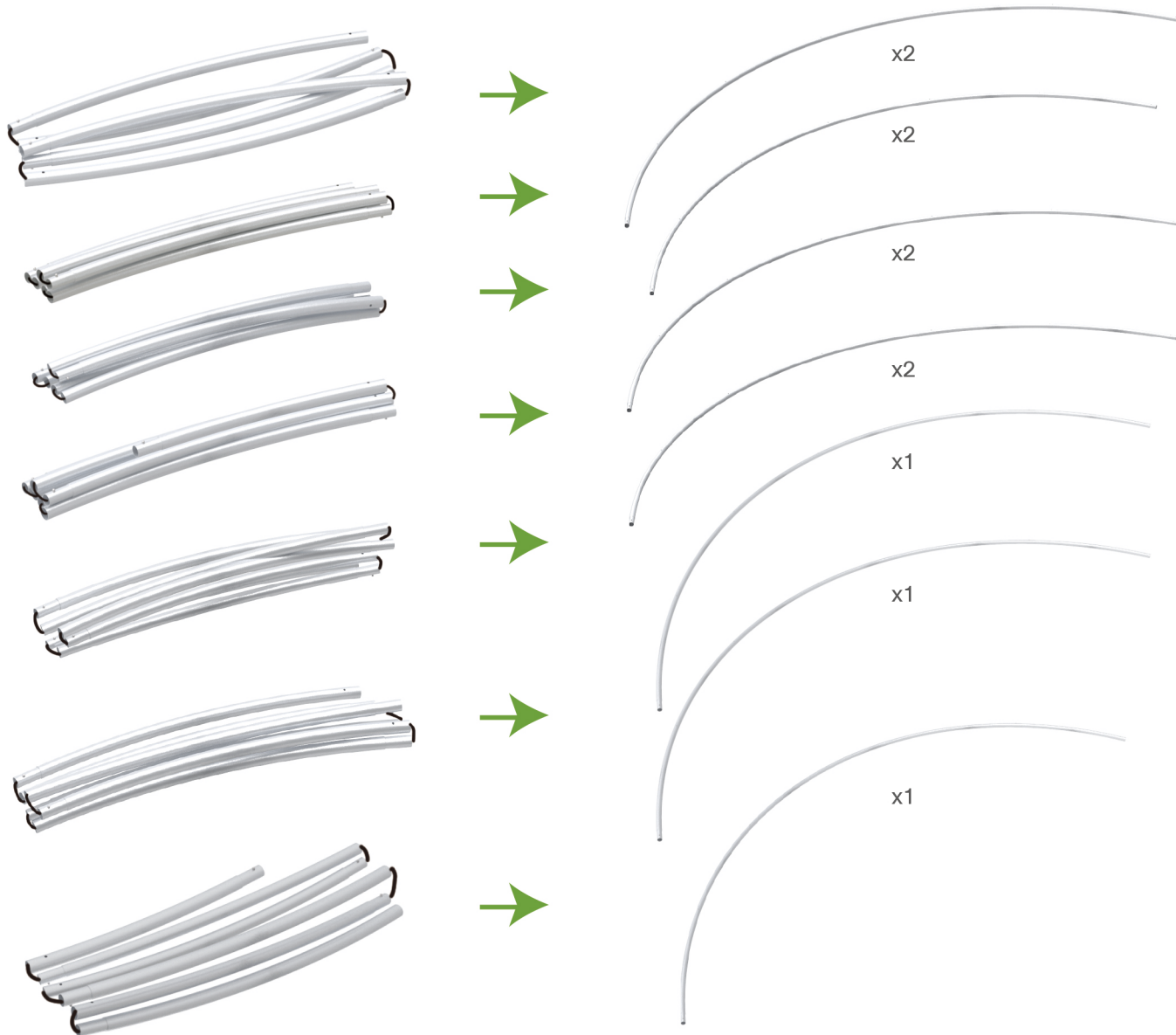

## STEP 02

Assemble support poles with hex wrench & screws.

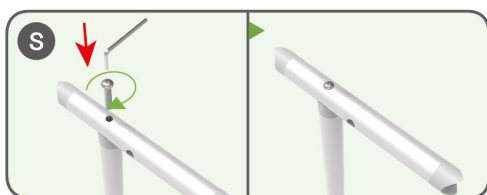

## STEPS

**STEP 03** Connect long poles with corner poles according to labelings.

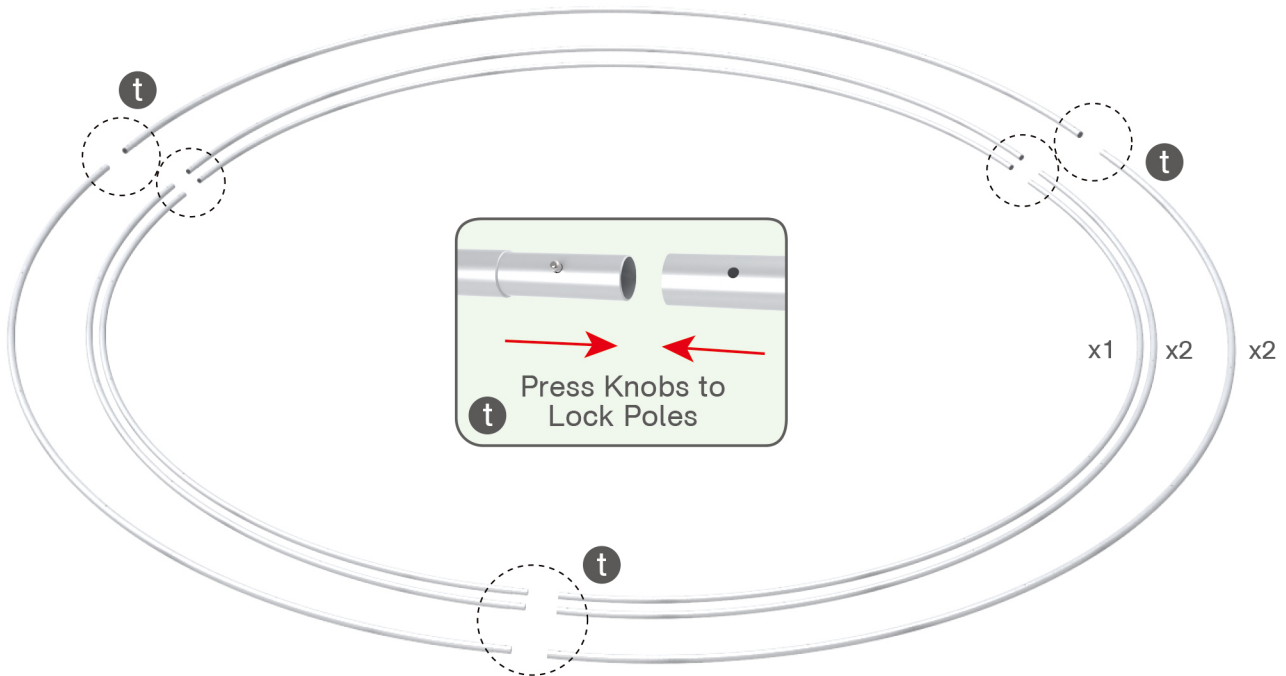
**STEP 04**

Connect support poles onto frame with screws B at top & screws A at middle & bottom.

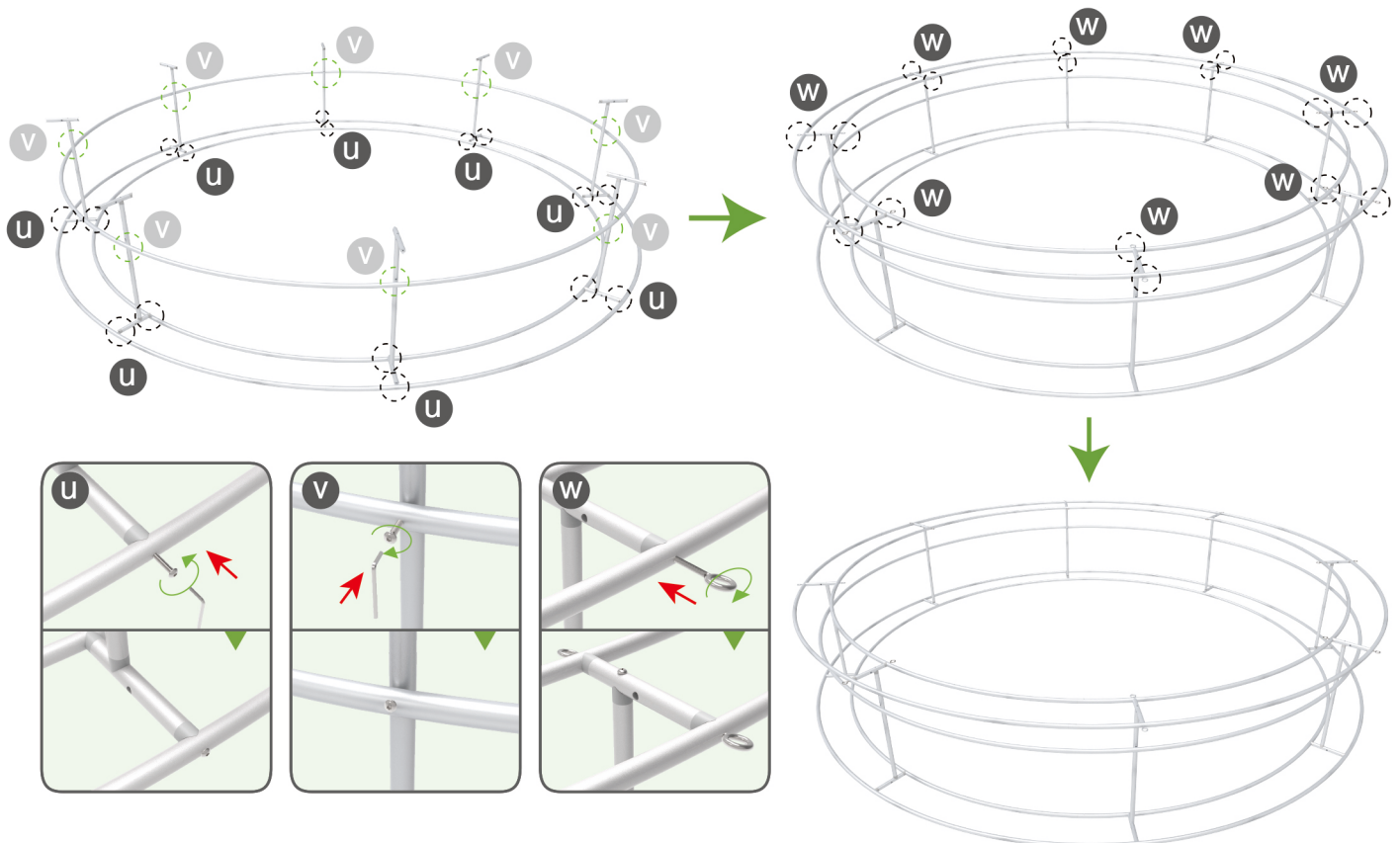

## STEPS

## STEP 05

Hang LED ladder light into poles' holes.

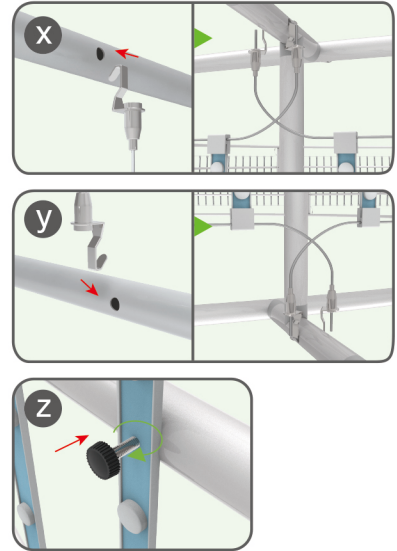
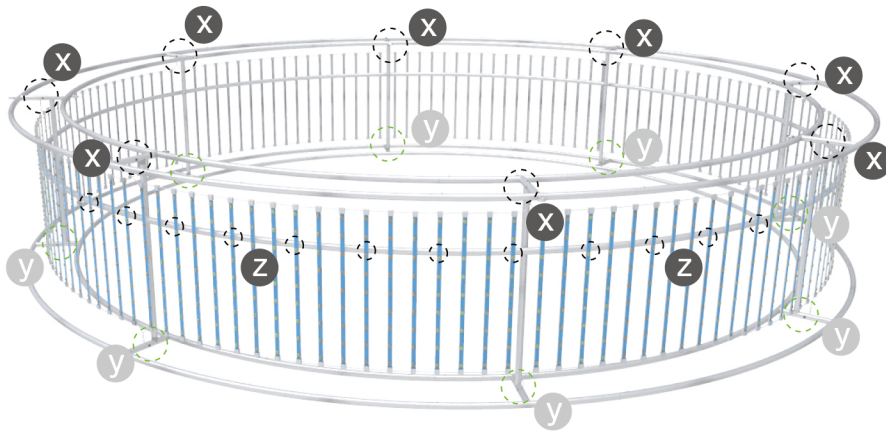

## STEP 06

Slide fabric banner on frame from bottom and zip up at top.

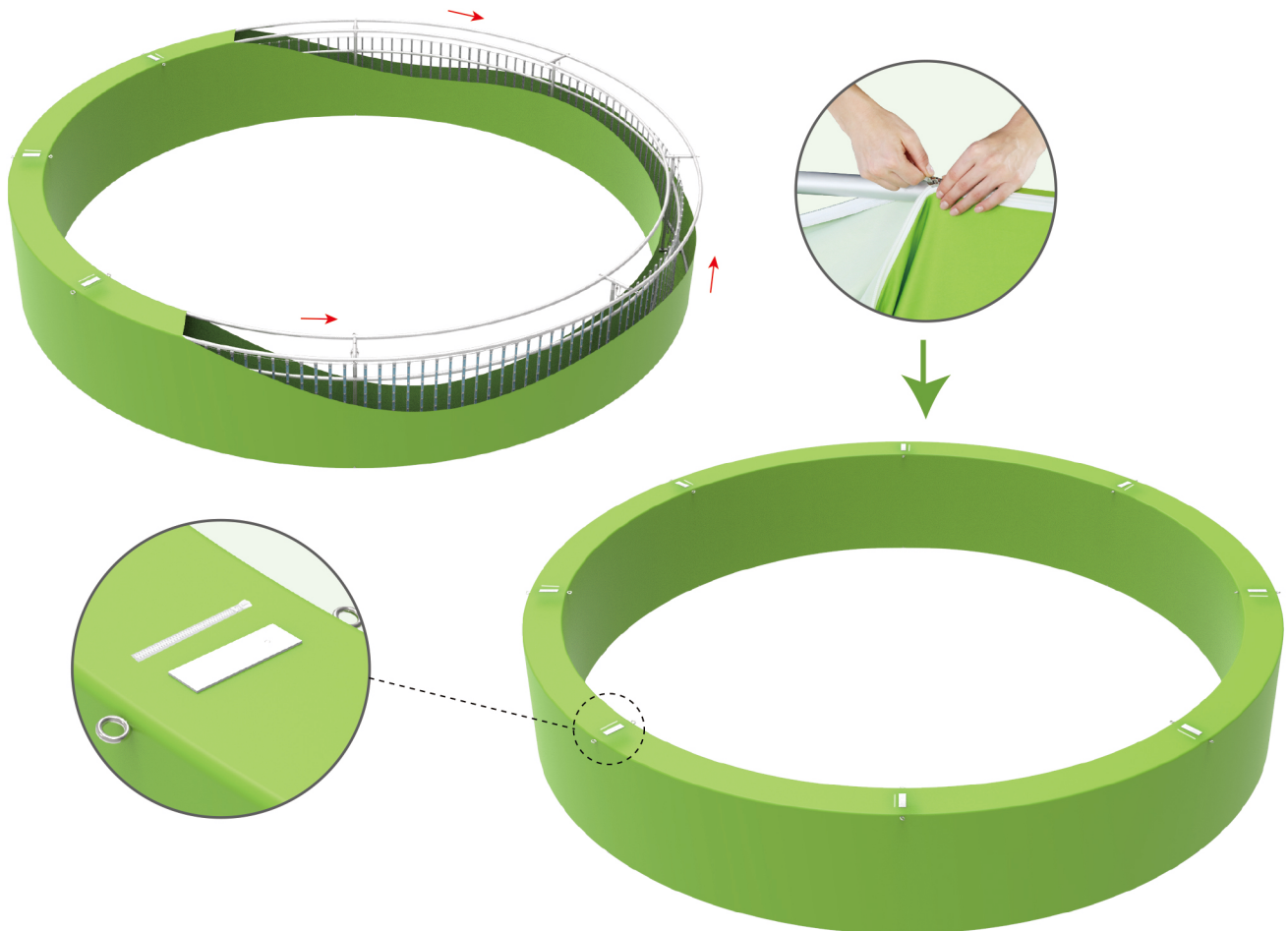



## STEPS

## STEP 07

Connect switching power supplies by laying them in position via velcros.

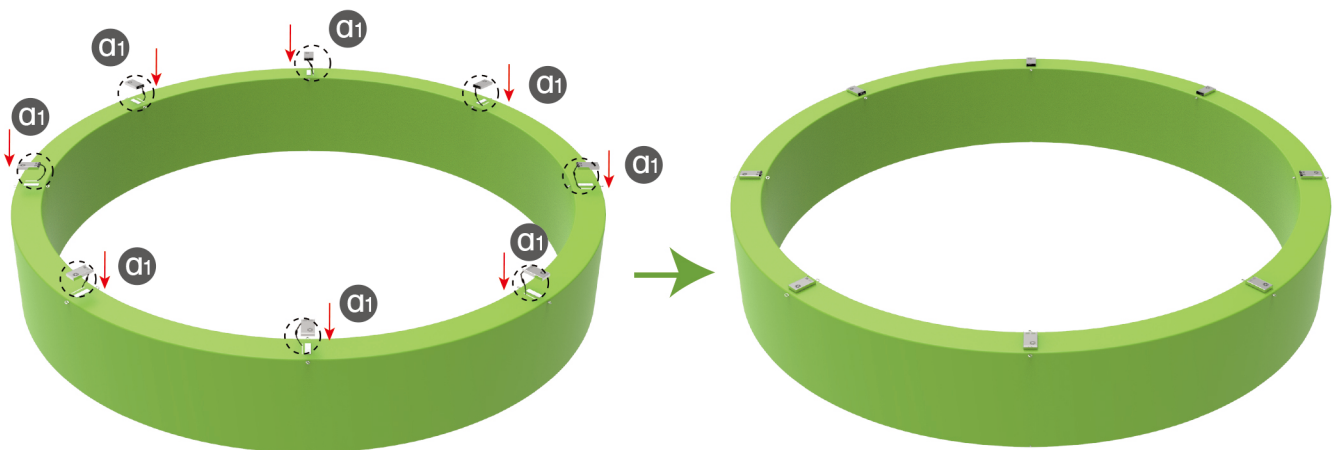
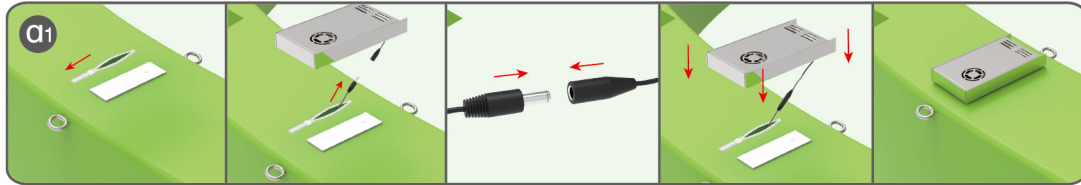

## STEP 08

Connect screws B by wires with hooks.

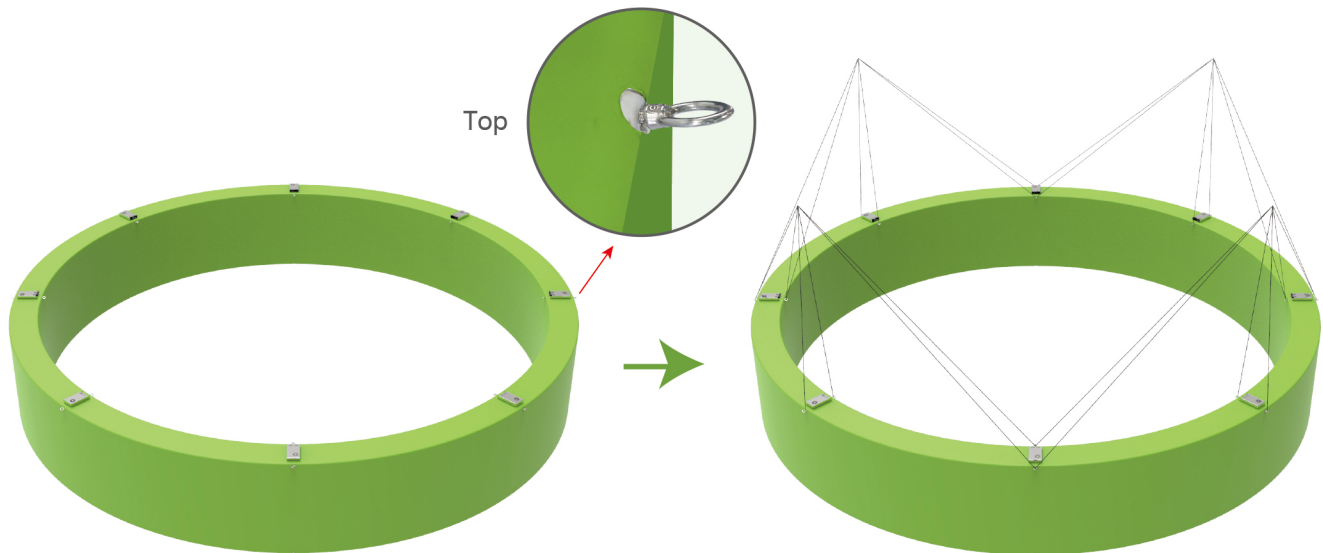

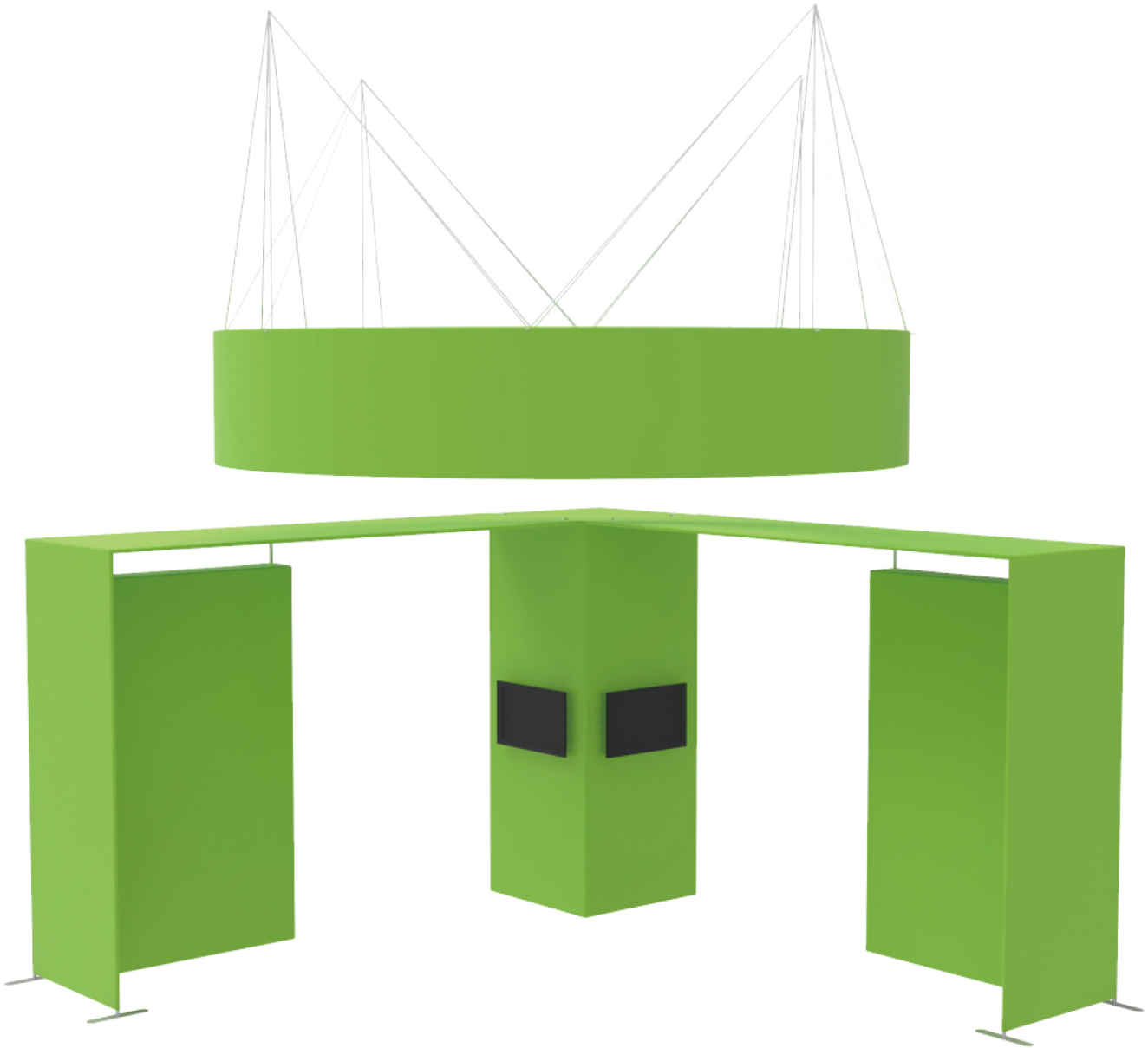
**STEPS****20X20FT-BOOTH-10**