

INSTRUCTION

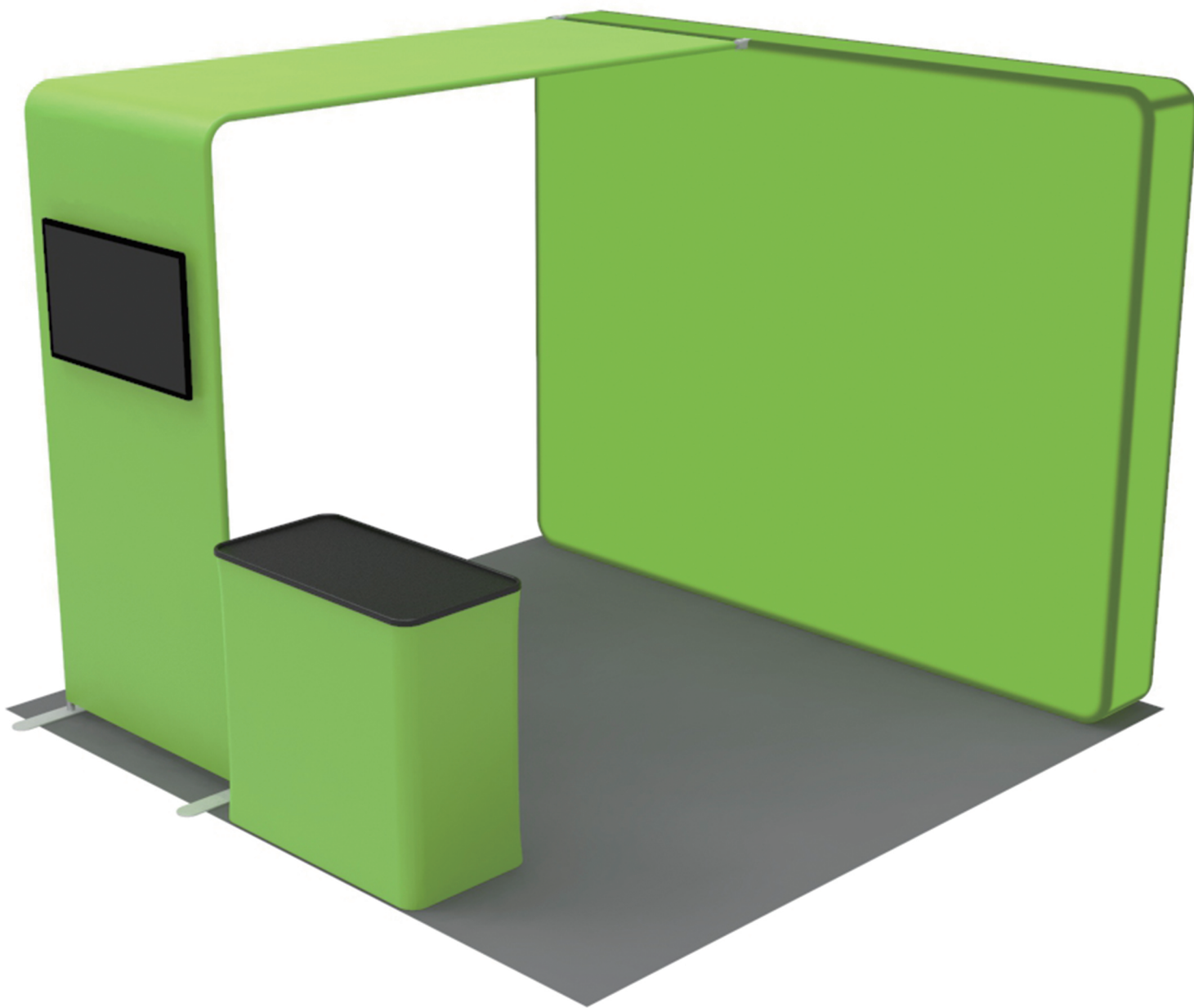

10X10FT-BOOTH-29

★ One Tool (Hex Wrench)

STEPS

(1) Hardware

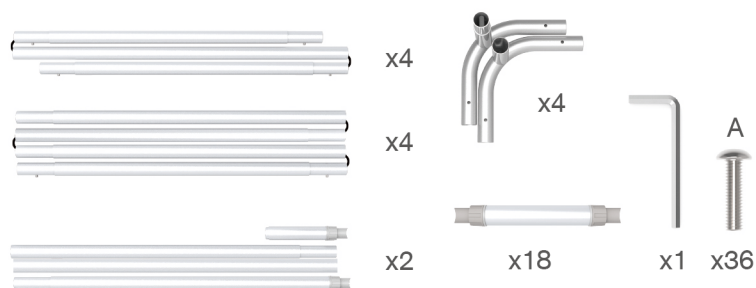

(2) Printed Graphic Fabric Banner (Optional)

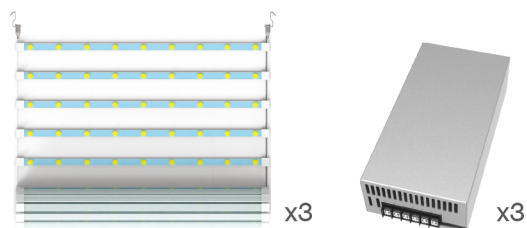
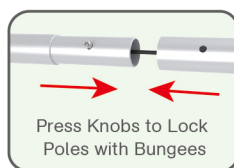

(3) LED Ladder Light & Switching Power Supply

**STEP 01** Connect to make long poles according to labelings.**STEP 02**

Connect long poles with corner poles according to labelings.

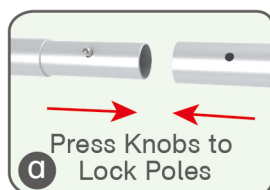
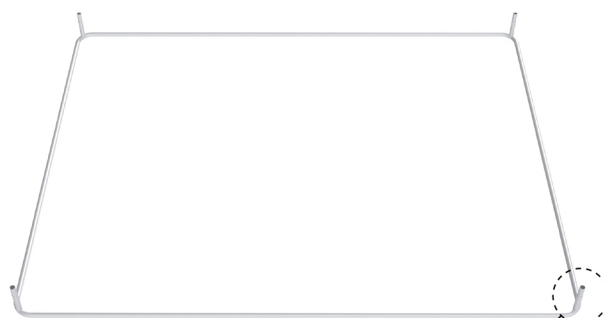
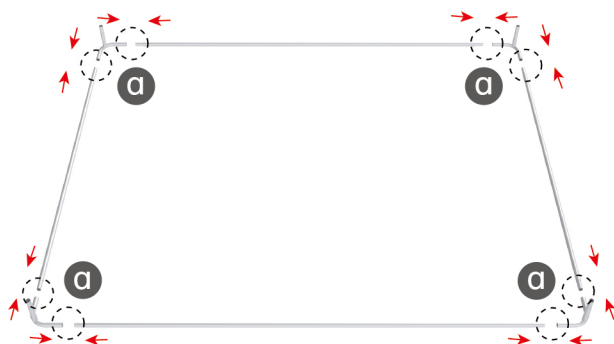

STEPS

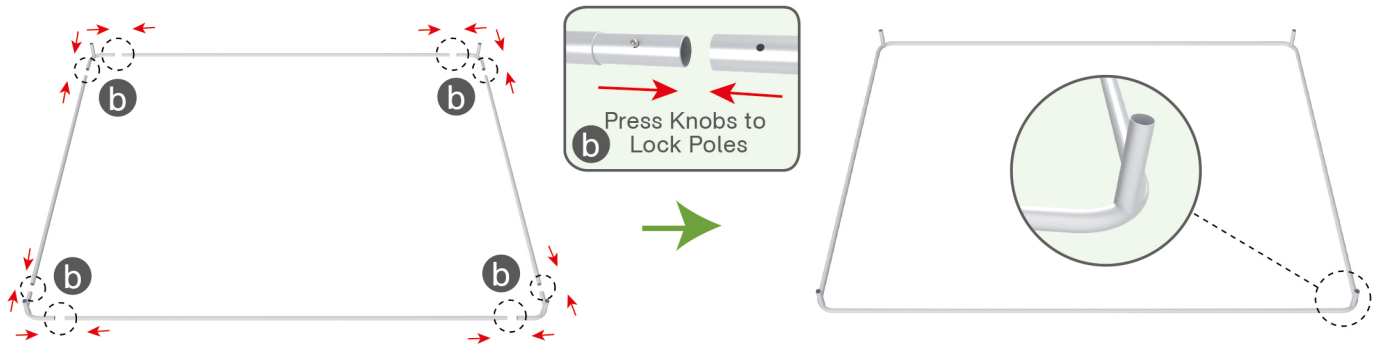

STEP 03 Interconnect corner poles to make column frame according to labelings.

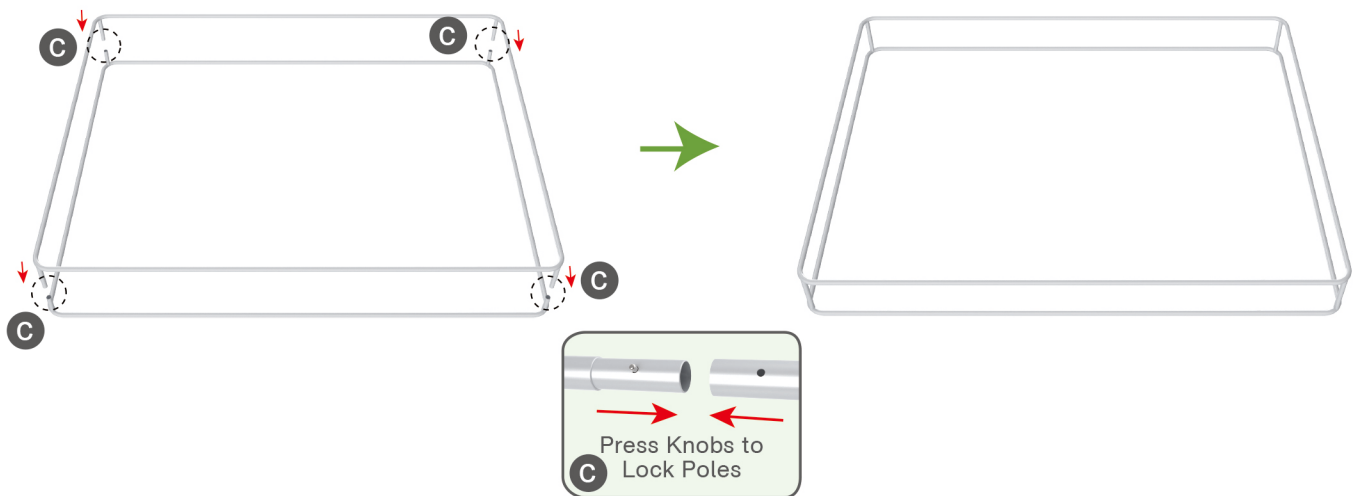

STEP 04 Connect support poles onto column frame.

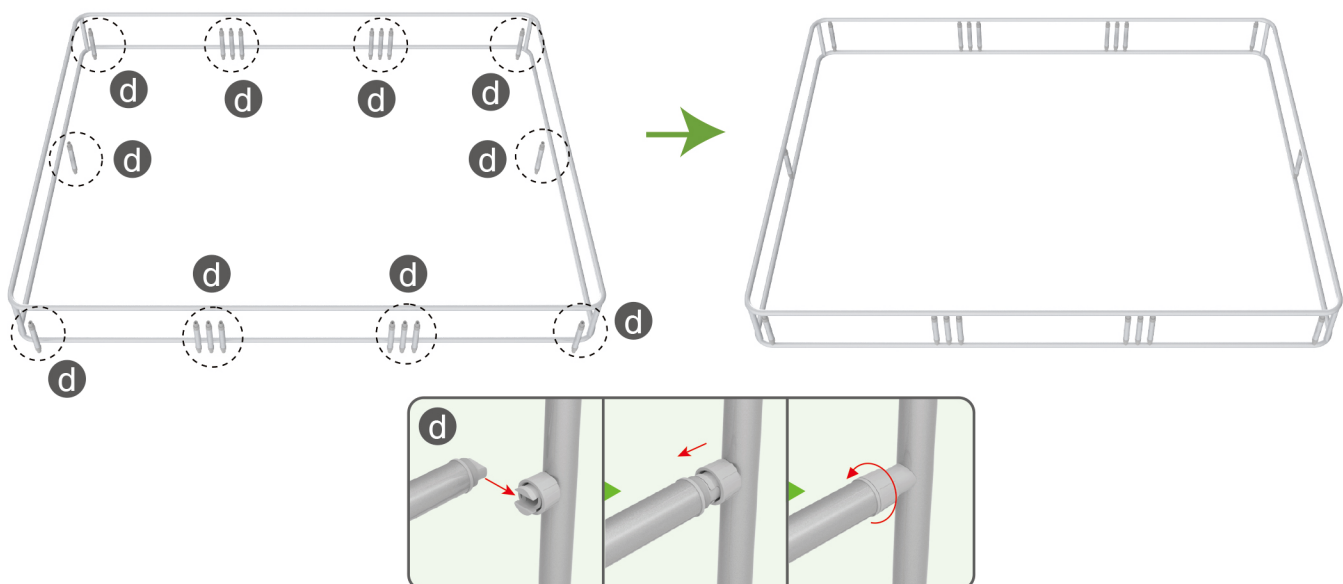

STEPS

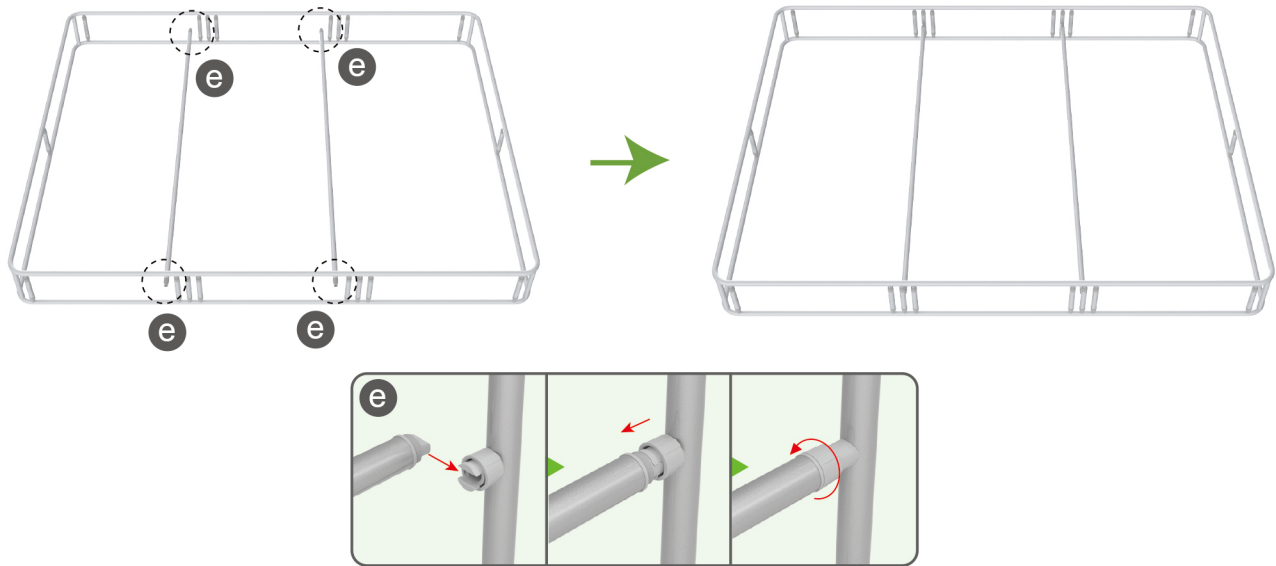

STEP 05 Hang LED ladder lights into poles' holes.

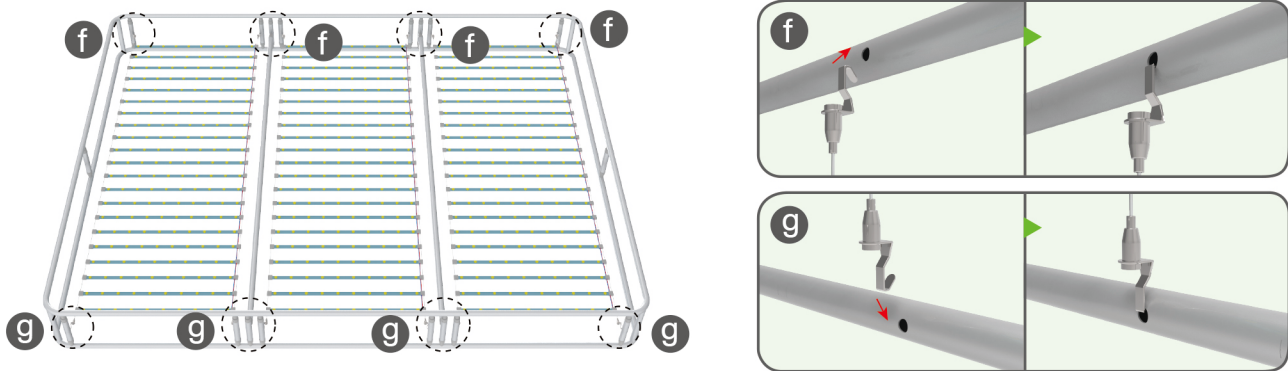
**STEP 06**

Wrap column frame with fabric banner & zip up at corner.



STEPS

STEP 07

Connect switching power supply with wires.

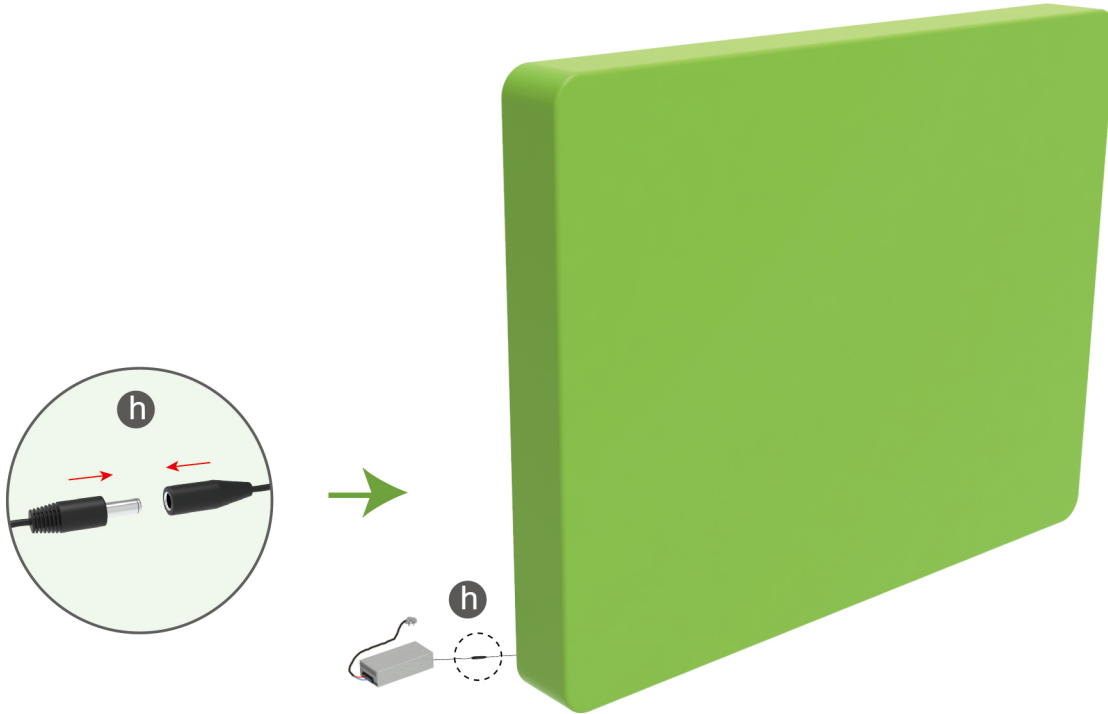

(1) Hardware

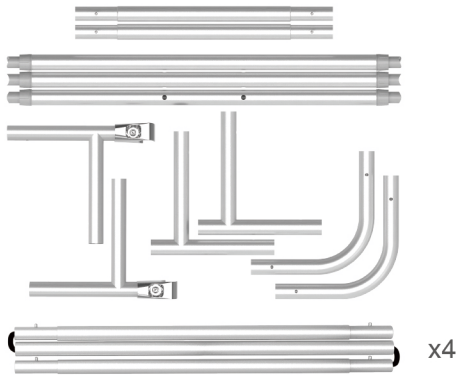

(2) Printed Graphic Fabric Banner (Optional)



STEP 01

Connect to make long poles according to labelings.

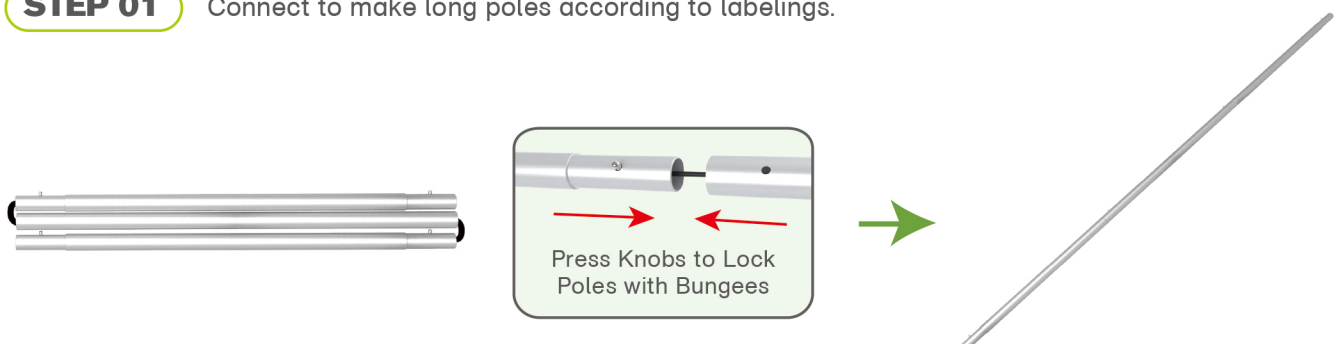

STEPS

STEP 02

Connect long poles with corner poles according to labelings, connect support poles onto frame.

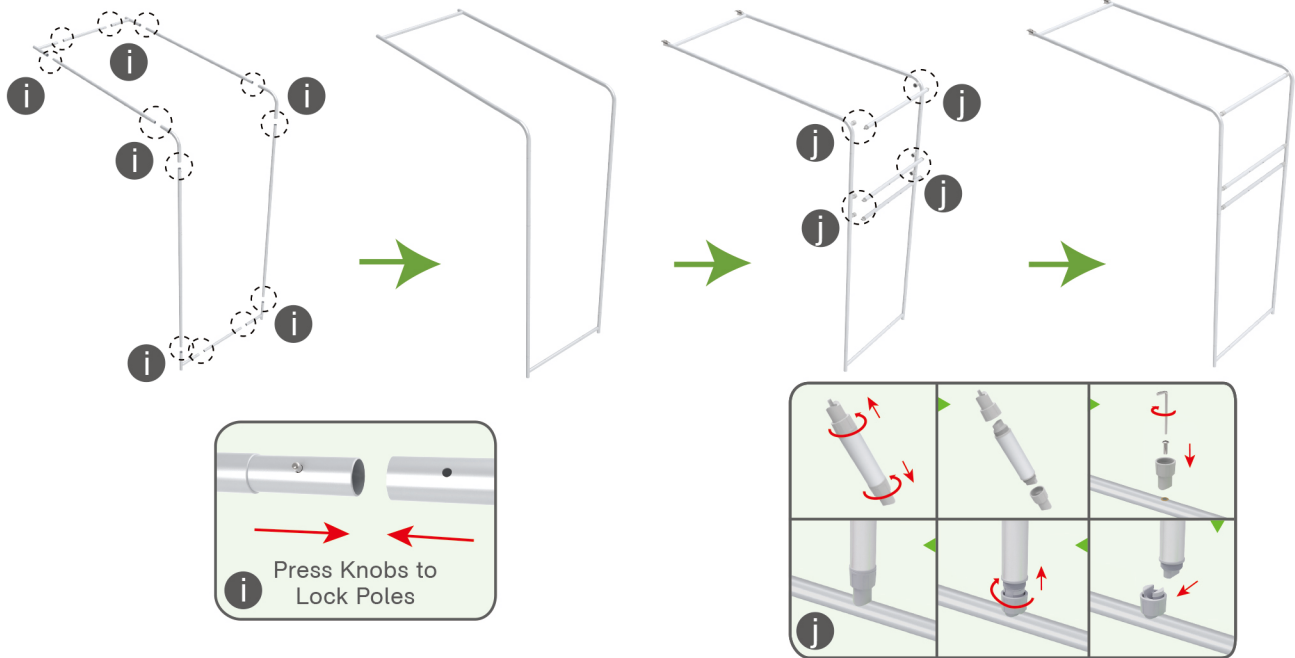

STEP 03

Slide fabric banner on frame from top and zip up at bottom.



Booth Set Assembly



(1) Base



x2

(2) Arm Clip

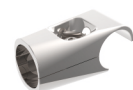

x2

(3) TV Mount

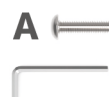
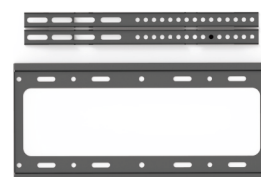

STEPS

STEP 01 Insert display stands onto feet by pressing their knobs.

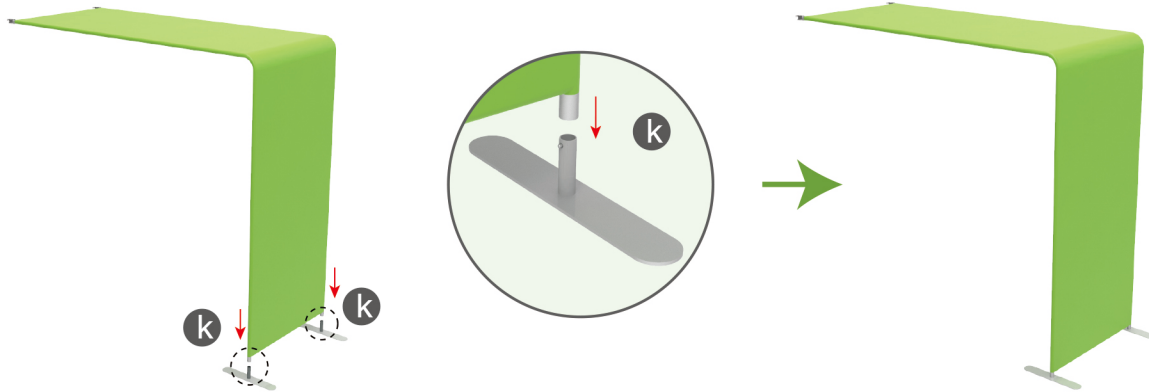

STEP 02 Connect display stands with arm clips.

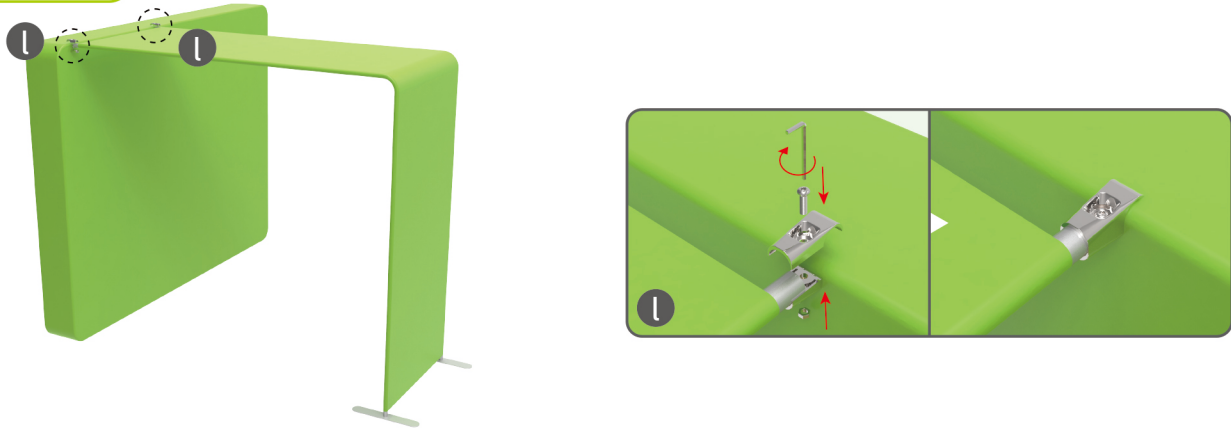

STEP 03 Screw TV mount with hex wrench.

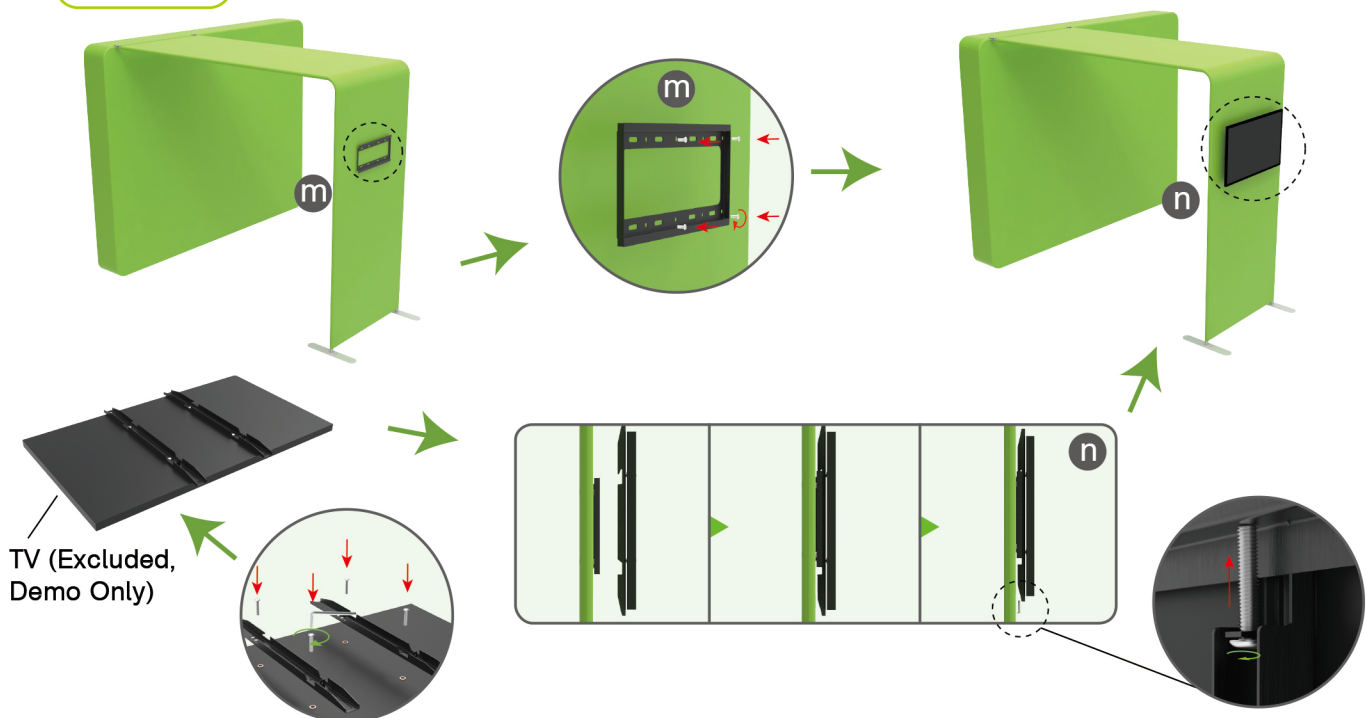

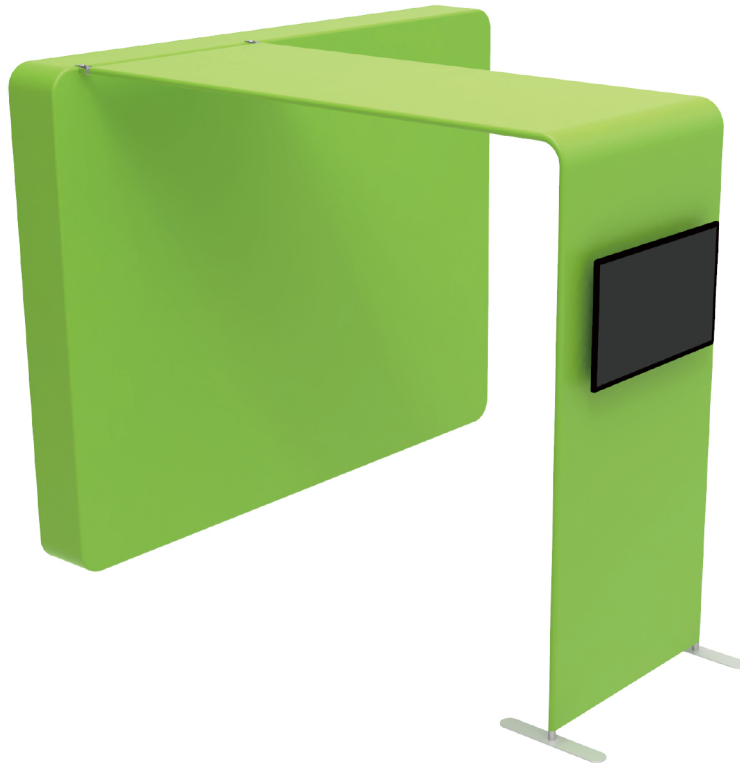
STEPS

Effect with Lights On

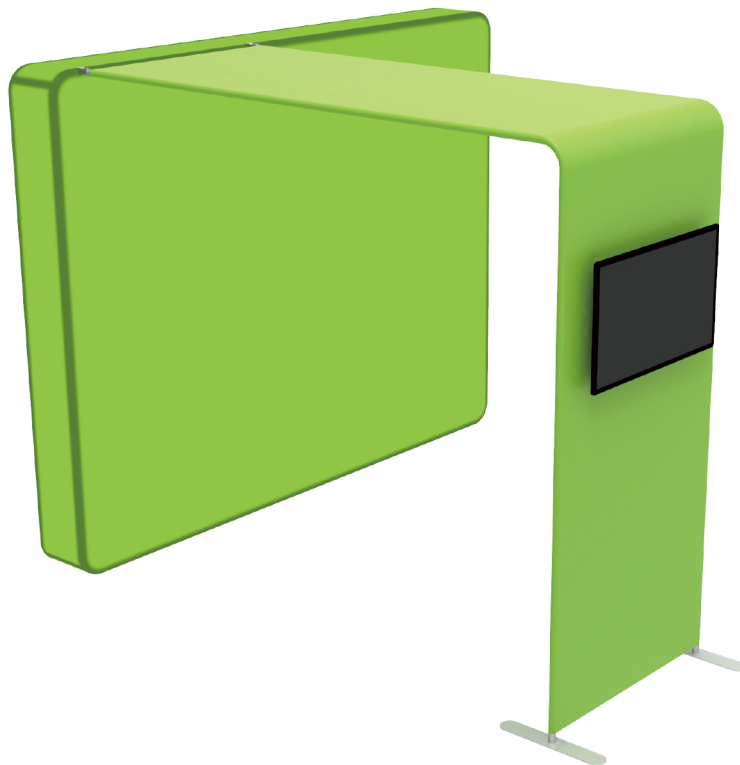

10X10FT-BOOTH-29

STEPS

(1) Durable Plastic Hard Case, Aluminum Support Poles



(2) Printed Graphic Fabric Banner



STEP 01

Put hard case's top into fabric banner.

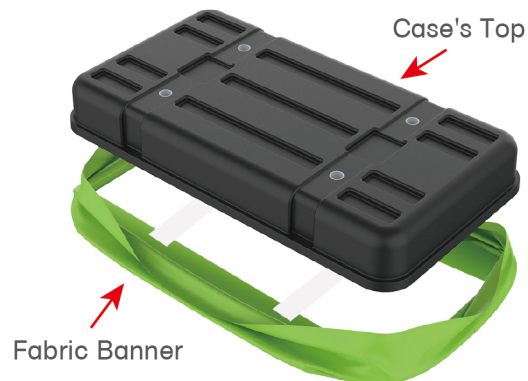

STEP 02

Insert support poles into hard case's top & bottom.

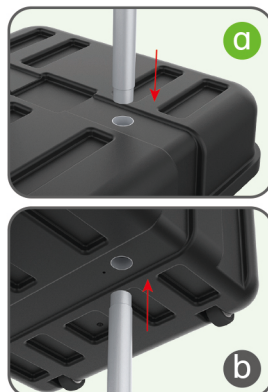
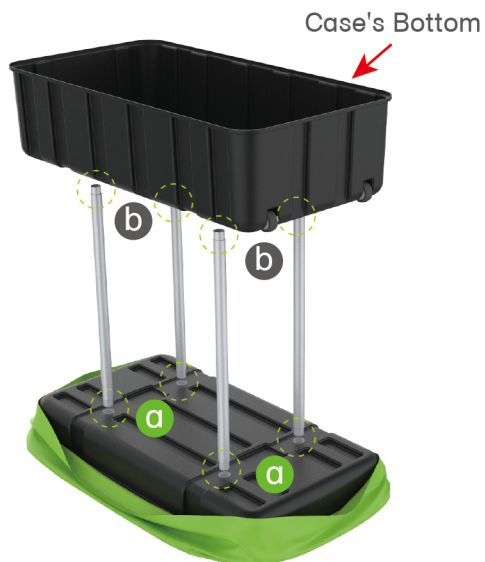

STEPS

STEP 04

Wrap fabric banner from bottom to top & twist it to be smooth, lay hard case's intermediate panel on podium's top.

