

STEPS

(1) Hardware



(2) Printed Graphic Fabric Banner



(3) Light Clips



STEP 01

Connect to make long poles according to labelings.

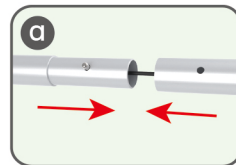
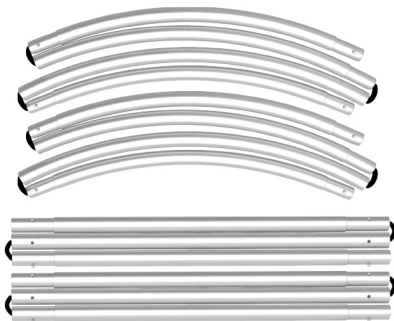

Press Knobs to Lock Poles with Bungees

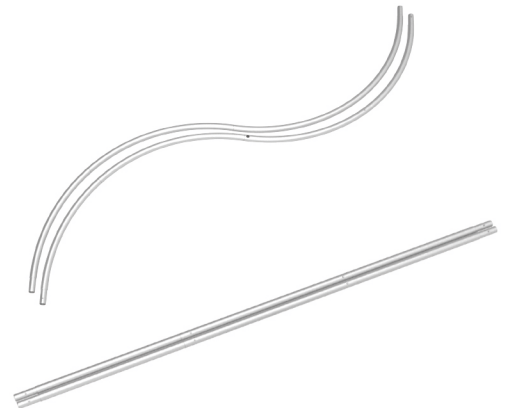

STEP 02

Connect long poles with corner poles according to labelings.

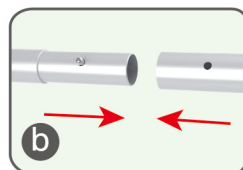
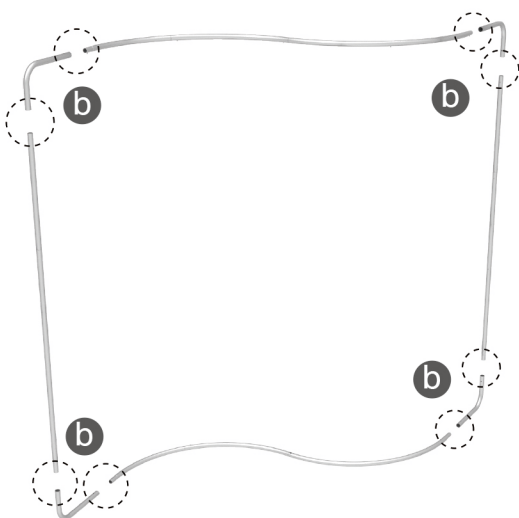

Press Knobs to Lock Poles

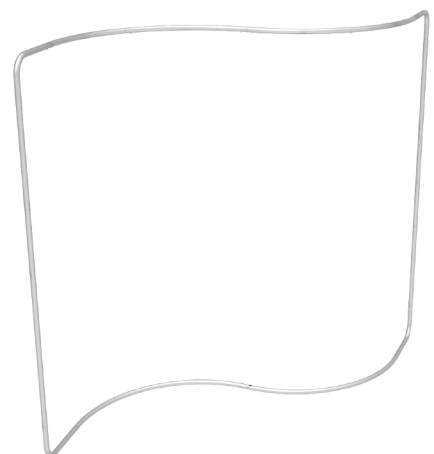

STEPS

STEP 03 Connect poles with bungees for making middle support pole to insert in position.

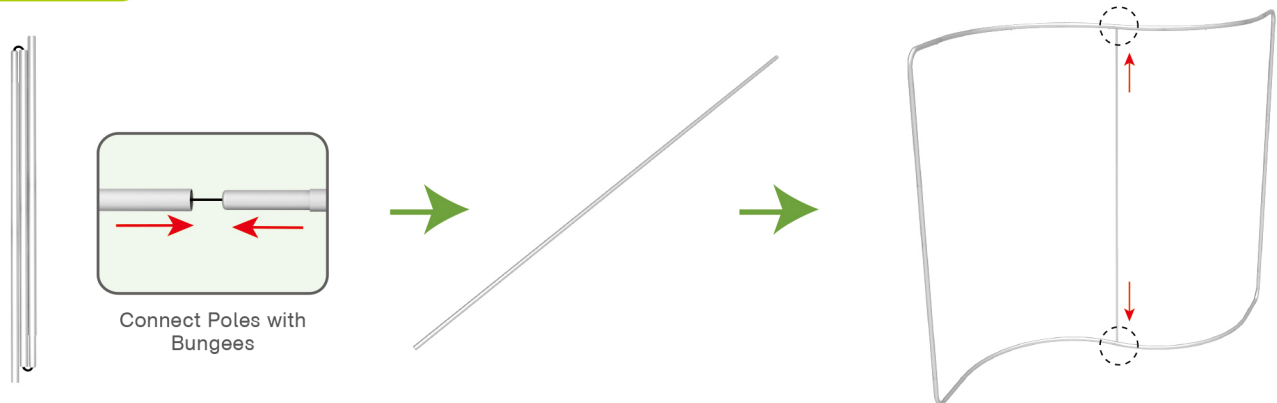

STEP 04 Slide fabric banner on frame from top and zip up at bottom.

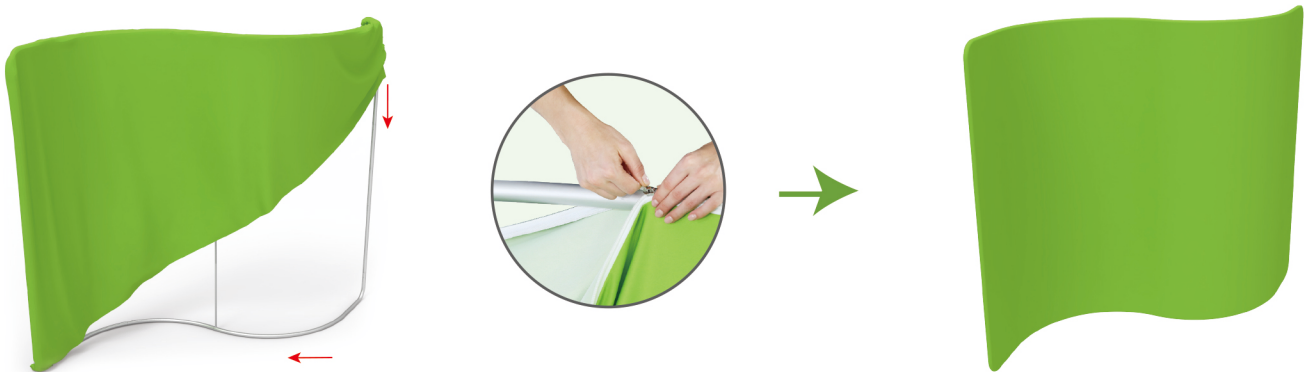

STEP 05 Screw light clips at top of display stand, slide lights onto them and adjust their direction.
LED Lights are optional

