

STEPS

(1) Hardware



(2) Graphic printing fabric banner

**STEP 01**

To connect the poles according to the labellings

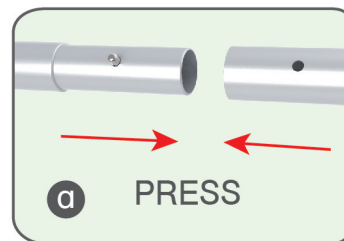
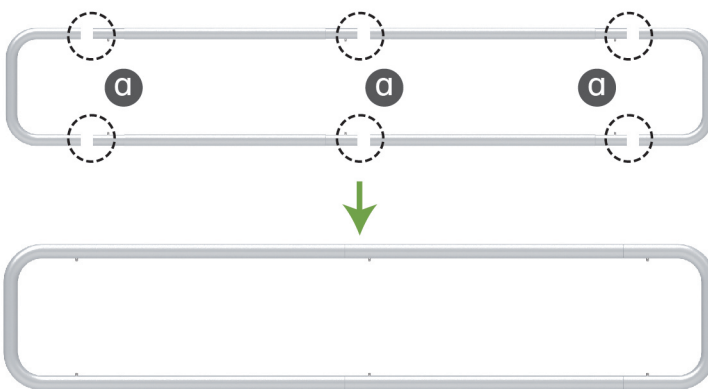
**STEP 02**

To wrap up the fabric banner from side to side and zip up



Same steps for following styles of headers

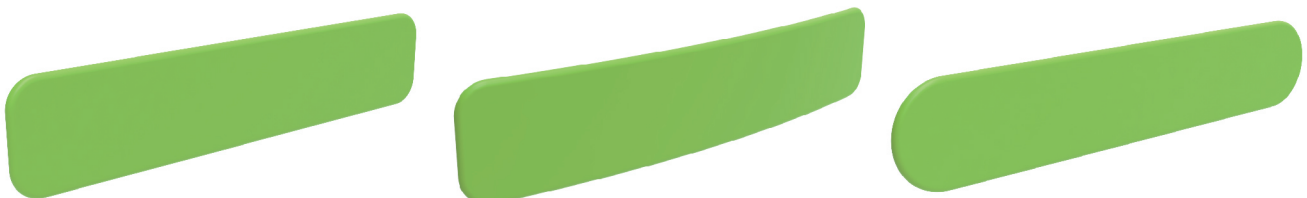

STEPS

(1) Hardware

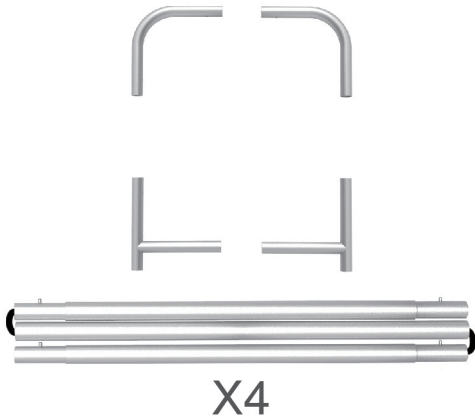

(2) Graphic printing fabric banner

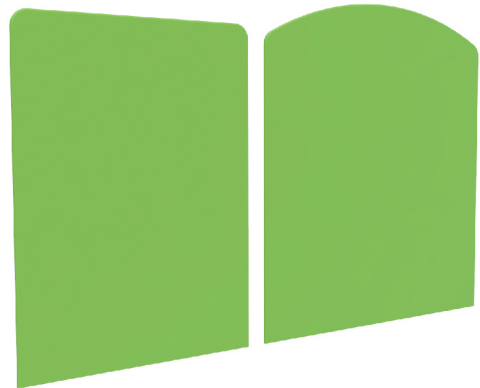

STEP 01

To connect the poles according to the labellings

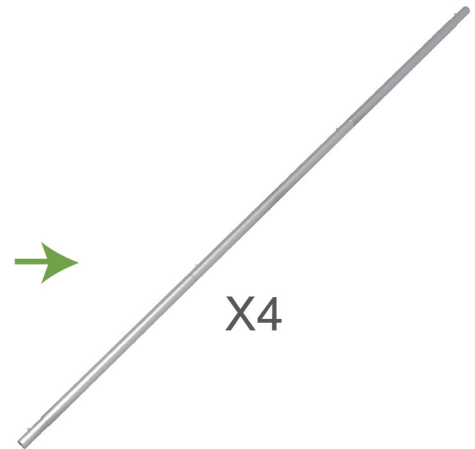
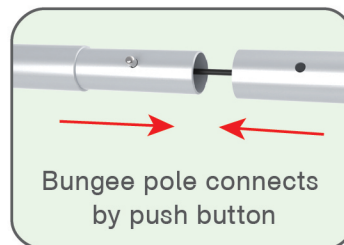
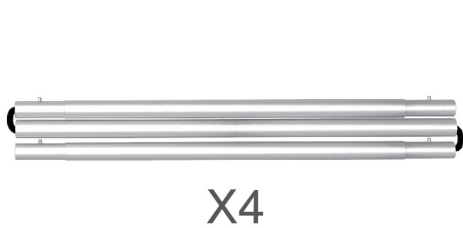

STEP 02

To connect the long poles by corner pieces

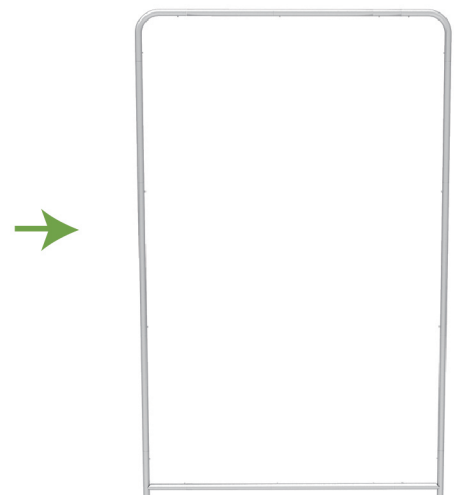
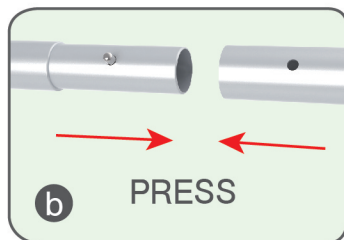
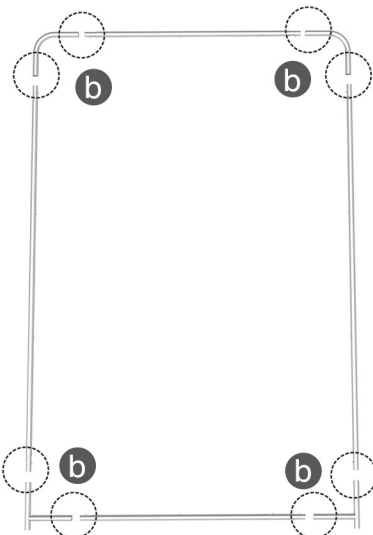

STEPS

STEP 03

To slide the fabric banner on the frame from top and zip up at bottom

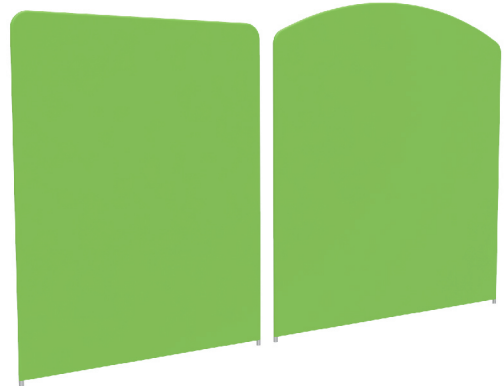

Same steps for rest back walls

Booth Set Assembly

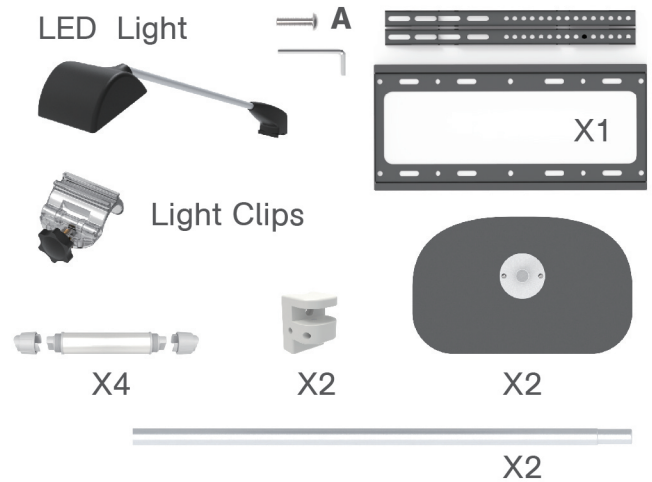
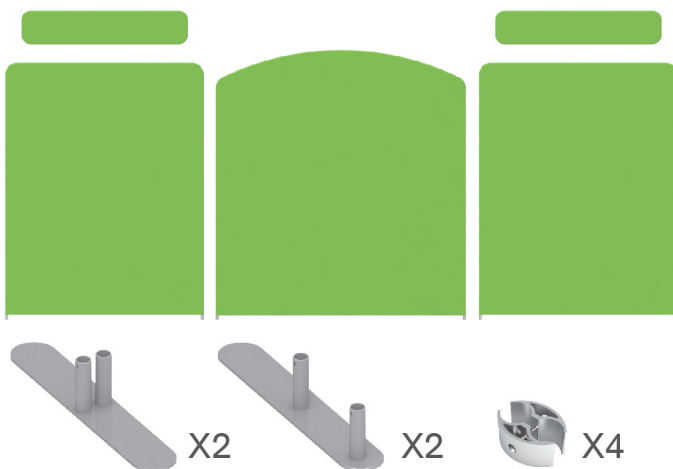

STEP 01

To lie down the backwall and header then install the upright pole in position

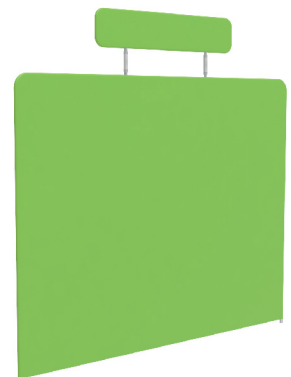
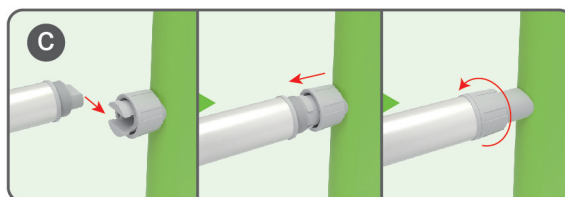
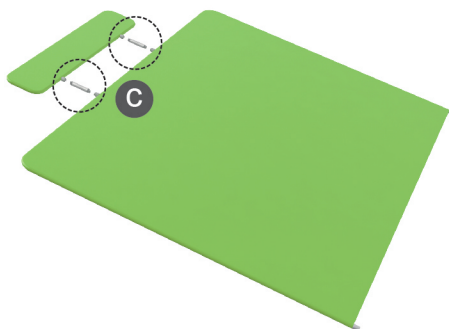

STEPS

STEP 02

To assemble the stand feet in position

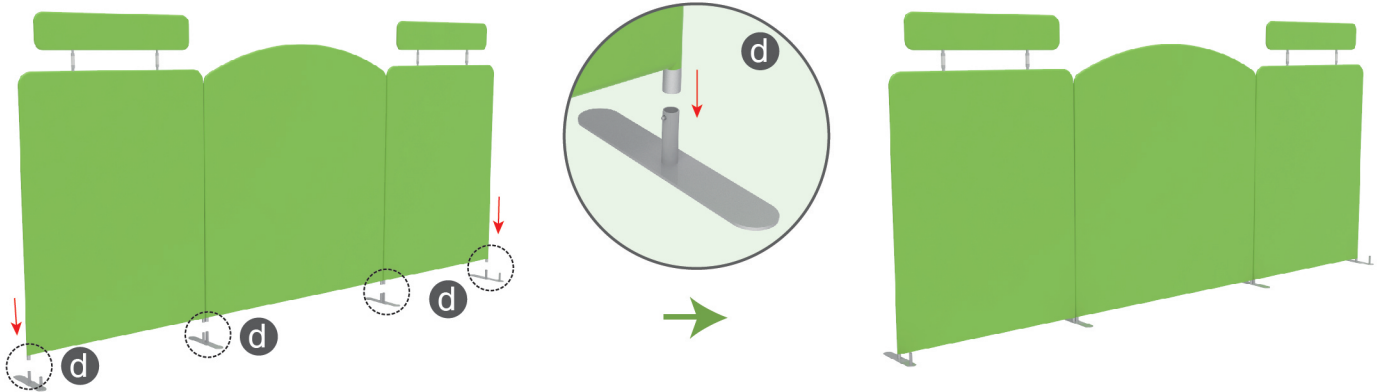

STEP 03

To put the C clips in between display wall and fasten for standing perfectly

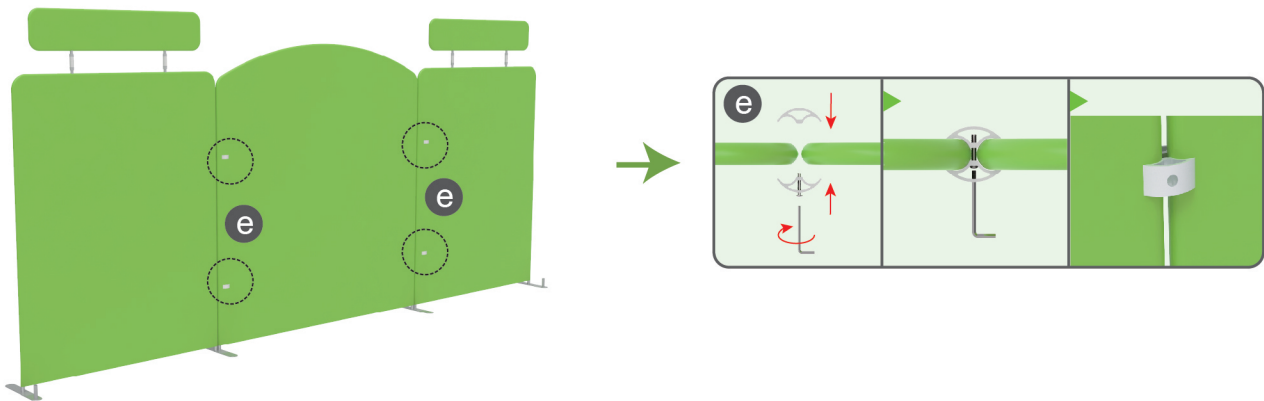

STEP 04

To install the shelves at sides in position

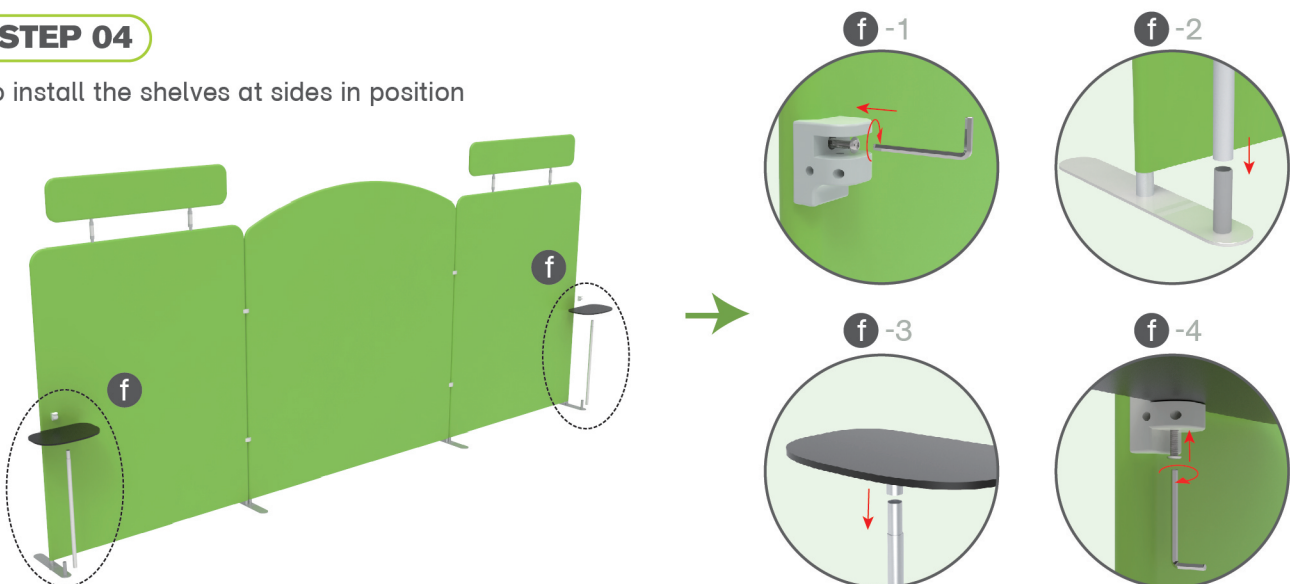

STEPS

STEP 05

To install the TV mount in position

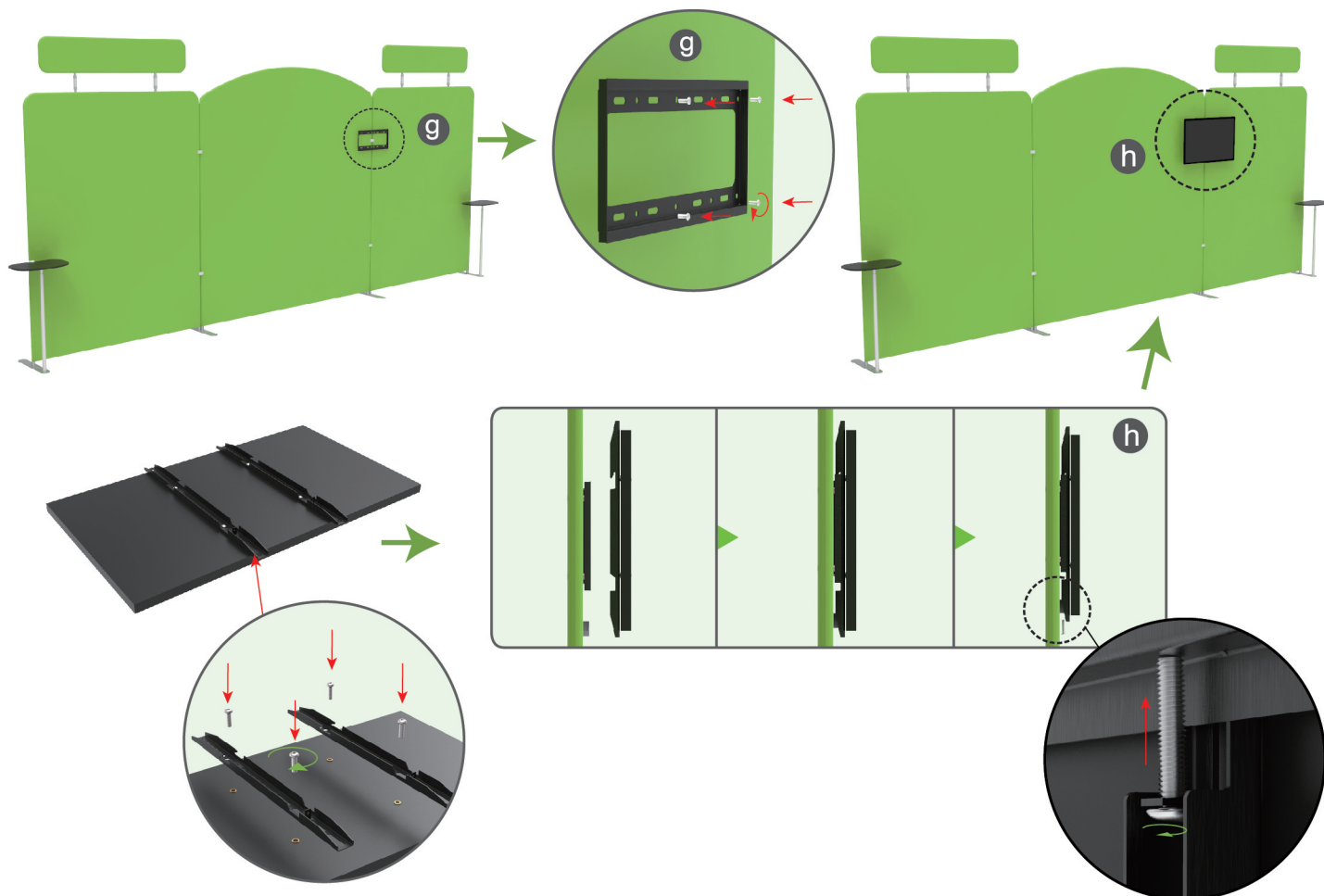

STEP 06

Install LED light

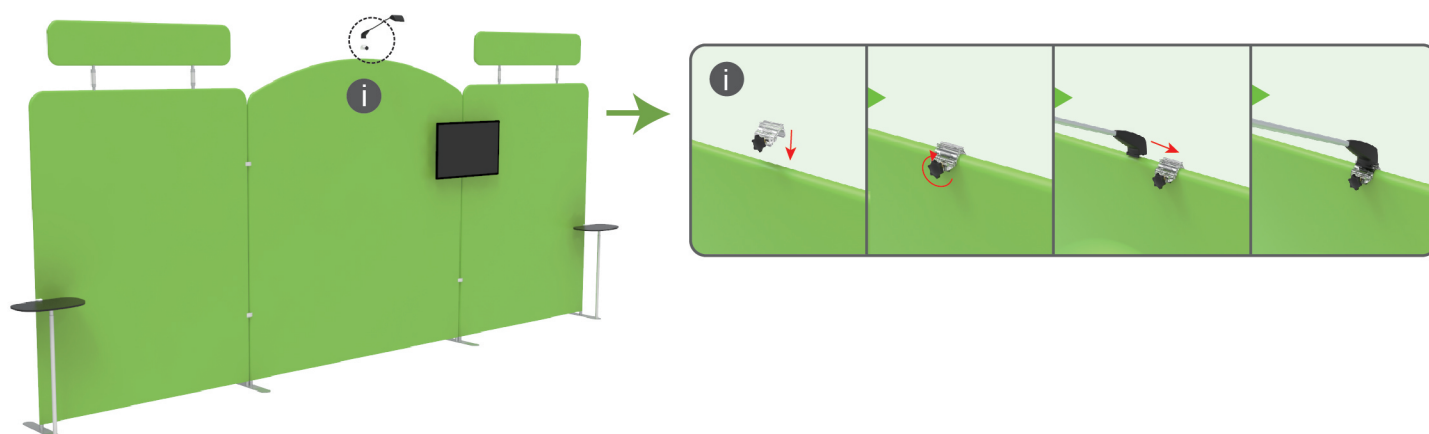

STEPS

Same Steps for Following Booths



10X20FT-BOOTH-06



10X20FT-BOOTH-08