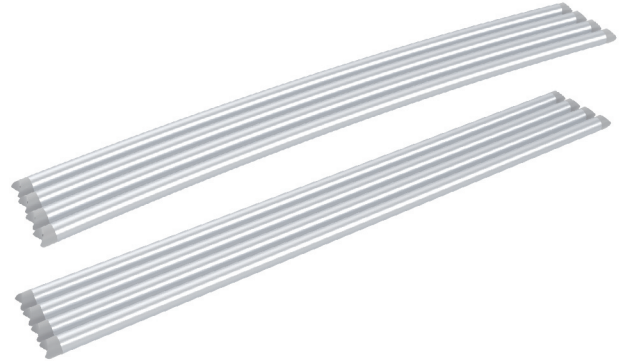
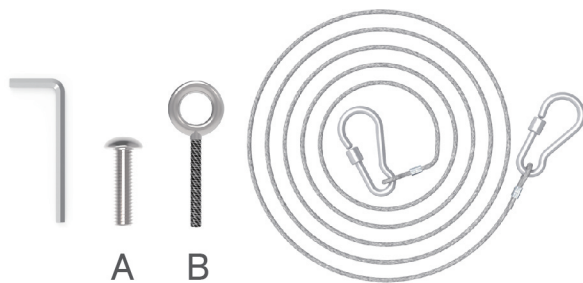
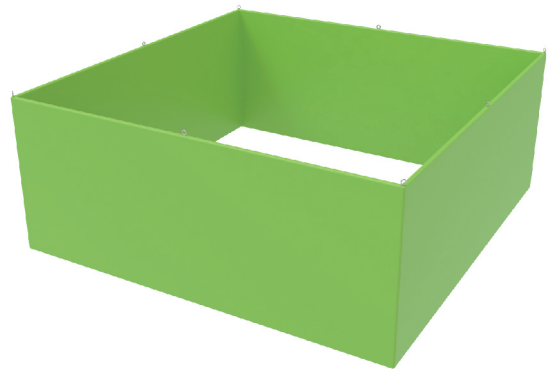

★ One Tool (Hex Wrench) **STEPS**

(1) Straight Long Tubes

(2) 4 Straight Corner Upright Poles
Curved Upright poles(3) wire cable with hook;
Screw A; Screw B;
Allen Key

(4) Graphic printing fabric banner x 1

**STEP 01**

To connect the poles according to the labellings

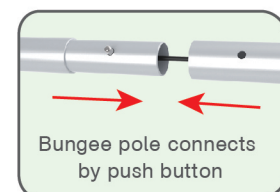

STEP 02

To connect 4 long poles to be top square and another 4 long poles to be bottom square, then use 4pcs of corner upright poles to connect top & bottom square and use screws B at top, screws A at bottom for fastening; afterwards, to install the rest curved upright poles in position by using screws B at top, screws A at bottom.

(Please mind that screws B are using at the top, screws A at the bottom)

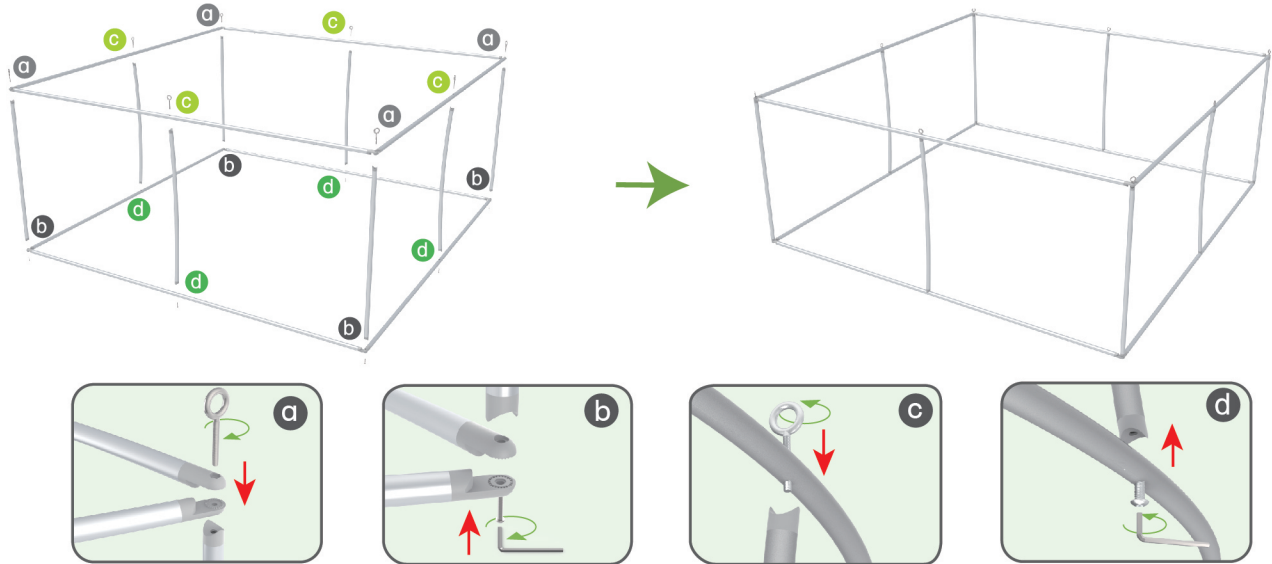
**STEP 03**

To wrap the fabric banner on the frame from bottom to top and zip up
Please mind there are holes on fabric for the hanging screws at top of frame

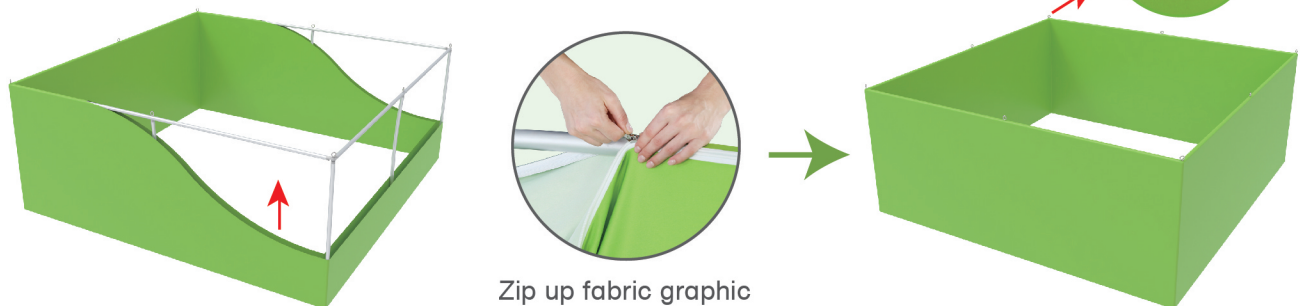
**STEP 04**

To clip the wire on the hanging screws and hang up the sign

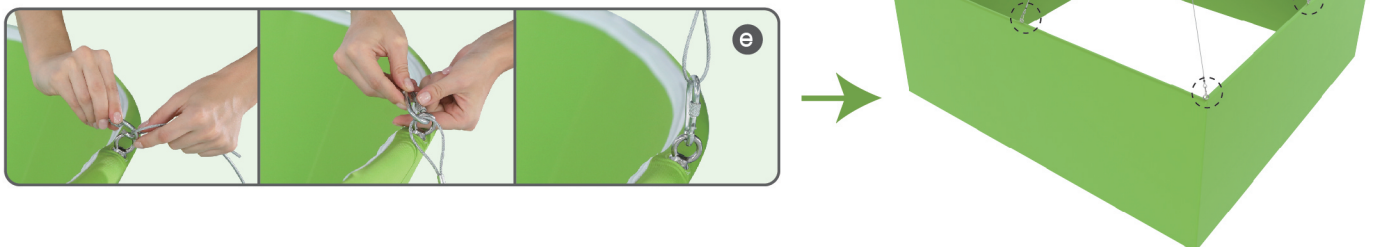

STEPS

(1) Hardware set of column

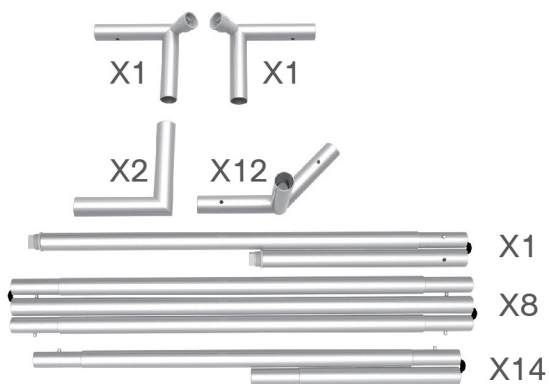

(2) Fabric cover of column

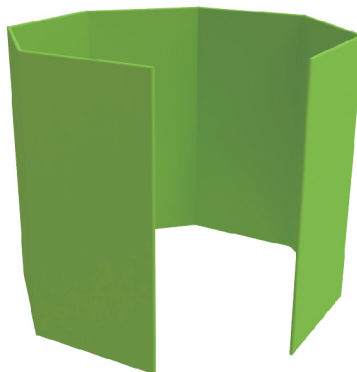
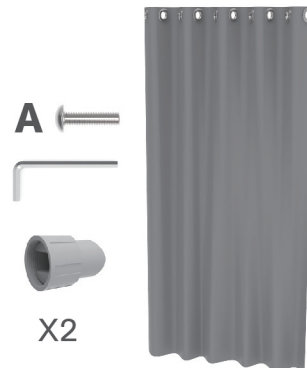
(3) 2x plastic screw knob
1x door curtain

STEP 01

To connect the poles according to the labellings

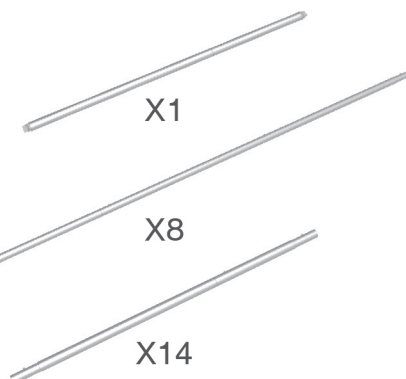
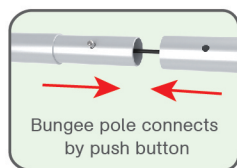
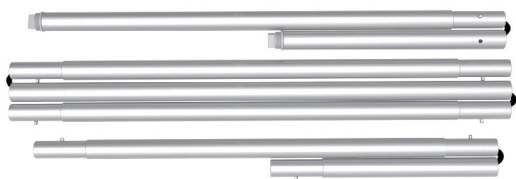

STEP 02

To connect the short poles with the welded corner pieces to be octagon according to the labelling

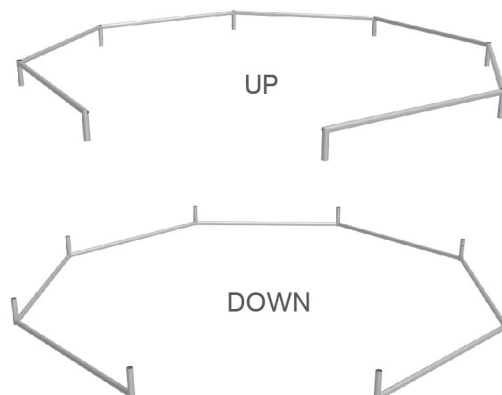
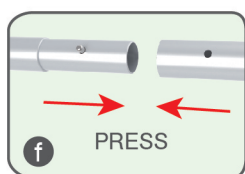
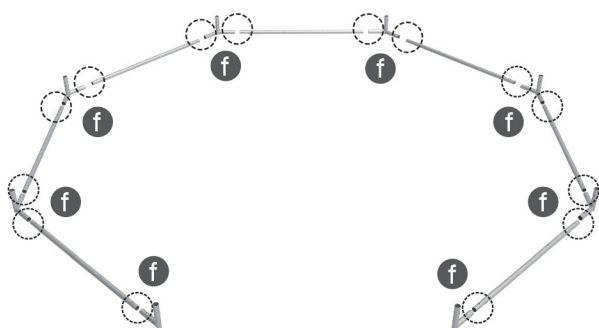

STEPS

STEP 03

To use 8 long poles connecting top octagon & bottom octagon frame to be a column stand

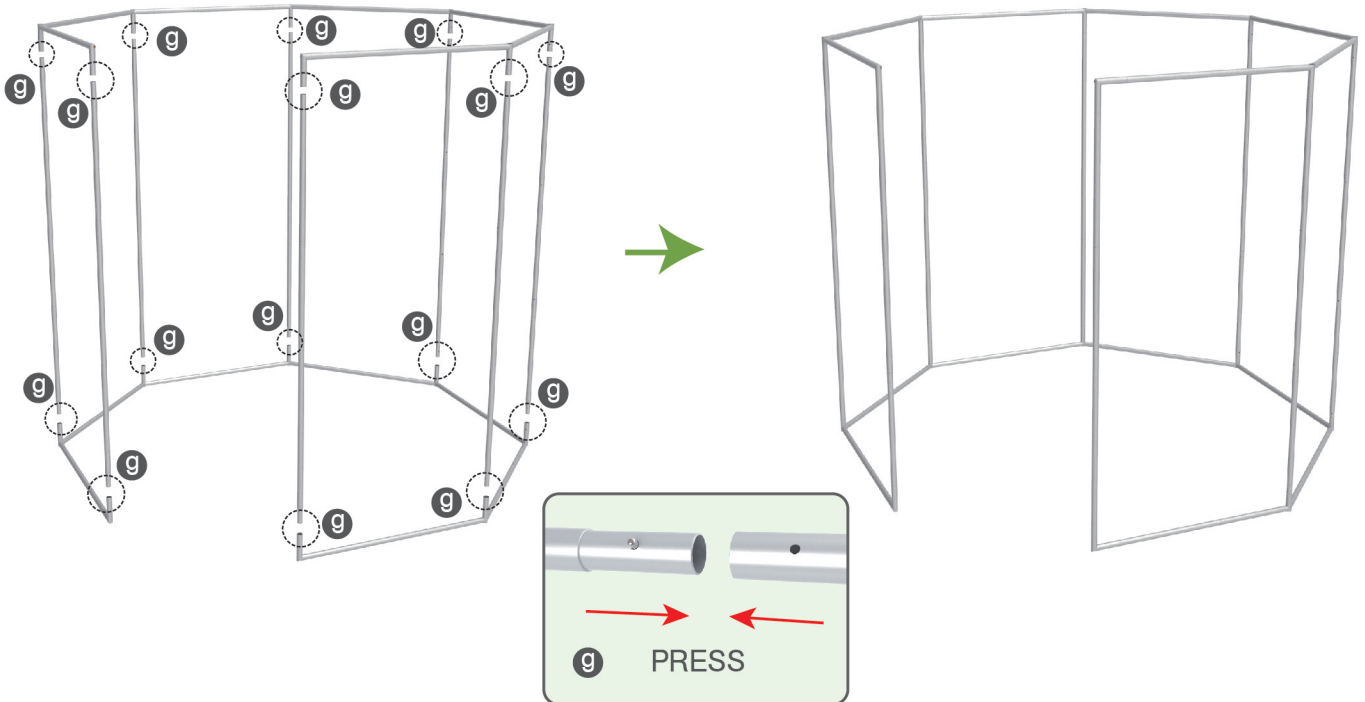

STEP 04

To wrap the fabric cover from bottom to top and zip up

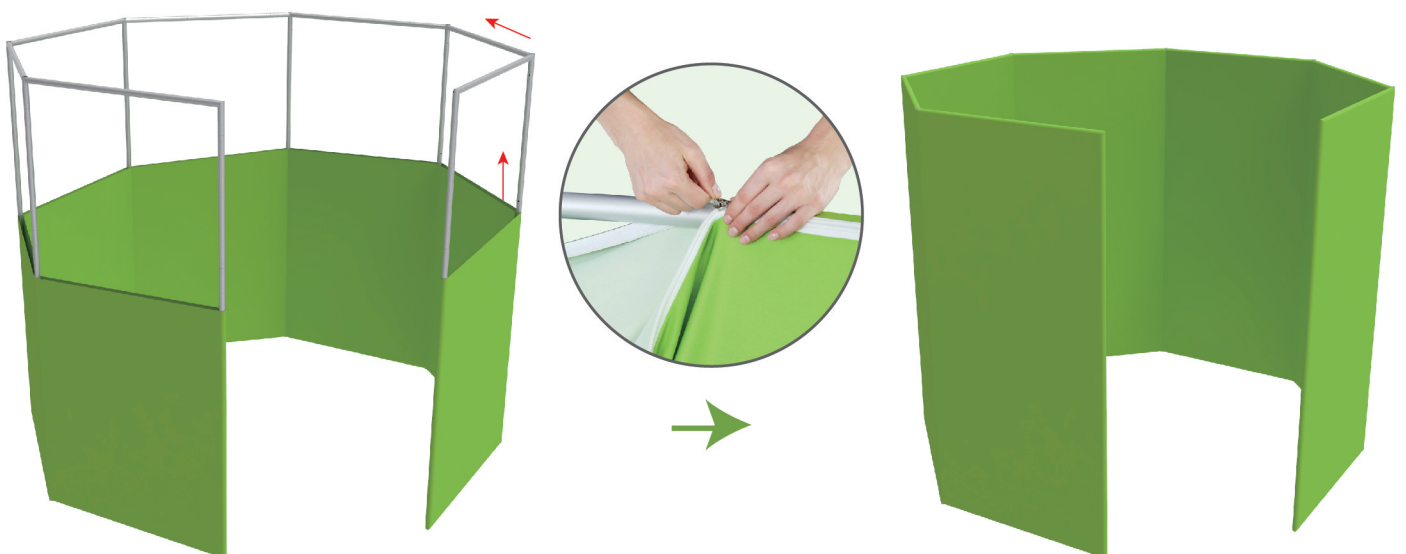

STEPS

STEP 05

To install the 2 plastic knobs on the top left / right corner of column opening by using screws

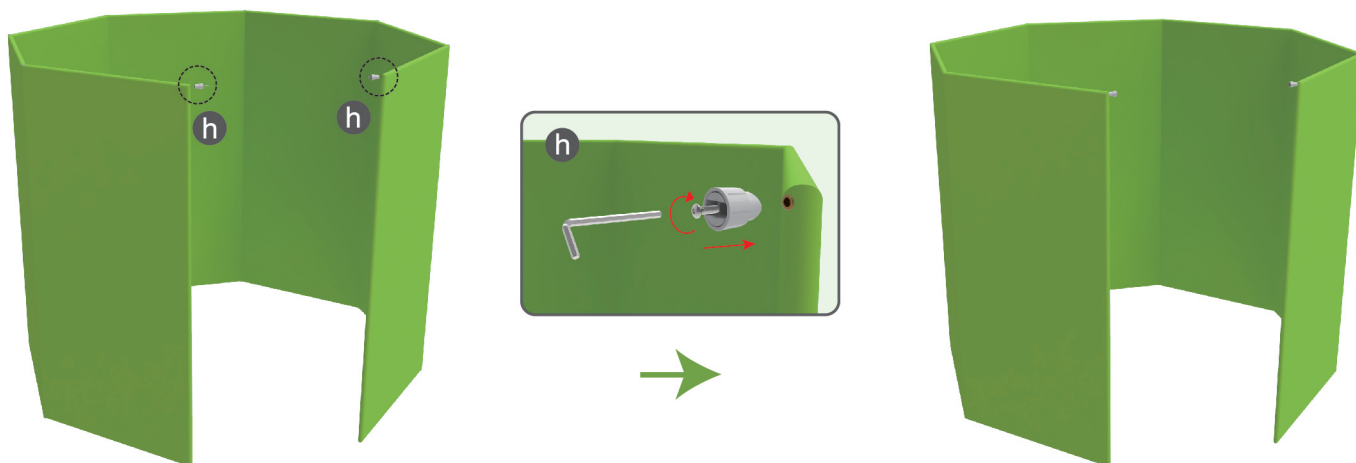

STEP 06

To put the cross bar through the rings of fabric curtain and then fasten to the top screw knobs of column

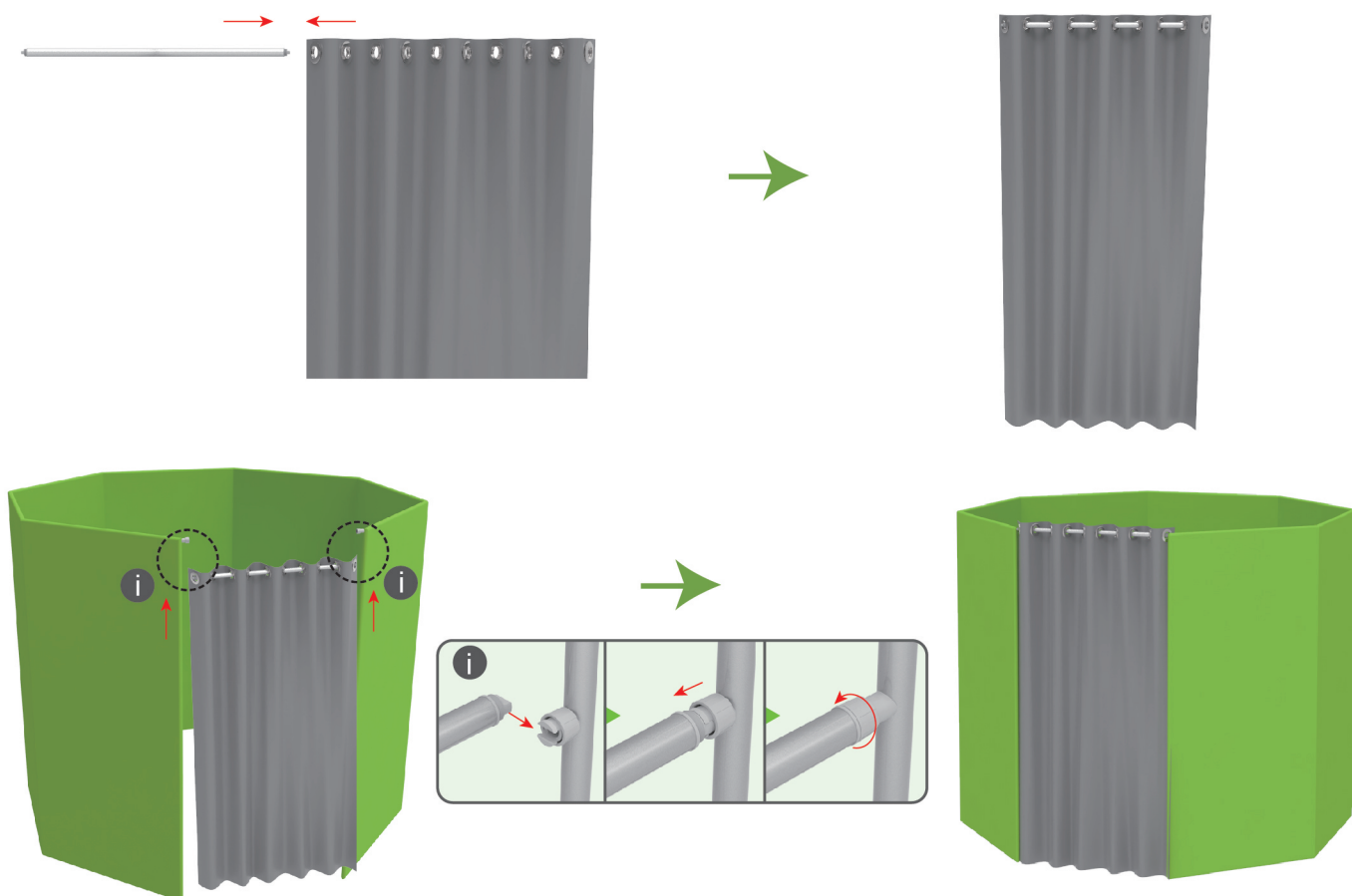

STEPS

(1) Hardware set

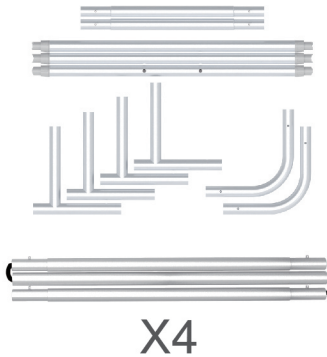

(2) Fabric banner

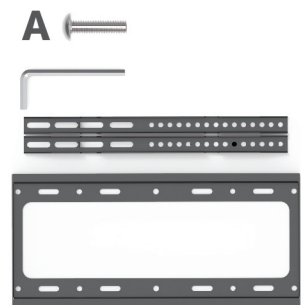
(3) TV mount x 1
Screw bag x 1

STEP 01

To connect the poles according to the labellings

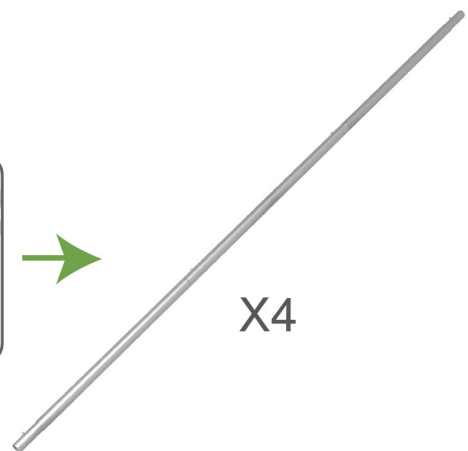
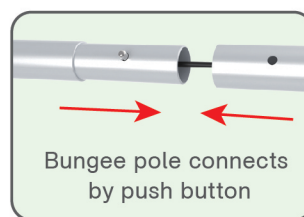

STEP 02

To use corner pieces to connect the poles to be display stand

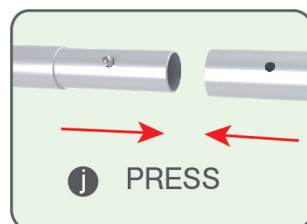
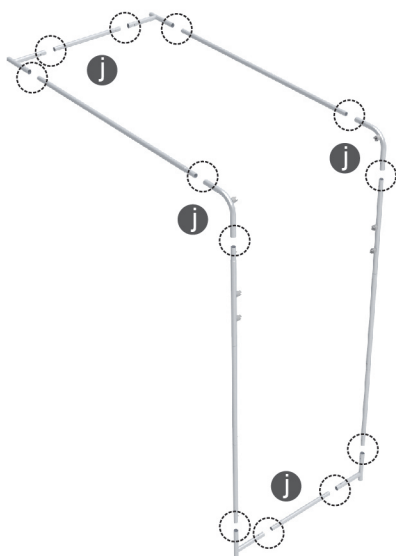

STEPS

STEP 03

To install the cross bar according to the labellings

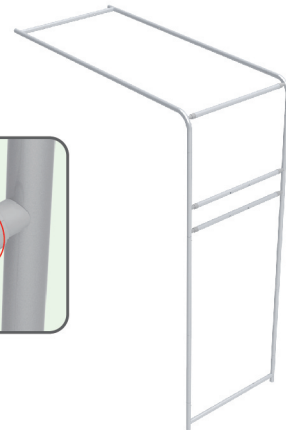
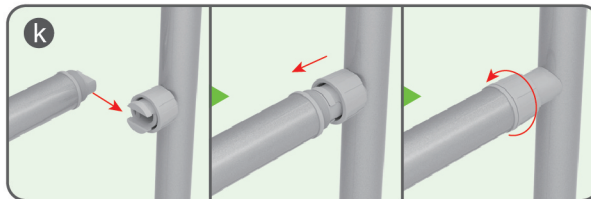
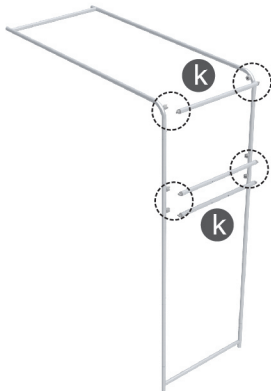

STEP 04

To wrap the fabric banner from side to side and zip up

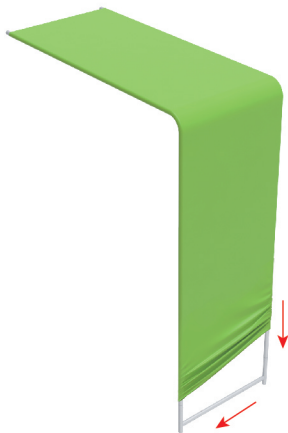

STEP 05

To assemble the feet in position

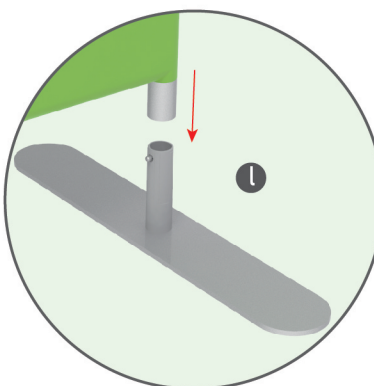
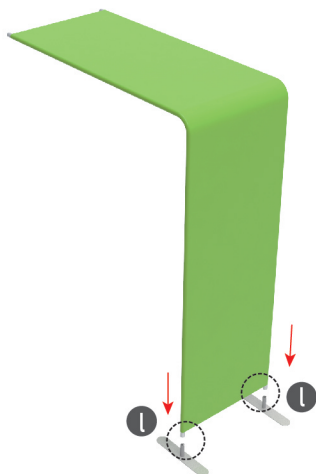

STEPS

STEP 06

To connect the arch stands to the column by using clamps

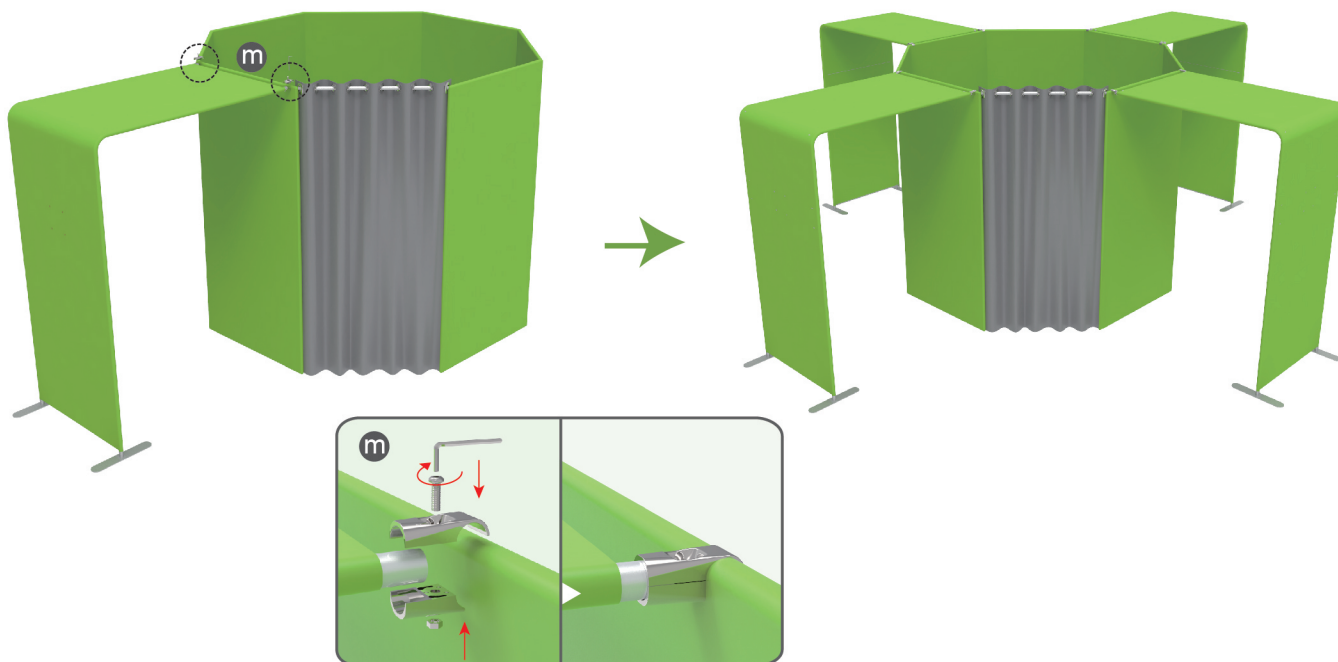

STEP 07

To install the TV mount in position

To assemble the 2 support brackets at the back of TV and hang whole TV set onto the TV mount of arch stand

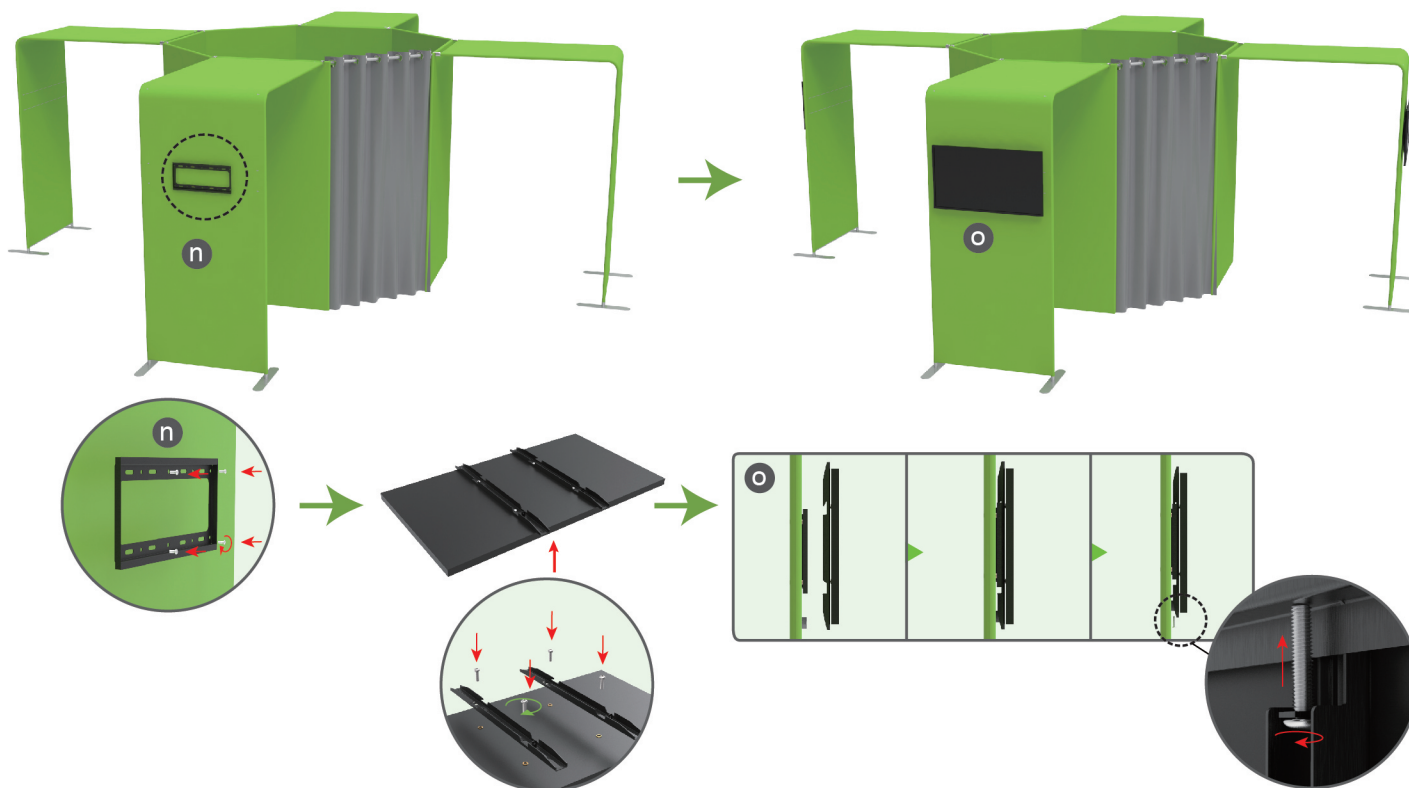

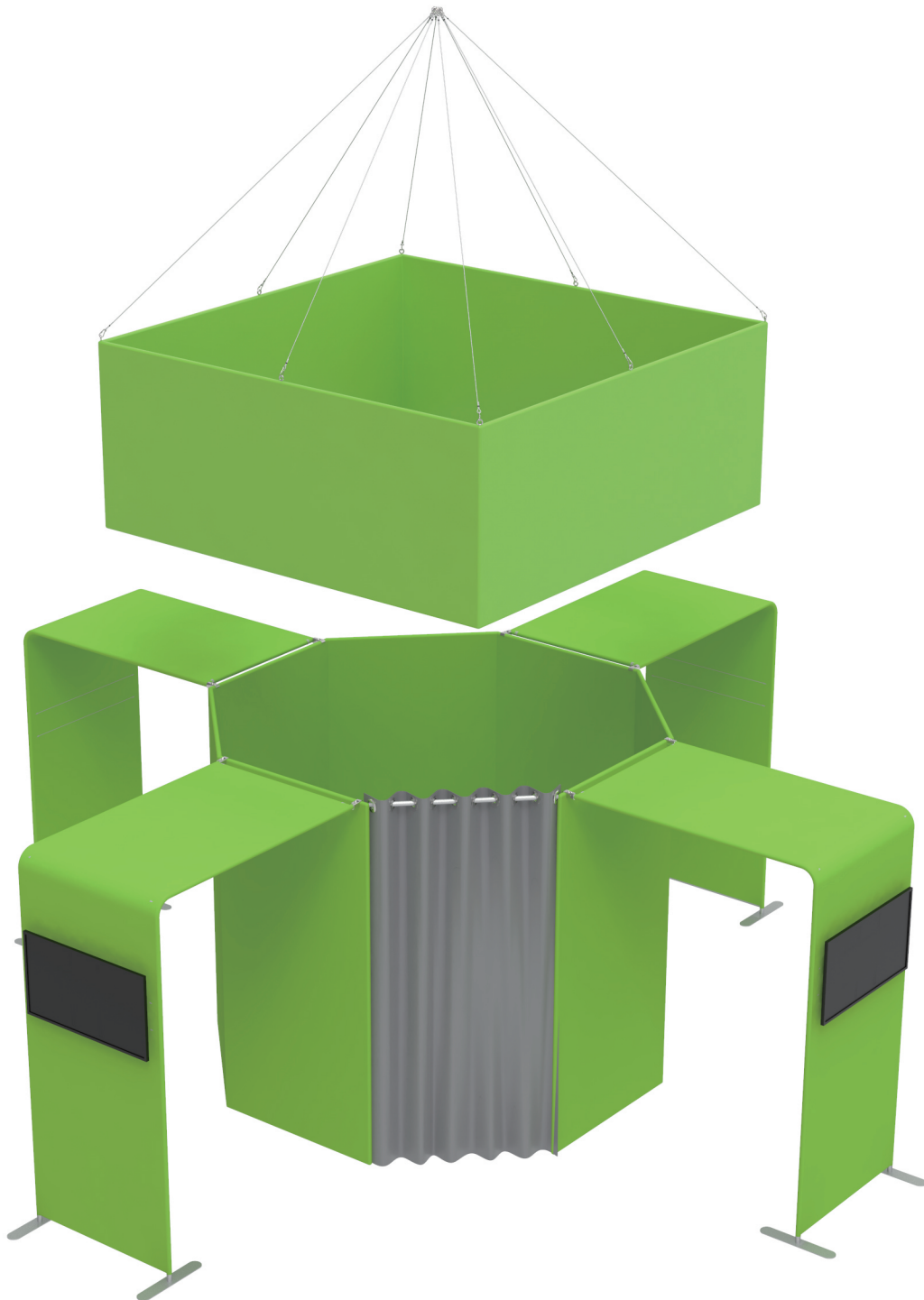
STEPS**20X20FT-BOOTH-05**